

SUBJECT TO FIRE MARSHAL APPROVAL



BUILDING LEGEND

- HALL B1 UTILITIES
 - A 480V, THREE, 100AMP
 - 200V, THREE, 100AMP
 - 120V, SINGLE, 15AMP
 - B 200V, THREE, 60AMP
 - 200V, THREE, 30AMP
 - 120V, SINGLE, 15AMP
 - C 200V, THREE, 30AMP
 - 120V, SINGLE, 15AMP
- PLUMBING POINTS
 - 1" GAS
 - 1" WATER
 - 4" DRAIN
- HALL B2 UTILITIES
 - ELECTRICAL FROM OVERHEAD
 - 200V AND 480V
 - PLUMBING POINTS
 - OVERHEAD 1" GAS, 1" WATER
 - 4" FLOOR DRAIN

CEILING HEIGHT IN HALL B1 = 40'
 CEILING HEIGHT IN HALL B2 = 18'
 CEILING HEIGHT IN GRAND CONCOURSE LOBBY VESTIBULES
 FHC FIRE HOSE CABINET (MUST BE KEPT CLEAR)
 FFC FIRE EXTINGUISHER CABINET
 FHR FIRE HOSE REEL
 * INDICATES LATEST REVISION

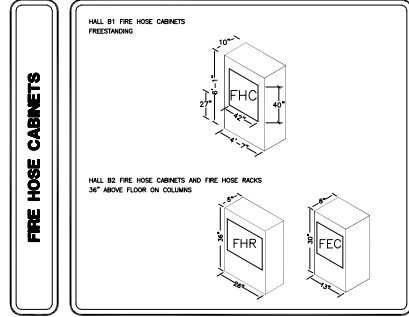
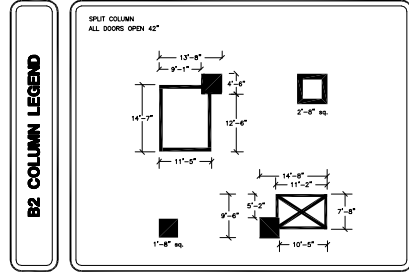
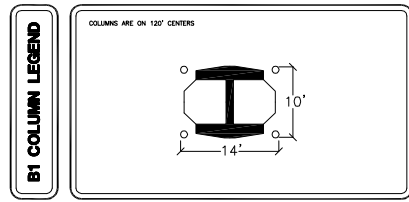

FLOOR PLAN INFORMATION

Show: National Restaurant Assn.
 Date Of Show: May 18 - 21, 2019
 Facility: McCormick Place North
 Portion Of Facility/Hall: Level 3 - Hall B1
 City: Chicago, IL
 Show Number:
 Aisle Size Unless Noted: 10' Drawn By: Lisa Pizzato
 Booth Size Unless Noted: 10'x10' SE/AE: John Loveless
 Outline: z-mccorm-b1b2.dwg
 File: nra1-1905-mccorm-b1.dwg

Initial: 04-02-18 LP	Rev:	Rev:
Rev: 04-12-18 LP	Rev:	Rev:
Rev: 04-26-18 LP	Rev:	Rev:
Rev: 06-07-18 LP	Rev:	Rev:
Rev:	Rev:	Rev:
Rev:	Rev:	Rev:

GES

Copyright © by Global Experience Specialists, All Rights Reserved. No part of this publication may be reproduced, stored in any retrieval system, or transmitted in any form or by any means - electronic, mechanical, photocopying, recording, or otherwise - without express written consent of Global Experience Specialists. Every effort has been made to insure the accuracy of all information contained on this floor plan. However, no warranties, either expressed or implied, are made with respect to this floor plan. If the location of building columns, utilities, or other architectural components of the facility is a consideration in the construction or usage of an exhibit, it is the sole responsibility of the exhibitor to physically inspect the facility to verify all dimensions and locations.

**CONFIDENTIAL PROPERTY OF GES
SEE ABOVE**