

These three cords are for charging your device (phone). (Power **OUT** of the battery)

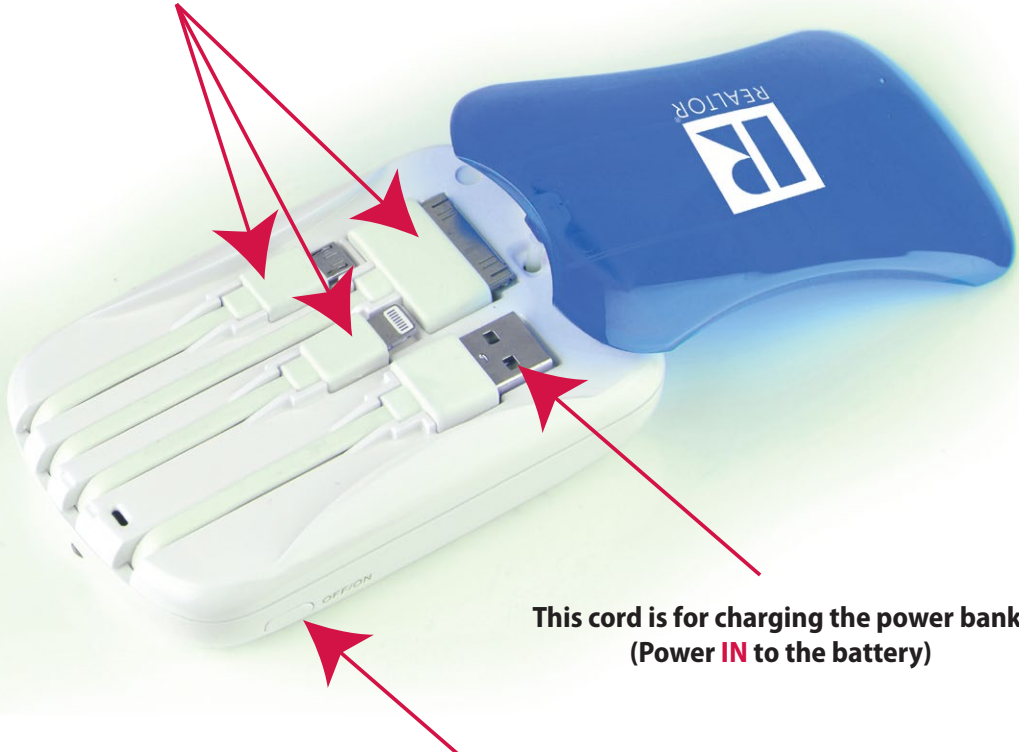

This cord is for charging the power bank. (Power **IN** to the battery)

This is the On Switch. You must press it before charging your phone or device. This also activates the battery meter.

Double clicking this button turns on and off the flashlight

This is the battery meter, it shows how much charge the battery contains. 4 lights is fully charged.

This port on top of the battery allows any USB cord to be plugged in. (Power **OUT** of the battery)

This port on the side is for charging the battery. (Power **IN** to the battery)



Built in flashlight

Pull here to open lid

**2 ways to add power into the power bank.
4 ways to get power out of the power bank.**