



# THE BILLIKENS APP

A guide to downloading and using  
the official athletics app for  
Saint Louis University Athletics

# DOWNLOAD THE APP

Download the Official Billikens Athletics app from the App Store or Google Play

Apple App Store: <https://apps.apple.com/us/app/billikens-athletics/id1659065677>

Google Play: <https://play.google.com/store/apps/details?id=com.sidearmsports.saintlouisu>

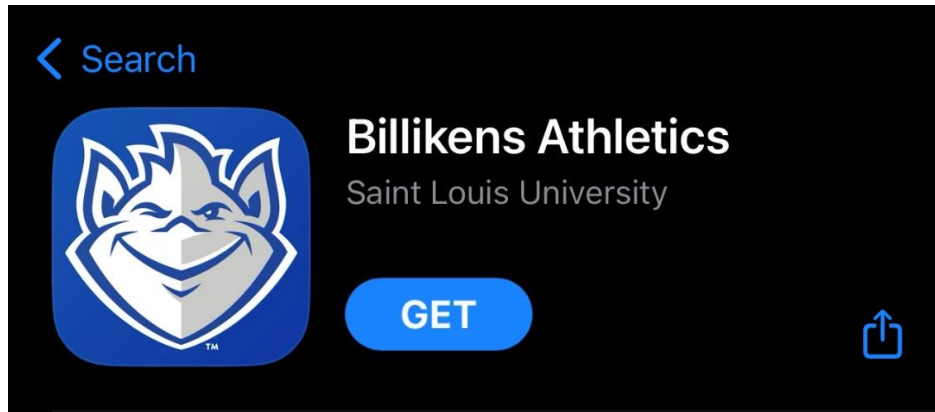

## Billikens Athletics

SIDEARM Sports  
Contains ads

0+  
Downloads

E  
Everyone

Install

Add to wishlist



# SETTING UP THE APP

Tap “Create an account” and type your first name, last name, email address, and create a password; then tap register

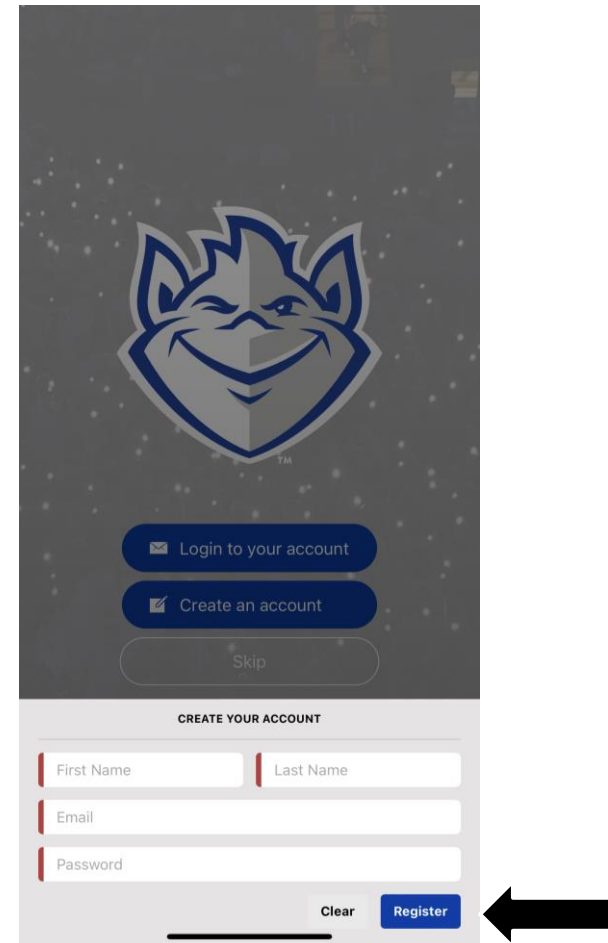
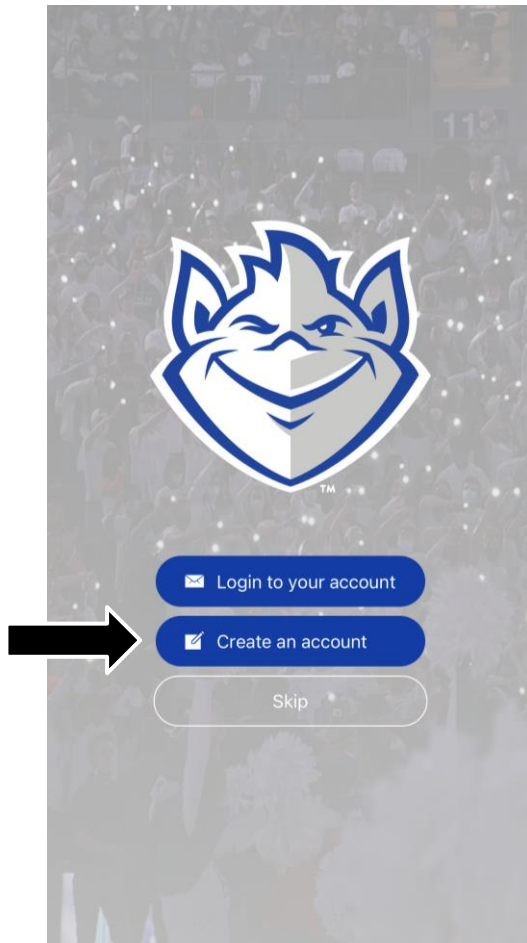

# SETTING UP THE APP

It will ask you if you would like to give permission to send marketing and promotional materials, select disagree or agree (recommended)

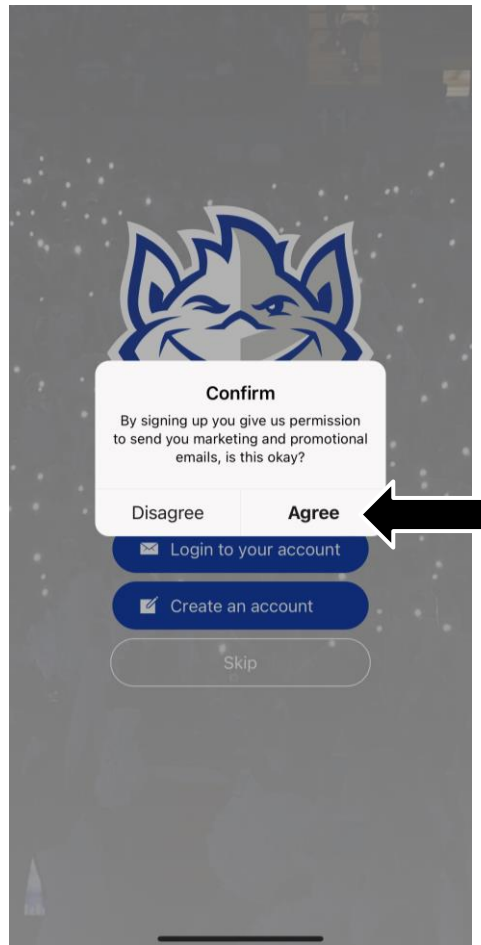

# SETTING UP THE APP

Tap “continue” and the next screen will ask if you would like to receive push notifications, select No Thanks or Sure! (recommended).

If you select sure! a pop up will confirm whether you would like to receive notification, select Don't Allow or Allow (recommended)

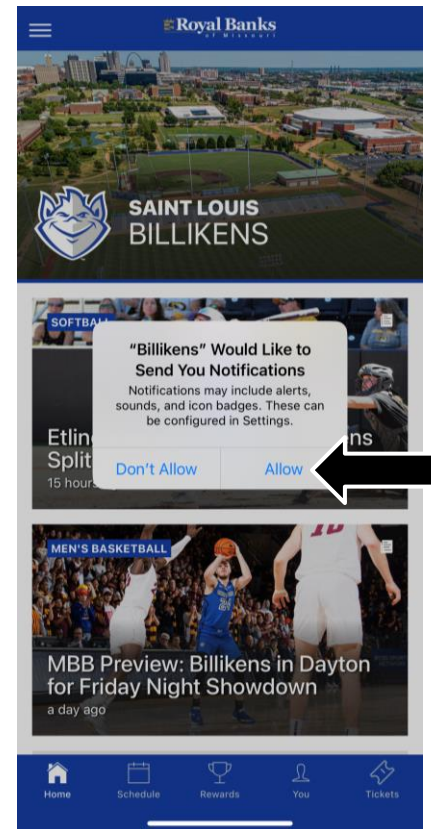
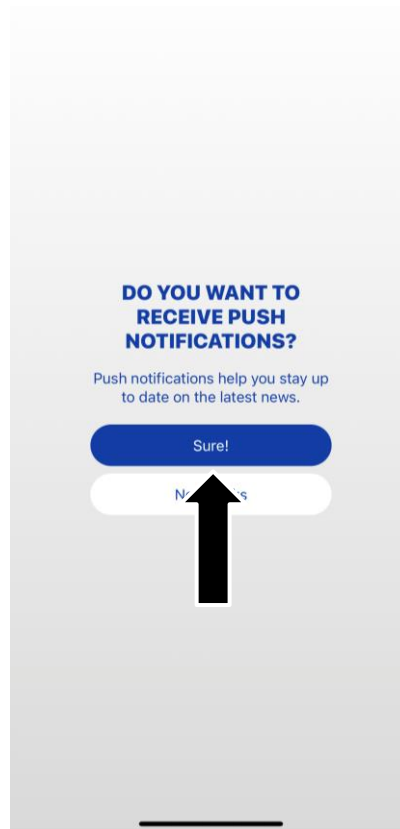
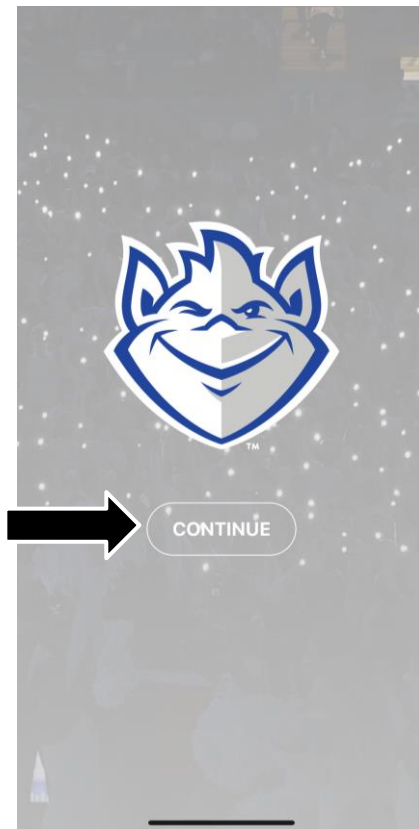

# SETTING UP BILLIKENS REWARDS

Tap the “Rewards” Icon in the bottom menu or tap the three lines in the top left corner and select “Billikens Rewards”

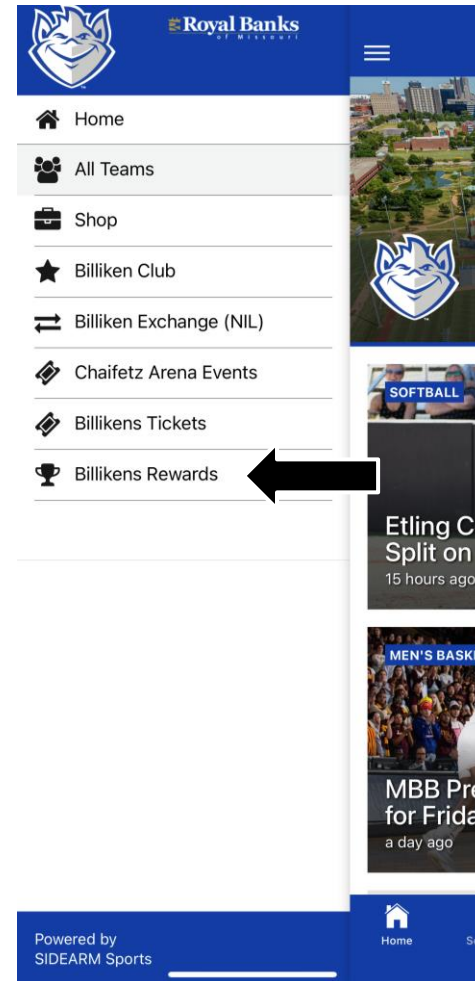
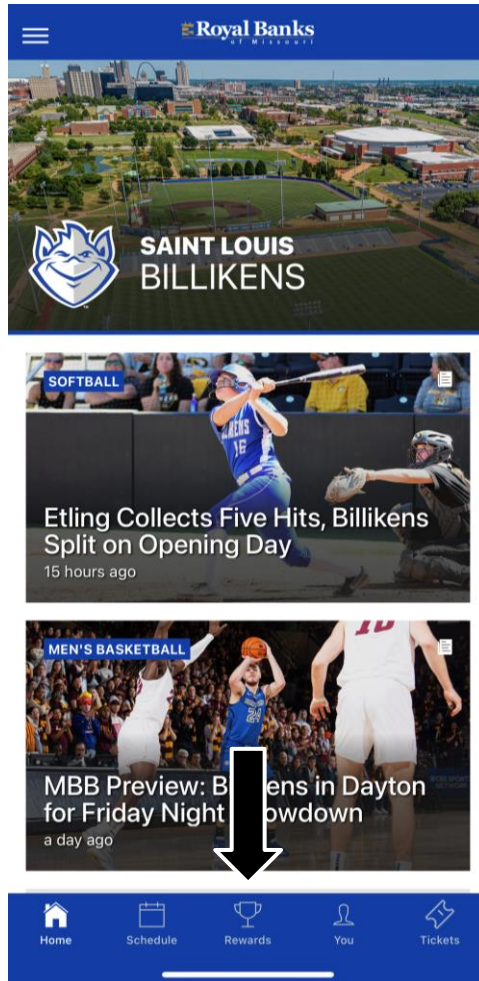

# SETTING UP BILLIKENS REWARDS

It will ask if you would like to share your location, select **Allow Once**, **Allow While Using App** (recommended), or **Don't Allow**.

In order to check-in at games and receive points, you will need to enable location services.

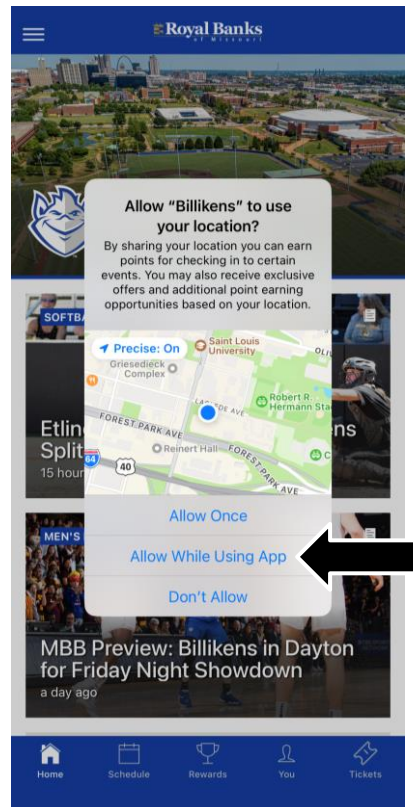



# SETTING UP BILLIKENS REWARDS

It will ask if you would like to allow access to the camera, select **Don't Allow** or **OK** (recommended).

**You can earn bonus points by submitting pictures at the games!**

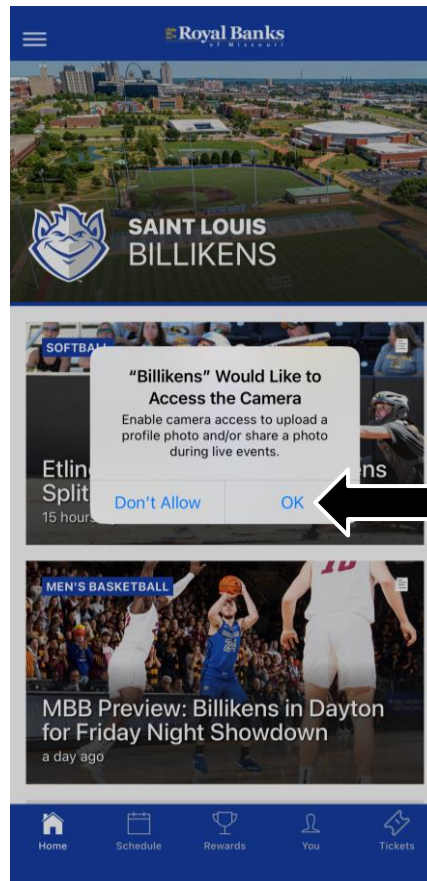



# SETTING UP BILLIKENS REWARDS

It will ask if you would like to use Bluetooth, select Don't Allow or OK (recommended)

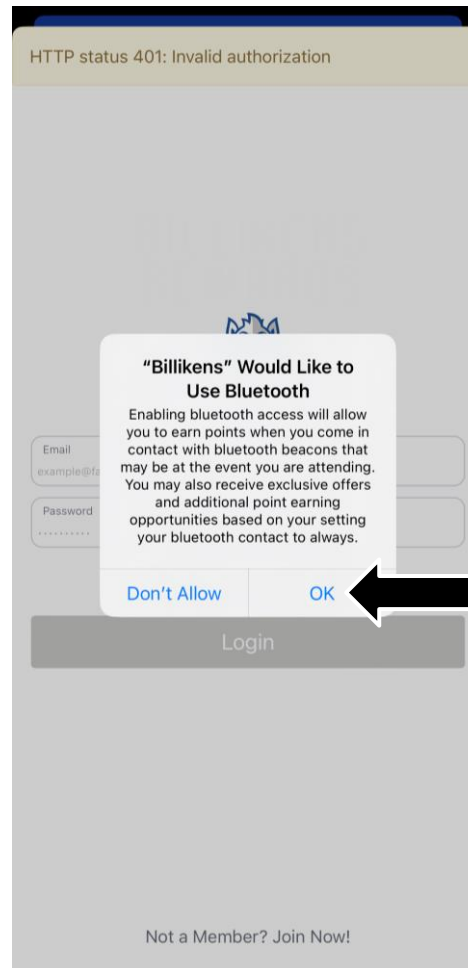

# SETTING UP BILLIKENS REWARDS

It will ask if you would like to allow your location when you are not using the app, select **Keep Only While Using** or **Change to Always Allow** (recommended)

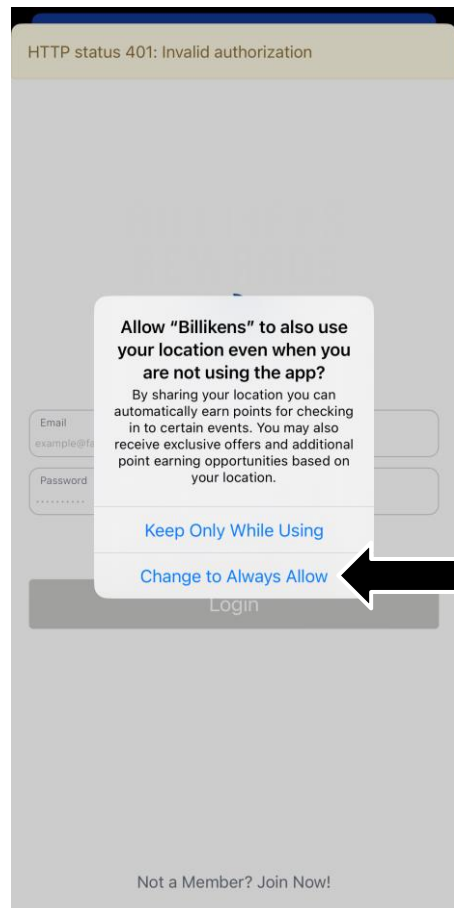

# SETTING UP BILLIKENS REWARDS

The next page will be a login screen for Billikens Rewards.

Please note that this is a separate account from the account that was created when you first downloaded the app.

HTTP status 401: Invalid authorization



Email  
example@fanmaker.com

Password  
.....

Forgot Your Password?

Login

Not a Member? [Join Now!](#)

# SETTING UP BILLIKENS REWARDS

If you are a season ticket holder, your Billiken Rewards account has been pre-created for you using your email address on file.

You should have received an email to reset your password, or you can use the “Forgot Password” function to reset your password.

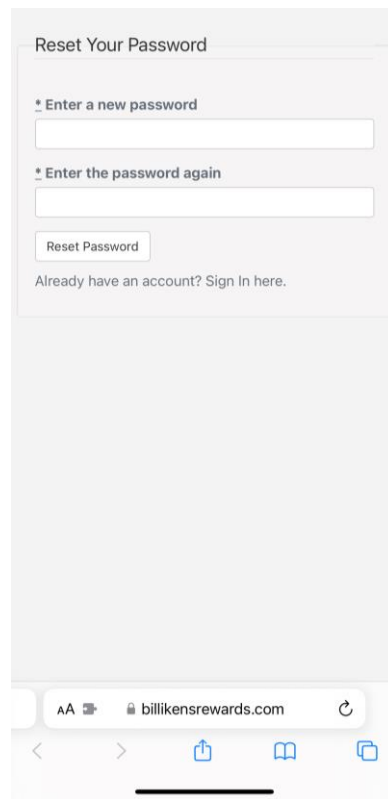

Reset Your Password

\* Enter a new password

\* Enter the password again

Reset Password

Already have an account? Sign In here.

billikensrewards.com

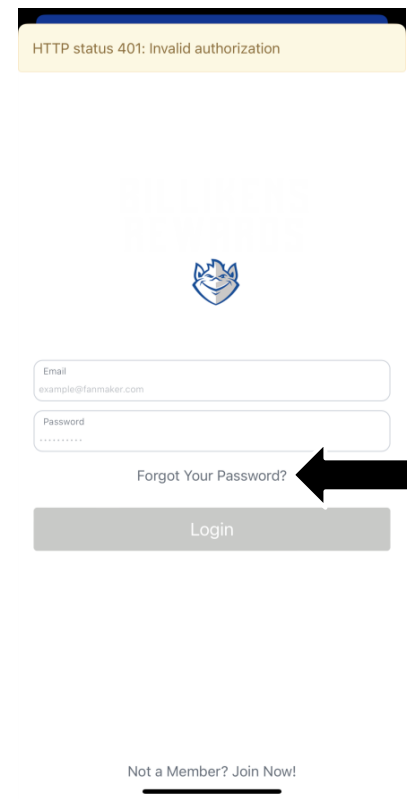

HTTP status 401: Invalid authorization



Email  
example@fanmaker.com

Password  
\*\*\*\*\*

Forgot Your Password?



Login

Not a Member? Join Now!

# SETTING UP BILLIKENS REWARDS

If you're not a season ticket holder, you will need to create an account.

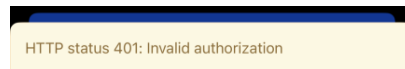
At the bottom of the screen tap “Not a Member? Join Now!” type in your email address, password (twice), select your registration tag (student, fan, or alumni), and phone number; tap continue.

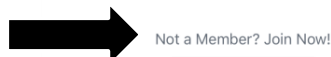
  
  
example@fanmaker.com  
  
.....  
[Forgot Your Password?](#)  
  
  
example@fanmaker.com  
  
.....  
  
.....  
  
Choose One  
  
.....  

[Not a Member? Join Now!](#)

# SETTING UP BILLIKENS REWARDS

Type in your first name and last name; tap login.

Your Billikens Rewards are set up! If you want to exit out of the rewards portion of the app, swipe down from the Billiken head at the top of the screen and you will return to the home screen of the app.



The login screen features a white background with a blue Billiken head logo centered at the top. Below the logo are two input fields: "First Name" and "Last Name". At the bottom is a grey "Login" button. A large black arrow points upwards towards the "Login" button.

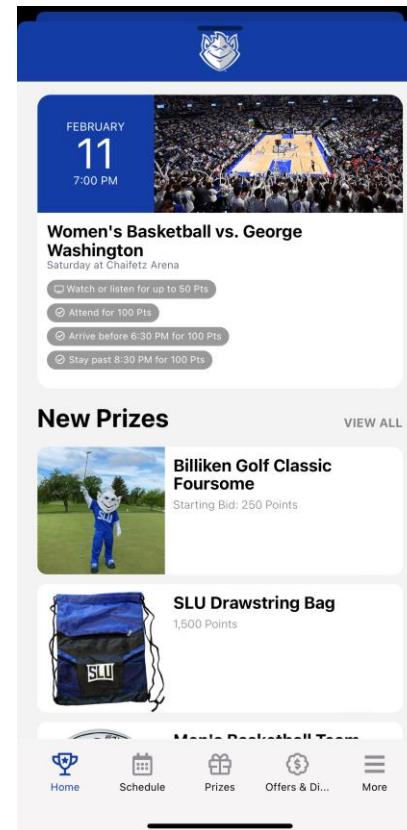

# SETTING UP YOUR TICKETMASTER ACCOUNT

Tap the “Tickets” icon in bottom menu or tap the three lines in the top left corner and select “Billikens Tickets”

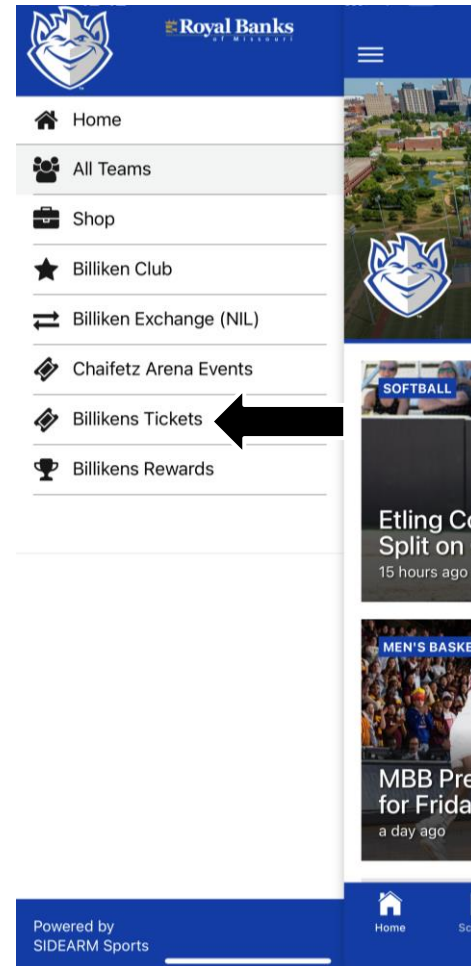
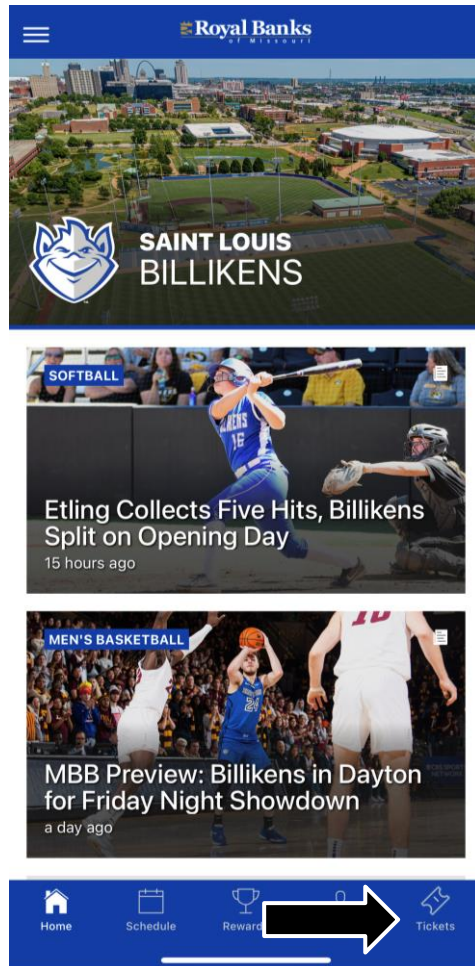



# SETTING UP YOUR TICKETMASTER ACCOUNT

Tap the “Tickets” icon in bottom menu or tap the three lines in the top left corner and select “Billikens Tickets”.

Once the tab is open, tap on the “Billikens Tickets” button.

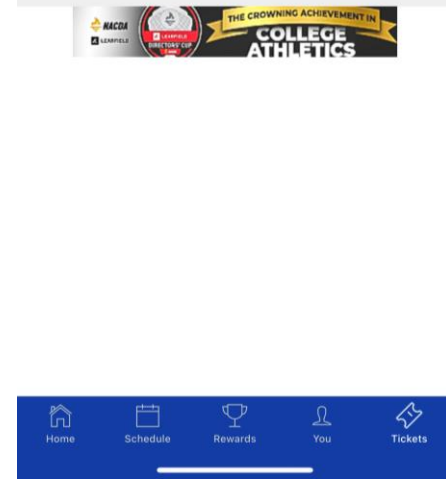
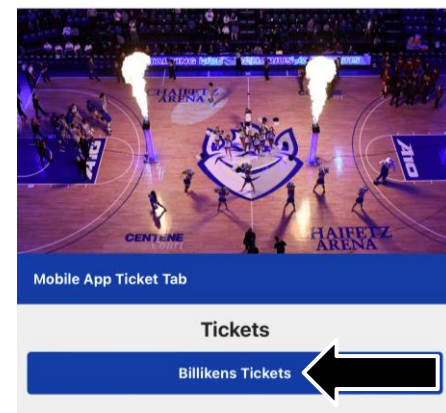
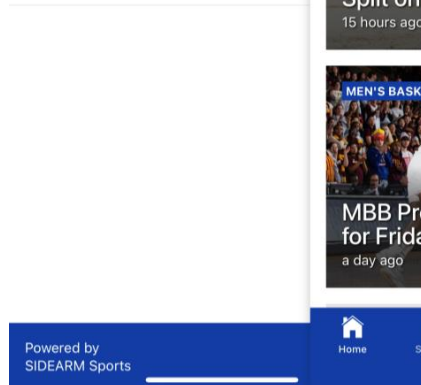
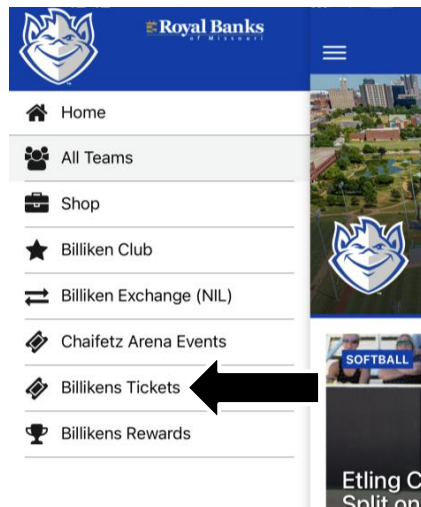

# SETTING UP YOUR TICKETMASTER ACCOUNT

It will take you to a sign in screen for Ticketmaster and ask if you want to use ticketmaster.com to sign in, tap **Continue**.

If your login information is already saved in your phone, you will be automatically logged in after you select **Continue**.

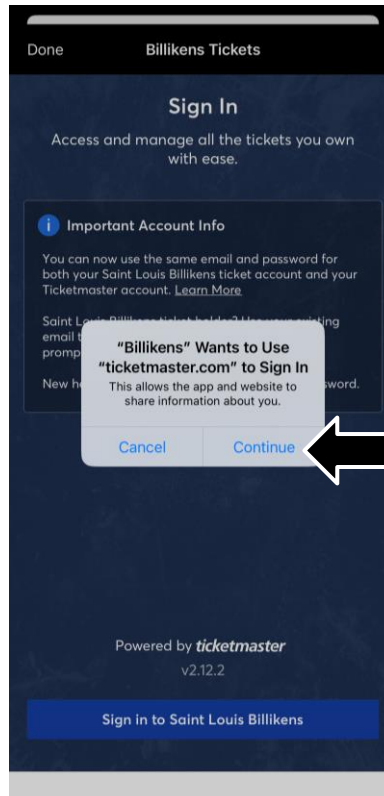

# SETTING UP YOUR TICKETMASTER ACCOUNT

If it did not automatically sign in, tap the button at the bottom that says “Sign in to Saint Louis Billikens”.

Enter your Ticketmaster account email address and password then tap Sign In

The image displays two screenshots side-by-side, illustrating the sign-in process for a Ticketmaster account.

**Left Screenshot (App Interface):** This is a mobile app screen titled "Billikens Tickets" with a "Done" button in the top left. The main heading is "Sign In" with the subtext "Access and manage all the tickets you own with ease." Below this is an "Important Account Info" section containing instructions for existing and new users. At the bottom, it says "Powered by ticketmaster v2.12.2". A large black arrow points to a blue button at the very bottom labeled "Sign in to Saint Louis Billikens".

**Right Screenshot (Web Interface):** This is a web browser screen showing the "Sign In to Saint Louis University Athletics" page, powered by Ticketmaster. It includes an "Important Account Update" notice. Below the notice are input fields for "Email Address" and "Password" (with a "SHOW" toggle). There are checkboxes for "Remember Email" and a link for "Forgot Password?". At the bottom, there is a link to the "Terms of Use" and "Privacy Policy". A large black arrow points down towards the bottom of the page, where a blue button (corresponding to the one in the app screenshot) is partially visible.

# SETTING UP YOUR TICKETMASTER ACCOUNT

**You're all set! Your tickets will appear on the screen, to use them tap on the image, and add them to your Apple Wallet or tap View Barcode to scan the tickets at Chaifetz Arena.**

