

**THIS IS  
MIZZOU**

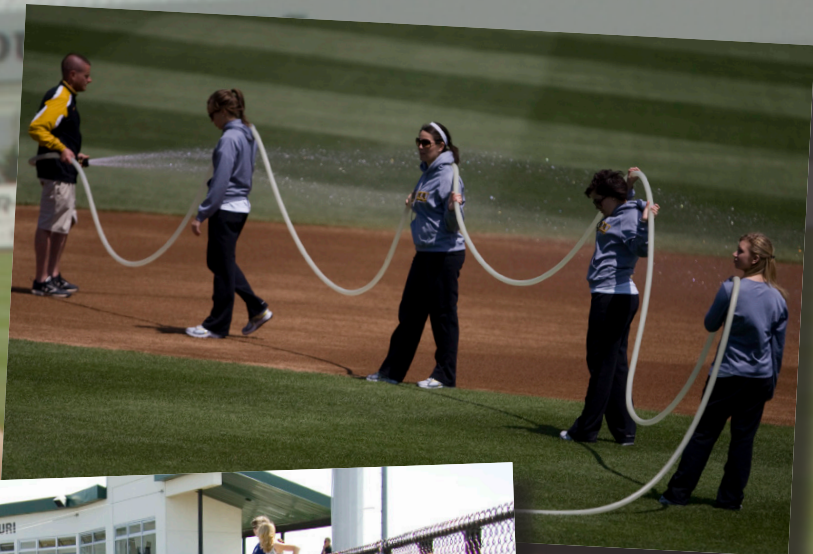

# GAMEDAY AT MIZZOU





# POSTSEASON EXCELLENCE

Missouri was one of just 14 teams in the nation that advanced to the NCAA Tournament in each season between 2003-2009. In total, the Tigers have made 20 NCAA Regional appearances.

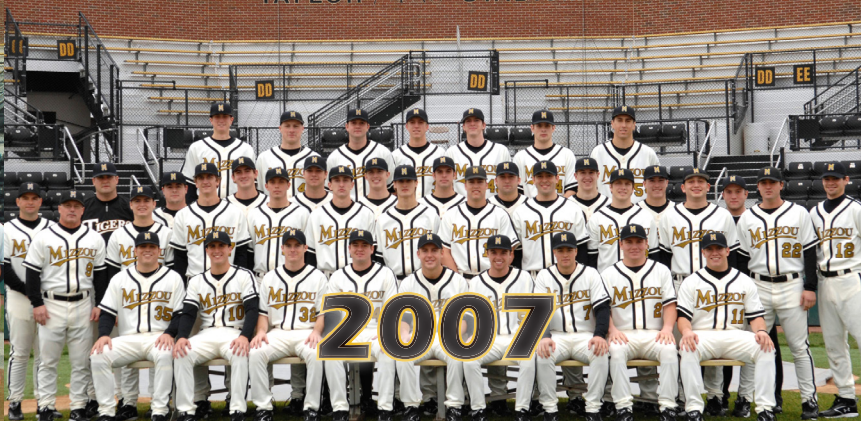
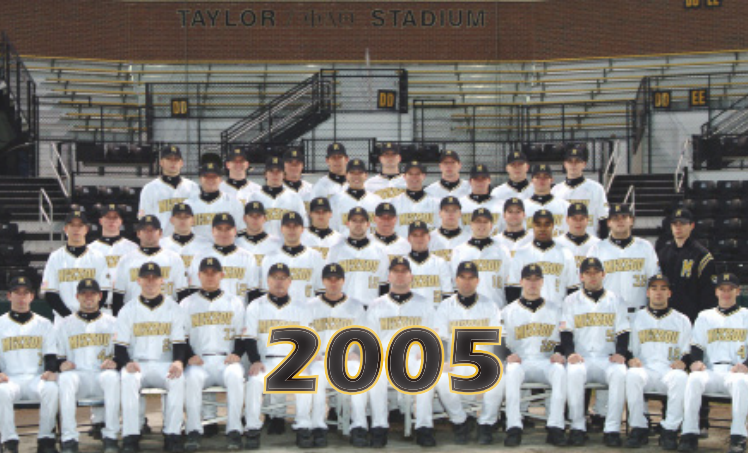



**Mizzou brought NCAA  
Tournament baseball to Columbia  
in 2007, as the Tigers hosted an  
NCAA Regional at Taylor Stadium  
for the first time in school history.**

**The Tigers won the Malibu  
Regional in 2006, advancing  
to the first NCAA Super  
Regional in MU history.**



# POSTSEASON EXCELLENCE

## 1954 NATIONAL CHAMPIONS



The 1954 NCAA Champions. Front row, from left: Bob Musgrave, George Gleason, Todd Sickel, Bob Schoonmaker, Dick Dickinson, James Doerr and Bert Beckmann. Middle row, from left: Ed Cook, Robert Beaman, Jack Gabler, Lloyd Elmore, Kent Henson, Lee Roy Wynn and S.L. Sayers. Back row, from left: Coach John "Hi" Simmons, Buddy Cox, Jerry Schoonmaker, Norm Stewart, Emil Kammer, Harold Gastineau, Eldon Morgan and trainer Ollie DeVictor.



2010 marks the 56th anniversary of Missouri's 1954 National Championship season.

That squad, under head coach John "Hi" Simmons was 22-4 on the year and claimed the Big Seven Conference Championship with a 11-1 conference record.

The Tigers were 5-1 at the College World Series. They had to come back through the losers' bracket and defeat Rollins in the championship game to claim the championship.





**In 1994, the 1954 team was inducted into the Missouri Intercollegiate Athletics Hall of Fame.**

**In February of 2004, the 1954 team earned another honor as it was inducted into the Missouri Sports Hall of Fame, located in Springfield, Mo.**



**In 2006, the Omaha World-Herald released a list of the top 25 College World Series programs of all-time. Missouri was No. 16 on the list. The World-Herald had this to say about Missouri:**

*"Under Simmons, Mizzou was a force in the early years of the CWS. The Tigers' .621 winning percentage still ranks fifth all-time. Missouri fell one win short of titles in 1952, 1958 and 1964, and also finished third in 1963."*

## **1954 COLLEGE WORLD SERIES**

Michigan State 16  
Massachusetts 3

Arizona 12  
Oregon 1

Rollins 9  
Oklahoma State 5 (11 innings)

**Missouri 5  
Lafayette 3**

Massachusetts 5  
Oregon 3

Oklahoma State 4  
Lafayette 2

Michigan St. 2  
Arizona 1

**Rollins 4  
Missouri 1**

**Missouri 8  
Massachusetts 1**

Oklahoma State 5  
Arizona 4 (14 innings)

Rollins 5  
Michigan State 4

**Missouri 7  
Oklahoma State 3**

Michigan State 3  
Rollins 2 (10 innings)

**Missouri 4  
Michigan State 3**

**Championship Game:  
Missouri 4, Rollins 1  
Missouri wins 1954 NCAA title**

# TAYLOR STADIUM



**The University of Missouri Baseball team broke in the millennium with a new \$2.1 million home. The stadium was the final major project on the west grounds of the Sports Park at Mizzou.**

**The facility, officially named Ralph and Debbie Taylor/ Phi Delta Theta Stadium at Simmons Field (or Taylor Stadium at Simmons Field), was constructed to accomplish a variety of goals set by the baseball coaching staff and MU's Department of Athletics. The ultimate goal in the construction of the stadium was to create a fan-friendly facility and to encourage a family ballpark atmosphere.**

**The stadium boosted seating capacity and allowed fans to enjoy many features, including a better view of the playing field, an expanded concession area and improved restroom facilities. The stadium even cut down the amount of wind that reaches patrons and provided them with some of the most-relaxing and satisfying experiences in all of Big 12 Conference baseball.**

**Another goal was to create an aesthetically pleasing facility. The stadium is composed of red bricks, green metal roofs and black steel, along with block and drivit – the look of traditional American baseball stadium. The look also accompanies the look of other recently built MU athletic facilities.**

**Finally, Taylor Stadium was designed to be able to host an NCAA Regional, which the Tigers did in 2007 in the first NCAA postseason action at MU since 1965.**

**Taylor Stadium at Simmons Field, contracted by Crawford Construction Inc. and designed by Peckham & Wright Architects Inc., became a reality after Ralph and Debbie Taylor of Prairie Village, Kan., presented a gift of \$1 million to the University in 1998 to spark funding for the project, which broke ground in June, 1999. Ralph Taylor, an MU alumnus, has a long-standing relationship with the University and its athletic department.**



# ***THE NEW TAYLOR STADIUM***

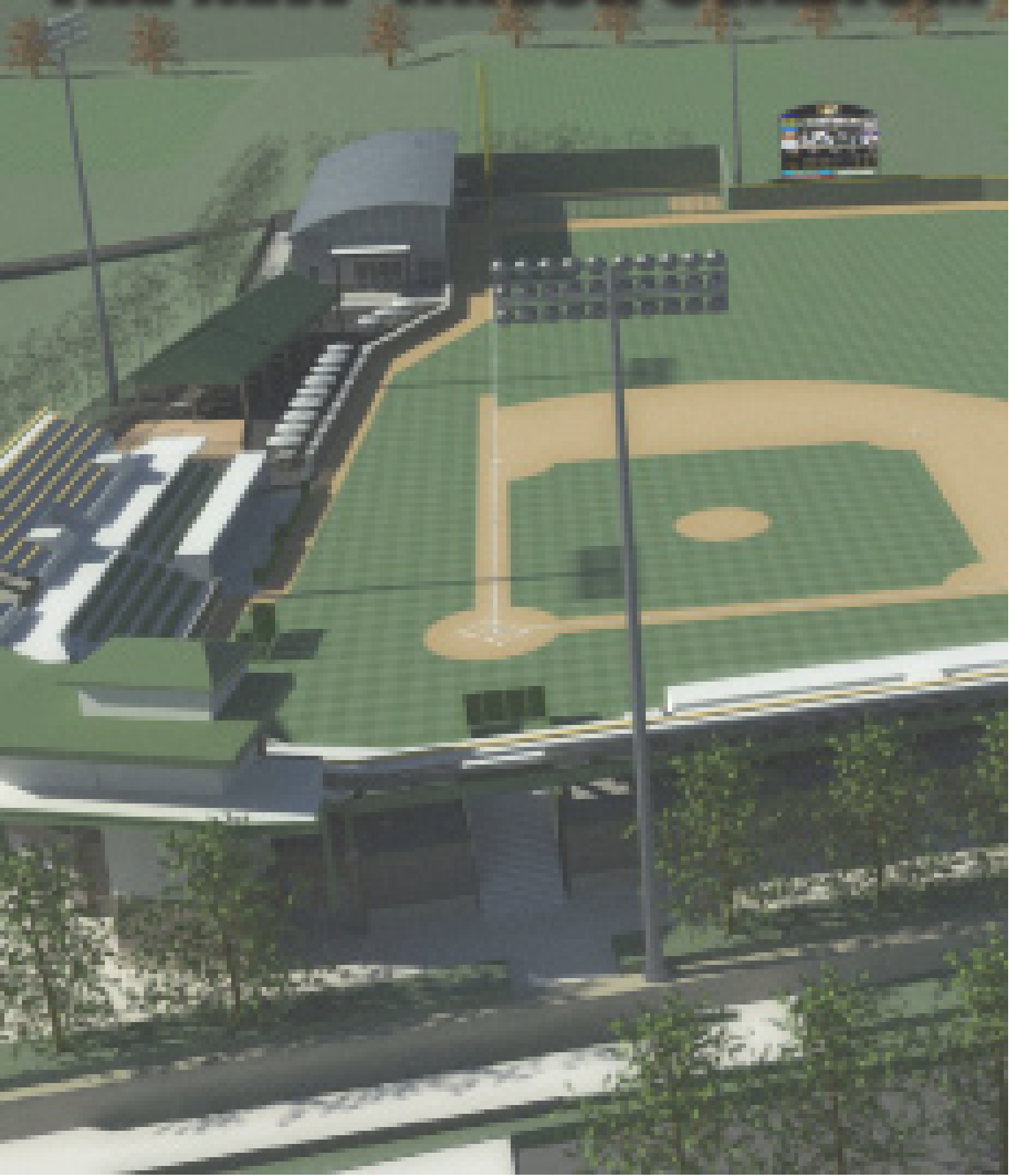



**Taylor Stadium took on a new look in 2010. The left field line received the majority of the work in phase one of the stadium's makeover as The McArtor Baseball Facility (pictured below) opened. The addition includes indoor/outdoor batting cages and pitching lanes.**

**In addition, a new brick wall was installed that spans foul territory. Also, a new scoreboard/video board has been added that will enhance the gameday experience. Future plans include a new clubhouse for the Tigers and new offices for the coaches. Those features will be added down the left field line. Plans are also in the place to extend seating down the right field line in the future.**



# SPORTS PARK AT MIZZOU

**Tiger athletes train and compete in some of the finest athletic facilities in the country. A construction boom in the last seven years has seen the birth of the Sports Park at Mizzou.**

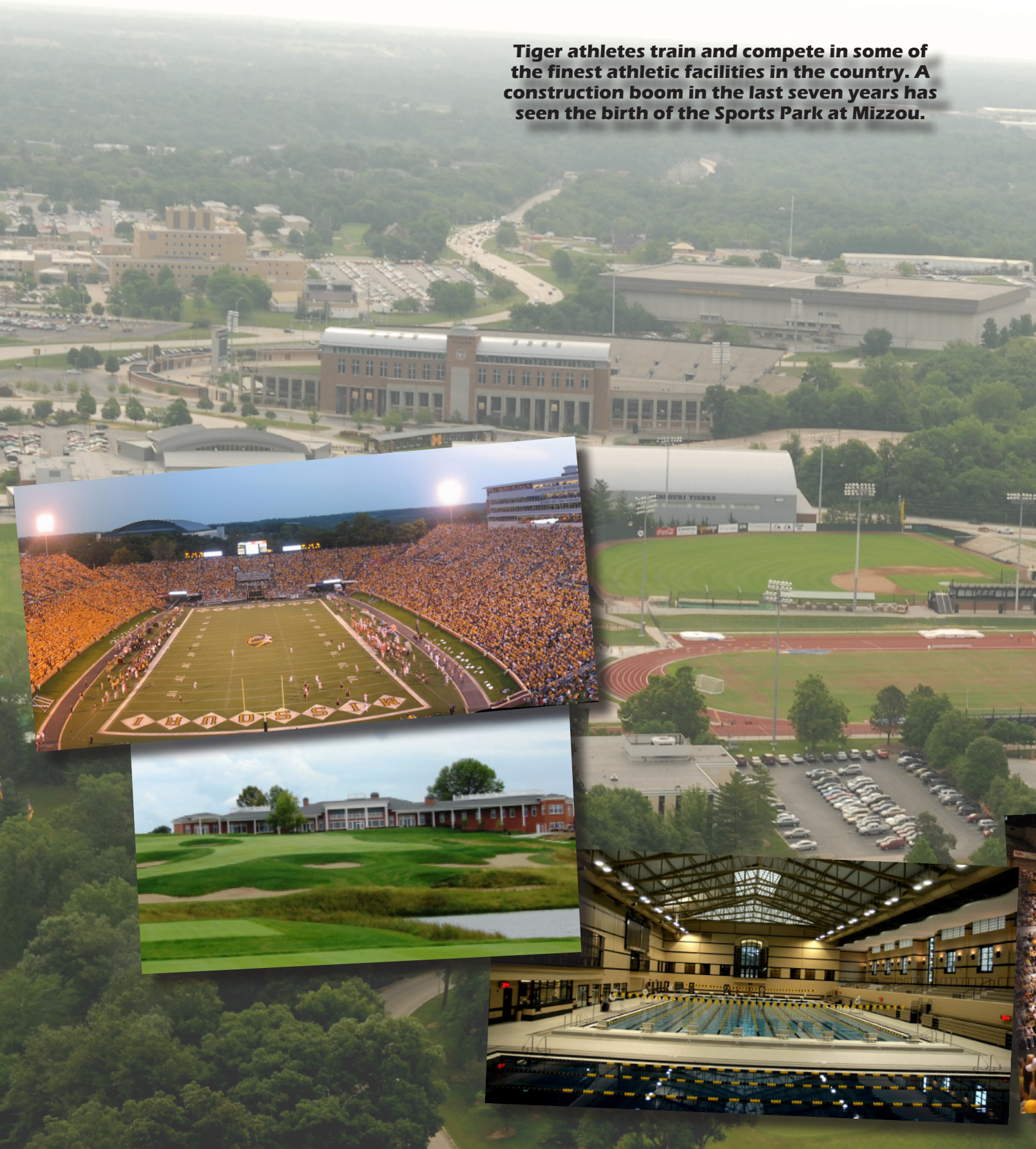



# MIZZOU ATHLETICS TRAINING



# G COMPLEX

**Opening in 2006, the Missouri Athletics Training Complex transformed the Tom Taylor Building into one of the top comprehensive centers in the nation. The "MATC" houses the Yeckel Strength & Conditioning Center, the McElroy Sports Medicine Center, the Sells Dining Hall, the Shelden Academic Resource Center along with locker rooms and coaches offices.**



# STRENGTH & CONDITIONING

MISSOURI



The cornerstone of the Mizzou Athletics Training Complex is the two-story strength and conditioning complex, which features approximately 14,200-square feet of space. The balcony level is contains cardiovascular equipment, overlooking the strength training area below.

URI TIGERS

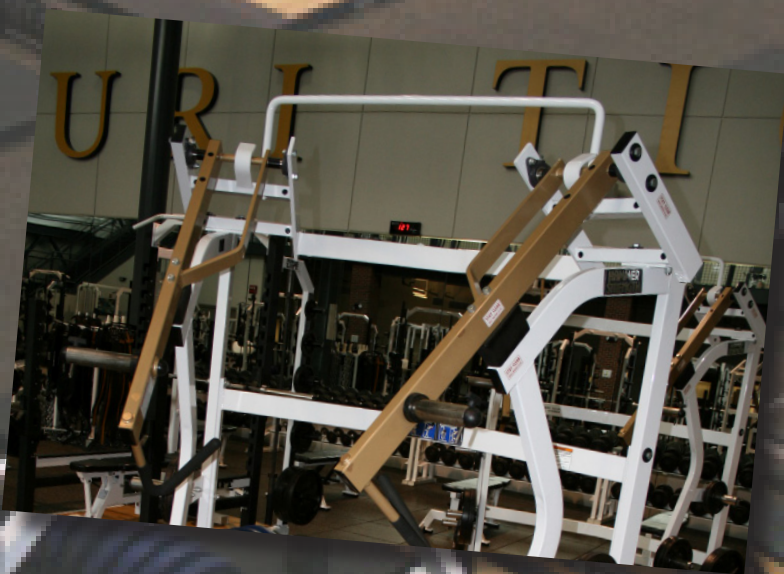

# SPORTS MEDICINE



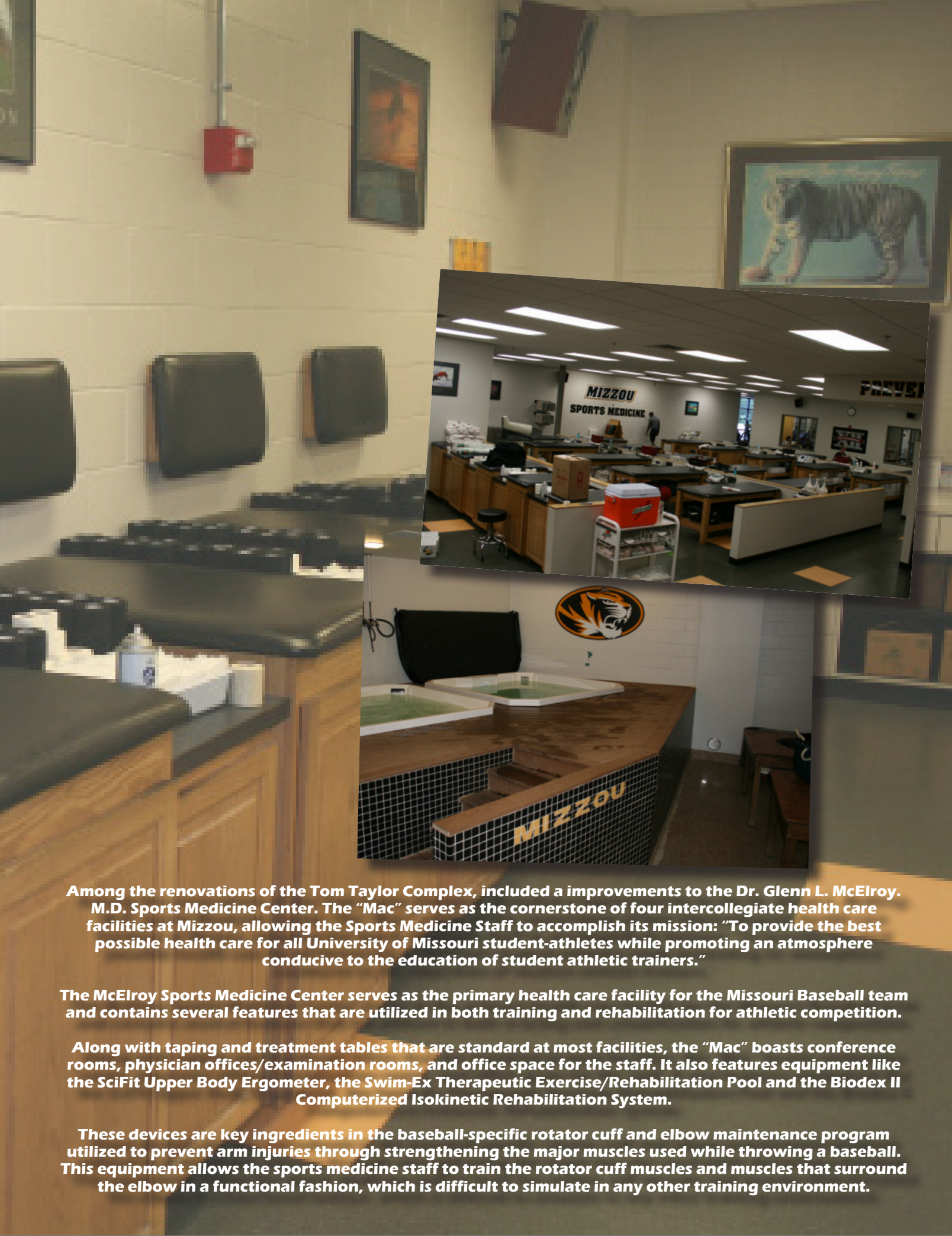

**Among the renovations of the Tom Taylor Complex, included a improvements to the Dr. Glenn L. McElroy. M.D. Sports Medicine Center. The “Mac” serves as the cornerstone of four intercollegiate health care facilities at Mizzou, allowing the Sports Medicine Staff to accomplish its mission: “To provide the best possible health care for all University of Missouri student-athletes while promoting an atmosphere conducive to the education of student athletic trainers.”**

**The McElroy Sports Medicine Center serves as the primary health care facility for the Missouri Baseball team and contains several features that are utilized in both training and rehabilitation for athletic competition.**

**Along with taping and treatment tables that are standard at most facilities, the “Mac” boasts conference rooms, physician offices/examination rooms, and office space for the staff. It also features equipment like the SciFit Upper Body Ergometer, the Swim-Ex Therapeutic Exercise/Rehabilitation Pool and the Biodex II Computerized Isokinetic Rehabilitation System.**

**These devices are key ingredients in the baseball-specific rotator cuff and elbow maintenance program utilized to prevent arm injuries through strengthening the major muscles used while throwing a baseball. This equipment allows the sports medicine staff to train the rotator cuff muscles and muscles that surround the elbow in a functional fashion, which is difficult to simulate in any other training environment.**

# DAN DEVINE PAVILION



**The Daniel J. Devine Pavilion, located immediately south of the Mizzou Athletics Training Complex and behind the right field wall of Taylor Stadium/Simmons Field, provides Tiger Athletics with an indoor practice facility, featuring a 90-yard field, two permanent batting cages and two removable batting cages. The size and versatility of the facility allows more than one team to use it at a time as the football team can run drills at one end while the baseball team can hit in the batting cage at the other.**

**In 2007, FieldTurf was installed replacing the Astroturf that was in place.**

**The Devine Pavilion was completed in May, 1998. In addition to being the home of the Tigers' winter workouts for all sports, camps have been held in the building.**

**The Devine Pavilion includes an observation viewing area as well as men's and women's restrooms. It also provides the Tiger Equipment and Maintenance staff with storage space.**

**The Tiger Baseball team uses the facility when faced with inclement weather. Various drills and even practice games can be played in the Devine Pavilion. Missouri also uses it for various strength and conditioning workouts.**



# TOTAL PERSON PROGRAM

## ACADEMIC ALL-AMERICA

1986	Nick Rallo
1991	Phil Neff
1992	John Hay
1994	Grant Ingram
1995	Brian Jorgensen
1996	Steve Brewster
1997	Ryan Fry
	Aaron Jaworowski
1998	Ryan Fry
	Griffin Moore
2004	Garrett Broshuis



**The University of Missouri Department of Athletics is committed to success of the student-athletes both on the field as well as off it. Since 1986, Missouri has had in place the Total Person Program which focuses on the total development of the student-athlete. The program has been so successful that other universities have created similar programs using Mizzou as a model.**

**The Total Person Program demonstrates the University's dedication to developing the student-athlete intellectually, socially and emotionally, as well as physically. Mizzou cares about the pressures and special needs of student-athletes, and the Total Person Program provides assistance and support.**

**There are several services that are offered as part of the program including academic counseling and assistance, academic progress monitoring and substance abuse and psychological counseling. The academic counseling and assistance offers help with academic program development, tutorial assistance, study skills development and career planning.**

**The program focuses heavily on the freshman year in order to provide the student-athletes with the greatest opportunity for academic success. A comprehensive student-athlete orientation ensures that freshman begin their first semester with confidence.**



### ACADEMIC ALL-CONFERENCE

1982	Cary Eades, OF Greg Larsen, P	Keith Massa, P Jeff Terrell, 2B					
1983	Dave Otto, P/DH Nick Rallo, INF	1997	Ryan Fry, OF Aaron Jaworowski, 1B	2006	Hunter Mense, OF Travis Wendte, RHP Trevor Helms, 2B Nathan Culp, LHP Max Scherzer, RHP		
1984	Dave Otto, P/DH Russ Perkins, OF Nick Rallo, INF		Griffin Moore, INF Jeff Terrell, OF		Jacob Priday, OF/DH Dan Pietroburgo, C Brant Combs, LHP Nick Admire, RHP John McKee, 3B		
1985	Dave Otto, P/DH Russ Perkins, OF Nick Rallo, INF	1998	Ryan Fry, OF Griffin Moore, INF Mike Ketelsen, OF Nick Wilfong, OF	2007	Dan Pietroburgo, C Jacob Priday, OF/DH Gary Arndt, SS John McKee, 1B Brant Combs, RHP Rick Zagone, LHP		
1986	Russ Perkins, OF Nick Rallo, INF Mike Rogers, 1B		Nick Schwieder, C Jason Williams, SS Mick Weiss, INF		2008	Jacob Priday, OF/DH Dan Pietroburgo, C/1B Trevor Coleman, C Aaron Senne, OF Kurt Calvert, OF Scooter Hicks, LHP	
1987	Mike Rogers, 1B	1999	Mike Ketelsen, OF Nick Wilfong, OF Ryan Stegall, SS		2009	Kyle Mach, INF Scooter Hicks, LHP Trevor Coleman, C Kyle Gibson, RHP Aaron Senne, OF Ryan Ampleman, C Nick Tepesch, RHP Andrew Thigpen, INF Kelly Fick, LHP Phil McCormick, LHP	
1988	Jon Pittenger, 3B Steve Powers, P		2000	Logan Dale, P Ryan Pickett, C Mike Rallo, INF Mick Weiss, INF		2010	Aaron Seene, INF Phil McCormick, LHP Ryan Ampleman, C Russell LaFleur, OF Andreas Plackis, C Nick Tepesch, RHP Andrew Thigpen, INF Ryan Clubb, RHP
1989	Chuck Fletcher, P Bunky Moeller, P Chuck Fletcher, P Chuck Fletcher, P	2001	Mark Alexander, P Logan Dale, P Drew Endicott, P Tony Vitello, INF Mick Weiss, INF				
1990	John Hay, C Phil Neff, 3B		2002	Garrett Broshuis, P Drew Endicott, P Tony Vitello, INF Garrett Broshuis, P			
1991	John Hay, C Grant Ingram, OF Steve Ball, OF John Hay, C	2003	Travis Wendte, P Garrett Broshuis, P Mark Alexander, P Ryan Rallo, OF				
1992	Grant Ingram, DH Keith Massa, P Chris Robertson, P		2004	James Boone, OF Taylor Parker, P			
1993	Steve Ball, OF Grant Ingram, DH Keith Massa, P Chris Robertson, P Jerry Vansell, P	2005	James Boone, OF Travis Wendte, P Cosme Caballero, C Max Scherzer, P Nathan Culp, P Travoer Helms, INF John McKee, 3B				
1994	John Hay, C Grant Ingram, OF Steve Ball, OF John Hay, C						
1995	Grant Ingram, DH Keith Massa, P Chris Robertson, P Jerry Vansell, P Jake Filip, DH Aaron Jaworowski, 1B Brian Jorgensen, 3B Jerry Vansell, P						
1996	Steve Brewster, P Mike Haverty, P Aaron Jaworowski, 1B Brian Jorgensen, 3B						

# UNIVERSITY OF MISSOURI



**For its innovative approach and commitment to providing a well-rounded undergraduate education, Missouri is one of only 13 universities, and the only Big 12 school, to be honored with the nationally respected Theodore M. Hesburgh award.**

**MU is one of only 34 public U.S. universities, and the only public institution in Missouri to be selected for membership in the Association of American Universities and designated Doctoral/Research Extensive by the Carnegie Foundation for the Advancement of Teaching.**

**Missouri is one of only five universities in the country with schools of medicine, law and veterinary medicine all on one campus.**

**MU offers more than 250 degree programs through 20 colleges and schools, including online degrees, an extensive evening program and lifespan learning courses for those over the age of 50.**

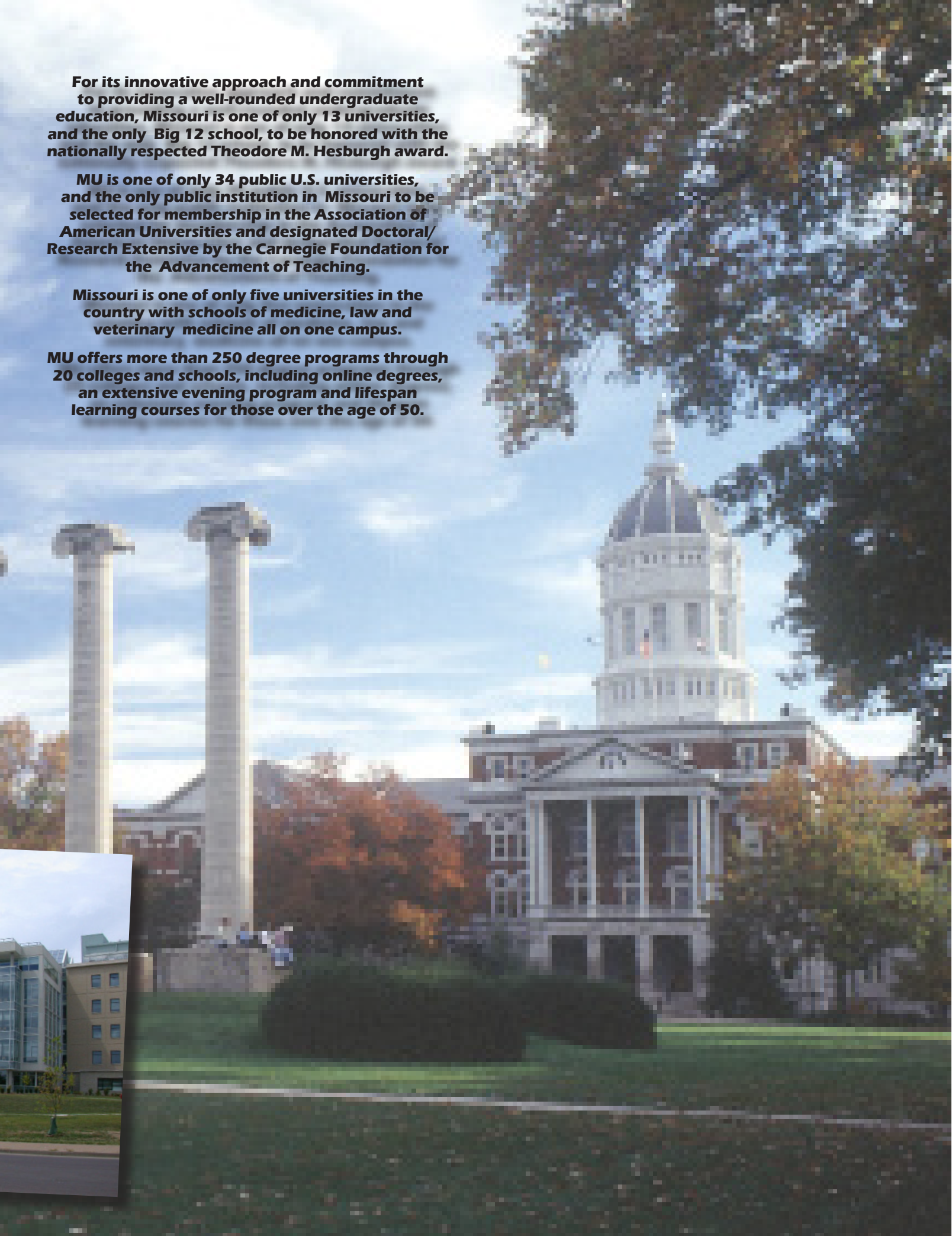

# COLUMBIA, MO.

**For the person who likes to do it all, Columbia is the place you want to be the quintessential college town, Columbia has recently been ranked among the top 10 cities to live, according to Money Magazine.**

**Columbia has also been named among the "Best Places to Live" by Forbes magazine and Men's Journal in recent years. Columbia is known for its variety of fine, unusual and popular restaurants.**

**In warm months, outdoor dining and entertainment is available at many locations. Columbia's nightlife offers all kinds of entertainment as well. .**





# MID-MISSOURI

Columbia is located in the center of the state, two hours from both Kansas City and St. Louis and sits just north of Jefferson City, the Missouri state capital, and the famed Lake of the Ozarks.

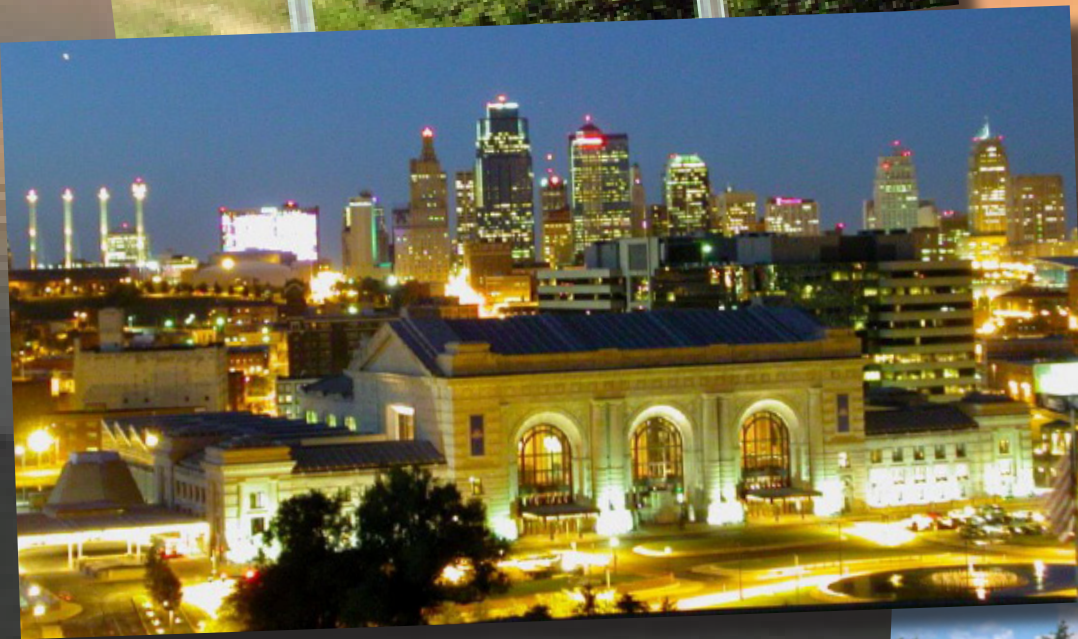

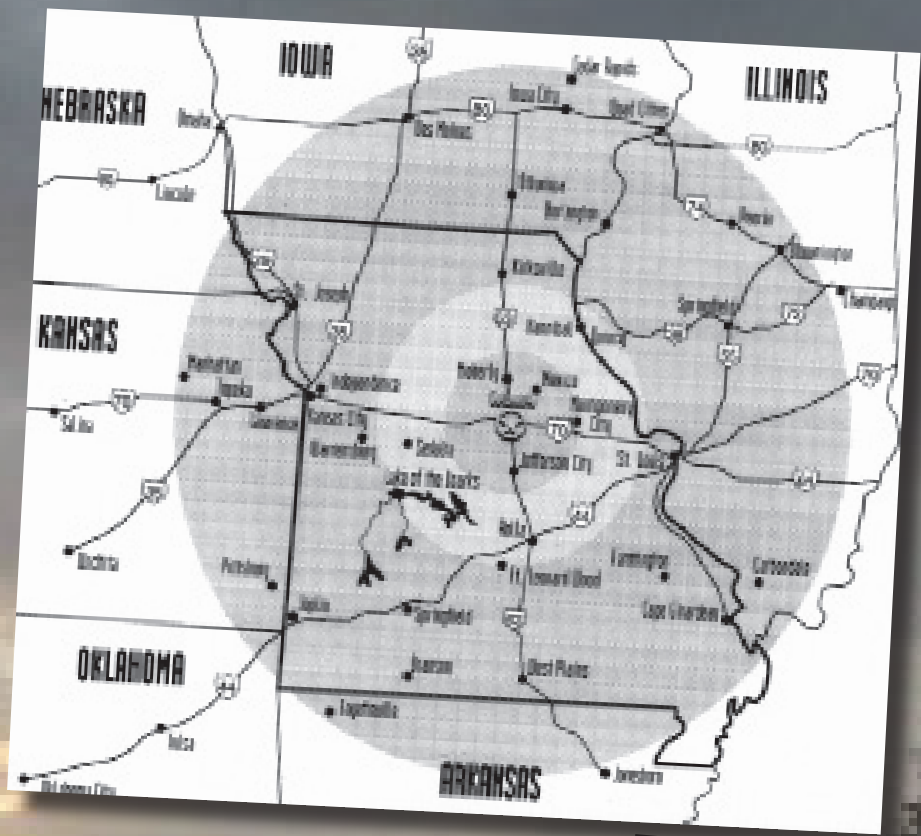

**DISTANCE FROM COLUMBIA TO:**

Jefferson City, Mo.	26 miles
Lake of the Ozarks	75 miles
Truman Lake	96 miles
St. Louis, Mo.	120 miles
Kansas City, Mo.	125 miles
Springfield, Mo.	169 miles
Branson, Mo.	205 miles
Des Moines, Iowa	313 miles
Omaha, Neb.	319 miles
Tulsa Okla.	348 miles
Memphis, Tenn.	398 miles
Chicago, Ill.	411 miles





## BASEBALL

### TOP STORIES

### MIZZOU NETWORK

### CALENDAR



BUY



### MIZZOU STORE

Missouri "M" Baseball Style #2 Hat

\$19.99



### QUICK LINKS

#### MIZZOU BASEBALL

- [Ticket Information](#)
- [Head Coach Tim Jamieson](#)
- [Taylor Stadium/ Simmons Field](#)
- [Join the Tiger Bullpen](#)
- [2011 Statistics](#)
- [Weekly Media Notes](#)

#### WELCOME RECRUITS!

- [Welcome to Mizzou](#)
- [Baseball Recruiting Questionnaire](#)
- [Taylor Stadium](#)
- [Mizzou Athletics Training Complex](#)
- [Admissions](#)
- [Financial Aid](#)
- [NCAA Rules](#)
- [Virtual Campus Tour](#)
- [University of Missouri Website](#)
- [Travel Center](#)
- [360 Columbia](#)

#### 2011 MEDIA GUIDE

- [Viewer-Friendly Version](#)
- [Printer-Friendly Version](#)

#### FIRST PITCH CELEBRATION

- [February 4, 2012](#)
- [Event Information](#)

#### MISSOURI BASEBALL CAMPS

### Winter Camp Info - Spots Open Until First Day

10/28/2011 - BASEBALL

[2011 Winter Camp Info](#) [READ MORE](#)



SHOP NOW  
**BUY TICKETS**

TEXT TIGERS TO 51234  
**MOBILE ALERTS**

# muzzoutigers.com

*The Official Web Page of the  
University of Missouri  
Department of Athletics*