



K-STATE ATHLETICS FACILITY MASTER PLAN

I would like to start by thanking each and every one of our donors for their continued support of K-State Athletics and our 450-plus student-athletes. K-State Athletics has seen tremendous growth over the past decade and our goal is to continue that path athletically, financially and academically. As I have traveled throughout the state of Kansas, the Midwest, and across the country, I am constantly asked about our facilities and “What’s Next?”. This past fall we were excited to release our facilities master plan that provides a vision into the future of K-State’s athletics facilities.

After receiving feedback from our coaches, staff, administration and fans, we are moving forward with this bold initiative, which will include four facilities: the South End Zone of Bill Snyder Family Stadium, Football Indoor Practice Facility, Volleyball Arena and Olympic Training Center. This capital initiative will be the largest in K-State Athletics history, totaling more than \$100 million in improvements. Inside this brochure are details on how these facility upgrades will be instrumental in the success of our student-athletes, in addition to improving upon the fan experience for football, men’s and women’s basketball and volleyball.

The growth of K-State Athletics starts with the support of our programs through the generous support from our loyal donors. This initiative will enhance the experience of our student-athletes and allow our athletes to compete and represent the community at the highest level possible. It will take all of K-State Nation to rise up and support this historic initiative as we look to transform K-State Athletics and build upon the success that we have achieved together.



Gene Taylor
Athletics Director



A HISTORY OF EXCELLENCE

THANKS TO THE GENEROSITY FROM LOYAL K-STATE SUPPORTERS,
WE HAVE IMPACTED THE LIVES OF K-STATE STUDENT-ATHLETES.



2012 - \$18M
Ice Family Basketball Center



2013 - \$2.7M
Intercollegiate Rowing Center



2013 - \$90M
West Stadium Center

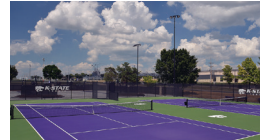

2013 - \$3.5M
Mike Goss Tennis Stadium



2015 - \$68M
Vanier Family Football Complex



2016 - \$15M
Northeast Connector



2017 - \$1.5M
Limestone Field Wall



2018 - \$4M
R.V. Christian Track



2019 - \$12.5M
Buser Family Park

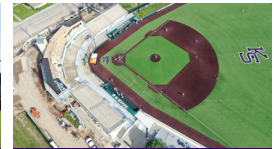

2020 - \$12.5M
Tointon Family Stadium

A HISTORY OF CAPITAL GIVING SINCE 2010

45 COMMITMENTS

\$1M+

ONLY 4 GIFTS
OF \$1M+ PRIOR
TO 2010

**FISCALLY
RESPONSIBLE**

NO UNIVERSITY,
CITY OR STATE
FUNDING

SINCE 2010

185

6+ FIGURE
COMMITMENTS

47

DONORS

HAVE GIVEN A
6-FIGURE+ GIFT
TO 2 OR MORE
PROJECTS

\$176M

OF TOTAL
GIVING TO THE
AHEARN FUND

676

GIFTS OF
\$10,000+

439 TOTAL
DONORS ACROSS

25
STATES

PROJECTED TIMELINE

5.11.2018	TOINTON FAMILY STADIUM GROUNDBREAKING
9.7.2018	MASTER PLAN UNVEILING
10.12.2018	BUSER FAMILY PARK GROUNDBREAKING
11.1.2018	R.V. CHRISTIAN TRACK COMPLETE
9.7.2019	BUILDING CHAMPIONS ANNOUNCEMENT
SUMMER 2020	SOUTH END ZONE CONSTRUCTION
FALL 2020	SOUTH END ZONE SEAT SALES
SUMMER 2021	SOUTH END ZONE COMPLETE
TBD	CONTINGENT ON FUNDING Football Indoor Practice Facility, Volleyball Arena and Olympic Training Center

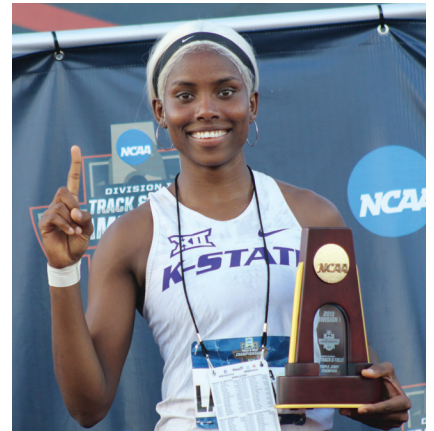

**\$50M SOUTH END ZONE
PLUS BRAMLAGE CONCOURSE ENHANCEMENTS**

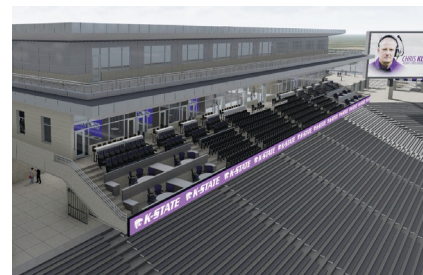



- ### SOUTH END ZONE UPGRADES
- Covered concourse for the south end zone of the stadium
 - Shorter concession lines with 24 new points of sale
 - 2,800 SF of new restroom space
 - Two new 68' x 39' video boards in the SE and SW corners
 - Distributed sound system throughout the stadium
 - Enhanced NE and NW Bramlage entrances

FAN AMENITIES

UPGRADED SOUTH END ZONE & BRAMLAGE FAN EXPERIENCE

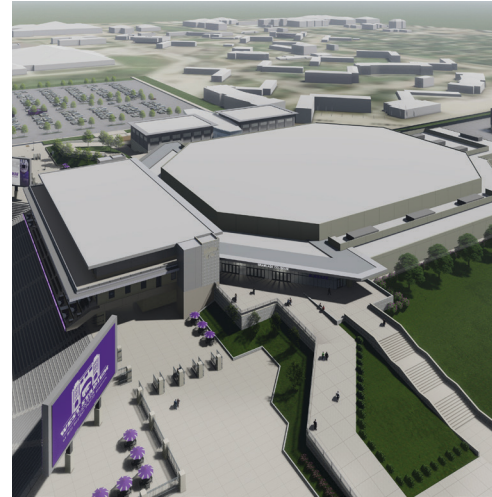

SOUTH END ZONE UPGRADES

- New south end zone premium seating includes:
 - 10 suites
 - 8 loge boxes
 - 300 club seats
- 4,500 SF of expanded Bramlage Coliseum concourse
- 13,500 SF club space which is 7x larger than the current Legends Room
- New full service kitchen and bar with 12 points of sale for football and basketball



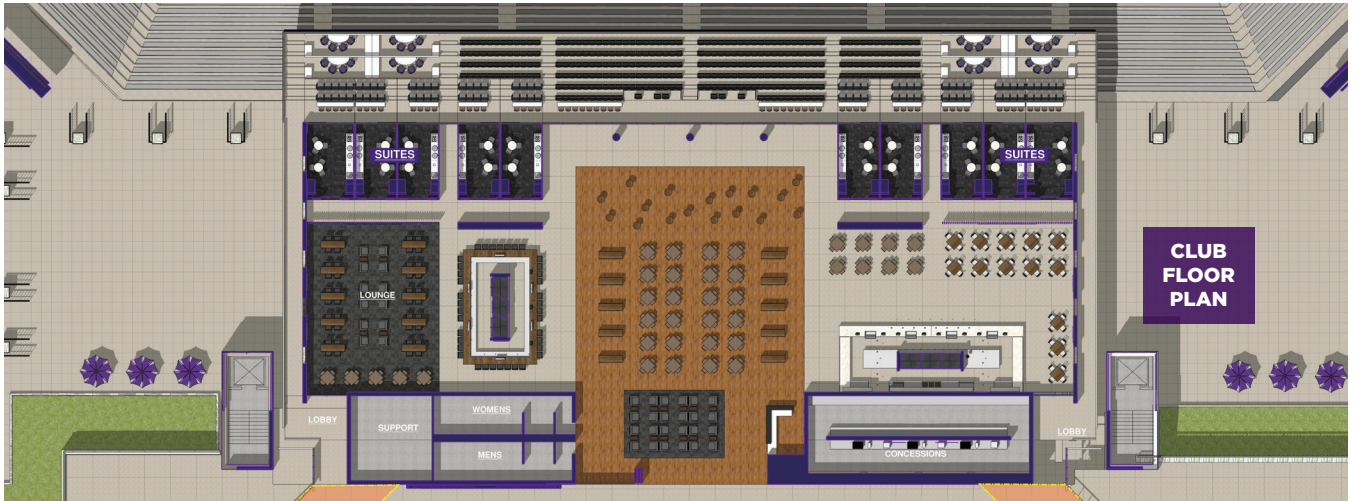

\$24.5M

FOOTBALL

INDOOR PRACTICE FACILITY





HIGHLIGHTS

- Full outdoor grass practice field
- 200' x 400' indoor practice facility with 65' roof clearance
- Indoor 130-yard practice field
- Accessible to Vanier Family Football Complex and Bill Snyder Family Stadium
- Limestone exterior to match stadium and campus architecture

\$17.5M
VOLLEYBALL
ARENA





HIGHLIGHTS

- Capacity 3,500
- 2 practice courts with retractable seating
- 2 video boards
- Restrooms and concessions located on both levels
- Team meeting rooms, locker room, team theatre and lounge
- Coaching staff offices, conference room and staff locker room



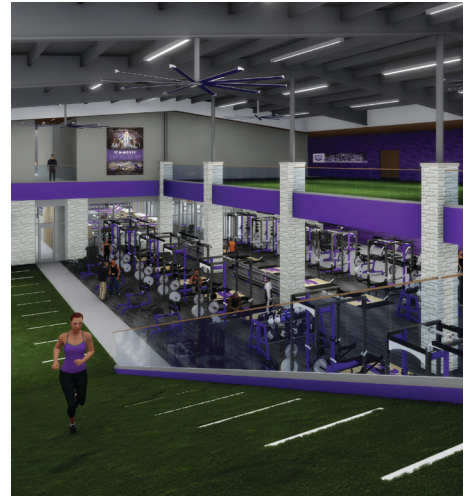

HIGHLIGHTS

- Serves 12 of the 16 sports
- 14,000 SF strength and conditioning center
- 8,000 SF second level multi-use turf area
- Sports medicine rehab space
- Hydrotherapy recovery area
- Nutrition and refueling station
- Plyometric ramp
- Athletic trainer and strength coach offices

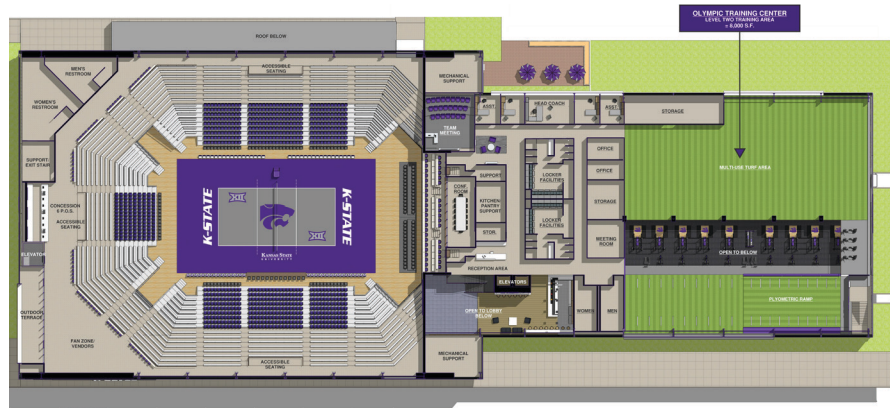

FLOOR 2



FLOOR 1

AHEARN FUND

BE A PART OF POWERING K-STATE EXCELLENCE
KSTATESPORTS.COM/BUILDINGCHAMPIONS

**WAYS
TO GIVE**



**AHEARN
FUND**.COM



888.232.9074
785.532.5282



1800 College Ave.
Manhattan, KS 66502