

GEORGE MASON  
UNIVERSITY  
Department of Intercollegiate Athletics



2016-2017  
Visiting Team Guide

*Men's and Women's Soccer, Baseball, Lacrosse, Softball*

# Table of Contents

George Mason Game Operations Contacts.....	3
Visiting Team Information.....	4
Athletic Training Information.....	6
Hotels .....	7
Restaurants.....	9
Bus Transportation.....	10
Directions to Field House/Map.....	12

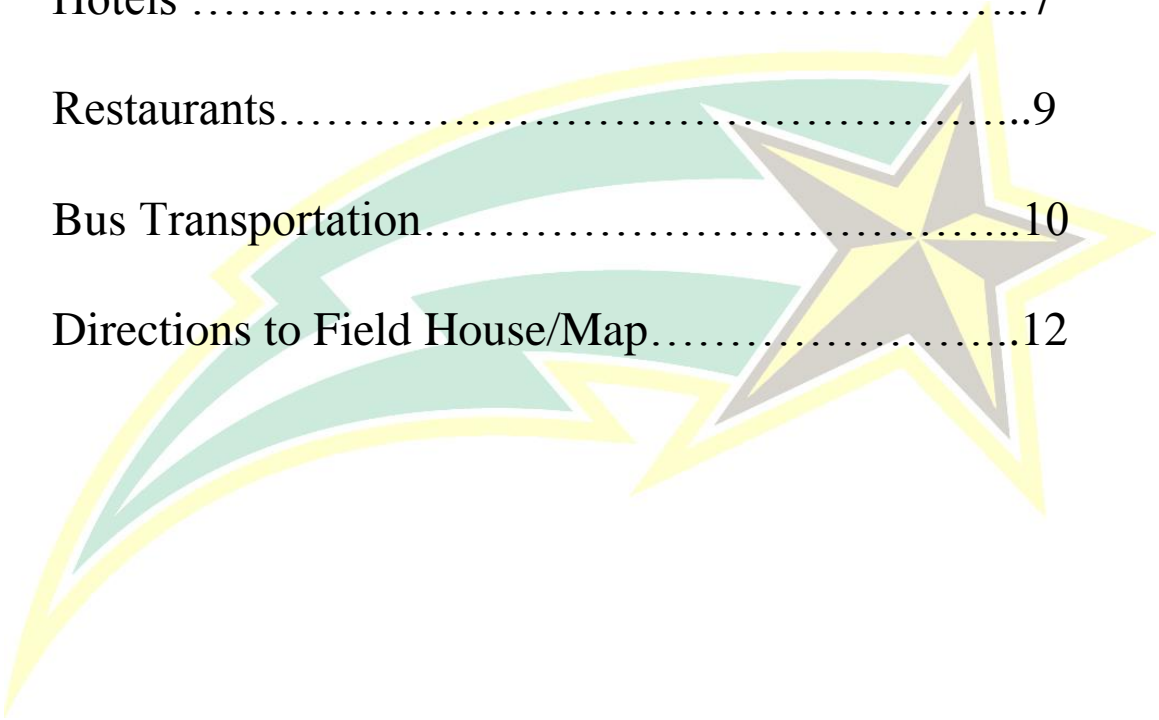

# George Mason University Game Operations Contacts

## *General Information for Game Day Operations*

Stacy A. Natoli, Assistant Athletic Director/Events

703-993-3195 (office)

571-423-8624 (cell)

[snatoli@gmu.edu](mailto:snatoli@gmu.edu)

Keith Morrisroe, Event Coordinator/Game Operations

703-993-9378 (office)

703-254-3108 (cell)

[kmorrisr@gmu.edu](mailto:kmorrisr@gmu.edu)

## *Scheduling Visiting Team Practices*

Ryan Jones, Scheduling Coordinator

703-993-3458 (office)

271-220-0113 (cell)

[rjones8@gmu.edu](mailto:rjones8@gmu.edu)

## *Marketing and Ticket Information*

James Meyer, Director of Tickets and Promotions

703-993-3265 (office)

[jmeyer2@gmu.edu](mailto:jmeyer2@gmu.edu)

## *Athletic Training*

Main Athletic Training Office

703-993-3279

Linda Pullen, Coordinator of Sports Medicine

703-993-3280 (office)

[lpullen@gmu.edu](mailto:lpullen@gmu.edu)

Ray Yamrus, Head Athletic Trainer

703-993-3280 (office)

[ryamrusj@gmu.edu](mailto:ryamrusj@gmu.edu)

# Visiting Team Information

## *Scheduling Practices*

Visiting teams that wish to practice before the event will be given a time period of 60 minutes and they should contact the scheduling coordinator at least one week in advance.

### *Men's Soccer, Women's Soccer, and Women's Lacrosse:*



Visiting teams can request a 30 minute walk-thru on the game field.



No cleats, balls, drills, or any type of running will be permitted on the game field during the walk-thru.



If visiting teams wish to schedule a full practice, they will be assigned to a practice field.



Practices cannot be scheduled to start after 7:00pm.

### *Baseball and Softball:*



Contact scheduling coordinator at least one week in advance to schedule practice times.

**All scheduled practices are weather permitting. Practices can be relocated or cancelled at any time at the discretion of the George Mason Athletic Department. The scheduling coordinator will contact you immediately if there are any changes.**

# Visiting Team Information

## ***Locker Rooms***

Visiting Teams will be assigned a locker room for the event. When you arrive please see the front desk to receive locker room combination. General locker room showers are available and if towels are needed, please contact an event staff worker when you arrive.

## ***Parking***









Ample amount of parking spaces are available adjacent to the fieldhouse and stadium. Buses should park in Lot P closest to the baseball stadium. Team vans can park in any of the spaces around the stadium or fieldhouse.

## ***Tickets***

George Mason Athletics charges for admission for the following sports: baseball (three game series only), M/W basketball, M/W soccer, and M/W volleyball. Teams providing a complimentary pass list must submit the list to the Athletic Ticket Office at least 90 minutes prior to the start of the event. Each guest must have their first and last name on the list and will be required to show a photo ID. *Athletic ticket policy is subject to change. Please visit [GoMason.com](http://GoMason.com) for the most up to date information.*

## ***Event/Facility Policies***

The following items are NOT permitted inside George Mason Stadium, George Mason Fieldhouse, Baseball Stadium or Softball Stadium:







-  Alcoholic Beverages
-  Artificial Noise Makers (air horns, drums, etc.)
-  Glass Containers
-  Outside Food or Beverages
-  Objects That Can Be Thrown (balls, frisbees, etc.)
-  Pets (with the exception of service animals)
-  Smoking
-  Visiting Team signs, flags, or banners cannot be attached to any part of George Mason Stadium/Facility.

***Tailgating*** – Tailgating is permitted in Lot P closest to the baseball stadium. Please make sure your tailgate set-up does not impede traffic flow or take up needed parking spaces. Only charcoal grills are permitted and tents need to be secured or dismantled if left unattended.

# Athletic Training Information

## *Athletic Training*

Please contact the athletic training staff at 703-993-3279 if you need to make arrangements for events or practices. The following will be available to visiting teams when they arrive:

-  Water, cups, ice, ice bags and emergency equipment.
-  Access to the athletic training room before and after practices and competitions.
-  Certified athletic trainer for all home contests and on-site for practices if a team travels without a certified athletic trainer.
-  Staff assistance with emergency procedures and communication at practices and contests.
-  Team physician available at all home soccer, basketball, and wrestling contests.
-  Access to a physician and emergency facility within five minutes of campus.

Please notify athletic training staff as early as possible if your team is traveling without an athletic trainer. Our staff will be glad to assist any visiting team. We do however request that the necessary supplies be provided for taping. Also, in order to use the electrotherapy and ultrasound units, athletes must be accompanied by a certified athletic trainer or provide a written prescription from a certified athletic trainer or team physician.

INOVA Emergency Care Center  
(Emergency clinic near campus)  
**703-877-8200**

INOVA Fairfax Hospital  
**703-776-4001**

INOVA Fair Oaks Hospital  
(Fair Lakes area)  
**703-391-3600**

Giant Pharmacy  
(University Mall Shopping Center)  
**703-591-002**

# Hotel Information

*Preferred Partners of George Mason Athletics*



**LIKE YOUR TEAM, WE ARE ALWAYS ON OUR GAME.**

Preferred Marriott Hotels for George Mason Athletics:

- |   |   |
|---|---|
| 1 - RESIDENCE INN FAIRFAX CITY<br>1.9 Miles from Campus<br><a href="http://www.marriott.com/IADRF">www.marriott.com/IADRF</a>             | 7 - SPRINGHILL SUITES<br>CENTREVILLE CHANTILLY<br>7.7 Miles from Campus<br><a href="http://www.marriott.com/WASCV">www.marriott.com/WASCV</a>   |
| 2 - COURTYARD FAIRFAX FAIR OAKS<br>2.7 Miles from Campus<br><a href="http://www.marriott.com/IADFO">www.marriott.com/IADFO</a>            | 8 - COURTYARD DULLES<br>AIRPORT CHANTILLY<br>10.0 Miles from Campus<br><a href="http://www.marriott.com/IADCA">www.marriott.com/IADCA</a>       |
| 3 - SPRINGHILL SUITES FAIRFAX FAIR OAKS<br>2.8 Miles from Campus<br><a href="http://www.marriott.com/IADFR">www.marriott.com/IADFR</a>    | 9 - TOWNEPLACE SUITES<br>CHANTILLY DULLES SOUTH<br>10.1 Miles from Campus<br><a href="http://www.marriott.com/IADTS">www.marriott.com/IADTS</a> |
| 4 - FAIRFAX MARRIOTT AT FAIR OAKS<br>3.8 Miles from Campus<br><a href="http://www.marriott.com/IADMC">www.marriott.com/IADMC</a>          | 10 - RESIDENCE INN<br>CHANTILLY DULLES SOUTH<br>10.8 Miles from Campus<br><a href="http://www.marriott.com/IADFX">www.marriott.com/IADFX</a>    |
| 5 - RESIDENCE INN FAIR LAKES<br>5.7 Miles from Campus<br><a href="http://www.marriott.com/IADFL">www.marriott.com/IADFL</a>               |   |
| 6 - FALLS CHURCH MARRIOTT<br>FAIRVIEW PARK<br>7.6 Miles from Campus<br><a href="http://www.marriott.com/WASFP">www.marriott.com/WASFP</a> |   |



For Individual Reservations please visit [www.Marriott.com](http://www.Marriott.com)  
and enter Corporate Code: G57

For 5 or More rooms, Special Mason Athletics Rates, Visiting Team Rates, Group Arrangements and Extra Special Incentives Contact:

Becky Tobin - Account Executive, Marriott Global Sales  
T: (202) 365-8984 | [GoMason@Marriott.com](mailto:GoMason@Marriott.com)



# COMFORT INN UNIVERSITY CENTER WELCOMES ALL MASON FANS!



- Located just minutes from the Patriot Center
- Free Hot Deluxe Breakfast
- Free Wi-Fi
- Private Meeting Rooms



- Indoor Heated Pool with Outdoor Patio
- Complimentary Shuttle
- Restaurant On Site
- Room Service



Comfort Inn University Center  
Fairfax, VA 22030  
703-591-5900  
Contact: Cinthia Garcia  
Email: [cgarcia@comfortinnfairfax.com](mailto:cgarcia@comfortinnfairfax.com)  
[www.comfortinnfairfax.com](http://www.comfortinnfairfax.com)



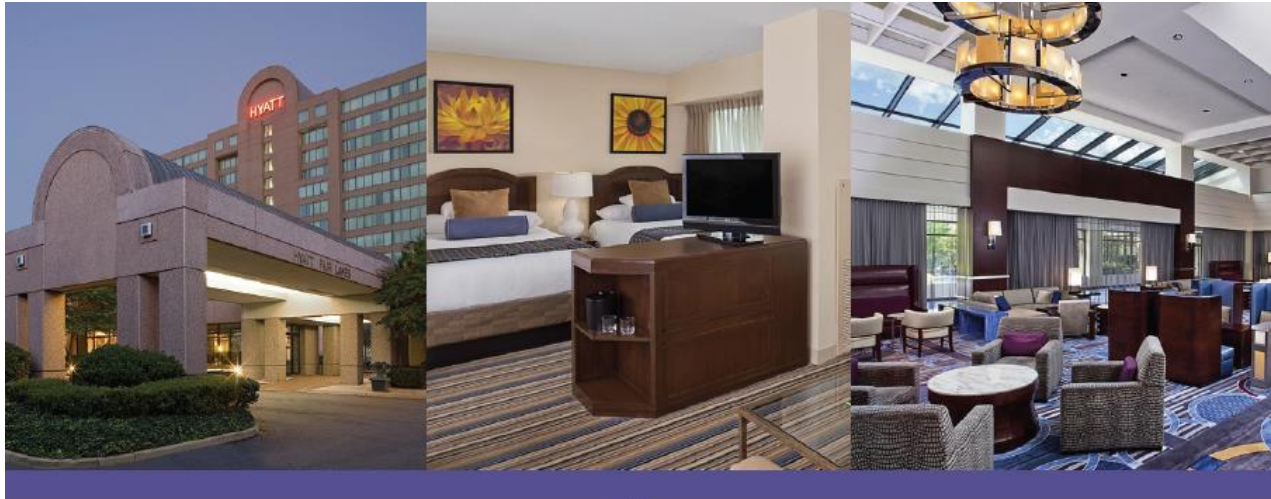

# HYATT REGENCY®

FAIRFAX

12777 Fair Lakes Circle  
Fairfax, VA 22033

**(703) 818-1234 | [fairfax.regency.hyatt.com](http://fairfax.regency.hyatt.com)**

A full-service hotel located just minutes from George Mason University, the Hyatt Regency Fairfax offers free wireless high speed internet, on-site restaurants, meeting space and is walking distance from premium shopping and eateries.

Contact Tricia L. DeVine, Sales Manager & GMU Liaison  
703.653.6047 or [tricia.devine@hyatt.com](mailto:tricia.devine@hyatt.com) to secure your rooms.

*Proud Corporate Partner of George Mason Athletics*



# Restaurant Guide

## *Preferred Partners of George Mason Athletics*

### **Brion's Grille**

10621 Braddock Rd. (University Mall), Fairfax, VA 22030  
Phone: 703-352-7272 Contact: Terry Walline  
Website : [www.brionsgrille.com](http://www.brionsgrille.com)



### **Chick-Fil-A**

9509 Fairfax Boulevard, Fairfax, VA 22031  
Phone: 703-034-2150 Contact: John Natolly  
Website: [chick-fil-a.com](http://chick-fil-a.com)



### **Glory Days Grill (20 area locations)**

3059 Nutley St., Fairfax, VA 22031  
Phone: (703) 204-0900 Contact: Katie Easterbrook 571-237-1029  
Website: [www.glorydaysgrill.com](http://www.glorydaysgrill.com)



### **Paisano's Pizza**

10330 Main St., Fairfax, VA 22030 Contact: Chris Kenney  
Phone: 703-273-9900 Website: [www.paisanospizza.com](http://www.paisanospizza.com)



### **Jersey Mike's Fairfax**

10394 Willard Way, Fairfax, VA 22030  
Phone: (703) 293-6293 Contact: Todd Cohen 917-494-7114  
Website: [www.jerseymikes.com/6028/Fairfax-VA](http://www.jerseymikes.com/6028/Fairfax-VA)



### **Jason's Deli**

12955 Fair Lakes Shopping Center, Fairfax, VA 22033  
Phone: (703) 449-0924 Website: [www.jasonsdeli.com](http://www.jasonsdeli.com)



### **Maggiano's – Little Italy**

6500 Springfield Mall, Suite 6805, Springfield, VA 22150  
Phone: 703-923-9209 Contact : Marc Antony Pickering  
Website : <http://locations.maggianos.com/virginia/springfield/22150/6500-springfield-mall/>



### **Hard Times Cafe**

4069 Chainbridge Road, Fairfax, VA 22030  
Phone: 703-267-9590 Contact : RB Cobean  
Website : [www.hardtimes.com](http://www.hardtimes.com)



**HARD TIMES CAFE**

### **Chuy's Tex Mex**

11219 Lee Highway, Fairfax, VA 22030  
Phone: 703-364-5933  
Website : [www.chuys.com/locations/virginia/fairfax](http://www.chuys.com/locations/virginia/fairfax)



### **Booeymonger – A Unique Delicatessen**

1010 N Glebe Road, Arlington, VA 22201  
Email: [booey.ballston@verizon.net](mailto:booey.ballston@verizon.net) Contact: Ron Vogel  
Phone: (301) 873-1736 Website: [www.booeymonger.com](http://www.booeymonger.com)





THE OFFICIAL FOOD OF HOMETOWN SPORTS.™

Locations in Maryland, Virginia, West Virginia & Florida

[www.glorydaysgrill.com](http://www.glorydaysgrill.com)

**BURGER MONDAY**  
\$5.99 CLASSIC BURGERS

**TACO TUESDAY**  
\$5.99 TWO TACOS  
W/ CHIPS & SALSA

**SNACK ATTACK MENU**  
\$4/\$5/\$6 Appetizers  
EVERY DAY AFTER 9PM

DINE IN ONLY. \*SELECT APPETIZERS ONLY.

**WELCOME TO FAIRFAX!**

If your team is looking for DELICIOUS food in a student-friendly sports atmosphere,  
**LOOK NO FURTHER!**

★ **COACH EATS FREE!** ★

Feed a team of 8 or more players & your coach eats free!



\*With this coupon and with the purchase of 8 or more sandwiches or entrees. Max value of discount \$14.99. Not redeemable for cash, alcoholic beverages, or gratuity. Not combinable with other offers, discounts or promotions. Exp. 6/30/17.

G065

Need  
**BOXED LUNCHES**  
or **CATERING?**

**EMAIL US!**

Email us at [catering@glorydaysgrill.com](mailto:catering@glorydaysgrill.com)



**Voted best sub  
in virtually every  
market we serve!**

**LET US CATER YOUR NEXT EVENT! WE DELIVER!**  
**CONTACT: OWNER, TODD COHEN AT 917-494-7114**



**10394 Willard Way • Fairfax, VA • 703-293-6293**

**FREE DELIVERY TO ALL MASON ATHLETICS VENUES**

# Jason's deli®

And so much more...



Reuben THE Great

To plan your team meal or schedule post-game delivery to Mason Athletics facilities, please contact:

Kristen Hunter, Local Sales Manager  
Email: [kristen.hunter@jasonsdeli.com](mailto:kristen.hunter@jasonsdeli.com)  
Cell Phone: (703) 898-2220

## Two Jason's Deli Locations:

12955 Fair Lakes Shopping Center  
Fairfax, VA  
(703) 449-0924

7505 Leesburg Pike  
Falls Church, VA  
(703) 448-5514

**We fit your  
team's schedule!  
dine-in, to-go, catering & delivery**

MAGGIANO'S  
= LITTLE ITALY =

# OUR PLACE OR YOURS

HOMEMADE CLASSIC ITALIAN AMERICAN CUISINE. WE OFFER  
PRIME STEAKS, SEAFOOD, CHEF'S SPECIALS, SIGNATURE SALADS AND CLASSIC PASTAS  
ALL MADE-FROM-SCRATCH BY OUR CHEFS.

**\$10 OFF \$30 SPENT DINING IN**

Minimum purchase of \$30 required. Valid for dine-in only. Not valid for Carryout, Delivery or Banquets. Not valid with other discounts or offers. One coupon per table. No cash value. Cannot be used for taxes, gratuity gift cards, alcohol or cash back. Certificate is void if altered. Coupon code #76. Offer expires 3/15/17.

**\$25 OFF YOUR NEXT DELIVERY**

Please order by 7:00pm the evening before your event. No cash value. A minimum order of \$150 is required. A delivery fee of \$20 or 15% of total food and beverage, whichever is higher, will be charged within the delivery area. Cannot be combined with any other offer. Offer expires 3/15/17. Use coupon code 51.

SPRINGFIELD 6500 Springfield Mall, Suite 6805 | Springfield, VA 22150 | 703.923.9309

# Bus Transportation

*Preferred Partners of George Mason Athletics*

## Academy Bus, LLC

792 Gainsford Court  
Bristow, Virginia 20136

Contact: Dena Ennis

Phone Number: 800-322-7733

Charter E-Mail: [dennis@academybus.com](mailto:dennis@academybus.com)

*We know the way.*



 *Academy*

703-392-8687  
[academybus.com](http://academybus.com)



## **Directions to George Mason Stadium/Fieldhouse/Baseball and Softball**

**4501 University Drive  
Fairfax, VA 22030**

### **From the North (Philadelphia, Baltimore):**

1. I-95 South (stay on I-95 and take tunnel [toll] if coming from north of Baltimore).
2. Exit 27 – I-495 West (sign will say Silver Spring).
3. Cross Potomac River into Virginia.
4. Exit 49A – I-66 West (Front Royal).
5. Exit 60 – 123 South (Fairfax).
6. Go through 6 traffic lights. At 7th light take a right onto University Drive.
7. Fieldhouse is located directly on your left.

### **From the South: (Richmond, Norfolk, North Carolina)**

1. I-95 North (take I-295 North to avoid congestion if below Richmond).
2. Exit 160 B – Rte. 123 (sign will say Occoquan/Lake Ridge).
3. Go approximately 15.5 miles to intersection with University Drive.
4. At traffic signal, make a left onto University Drive.
5. Fieldhouse is located directly on your left.

### **From the Southwest: (Harrisonburg, Roanoke, Blacksburg)**

1. I-81 North.
2. I-66 East.
3. Exit 55 – Fairfax County Parkway SOUTH.
4. Exit at Braddock Road, turn left at traffic signal at bottom of ramp.
5. Go approximately 3½ miles to intersection with Ox Road/Rt.123.
6. Make a left onto Ox Road/Rt. 123.
7. At next traffic signal (about 200 yards), left onto University Drive.
8. Fieldhouse is located directly on your left.

### **From National Airport:**

1. I-395 South.
2. I-495 West.
3. Exit 54A – Rte. 620 (Braddock Road WEST).
4. Go 5-6 miles to George Mason campus on right.
5. Continue to the intersection with Ox Road/ Rt. 123.
6. At the traffic signal make a right onto Ox Road/ Rt. 123.
7. At the next traffic signal (about 200 yards), make a left onto University Drive.
8. Fieldhouse is located directly on your left.

### **From Dulles Airport:**

1. Dulles Toll Road EAST.
2. Fairfax County Parkway SOUTH.
3. Exit at Braddock Road, turn left at traffic signal at bottom of ramp.
4. Go approximately 3½ miles to intersection with Ox Road/ Rt. 123.
5. Make a left onto Ox Road/Rt. 123.
6. At next traffic signal (about 200 yards), left onto University Drive.
7. Fieldhouse is located directly on your left.

- Baseball
- Softball
- Women's Lacrosse, Men's and Women's Soccer

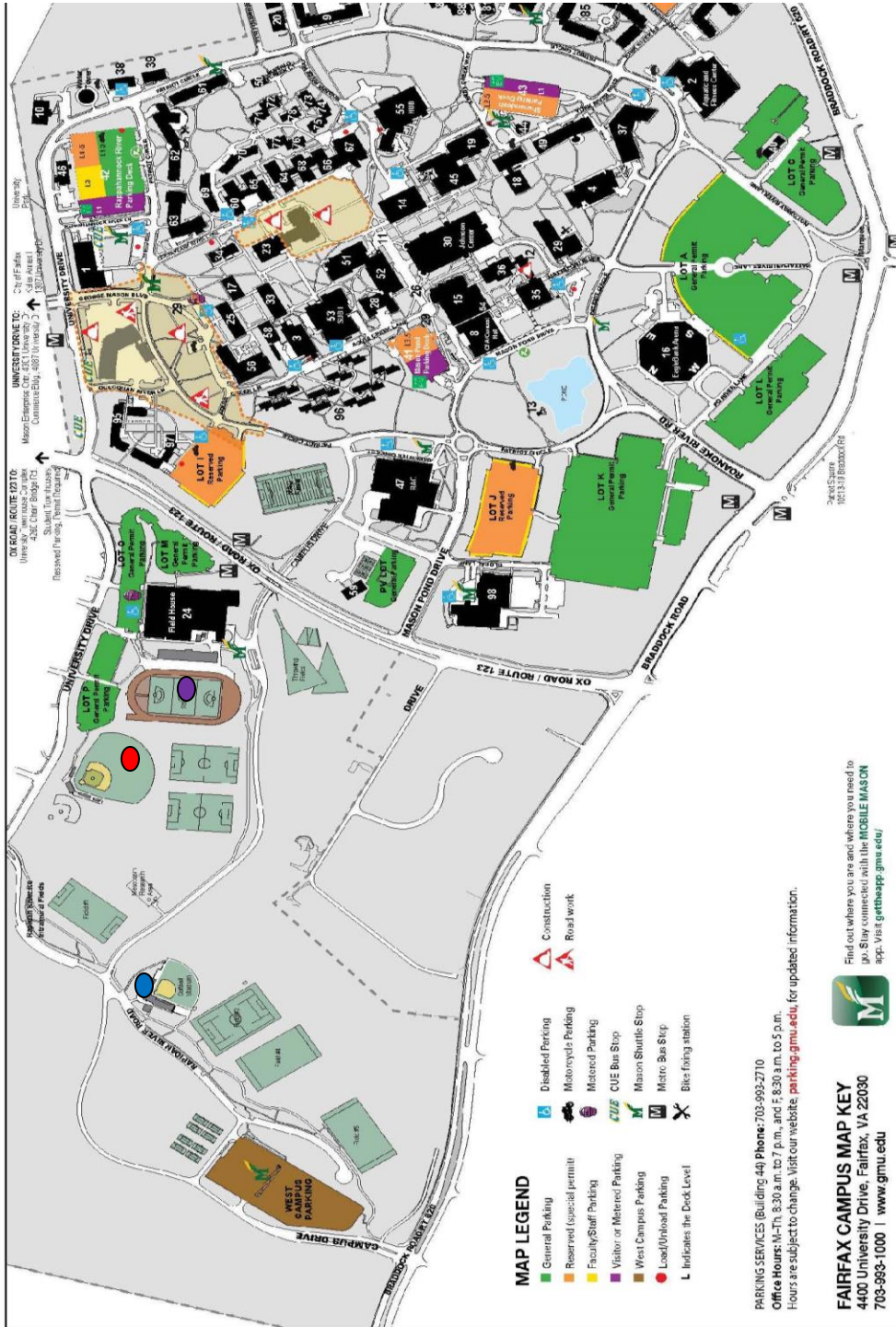

- MAP LEGEND**
- General Parking
  - Reserved/Special permit
  - Faculty/Staff Parking
  - Visitor or Metered Parking
  - West Campus Parking
  - Load/Unload Parking
  - Disabled Parking
  - Motorcycle Parking
  - Metered Parking
  - CUE CUE Bus Stop
  - Mason Shuttle Stop
  - Metro Bus Stop
  - Bike fixing station
  - ▲ Construction
  - ▲ Road work
  - L Indicates the Dock Level

PARKING SERVICES (Building 44) Phone: 703-993-2710  
 Office Hours: M-Th, 8:30 a.m. to 7 p.m., and F, 8:30 a.m. to 5 p.m.  
 Hours are subject to change. Visit our website, [parking.gmu.edu](http://parking.gmu.edu), for updated information.

**FAIRFAX CAMPUS MAP KEY**  
 4400 University Drive, Fairfax, VA 22030  
 703-993-1000 | [www.gmu.edu](http://www.gmu.edu)

Find out where you are and where you need to go. Stay connected with the **MOBILE MASON** app. Visit [gettheapp.gmu.edu](http://gettheapp.gmu.edu)

- |                                      |  |  |                                  |                           |                                  |
|--------------------------------------|--|--|----------------------------------|---------------------------|----------------------------------|
| 1 Alan and Betty Verten Hall         | 18 Enterprise Hall                           | 34 Lecture Hall                          | 51 Robinson Hall A               | 64 Pishmoor*              | 78 Adams                         |
| 2 Athletic and Fitness Center        | 19 Epiphany Hall                             | 35 Mason Hall                            | 52 Robinson Hall B               | 65 Sandridge              | 79 Elliott                       |
| 3 Arts Building                      | 20 Facilities Administration                 | 36 Music/Theater                         | 53 Student Union Building I      | 66 Skyline Fitness Center | 80 Eshenower* and Ike's Diner    |
| 4 Business Design Building           | 21 Facilities Management - Activities Center | 37 Nguyen Engineering Building           | 54 Trustees/Space/Black Box      | 67 Jackson                | 81 Jackson                       |
| 5 Carroll House                      | 22 Center for the Arts                       | 38 Northwood Student Support Center      | 55 The Hub                       | 68 Burwater               | 82 Jefferson                     |
| 6 Carroll Hall                       | 23 Frank R. Library                          | 39 Nuttman Alumni Hall                   | 56 West Building                 | 69 Commonwealth           | 83 Kennedy                       |
| 7 Carry House                        | 24 Field House and Mobile                    | 40 Nuttman Alumni Hall                   | 57 West Building                 | 70 Dominion               | 84 Liberty Square                |
| 8 Center for the Arts/Concert Hall   | 25 Field House and Mobile                    | 41 Parking Deck, Mason Road              | 58 West PE Module                | 71 Amherst                | 85 Lincoln                       |
| 9 Central Heating and Cooling Plant  | 26 George Mason Statue                       | 42 Parking Deck, Regghanook Rvr          | 59 West PE Module                | 72 Brunswick              | 86 Madison                       |
| 10 Child Development Center          | 27 Greenhouse                                | 43 Parking Services                      | 60 Bull Ridge                    | 73 Carroll                | 87 Monroe                        |
| 11 Clock                             | 28 Harris Theater                            | 44 Police and Safety Hdqtr.              | 61 Eastern Shurtz                | 74 Dickenson              | 88 Piomac Heights/Housing Office |
| 12 Cross Cottage                     | 29 Innovation Hall                           | 45 Recreation and Athletic Complex (RAC) | 62 Hampton Roads and Pilot House | 75 Franklin               | 89 Roosevelt                     |
| 13 David King Hall                   | 30 Johnson Center                            | 46 Recycling Center                      | 63 Northern Neck                 | 76 Franklin               | 90 Taylor                        |
| 14 de Laski Performing Arts Building | 31 Kelley II                                 | 47 Research Hall                         | 64 Pishmoor*                     | 77 Grayson                | 91 Truman                        |
| 15 EagleBank Arena                   | 32 Krasnow Institute                         | 48 Research Hall                         | 65 Sandridge                     | 78 Hanover                | 92 Washington                    |
| 16 East Building                     | 33 Krug Hall                                 | 49 Research Hall                         | 66 Skyline Fitness Center        | 79 Elliott                | 93 Wilson                        |