

UNIVERSITY OF COLORADO

CU Invitational

Field Events * (tentative)

Friday, April 5th

Throwing Events

1:45pm National Anthem
2:00pm Women's Hammer
2:00pm Men's Javelin
~after M-JT Women's Javelin
~after W-HT Men's Hammer

Saturday, April 6th

Throwing Events

11:00am Women's Shot Put (West Ring)
11:00am Men's Shot Put (East Ring)
~after W-SP Women's Discus
~after W-DT Men's Discus

Jumping Events

11:00am Women's Triple Jump (East Pit)
~after W-TJ Women's Long Jump (East Pit)
11:00am Men's Triple Jump (West Pit)
~after M-TJ Men's Long Jump (West Pit)
11:00am Women's High Jump
~after W-HJ Men's High Jump
11:00am Women's Pole Vault
~after W-PV Men's Pole Vault

Running Events* (tentative)

Saturday, April 6th

10:45am National Anthem
11:00am Men's 3000 Meter Steeplechase
~ Women's 3000 Meter Steeplechase
~ Men's 4x100 Meter Relay
~ Women's 4x100 Meter Relay
~ Men's 1500 Meters
~ Women's 1500 Meters
~ Men's 110 Meter Hurdles
~ Women's 100 Meter Hurdles
~ Men's 400 Meters
~ Women's 400 Meters
~ Men's 100 Meters
~ Women's 100 Meters
~ Men's 800 Meters
~ Women's 800 Meters
~ Men's 400 Meter Hurdles
~ Women's 400 Meter Hurdles
~ Men's 200 Meters
~ Women's 200 Meters
~ Men's 3000 Meters
~ Women's 3000 Meters
~ Men's 4X400 Meter Relay
~ Women's 4X400 Meter Relay

* Tentative Meet Schedule, final schedule will be posted
after entries close and seeding is complete.



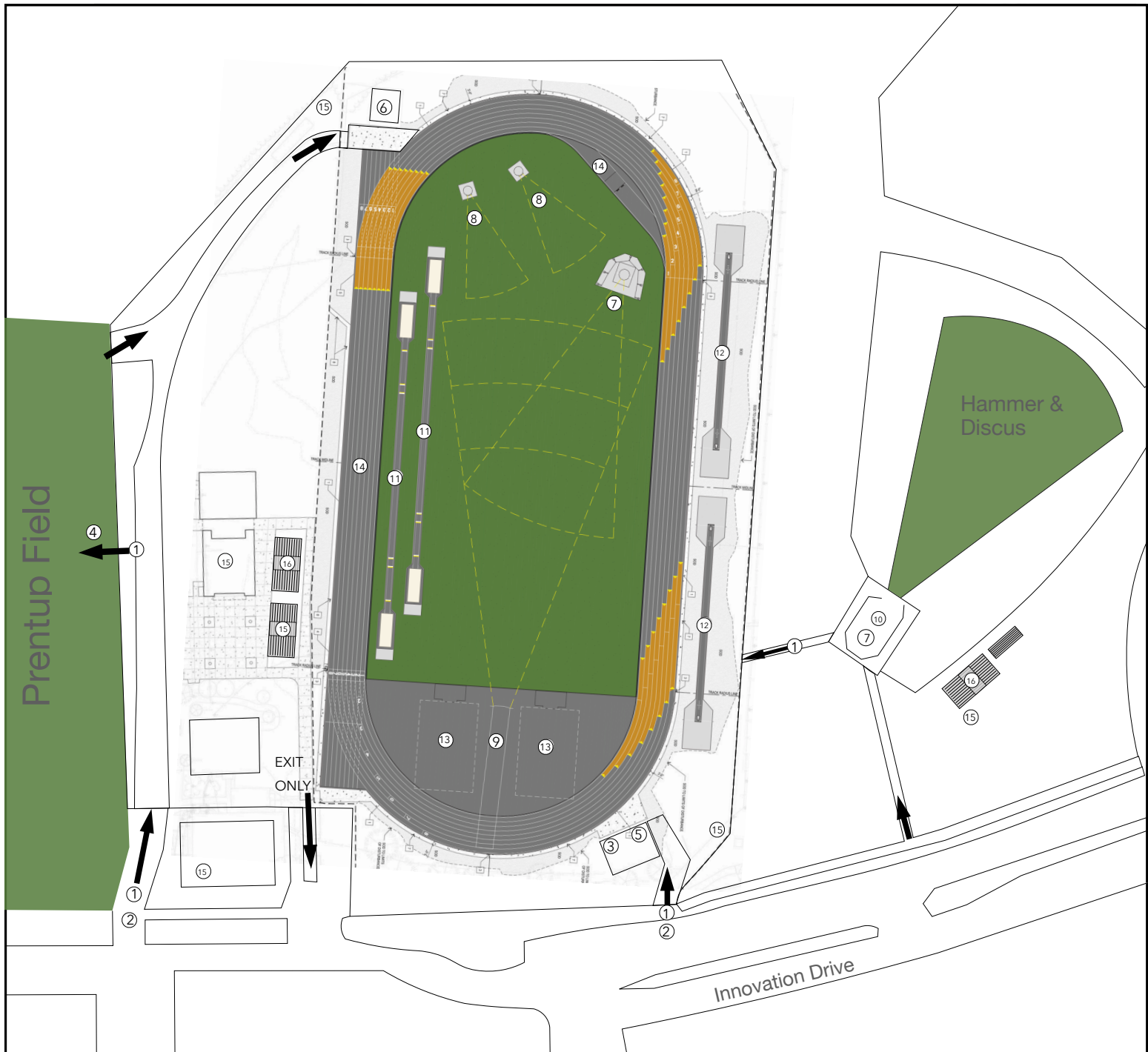

Potts Track Map

1. Athlete/Coach Entrance
2. Spectator Entrance
3. Sport Medicine
4. Team Camp Areas

5. Implement Certification
6. Clerk/Hip Numbers
7. Discus
8. Shot Put
9. Javelin
10. Hammer

11. Long/Triple Jump
12. Pole Vault
13. High Jump
14. Track Events
15. Rest Rooms
16. Spectator Seating

RESTRICTIONS

CU CLEAR BAG POLICY

PERMITTED BAGS

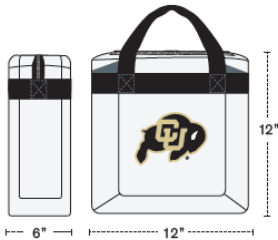

CLEAR BAGS

No larger than 12" x 6" x 12"



SMALL CLUTCH BAGS

No larger than 4.5" x 6.5"

PLASTIC STORAGE BAG

1-Gallon resealable, clear



SEAT CUSHION AND SEAT CUSHION WITH BACK

No pockets or zippers
18" or less in width

PROHIBITED BAGS



BACKPACKS

Solid or Clear



LARGE PURSE



OVERSIZED TOTE BAG



MESH BAG

Reusable Grocery Bag



DRAWSTRING BAG

Solid (Clear Permitted)



CAMERA BAG BINOCULAR CASE



DIAPER BAG



PRINTED PLASTIC BAG



FANNY PACK

For a complete list of PROHIBITED and PERMITTED items, go to:
www.CUBuffs.com/BECLEAR

*Medical bags are permitted
and subject to a thorough inspection.*



**NO CHRISTMAS
TREE SPIKES**

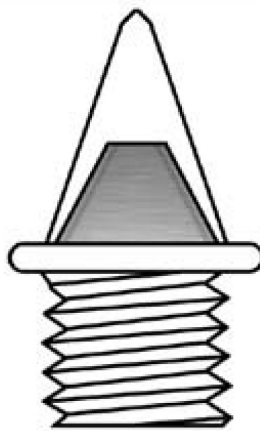

**1/4 INCH
PYRAMID SPIKES
ONLY**



**NO NEEDLE
SPIKES**