

MAXXON®

MAXXON®
Gyp-Crete®

MAXXON®
Acousti-Mat®

**YOUR
PROVEN
PARTNER FOR
MULTIFAMILY
SUBFLOORS**



Maxxon® Delivers Industry Leadership.

In 1972, Maxxon® revolutionized the construction industry by developing Gyp-Crete®. At times our trademarked name is used when referring to basic gypsum products, but there's no substitute for the performance and integrity of authentic Gyp-Crete underlayments. Spec it once and you'll never look back.

Today, Maxxon continues to lead the way with our dedicated R&D team and sound attenuation experts. Working in state-of-the-art R&D and Acoustics labs, they're bringing more scientific advancements to Multifamily construction. We were the first to introduce sound mats to Multifamily and we remain focused on developing product and process improvements to meet the changing needs of the industry.

Our commitment to innovation and science is only part of our leadership story. We are also dedicated to exceptional customer service. When you need solutions or support, our problem-solving team delivers the expertise your project demands. Start to finish, we've got your back.

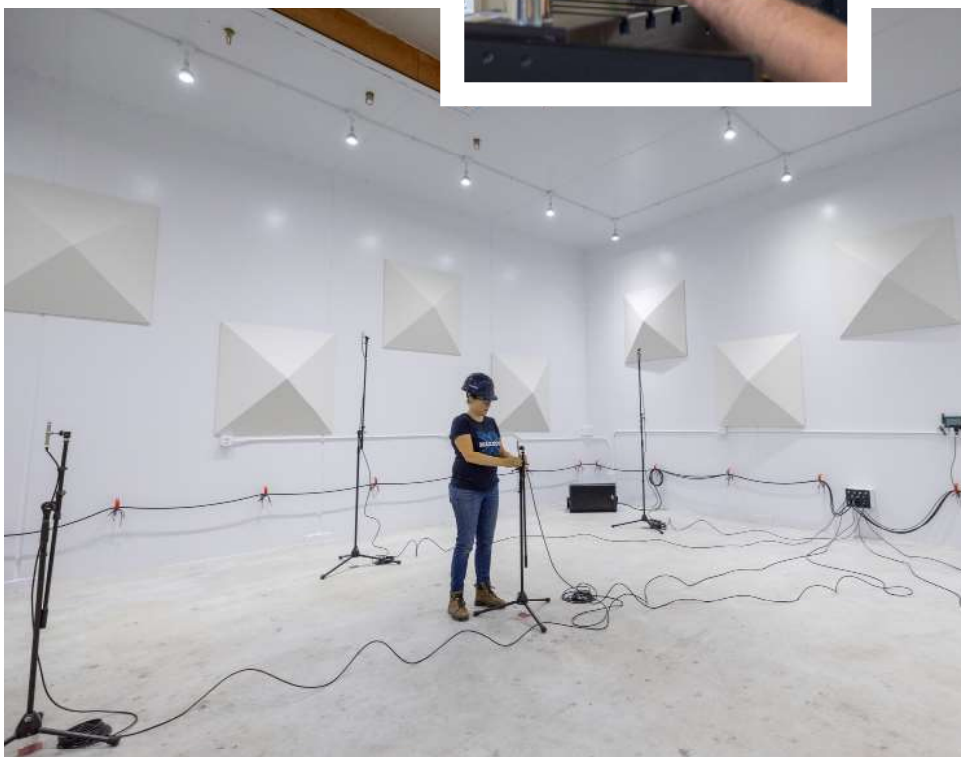



1972

Invented Gyp-Crete®

2022

Built largest
Floor/Ceiling Acoustic
Test Chambers
in North America

STRENGTH. FIRE SAFETY. SOUND CONTROL.

Maxxon Delivers Confidence.

For quality assurance, code compliance, and design flexibility, Maxxon® Gyp-Crete® underlayments and Maxxon® Acousti-Mat® sound control mats allow you to build with confidence.

Maxxon Gyp-Crete underlayments are available in more than 140 UL and ULC fire-resistance rated designs. They bring efficient fire and sound control to every Multifamily project. With a range of compressive strengths, Maxxon Gyp-Crete underlayments enable you to meet or exceed the demands of virtually all modern flooring coverings.

Maxxon Acousti-Mat products are backed by thousands of third-party sound tests and designed to mitigate impact and airborne noises in a variety of floor assemblies without sacrificing sound control.





Looking for Design Resources?

Get specifications, design files
and more at **maxxon.com**



GYPSUM UNDERLAYMENTS & SOUND MATS.

Maxxon Delivers Complete Systems for Multifamily Success.

To achieve the ultimate in tenant safety and satisfaction, combine a Maxxon Gyp-Crete underlayment with a Maxxon Acousti-Mat sound control mat.

Easily find the right system assembly for your project with our **Interactive System Selector** at Maxxon.com. Simply enter in project details to ensure you achieve the desired sound and fire ratings for your project.

Compatible with virtually all multifamily flooring, our warranted systems deliver proven, fire-resistant performance for peace of mind and superior sound control for peace and quiet.



MAXXON®
Acousti-Mat®

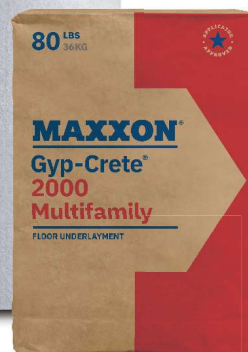

MAXXON®
Gyp-Crete®

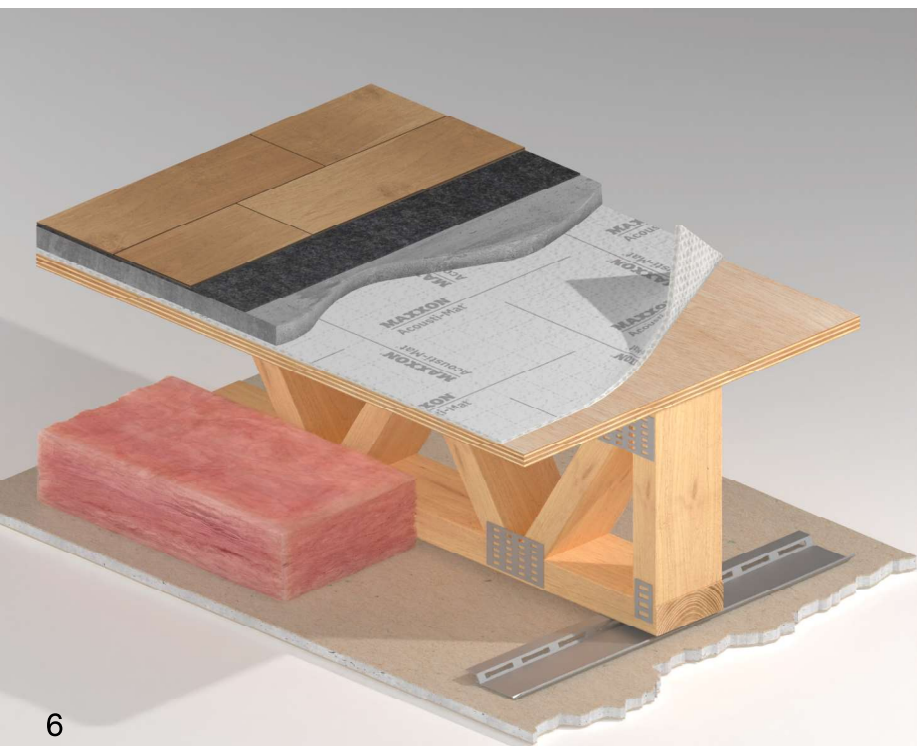

Interactive System
Selector





Lunch. Learn. Earn.

Maxxon offers AIA-approved continuing education courses. Choose a course and we'll bring the presentation – and lunch, on us – to your office. Each participant will earn one LU|HSW (Health, Safety, Welfare) credit.

Working remotely? Maxxon offers online presentations as well. View our current courses under the Resources tab at maxxon.com.



GYP-CRETE® UNDERLAYMENTS.

Our comprehensive portfolio of gypsum underlayments ensures the optimal solution for your project without compromise.

Every Maxxon Gyp-Crete Underlayment offers:



More than 140 UL and ULC fire-resistance rated designs



Superior sound attenuation when used with Maxxon® Acousti-Mat®



GREENGUARD Gold Certification

MAXXON® GYP-CRETE® 2000 MULTIFAMILY

The premium choice for interior wood subfloors with excellent flow properties.

TYPICAL RANGE:
2,000-3,200
PSI



MAXXON® GYP-CRETE® HIGH PERFORMANCE

Durability, versatility and excellent flow properties to meet the challenges of all modern, hard-surface floor coverings.

TYPICAL RANGE:
3,000-4,000
PSI



MAXXON® GYP-CRETE® BASIC

A cost-effective solution for interior wood subfloors.

UP TO
2,200
PSI



MAXXON® GYP-CRETE® RADIANT

Specially formulated to deliver even heat, maintain long-term heat tolerance and eliminate baseboard drafts.

TYPICAL RANGE:
2,000-3,200
PSI





Primers and Support Products

- Maxxon Commercial Multi-Use Primer
- Maxxon Commercial Gypsum Overspray
- Maxxon Perimeter Isolation Strip
- Maxxon Acousti-Mat Tape
- Maxxon Reinforcement Mesh and Fibers

ALSO AVAILABLE FROM MAXXON®:

MAXXON® RAPID FLOOR® MULTIFAMILY

The premium choice for interior wood subfloors with excellent flow properties.

TYPICAL RANGE:
2,000-3,200
PSI



MAXXON® RAPID FLOOR® BASIC

A cost-effective solution for interior wood subfloors.

UP TO
2,200
PSI



CHOOSE THE RIGHT PRODUCT

Multifamily Construction	Gyp-Crete 2000 MF	Gyp-Crete Basic	Gyp-Crete High Performance	Gyp-Crete Radiant
Wood - New	X	X	O	
Wood Renovation	X		O	
Concrete - New	X		X	
Concrete Renovation	X		X	
Steel Deck			X	
Radiant Heating				X

X = Recommended Product. O = Upgrade Alternative. Contact Maxxon®.



ACOUSTI-MAT® SOUND CONTROL MATS.

Reduce noise complaints with a Maxxon sound control mat topped by a Maxxon Gyp-Crete underlayment. Our broad Acousti-Mat product range allows you to meet the unique demands of every project.

Every Maxxon Acousti-Mat:



Meets or exceeds
IIC / STC ratings



Requires Maxxon
Underlayment for a
warranted system



GREENGUARD
Gold Certified

MAXXON® ACOUSTI-MAT® 1/8

Code minimum sound control in an economical, low-profile mat.

1/8 ACOUSTI-MAT SOUND CONTROL

Code
Min.

Highest
Level of
Performance

Code Minimum



MAXXON® ACOUSTI-MAT® 1/4

The original sound control mat for multifamily construction.

1/4 ACOUSTI-MAT SOUND CONTROL

Code
Min.

Highest
Level of
Performance

Code Minimum



MAXXON® ACOUSTI-MAT® 1/4 PREMIUM

Upgraded sound control for multifamily construction where floor height is a concern.

1/4P ACOUSTI-MAT SOUND CONTROL

Code
Min.

Highest
Level of
Performance

Acceptable Performance



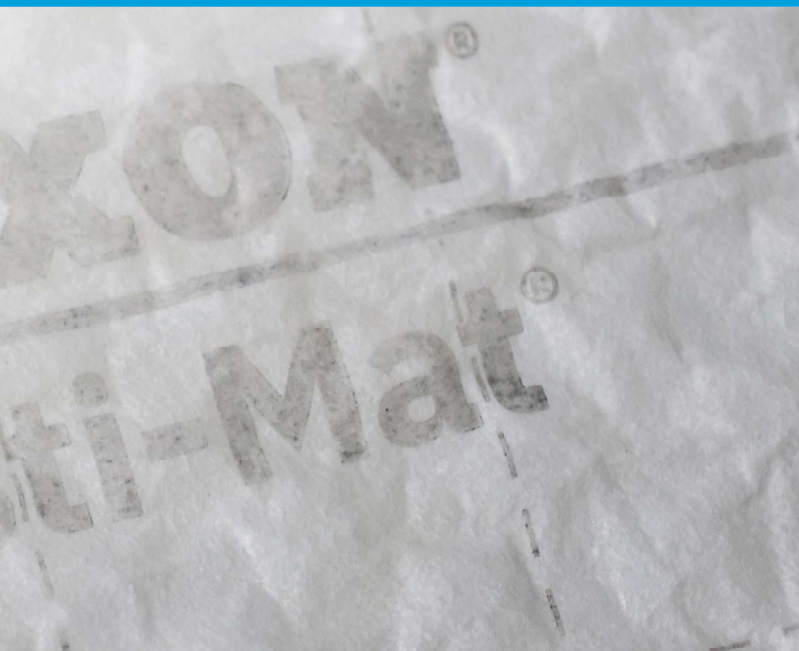

ICC G2-2010 GUIDELINE FOR ACOUSTICS

	Laboratory Sound Rating	Field Sound Rating
Code Minimum	50 STC/IIC	45 F-STC/F-IIC
Acceptable Performance	55 STC/IIC	52 F-STC/F-IIC
Preferred Performance	60 STC/IIC	57 F-STC/F-IIC

MAXXON® ACOUSTI-MAT® 3/8

The new acoustical standard for multifamily living.

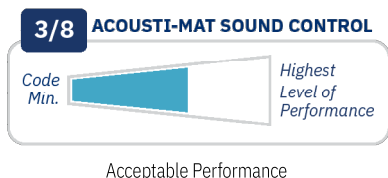

MAXXON® ACOUSTI-MAT® 3/4

Ideal for the luxury developments and assemblies with exposed ceilings.

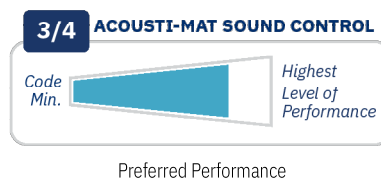

MAXXON® ACOUSTI-MAT® 3/8 PREMIUM

Ideal for high-end apartments, condos, and townhomes.

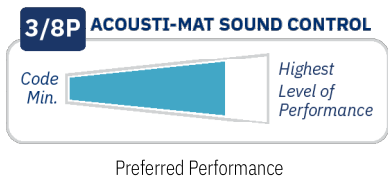

MAXXON® ACOUSTI-MAT® 3/4 PREMIUM

The highest performance sound control mat for challenging floors.

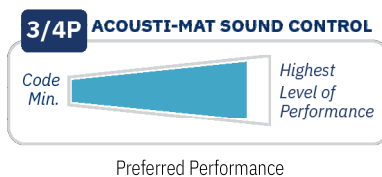

COMMERCIAL PRO.

Designed for large commercial projects that require high-strength underlayments, Maxxon Commercial Pro products come in 80# bags that are mixed with sand on site for lower cost and greater efficiency. Maxxon Commercial Pro products are exclusively installed by Authorized Maxxon Applicators who deliver faster turnarounds by pumping up to 40,000 sq. ft. per day.

MAXXON® COMMERCIAL PRO LEVEL-CRETE™

A cost-effective, high-strength hydraulic cement underlayment with excellent flow properties for resurfacing rough, pitted and out-of-level concrete.

TYPICAL RANGE:
4,000-5,000
PSI

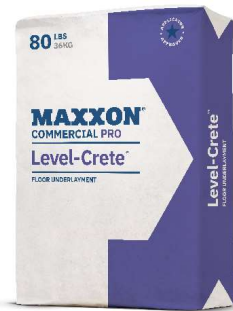

MAXXON® COMMERCIAL PRO LEVEL-RIGHT®

A self-leveling, hydraulic cement-based underlayment designed to flatten and smooth concrete slabs. No special subfloor prep, old floor removal or hand finishing required.

TYPICAL RANGE:
5,000-7,000
PSI



Nationwide Installer Network

Trained in the precise application of all Maxxon products, our Authorized Applicators provide the experience and know-how to get your project done right. With our nationwide network, you'll find skilled product applicators where you need them, when you need them.



EZ RENOVATION SYSTEM FOR MULTIFAMILY.

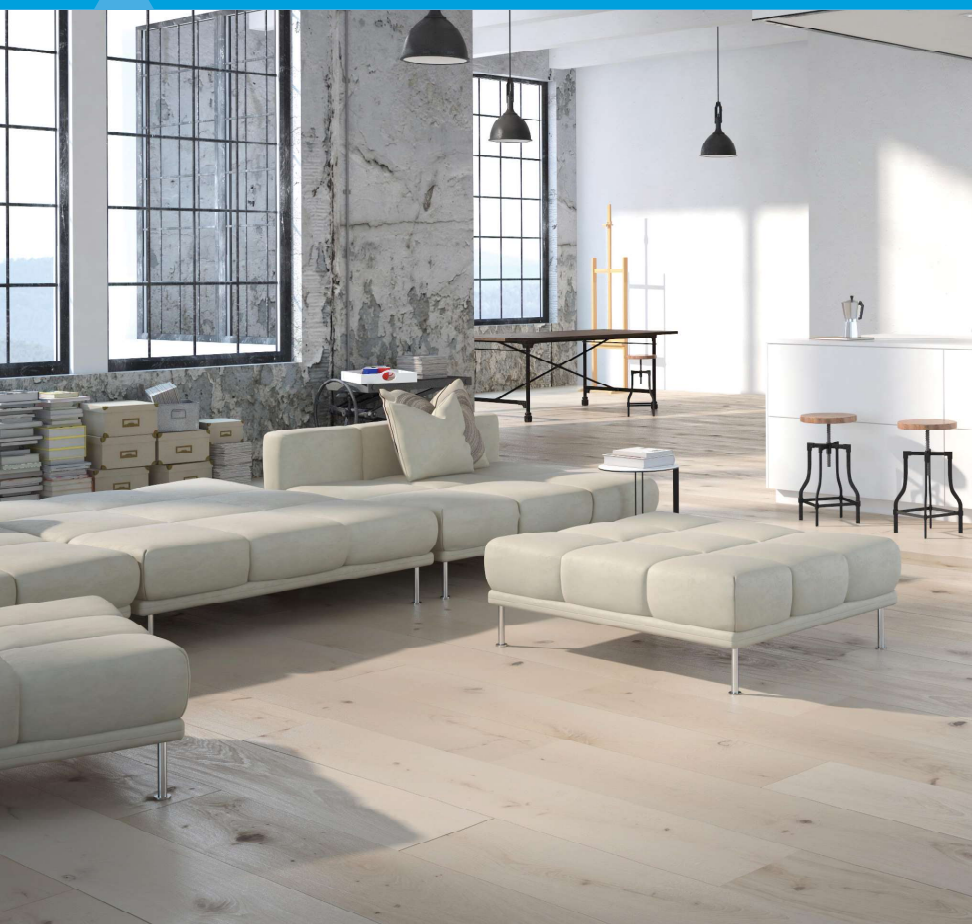

MAXXON® EZ Renovation System™

**A 3-step, permanent
subfloor renovation in as
little as 1 day.**

The Maxxon EZ Renovation System provides a subfloor renovation solution that saves you time and money. Fix broken or cracked floors with incredible results in three easy steps.



STEP 1 PRIME

GYPSUM PRIMER

- Compatible with gypsum and lightweight concrete underlayments
- Single component – fast and easy to install
- Gives old subfloors like-new surface strength



STEP 2 POUR/PATCH

FIRE RATED UNDERLAYMENT

- Levels at 1/4"
- Exceptional smoothness and workability
- Ready for floor covering the next day

EZ CRETE® & GYP-FIX EZ™ PATCH ALSO AVAILABLE



STEP 3 PLACE

SOUND CONTROL SOLUTION

- Sound code compliance without added height
- Helps contribute to meeting building sound code standards
- Exceptional durability

MASS TIMBER EXPERTISE.

Supporting Mass Timber construction since 2014

Mass timber construction offers many advantages from carbon sequestration and renewability to strength, versatility and biophilic aesthetic. Maxxon began supporting mass timber in 2014 with proven solutions for fire and sound control subfloor assemblies to meet the unique demands of these projects. As the innovator of Gyp-Crete® underlayment and Acousti-Mat® sound control, Maxxon has served mass timber construction across the U.S. with products covering more than 8.5 million square feet.



Maxxon is proud to support WoodWorks in expanding the use of mass timber. As the leading provider of wood education and resources, WoodWorks provides free project assistance to architects, engineers, contractors, and developers/owners. To learn more visit: woodworks.org

TECHNICAL RESOURCES.

MAXXON GYPSUM FLOOR UNDERLAYMENTS TECHNICAL DATA

	GYP-CRETE® BASIC		GYP-CRETE® 2000 MULTIFAMILY		GYP-CRETE® RADIANT		GYP-CRETE® HIGH PERFORMANCE	
USES	Multifamily, New Wood Construction		Multifamily, light commercial, single family, floating floors, carpet, sheet vinyl and thicker LVT		Radiant Floor Heating		Multifamily, light commercial, steel decks, thin LVT, glue down, high foot traffic corridors, common areas, pre drywall	
COMPRESSIVE STRENGTH	Up to 2,200 psi (15.2 MPa)		Typical Range: 2,000 - 3,200 psi (13.8-22.1 MPa)		Typical Range: 2,000 - 3,200 psi (13.8-20.7 MPa)		Typical Range: 3,000 - 4,000 psi (13.8-20.7 MPa)	
"K" FACTOR	4.75 (Btu•in)/(h•ft²•°F) (.6840 W/[m•°C])		5.15 (Btu•in)/(h•ft²•°F) (.7416 W/[m•°C])		4.96 (Btu•in)/(h•ft²•°F) (.7142 W/[m•°C])		4.76 (Btu•in)/(h•ft²•°F) (.6854 W/[m•°C])	
SPECIFIC HEAT	.223 Btu/(lb•°F) at 85 °F (.9343 kJ[kg•°C]at 29.44 °C)		.222 Btu/(lb•°F) at 85 °F (.9301 kJ[kg•°C]at 29.44 °C)		.224 Btu/(lb•°F) at 85 °F (.9385 kJ[kg•°C]at 29.44 °C)		.229 Btu/(lb•°F) at 85 °F (.9595 kJ[kg•°C]at 29.44 °C)	
WEIGHT (approximate)	3/4"	7.2 lbs/ft² (35.1 kg/m²)	3/4"	7.2 lbs/ft² (35.1 kg/m²)	3/4"	7.2 lbs/ft² (35.1 kg/m²)	3/4"	7.5 lbs/ft² (36.6 kg/m²)
	1"	9.6 lbs/ft² (46.8 kg/m²)	1"	9.6 lbs/ft² (46.8 kg/m²)	1"	9.6 lbs/ft² (46.8 kg/m²)	1"	10.0 lbs/ft² (46.9 kg/m²)
	1½"	14.4 lbs/ft² (70.2 kg/m²)	1½"	14.4 lbs/ft² (70.2 kg/m²)	1½"	14.4 lbs/ft² (70.2 kg/m²)	1½"	15 lbs/ft² (73.2 kg/m²)
DRY DENSITY	110-120 lbs/ft3 (1762-1922 kg/m3)		110-120 lbs/ft3 (1762-1922 kg/m3)		110-120 lbs/ft3 (1762-1922 kg/m3)		115-125 lbs/ft3 (1842-2002 kg/m3)	
SURFACE BURNING CHARACTERISTICS (ASTM-E84)	Flame spread: 0 Fuel contributed: 0 Smoke density: 0							

Maxxon gypsum underlayments retain their strength when re-dried after being immersed in water for 30 days. Gyp-Crete Performance Test, Telco Report #9-018.

Designing for Safety & Sound Control: Maxxon Fire & Sound Manual

Streamline the process of specifying products to meet requirements for fire safety and acoustical performance. Access the Maxxon Fire & Sound manual to help determine the right assembly, along with correct codes and resources, based on your project's construction type.



UNDERLAYMENT THICKNESS OVER WOOD SUBFLOORS

Subfloor Thickness	Truss, Beam or Joist Spacing	Min. Thickness of Underlayment
19/32" (15 mm) [5/8"]	16–19.2" o.c. (406–487 mm)	3/4" (19 mm)C
19/32" (15 mm) [5/8"]	19.2–24" o.c. (487–610 mm)	1" (25 mm)
23/32" (19 mm) [3/4"]	16–24" o.c. (406–610 mm)	3/4" (19 mm)

ICC G2-2010 GUIDELINE FOR ACOUSTICS

	Laboratory Sound Rating	Field Sound Rating
Code Minimum	50 STC/IIC	45 F-STC/F-IIC
Acceptable Performance	55 STC/IIC	52 F-STC/F-IIC
Preferred Performance	60 STC/IIC	57 F-STC/F-IIC

SINCE THE BEGINNING,

solving problems has been a Maxxon trademark. We invented Gyp-Crete and Acousti-Mat, creating a new industry for building in multifamily construction.

Now we offer a full product portfolio to deliver great results for the commercial flooring industry, too. Our proven know-how, scientific innovation, fully invested customer service and skilled, knowledgeable team bring time-saving, cost-effective solutions to the commercial industry.

Concrete Repair & Renovation • Moisture Mitigation Systems • Primers & Sealers
Leveling & Patch Solutions • Topical Sound Control

Choose from our wide range of products to determine the best system for your project. And, if you'd like help evaluating your options, check out our online system selector at maxxon.com. Prefer to talk it over? We're happy to share our expertise, simply contact your regional representative at (800) 356-7887.

MAXXON®
BENEATH IT ALL, MAXXON DELIVERS.™

Maxxon Corporation • 920 Hamel Road • P.O. Box 253 Hamel, MN 55340 USA
info@maxxon.com • maxxon.com

©2023 Maxxon Corporation. All Rights Reserved. Gyp-Crete, Acousti-Mat and associated logos are registered trademarks of Maxxon Corporation, Hamel, MN, USA. Maxxon Corporation assumes no responsibility or liability for any errors or omissions in the content of this document. The information contained is subject to change without notice. Follow local and state regulations and use appropriate safety precautions and measures when installing Maxxon products. See related product literature at Maxxon.com or contact Maxxon Corporation for more information prior to installation