

# ABS & PVC-DWV Fittings

5800 Series - ABS/4800 Series PVC

## ELBOWS (Continued)

**5806-2 4806-2**

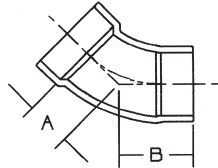

### 45° Street Ell (Spig x Hub)

NOM. SIZE	ABS APPROX. NET WT./LBS.	PVC APPROX. NET WT./LBS.	DIM. A INCHES	DIM. B INCHES
1 <sup>1</sup> / <sub>4</sub>	.100	.136	1	1 <sup>3</sup> / <sub>4</sub>
1 <sup>1</sup> / <sub>2</sub>	.134	.174	1 <sup>1</sup> / <sub>8</sub>	1 <sup>7</sup> / <sub>8</sub>
2	.201	.277	1 <sup>7</sup> / <sub>16</sub>	2 <sup>1</sup> / <sub>4</sub>
3	.601	.818	1 <sup>3</sup> / <sub>4</sub>	3 <sup>1</sup> / <sub>4</sub>
4	1.048	1.464	2 <sup>3</sup> / <sub>16</sub>	3 <sup>15</sup> / <sub>16</sub>
6	2.772	3.950	3 <sup>3</sup> / <sub>8</sub>	6 <sup>3</sup> / <sub>8</sub>
† 8	N/A	5.738	2 <sup>1</sup> / <sub>16</sub>	6 <sup>1</sup> / <sub>16</sub>
† 8 x 6 F	N/A	6.500	2 <sup>1</sup> / <sub>16</sub>	5
† 8 x 4 F	N/A	6.200	2 <sup>1</sup> / <sub>16</sub>	3 <sup>3</sup> / <sub>4</sub>

**5807 4807**

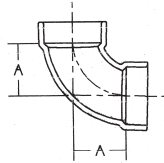

### 90° Ell (Hub x Hub)

NOM. SIZE	ABS APPROX. NET WT./LBS.	PVC APPROX. NET WT./LBS.	DIM. A INCHES
1 <sup>1</sup> / <sub>4</sub>	.122	.184	1 <sup>9</sup> / <sub>16</sub>
1 <sup>1</sup> / <sub>2</sub>	.149	.204	1 <sup>3</sup> / <sub>4</sub>
2	.248	.331	2 <sup>5</sup> / <sub>16</sub>
3	.724	1.008	3
4	1.278	1.840	3 <sup>7</sup> / <sub>8</sub>
6	3.453	4.666	5 <sup>5</sup> / <sub>8</sub>
† 8	N/A	8.553	5 <sup>31</sup> / <sub>32</sub>

**5807-CL 4807-CL**

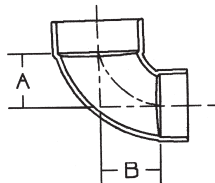

### 90° Closet Ell (Hub x Hub)

NOM. SIZE	ABS APPROX. NET WT./LBS.	PVC APPROX. NET WT./LBS.	DIM. A INCHES	DIM. B INCHES
4 x 3	1.044	1.448	3	3 <sup>3</sup> / <sub>8</sub>

**5807-LT 4807-LT**

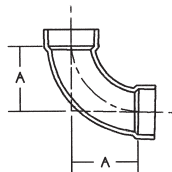

### 90° Long Turn Ell (Hub x Hub)

NOM. SIZE	ABS APPROX. NET WT./LBS.	PVC APPROX. NET WT./LBS.	DIM. A INCHES
* 1 <sup>1</sup> / <sub>4</sub>	.164	N/A	2 <sup>1</sup> / <sub>4</sub>
1 <sup>1</sup> / <sub>2</sub>	.206	.279	2 <sup>11</sup> / <sub>16</sub>
2	.291	.409	3 <sup>7</sup> / <sub>32</sub>
3	.855	1.268	4 <sup>1</sup> / <sub>16</sub>
4	1.542	2.114	4 <sup>15</sup> / <sub>16</sub>

† Available in PVC only

F Fabricated

Do not use or test the products in this catalog with compressed air or other gasses.