

# WATERFRONT RESTAURANT OPPORTUNITY

Adelaide Pointe

1204 West Western Avenue, Muskegon, MI 49441



## DETAILS



### MIXED USE BUILDING

3-stories

Ground Floor	6,744 SF
Second Floor Restaurant Space + Outdoor Deck Space	4,117 SF 3,688 SF
Third Floor Event Space + Outdoor Deck Space	3,992 SF 1,181 SF

### ADDITIONAL HIGHLIGHTS

- Mass Timber Construction
- Green Building Technology
- 300 Residential Condo Units
- 270 Slip Marina
- Walking Path – 1 Mile to downtown
- Best Views of Muskegon Lake
- Residential Unit: Delivery Q1 2023
- Commercial Space: Delivery Q1 2023

**AVAILABLE**

**Winter 2023**

**DONNA BARNETT** 313.552.4005 [dbarnett@sbre1.com](mailto:dbarnett@sbre1.com)





1204 West Western Avenue, Muskegon, MI 49441



# WATERFRONT RESTAURANT OPPORTUNITY

Adelaide Pointe

1204 West Western Avenue, Muskegon, MI 49441

## DEMOGRAPHICS

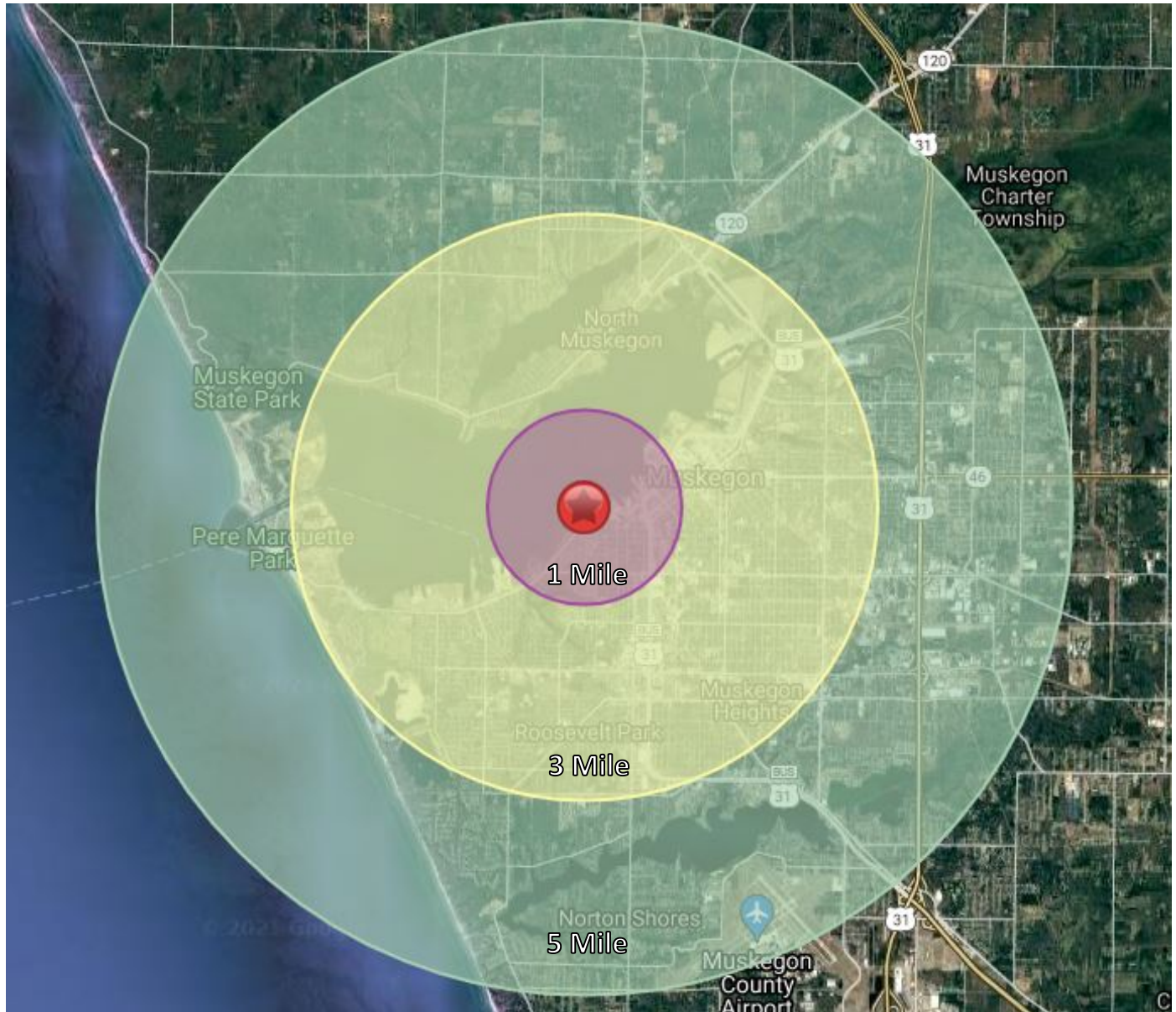

Area Demographics	1Mile	3 Mile	5 Mile
Est Population (2021)	5,107	53,842	90,564
Average HH Income	46,347	56,221	62,014
Households	2,260	21,948	37,209
Median Age	33.9	36.5	38.5

Area Demographics	1Mile	3 Mile	5 Mile
Total Businesses	130	1,911	3,022
Daytime Population	1,253	23,907	40,864



# WATERFRONT RESTAURANT OPPORTUNITY

Adelaide Pointe

1204 West Western Avenue, Muskegon, MI 49441

## SITE PLAN



# WATERFRONT RESTAURANT OPPORTUNITY

Adelaide Pointe

1204 West Western Avenue, Muskegon, MI 49441

## FLOOR PLANS

Ground Floor

6,744 SF

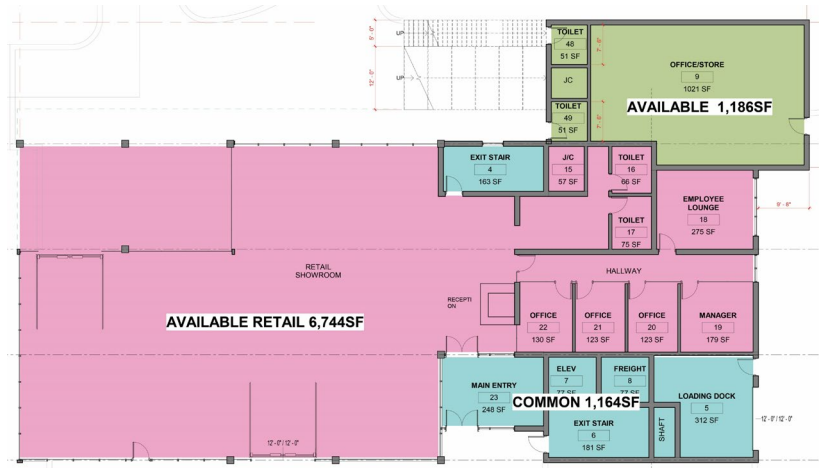

Second Floor

Restaurant Space  
+ Outdoor Deck Space

4,117 SF

3,688 SF



Third Floor Event Space  
+ Outdoor Deck Space

3,992 SF

1,181 SF



DONNA BARNETT 313.552.4005 dbarnett@sbre1.com

