

FOR LEASE - AVAILABLE DECEMBER 1

Up To 15,324 SF Of Furnished Office Space
13200 Fountain Head Plz - Fountainhead One |
Hagerstown, MD 21742



PROPERTY HIGHLIGHTS

- 3rd Flr space furnished with Steelcase brand furniture, move in ready
- Surrounded by Fountainhead Plaza Shopping Center with restaurants, wellness clinic, banking and more
- Within walking distance of Fountain Head County Club
- 3 Miles from the Hagerstown Regional Airport
- Easy access to the city's public transportation network and the I-81 corridor
- Built using Recycled Construction Materials from Rapidly Renewable Resources
- Featuring an Advanced Air-Quality Management System



For Information Contact:

Treva Ghattas, Sales and Leasing Associate
treva@murphycre.com
410.266.1113

FOR LEASE

Up To 15,324 Sf Of Office Space
13200 Fountain Head Plz - Fountainhead One |
Hagerstown, MD 21742



For Information Contact:

Treva Ghattas, Sales and Leasing Associate
treva@murphycre.com
410.266.1113

FOR LEASE

Up To 15,324 SF Of Office Space
13200 Fountain Head Plz - Fountainhead One |
Hagerstown, MD 21742

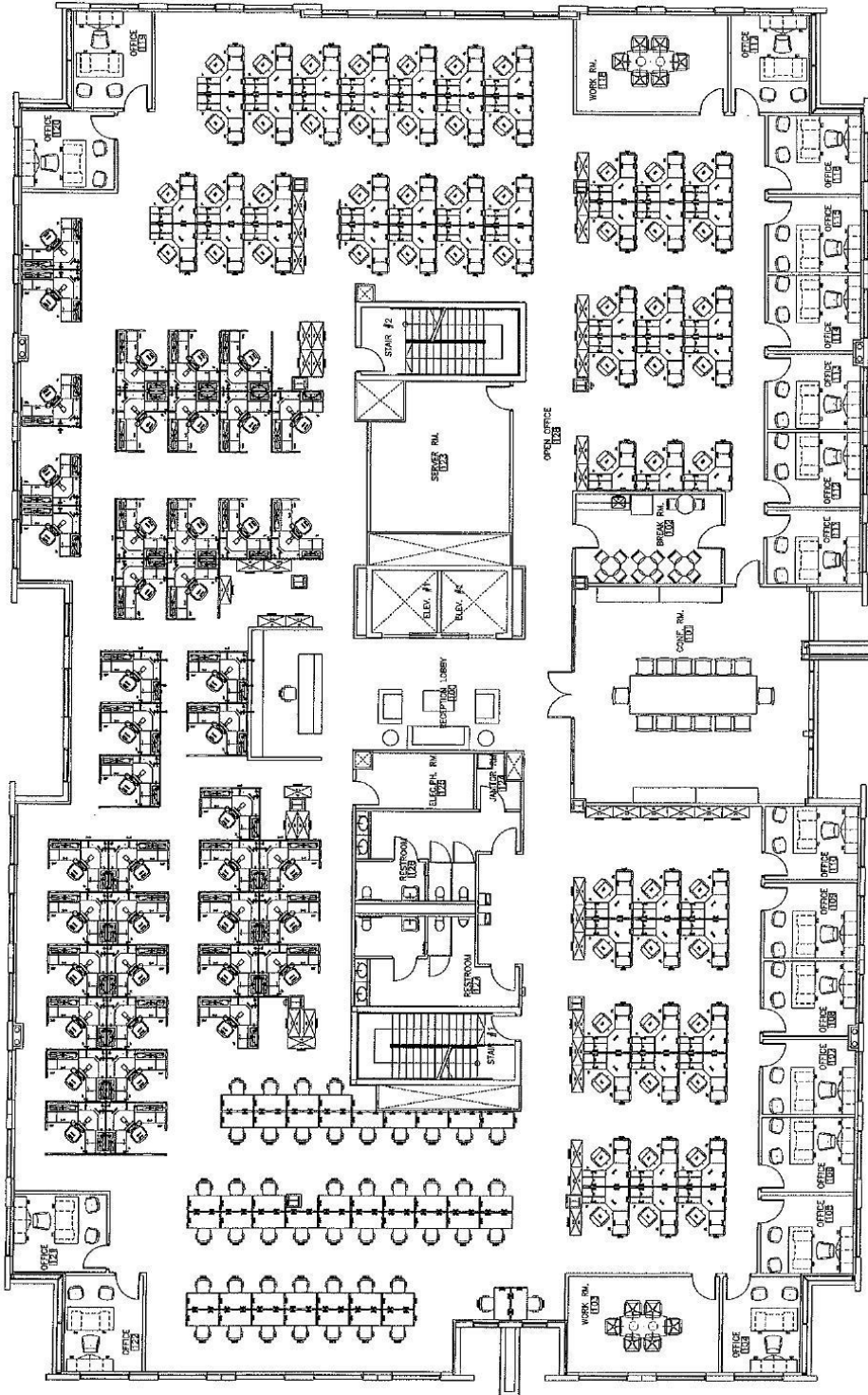

For Information Contact:

Treva Ghattas, Sales and Leasing Associate
treva@murphycre.com
410.266.1113

FOR LEASE

Up To 15,324 SF Of Office Space
13200 Fountain Head Plz - Fountainhead One |
Hagerstown, MD 21742

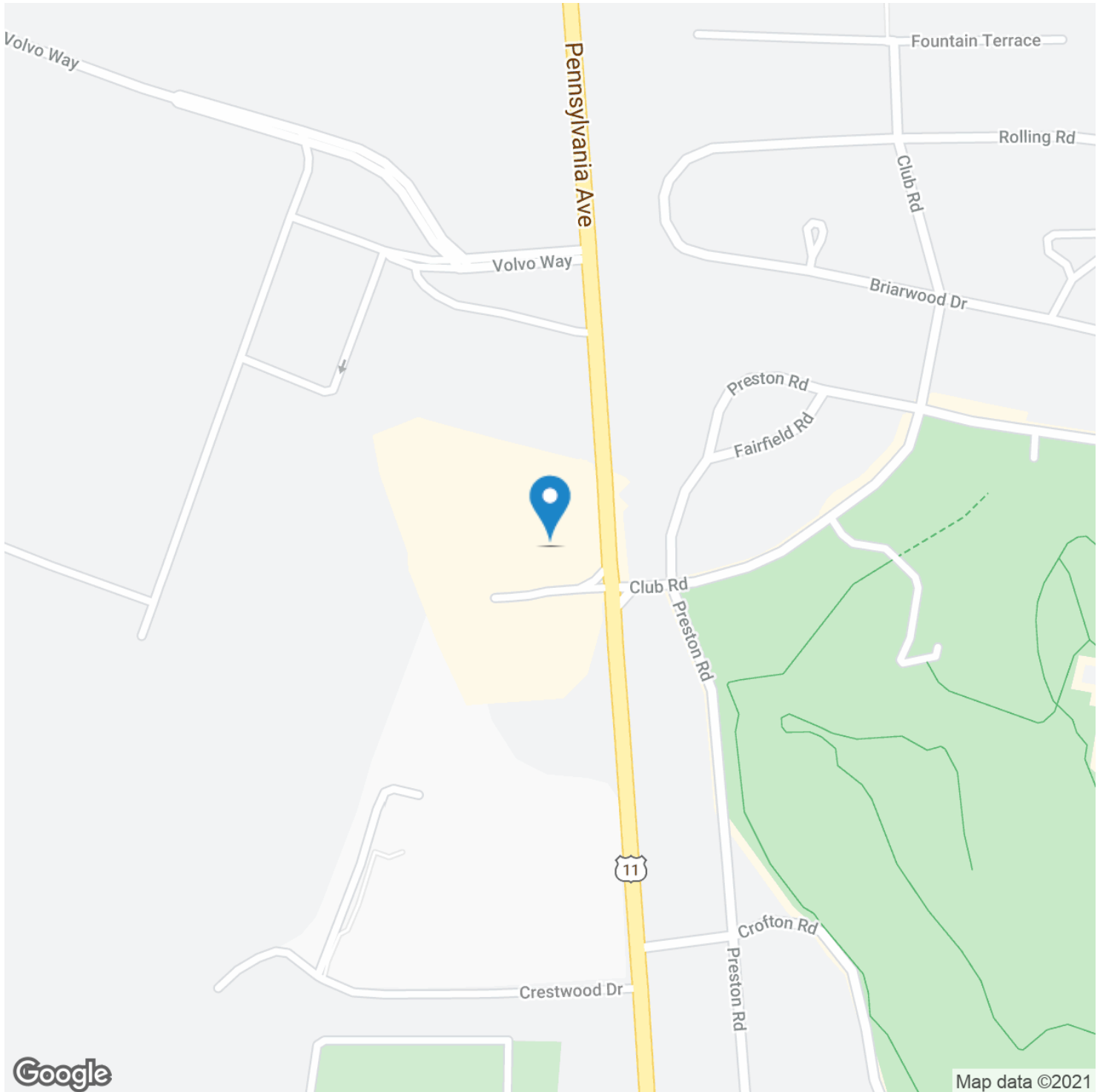

For Information Contact:

Treva Ghattas, Sales and Leasing Associate
treva@murphycre.com
410.266.1113

FOR LEASE

Up To 15,324 SF Of Office Space
 13200 Fountain Head Plz - Fountainhead One |
 Hagerstown, MD 21742

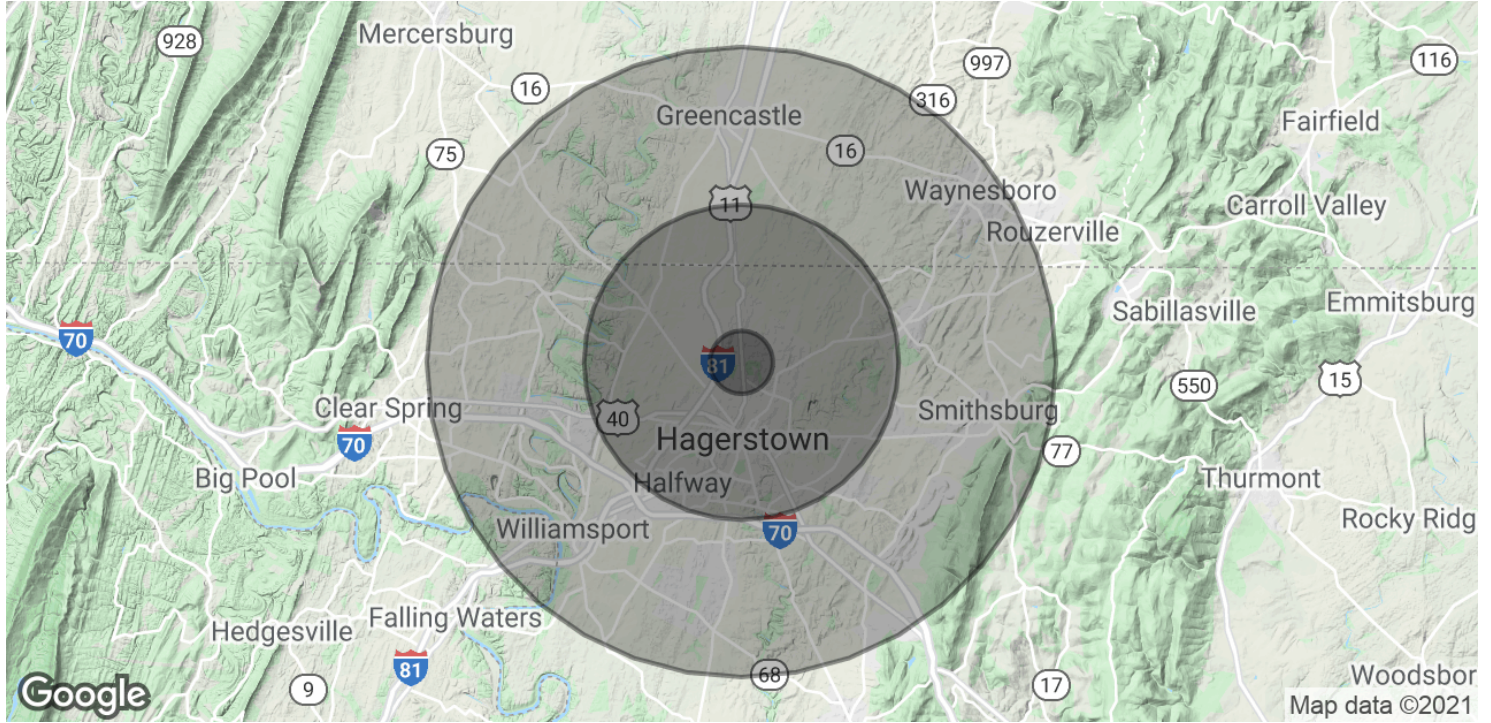

POPULATION	1 MILE	5 MILES	10 MILES
Total Population	4,101	86,446	163,367
Average age	40.4	37.7	38.7
Average age (Male)	40.5	35.9	37.4
Average age (Female)	40.4	39.0	38.8
HOUSEHOLDS & INCOME	1 MILE	5 MILES	10 MILES
Total households	1,577	34,950	62,867
# of persons per HH	2.6	2.5	2.6
Average HH income	\$73,824	\$59,293	\$65,568
Average house value	\$221,818	\$233,527	\$240,157

* Demographic data derived from 2010 US Census

For Information Contact:

Treva Ghattas, Sales and Leasing Associate
 treva@murphycre.com
 410.266.1113