



Portage Trail Ext.

Cuyahoga Falls, OH 44223

Property Features

- Excellent Visibility
- Located near Portage Trail Ext. W. and Northampton Rd. Intersection
- Approximately 1.25 miles from Portage Crossing retail area
- Zoned R-5

Parcel A #70-02663 \$300,000

4.35 acres
Approximately 930' frontage and 233' depth

Parcel B #70-00935 \$250,000

9.138 acres
Approximately: 930' wide by 631' to 267" deep

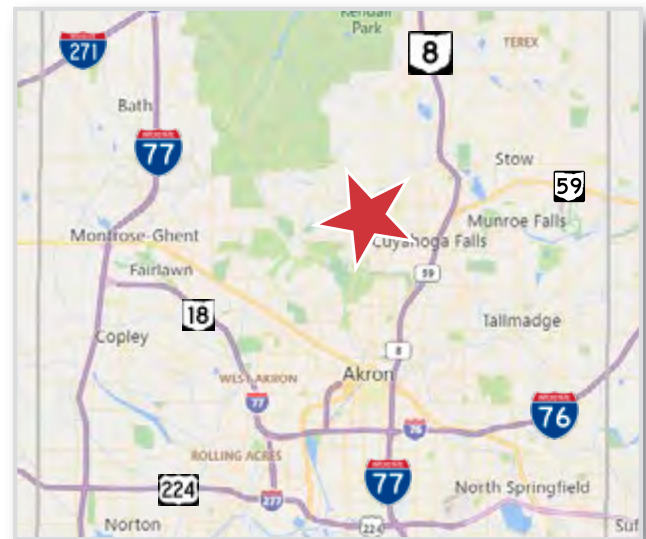

For more information:

Ronald Midcap II
+1 216 455 0900
RMidcap@naipvc.com

Merriman Valley



Portage Crossing

| Demographics | 1 Mile | 3 Miles | 5 Miles |
|--------------------|---------------------------------------|----------|----------|
| Population: | 6,361 | 73,712 | 171,874 |
| Households: | 3,202 | 33,100 | 75,534 |
| Median Age: | 33.3 | 41 | 40.6 |
| Average HH Income: | \$65,163 | \$72,832 | \$69,781 |
| Traffic: | 16,980 Portage Trail @ Northampton Rd | | |

Portage Trail Ext. West
Cuyahoga Falls, OH 44223

Ronald Midcap II
+1 216 455 0900
RMidcap@naipvc.com

6155 Rockside Rd., Suite 304
Independence, Ohio 44131
216 831 3310
naipvc.com

