

Medical Space For Lease Maplewood Professional Building



Maplewood Professional Building

1655 Beam Avenue | Maplewood, MN 55109

Building Size: 48,281 sq. ft.
Space Available: 11,522 sq. ft.

- Located on HealthEast St. John's Hospital Campus
- Connected to both Hospital and Beam Professional Bldg
- Convenient location on Beam Avenue, adjacent to plentiful retail and restaurants, including Maplewood Mall, Costco, and others
- Easily accessible from I-694 and Highway 61
- Ample parking on surface lot

Net Rental Rate: \$22.50 sq. ft.
Operating Expenses: \$10.86 sq. ft.
Real Estate Taxes: \$4.99 sq. ft.

Anne E. Madyun
612.454.4172
amadyun@davishre.com
davishre.com

Jill K. Rasmussen CCIM, SIOR
612.341.3247
jrasmussen@davishre.com



BUILDING TENANTS:

HealthEast St. John's Hospital
Metro OBGYN
Twin Cities Oral & Maxillofacial Surgery



TRAFFIC COUNT

15,900 vehicles on Beam Ave A.A.D.T.
(average annual daily traffic)
85,000 vehicles on I-694



2020 ESTIMATED POPULATION

1 mile: 4,791
3 miles: 71,095
5 miles: 224,569



2020 ESTIMATED AVERAGE HOUSEHOLD INCOME

1 mile: \$63,493
3 miles: \$70,443
5 miles: \$64,440



Maplewood Professional Building

1655 Beam Avenue, Maplewood, MN 55109

1st Floor



Suite 108
2,265 SF



Maplewood Professional Building

1655 Beam Avenue, Maplewood, MN 55109

2nd Floor

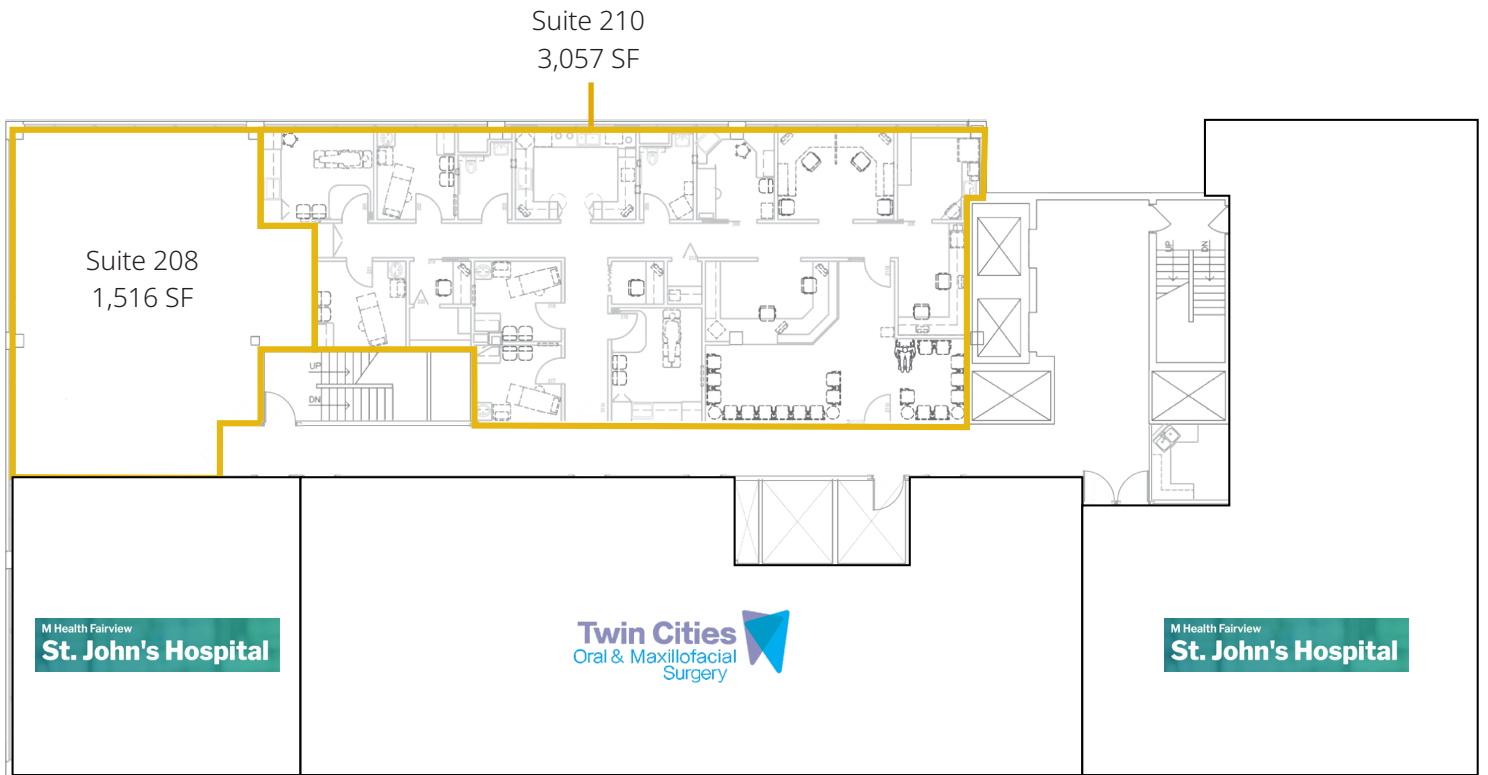



Maplewood Professional Building

1655 Beam Avenue, Maplewood, MN 55109

3rd Floor

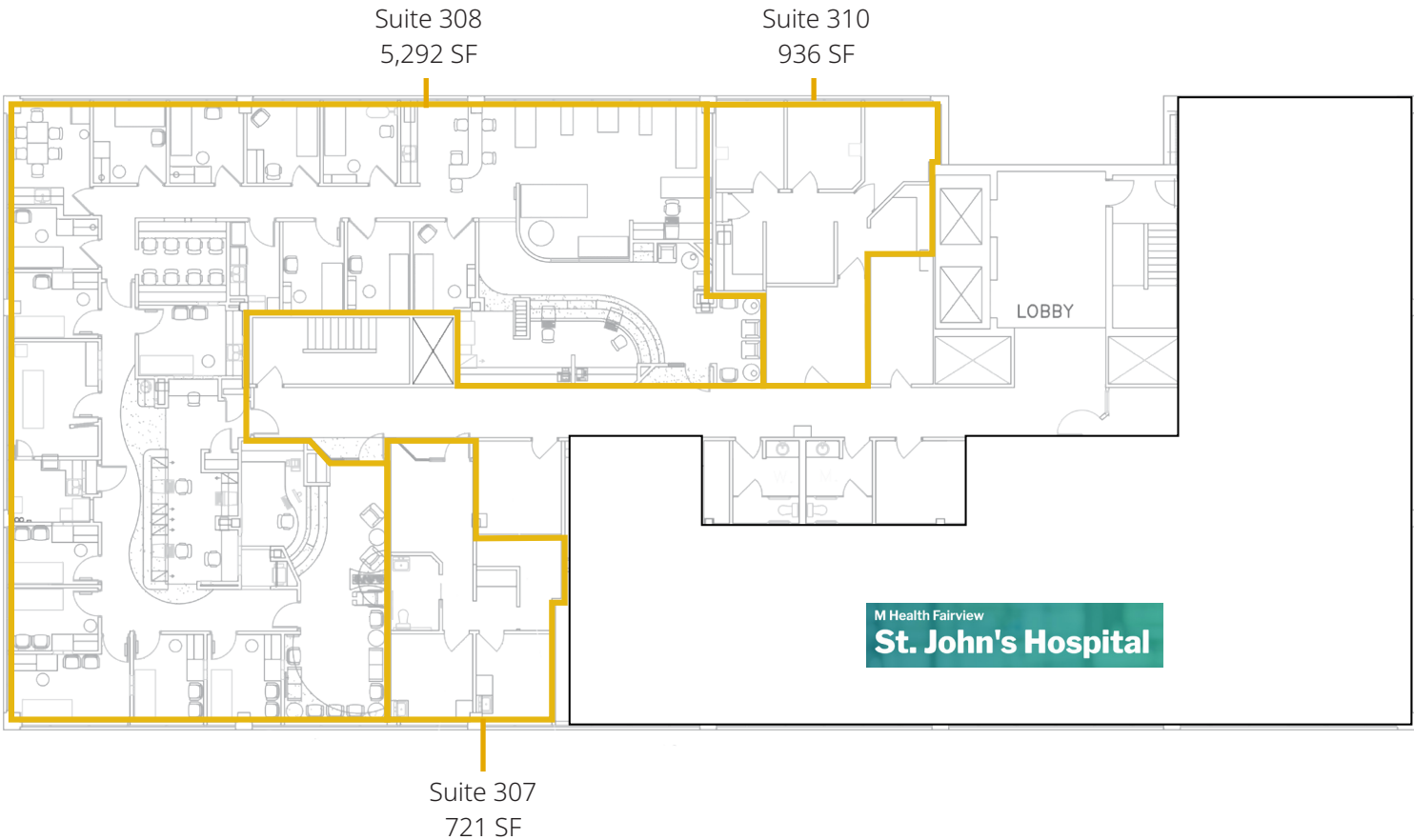



Maplewood Professional Building

1655 Beam Avenue, Maplewood, MN 55109





Maplewood Professional Building

1655 Beam Avenue, Maplewood, MN 55109

