



Eagle Point Medical Building

8515 Eagle Point Blvd, Lake Elmo, MN 55042

Building Size: 29,791 sq. ft.
Space Available: 3,456 sq. ft.

- One space remaining!
- Great access to Radio Drive and visibility along Inwood Ave N
- Close proximity to I-94 and I-494/694
- Class "A" beautiful interior and exterior finishes
- Prominent signage opportunities
- Strong area demographics
- Ample parking at 5/1000 for patients, staff, and physicians
- Covered drop off canopy
- Adjacent to Woodbury Retail Hub

Net Rental Rate: Negotiable
Operating Expenses: \$9.89 /sq. ft.
Real Estate Taxes: \$7.45/sq. ft.

Jill K. Rasmussen CCIM, SIOR
612.341.3247
jrasmussen@davishre.com

Anne E. Madyun
612.454.4172
amadyun@davishre.com

davishre.com



BUILDING TENANTS

Noran Neurological
HealthPartners Dental Specialty Center



TRAFFIC COUNT

13,100 vehicles on Inwood Ave N A.A.D.T.
(average annual daily traffic)
105,000 vehicles on I-94



2019 ESTIMATED POPULATION

1 mile: 2,561
3 miles: 53,351
5 miles: 161,163



2019 ESTIMATED AVERAGE HOUSEHOLD INCOME

1 mile: \$133,849
3 miles: \$115,335
5 miles: \$109,094



PHYSICIANS REALTY TRUST



Eagle Point Medical Building

8515 Eagle Point Blvd, Lake Elmo, MN 55042

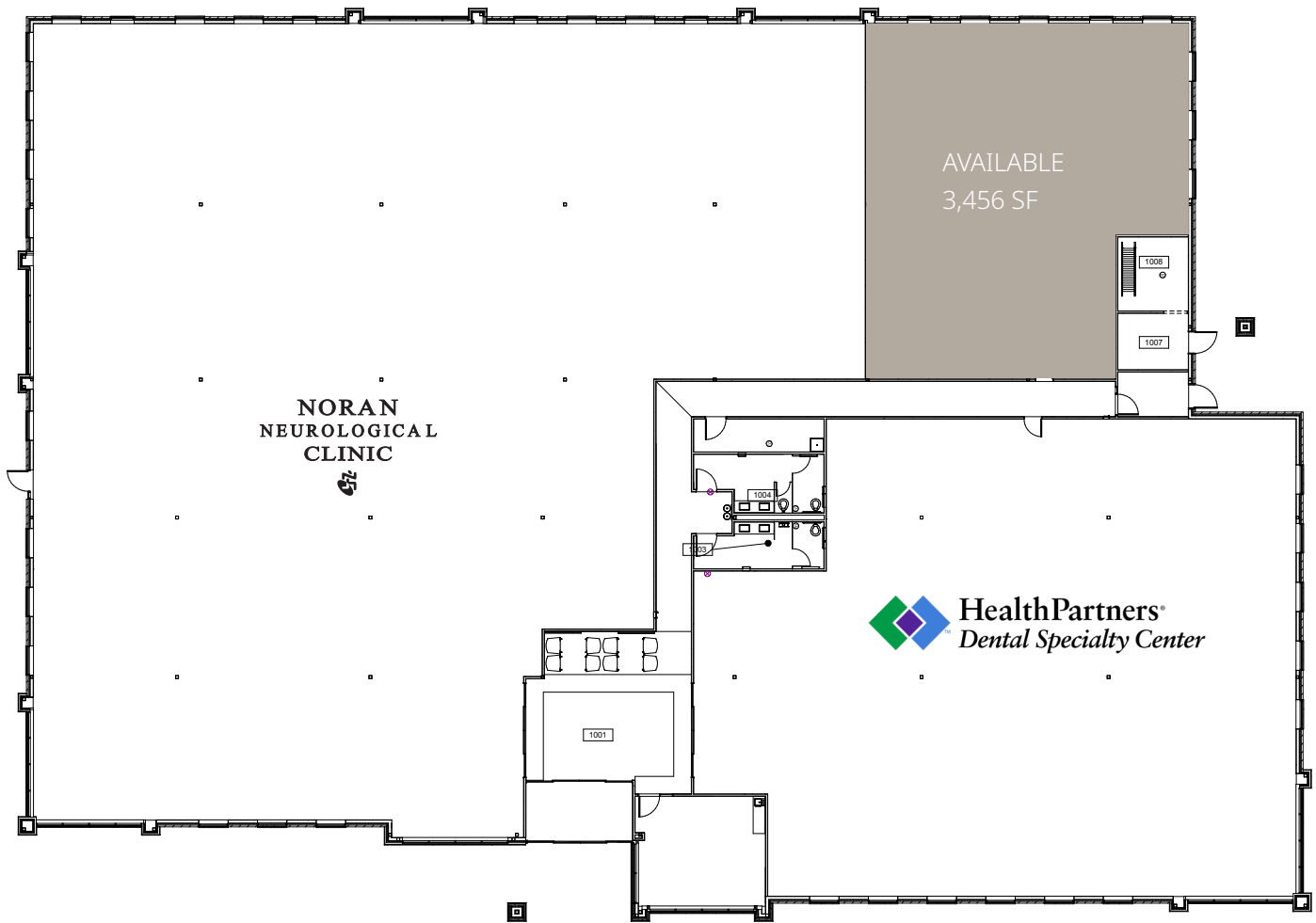



Eagle Point Medical Building

8515 Eagle Point Blvd, Lake Elmo, MN 55042





Eagle Point Medical Building

8515 Eagle Point Blvd, Lake Elmo, MN 55042

