



AVAILABLE

Amy's
DRIVE THRU
COMING
SOON

N MOORPARK RD

N MOORPARK RD

ENDCAP LOCATION RESTAURANT SPACE

THOUSAND OAKS, CA

398 N Moorpark Rd.
FOR LEASE | 4,000 SF | ENDCAP



ENDCAP RESTAURANT

THOUSAND OAKS, CA

Endcap restaurant opportunity at busy Best Buy Plaza in Conejo Valley. Join a strong lineup of tenants at a prime Thousand Oaks location. The property is highly visible from North Moorpark Road and is located directly across from Janss Marketplace.

- Endcap location; adjacent to future Amy's Drive Thru
- Property located at a high visibility intersection near a new Starbucks Drive-thru and Aldi at Janss Marketplace.
- Densely populated area with close proximity to regional shopping centers and commuter freeways

LOCATION

398 N Moorpark Road
SEC N. Moorpark Rd & Brazil Street
Thousand Oaks, CA 91360

AVAILABLE

Endcap Restaurant | 4,000 SQ FT

IN GOOD COMPANY

Key area tenants near Best Buy Plaza include Nordstrom Rack, Ulta, Regal Cinemas, Whole Foods, Chick-fil-A and The Oaks Mall.

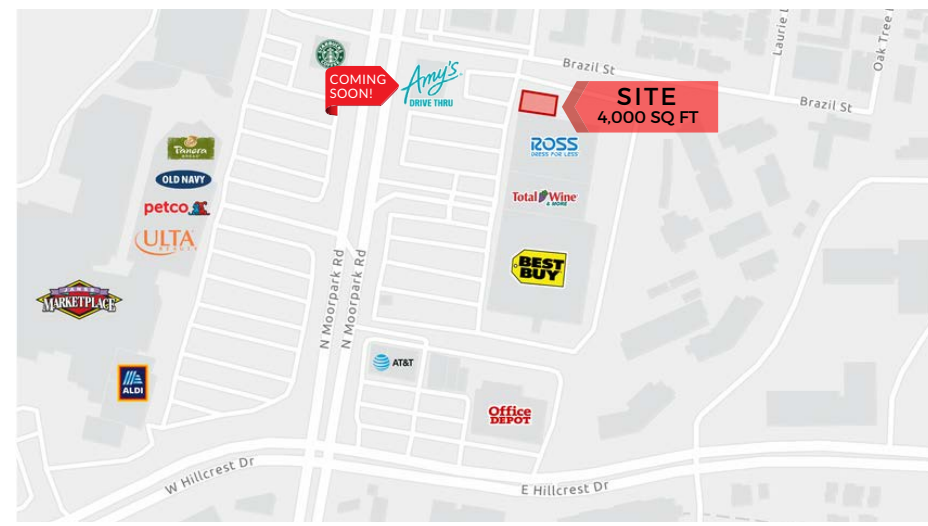

COMMERCIAL WEST BROKERAGE
Phil Berry, LIC# 1208635
Matthew Berry, LIC# 2134414
mberry@commercialwest.com | 949.723.7300

398 N MOORPARK RD.

4,000 SF AVAILABLE

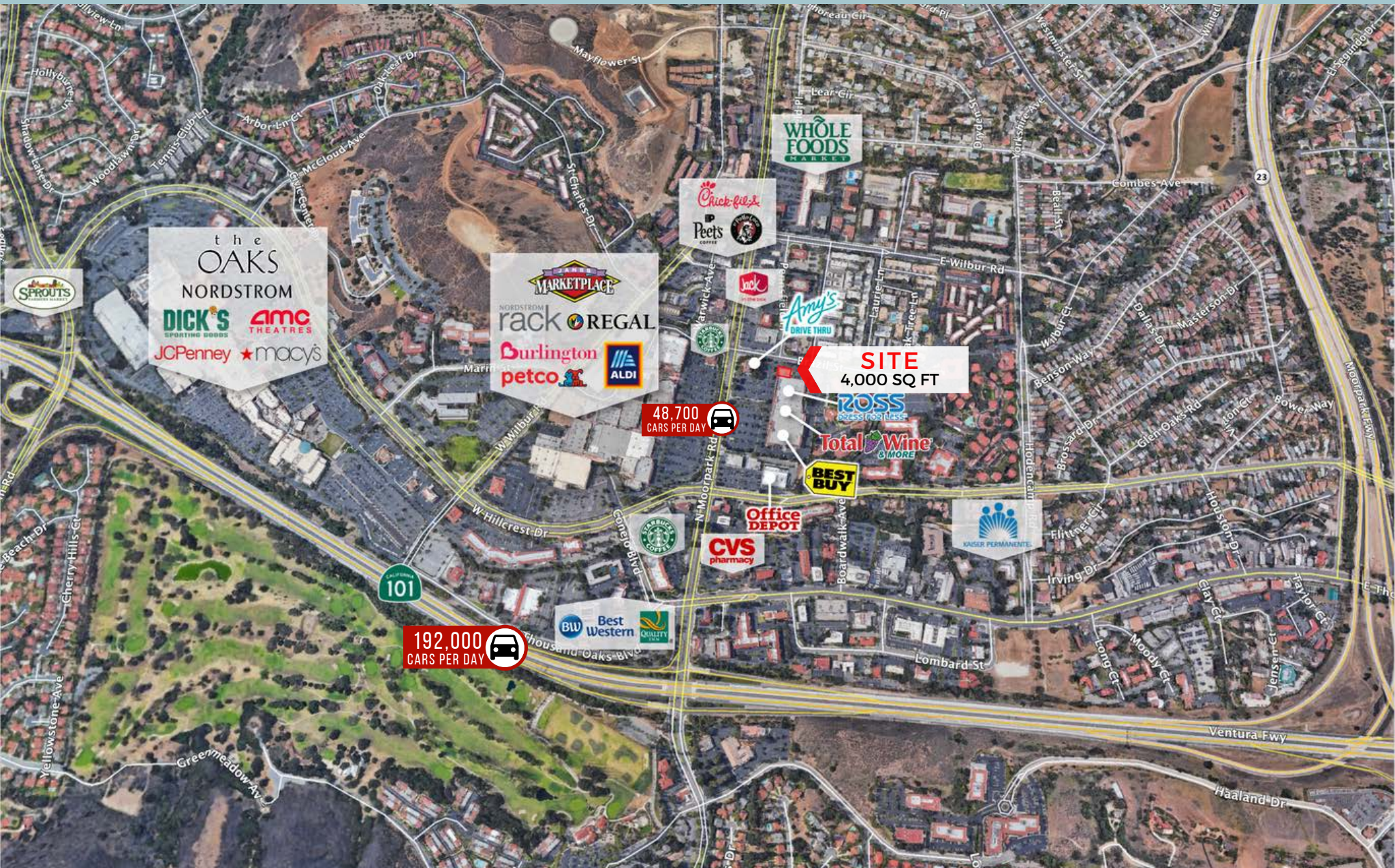

BEST BUY PLAZA
THOUSAND OAKS, CA

COMMERCIAL WEST BROKERAGE
Phil Berry, LIC# 1208635
Matthew Berry, LIC# 2134414
mberry@commercialwest.com | 949.723.7300

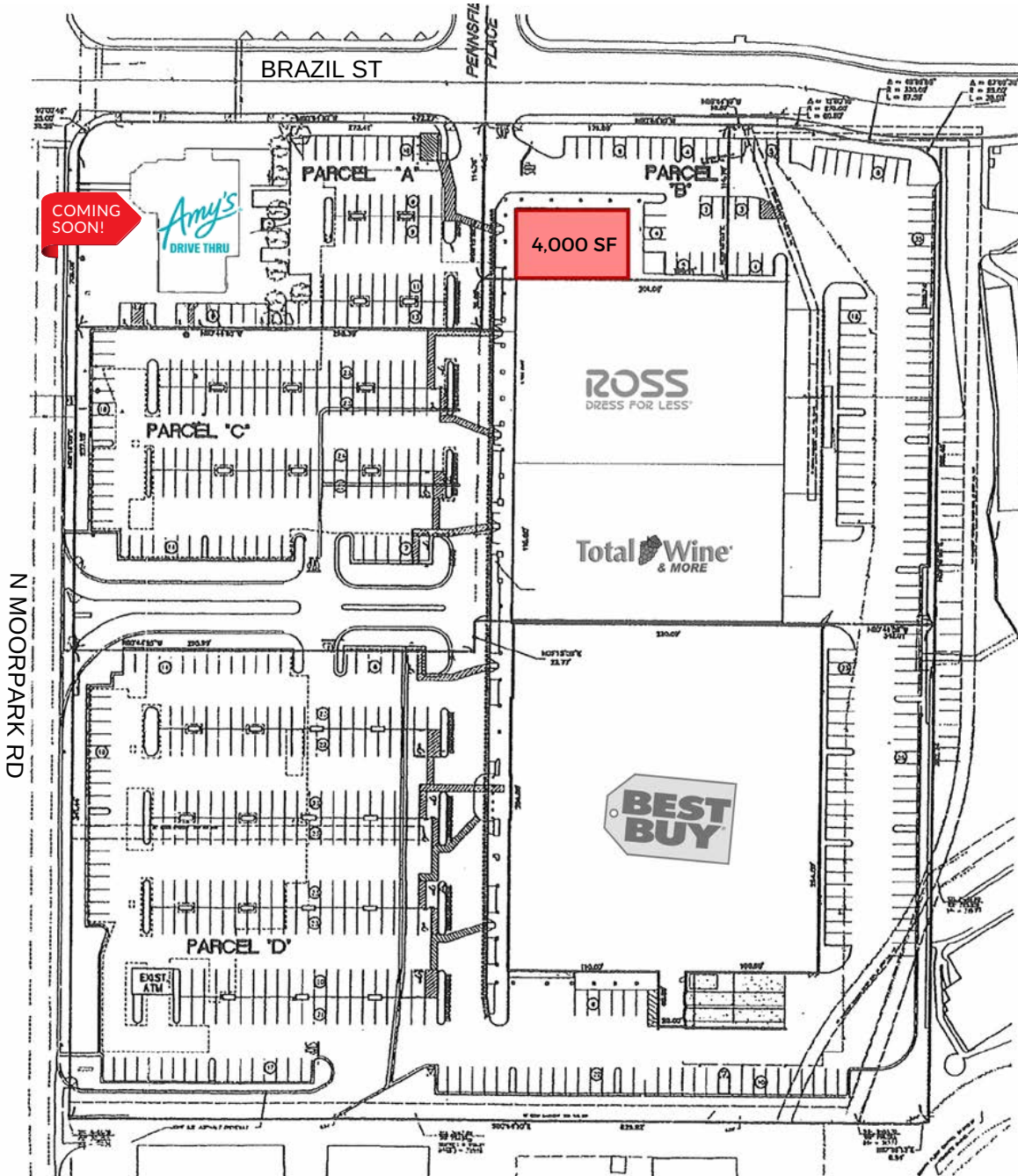

VICINITY

AVAILABLE:
 398 N Moorpark Rd.
 Thousand Oaks, CA

Endcap | 4,000 SQ FT

**BEST BUY PLAZA
 THOUSAND OAKS, CA**



COMMERCIAL WEST BROKERAGE
 Phil Berry, LIC# 1208635
 Matthew Berry, LIC# 2134414
 mberry@commercialwest.com | 949.723.7300



THOUSAND OAKS CALIFORNIA



BY THE NUMBERS

AREA POPULATION

- 1 mi | 11,155
- 2 mi | 34,395
- 3 mi | 78,687



BY THE NUMBERS

AVERAGE INCOME

- 1 mi | \$102,422
- 2 mi | \$117,498
- 3 mi | \$133,121



TRAFFIC COUNT

N Moorpark Rd. | 48,700 CPD
CA-101 Fwy | 192,000 CPD

CONTACT

COMMERCIAL WEST BROKERAGE
Phil Berry, LIC# 1208635
Matthew Berry, LIC# 2134414
mberry@commercialwest.com | 949.723.7300

