

SALTZMAN VILLAGE

605 NW Saltzman Road | Portland OR 97229

FOR LEASE



RETAIL/OFFICE SPACE AVAILABLE FOR LEASE

DETAILS

- Lease Rate: Call for Details + NNN
- One Space Available

FEATURES

- **Suite 485**
 - Rentable Area: $\pm 1,200$ SF
 - Office/Retail space, with new buildout, 2 offices
- Busy retail center with solid tenant mix
- Ample On-Site Parking
- Signage available with visibility from NW Barnes, Saltzman, and Cornell Roads, and access to Hwy 26
- Close to Sunset Mall and Columbia Sportswear HQ

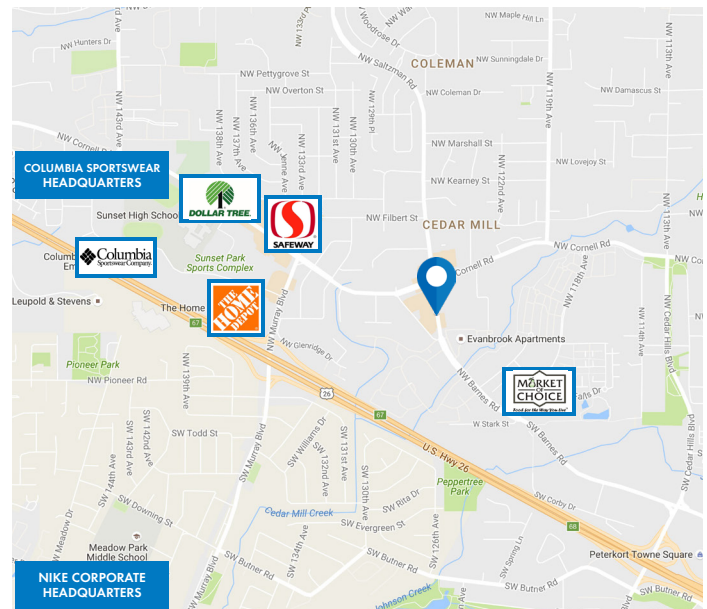

07.11.2019

For more information or a property tour, please contact:

LUIS MARTIN DEL CAMPO

503.416.8422

LuisM@norris-stevens.com

MARISSA LEE

503.225.8449

Marissal@norris-stevens.com

Norris & Stevens

INVESTMENT REAL ESTATE SERVICES



Information contained herein has been obtained from others and considered to be reliable; however, a prospective purchaser or lessee is expected to verify all information to his/her own satisfaction.

900 SW 5th Avenue • 17th Floor • Portland, OR 97204
503.223.3171 • norris-stevens.com

SALTZMAN VILLAGE

605 NW Saltzman Road | Portland OR 97229

FOR LEASE

SITE PLAN

Site Plan

TENANT LIST:

405	JG Barbars	800 SF
415	Cedar Hills Cleaners	800 SF
421	Teriyaki Beef Bowl	800 SF
425	Dennis' Market	2,400 SF
455	Joy Poke	1,181 SF
465	China Rim	845 SF
475	Red Rose Spa	1,200 SF
485	AVAILABLE	1,200 SF
495	Occupied	1,200 SF
515	Mailboxes and More	1,200 SF
525	The Wine Cellar	2,400 SF
575	Bleachers Grill & Pub	3,146 SF
12660	Hoffman Academy of Music	1,585 SF
12640	Baby & Me	3,110 SF
12670	College Nanny	932 SF
625	Laughing Planet	2,400 SF
555	Dairy Queen	2,806 SF

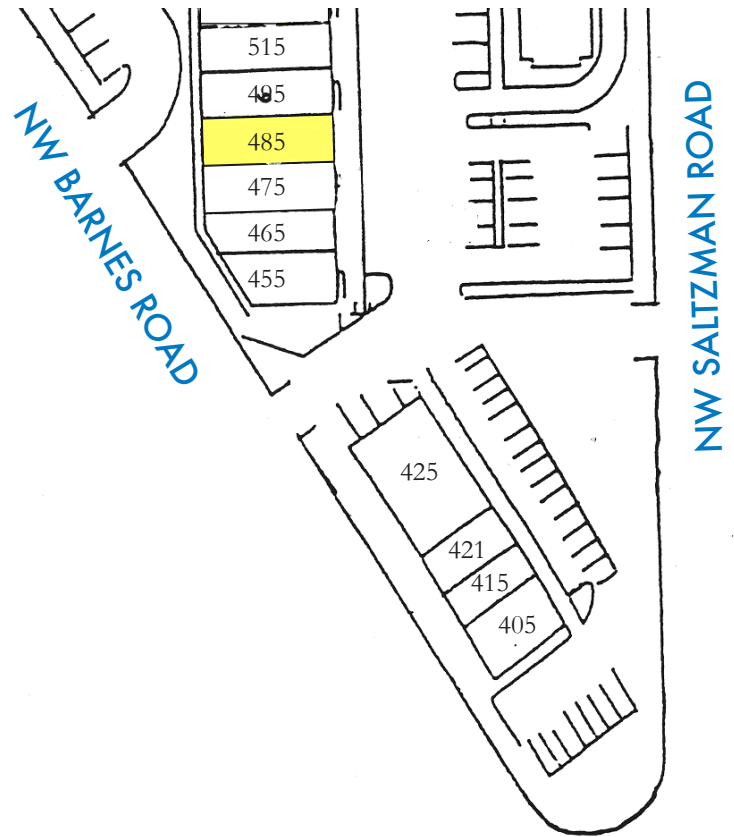

For more information or a property tour, please contact:

LUIS MARTIN DEL CAMPO

503.416.8422

LuisM@norris-stevens.com

MARISSA LEE

503.225.8449

Marissal@norris-stevens.com

Norris & Stevens

INVESTMENT REAL ESTATE SERVICES



Information contained herein has been obtained from others and considered to be reliable; however, a prospective purchaser or lessee is expected to verify all information to his/her own satisfaction.

900 SW 5th Avenue • 17th Floor • Portland, OR 97204

503.223.3171 • norris-stevens.com