

SHERWOOD INDUSTRIAL PARK

20746 SW Olds Place | Sherwood OR 97140

FOR LEASE



INDUSTRIAL SPACE FOR LEASE

DETAILS

- Lease Rate: \$1.13/SF/NNN
- Suite 102-104: ± 6,000 SF - Can divided into three ± 2,000 SF spaces
- Suite 302: ± 766 SF Office Space

FEATURES

- 3 Building Industrial Center
- Warehouse with Offices and Grade Doors
- Heavy On-Site Parking
- Just off SW Tualatin Sherwood Road with Easy Access to Hwy 99
- Close to Sherwood Market Center, Parkway Village at Sherwood, Walmart, Target, and Home Depot
- Located in the Heart of the Sherwood-Tualatin Business Markets

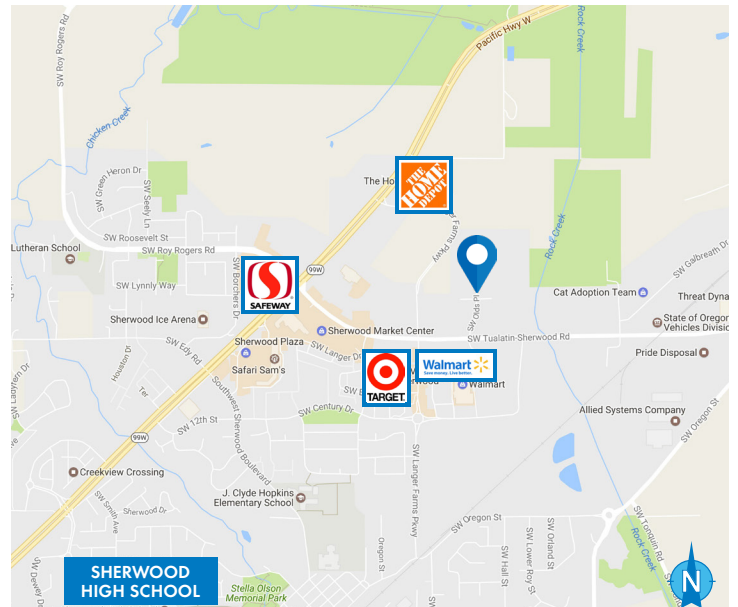

01.22.2021

For More Information or a Property Tour, Please Contact:

NICK CHESSAR
503.225.8469
NickC@norris-stevens.com

SCOTT FINNEY, SIOR
503.225.8431
ScottF@norris-stevens.com

Norris & Stevens

INVESTMENT REAL ESTATE SERVICES



Information contained herein has been obtained from others and considered to be reliable; however, a prospective purchaser or lessee is expected to verify all information to his/her own satisfaction.

900 SW 5th Avenue • 17th Floor • Portland, OR 97204
503.223.3171 • norris-stevens.com

SHERWOOD INDUSTRIAL PARK

20746 SW Olds Place | Sherwood OR 97140

FOR LEASE

SITE PLAN

Suite 102-104 6,234 SF

Suite 302 766 SF



For More Information or a Property Tour, Please Contact:

NICK CHESSAR
503.225.8469
NickC@norris-stevens.com

SCOTT FINNEY, SIOR
503.225.8431
ScottF@norris-stevens.com

Norris & Stevens

INVESTMENT REAL ESTATE SERVICES



Information contained herein has been obtained from others and considered to be reliable; however, a prospective purchaser or lessee is expected to verify all information to his/her own satisfaction.

900 SW 5th Avenue • 17th Floor • Portland, OR 97204
503.223.3171 • norris-stevens.com

SHERWOOD INDUSTRIAL PARK

20746 SW Olds Place | Sherwood OR 97140

FOR LEASE

FLOOR PLANS

± 6,234 SF total, or
can divided into three
± 2,000 SF spaces

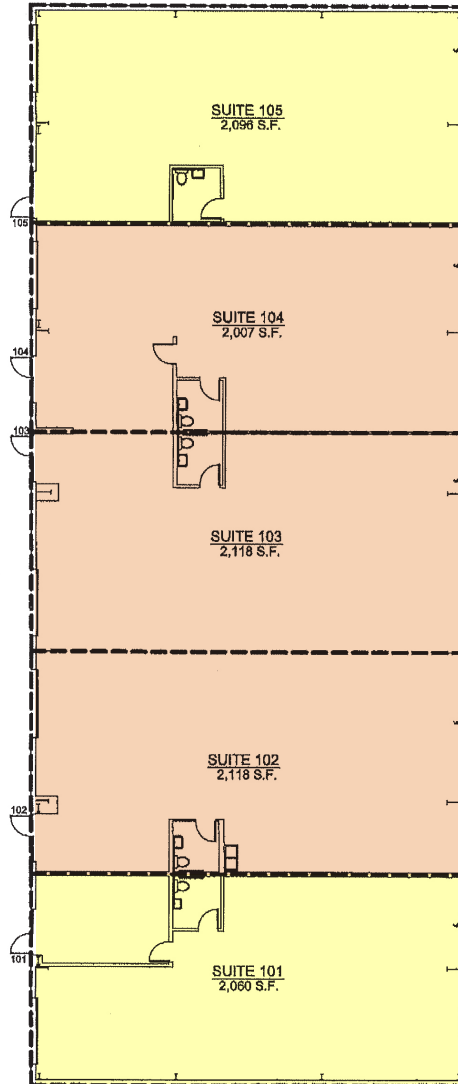

For More Information or a Property Tour, Please Contact:

NICK CHESSAR
503.225.8469
NickC@norris-stevens.com

SCOTT FINNEY, SIOR
503.225.8431
ScottF@norris-stevens.com

Norris & Stevens

INVESTMENT REAL ESTATE SERVICES



Information contained herein has been obtained from others and considered to be reliable; however, a prospective purchaser or lessee is expected to verify all information to his/her own satisfaction.

900 SW 5th Avenue • 17th Floor • Portland, OR 97204
503.223.3171 • norris-stevens.com