

FOR LEASE | RETAIL

# THE SHOPPES AT THE ARCADE

658 Cookman | Asbury Park, NJ 07712



## PROPERTY SUMMARY

**Building Size:** ± 20,000 SF  
**Cross Streets:** Cookman Ave & Bond St

## AVAILABLE SPACES

**Suite** **Lease Rate**  
Unit 7 \$1,300 per month, plus electric

## PROPERTY OVERVIEW

The Shoppes at the Arcade

## LOCATION OVERVIEW

Located in the heart of downtown Asbury Park. Easy access to Routes 71, 33, 36, 18 and the Garden State Parkway.

## PROPERTY HIGHLIGHTS

- Unique retail/office building on Cookman Avenue
- Join 20 stores with many vibrant uses
- Reasonable pricing
- Possible uses include retail, office, restaurants
- Tenant pays electric
- Owner is a licensed NJ Real Estate Broker

FOR MORE INFORMATION, PLEASE CONTACT:

Douglas Sitar | P: 732.623.2135 | C: 732.859.2144 | dsitar@sitarcompany.com

1481 Oak Tree Road  
Iselin, NJ 08830  
T: 732.283.9000 | F: 732.283.3103  
www.sitarcompany.com



FOR LEASE | RETAIL

# THE SHOPPES AT THE ARCADE

658 Cookman | Asbury Park, NJ 07712



Imagery ©2021 , Maxar Technologies, USDA Farm Service Agency

FOR MORE INFORMATION, PLEASE CONTACT:

Douglas Sitar | P: 732.623.2135 | C: 732.859.2144 | dsitar@sitarcompany.com

1481 Oak Tree Road  
Iselin, NJ 08830  
T: 732.283.9000 | F: 732.283.3103  
www.sitarcompany.com



Disclaimer: ALL INFORMATION FURNISHED REGARDING PROPERTY FOR SALE, RENTAL OR FINANCING IS FROM SOURCES DEEMED RELIABLE, BUT NO WARRANTY OR REPRESENTATION IS MADE AS TO THE ACCURACY THEREOF AND SAME IS SUBMITTED SUBJECT TO ERRORS, OMISSIONS, CHANGES OF PRICE, RENTAL OR OTHER CONDITIONS, PRIOR SALE, LEASE OR FINANCING OR WITHDRAWAL WITHOUT NOTICE.

FOR LEASE | RETAIL

# THE SHOPPES AT THE ARCADE

658 Cookman | Asbury Park, NJ 07712

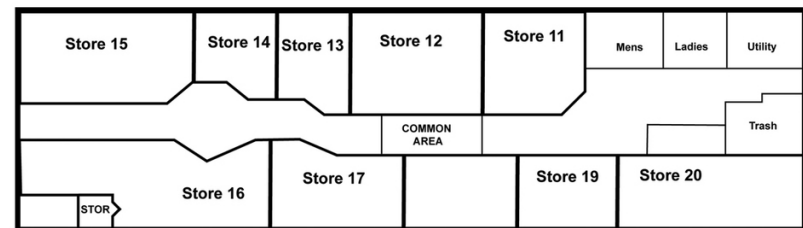

FOR MORE INFORMATION, PLEASE CONTACT:

Douglas Sitar | P: 732.623.2135 | C: 732.859.2144 | dsitar@sitarcompany.com

1481 Oak Tree Road  
Iselin, NJ 08830  
T: 732.283.9000 | F: 732.283.3103  
www.sitarcompany.com



Disclaimer: ALL INFORMATION FURNISHED REGARDING PROPERTY FOR SALE, RENTAL OR FINANCING IS FROM SOURCES DEEMED RELIABLE, BUT NO WARRANTY OR REPRESENTATION IS MADE AS TO THE ACCURACY THEREOF AND SAME IS SUBMITTED SUBJECT TO ERRORS, OMISSIONS, CHANGES OF PRICE, RENTAL OR OTHER CONDITIONS, PRIOR SALE, LEASE OR FINANCING OR WITHDRAWAL WITHOUT NOTICE.

FOR LEASE | RETAIL

# THE SHOPPES AT THE ARCADE

658 Cookman | Asbury Park, NJ 07712

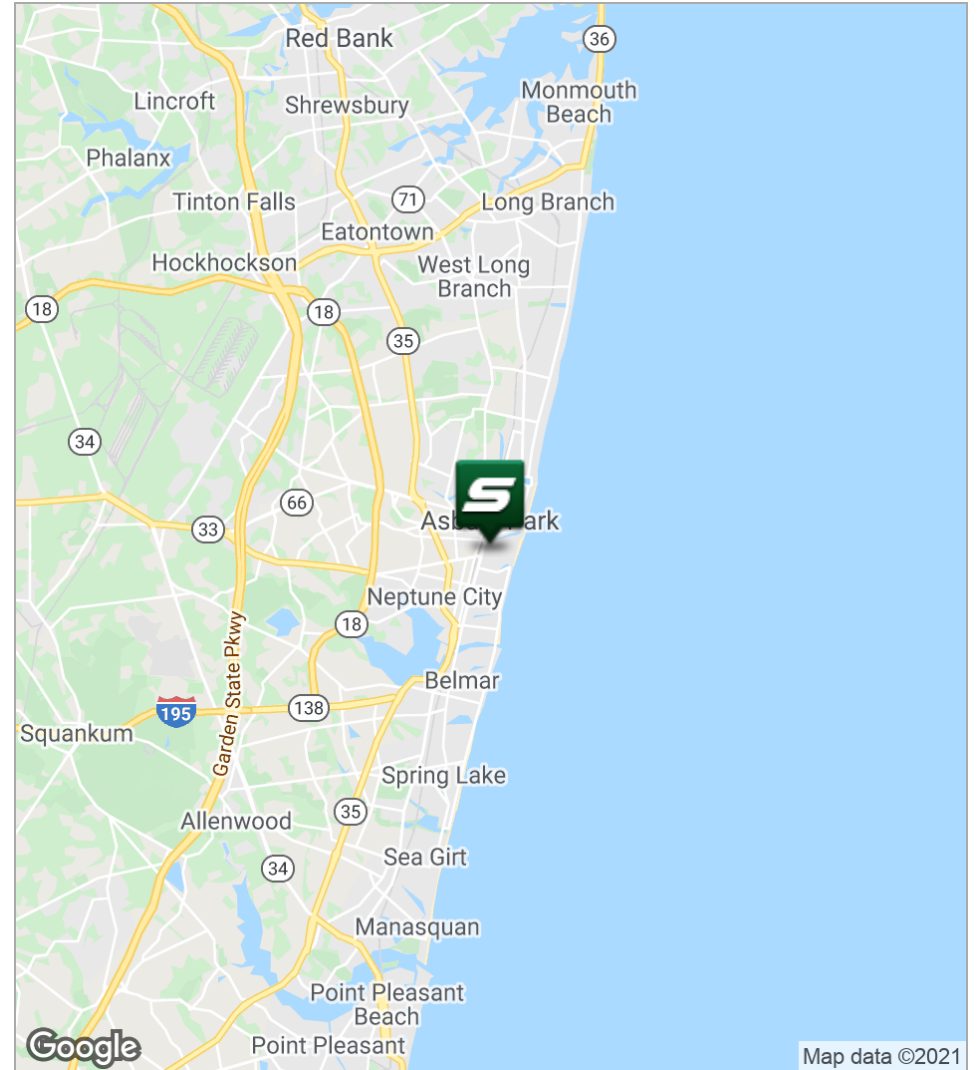
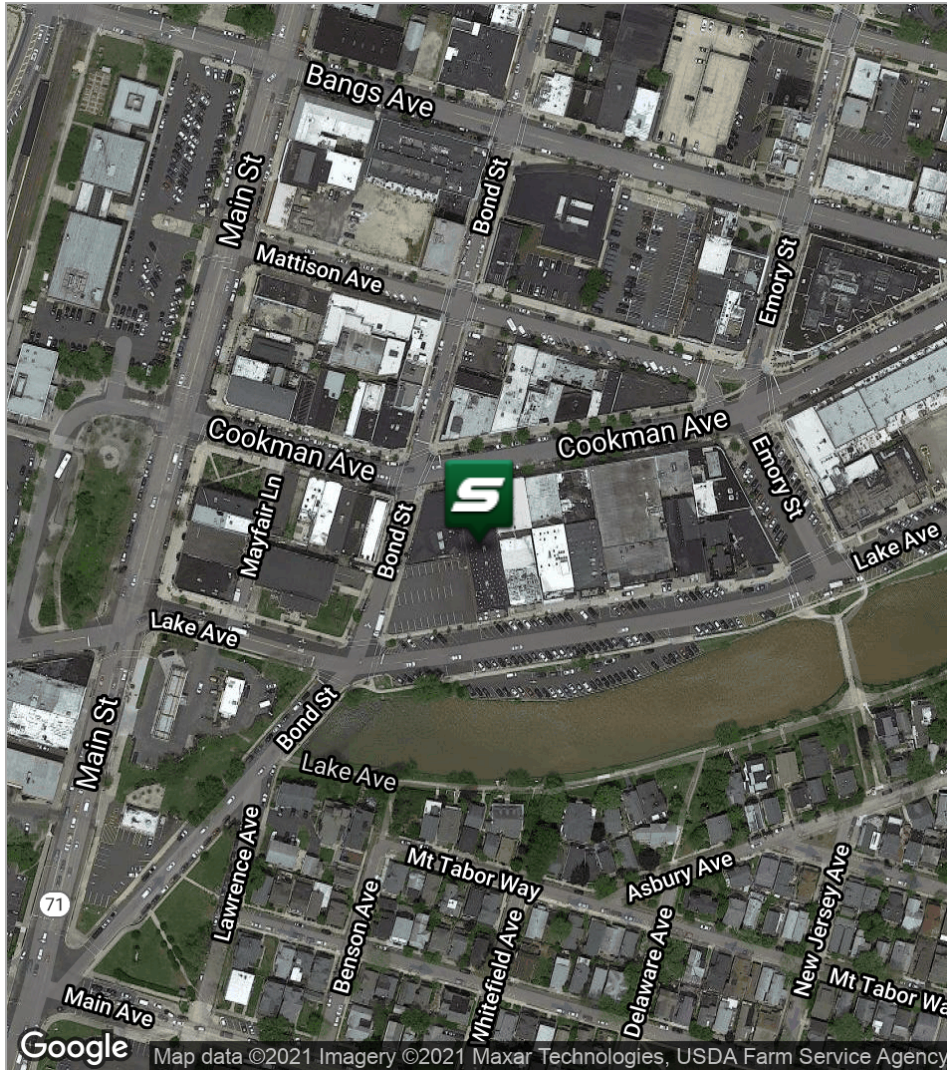

FOR MORE INFORMATION, PLEASE CONTACT:

Douglas Sitar | P: 732.623.2135 | C: 732.859.2144 | dsitar@sitarcompany.com

1481 Oak Tree Road  
Iselin, NJ 08830  
T: 732.283.9000 | F: 732.283.3103  
www.sitarcompany.com



Disclaimer: ALL INFORMATION FURNISHED REGARDING PROPERTY FOR SALE, RENTAL OR FINANCING IS FROM SOURCES DEEMED RELIABLE, BUT NO WARRANTY OR REPRESENTATION IS MADE AS TO THE ACCURACY THEREOF AND SAME IS SUBMITTED SUBJECT TO ERRORS, OMISSIONS, CHANGES OF PRICE, RENTAL OR OTHER CONDITIONS, PRIOR SALE, LEASE OR FINANCING OR WITHDRAWAL WITHOUT NOTICE.

FOR LEASE | RETAIL

# THE SHOPPES AT THE ARCADE



658 Cookman | Asbury Park, NJ 07712

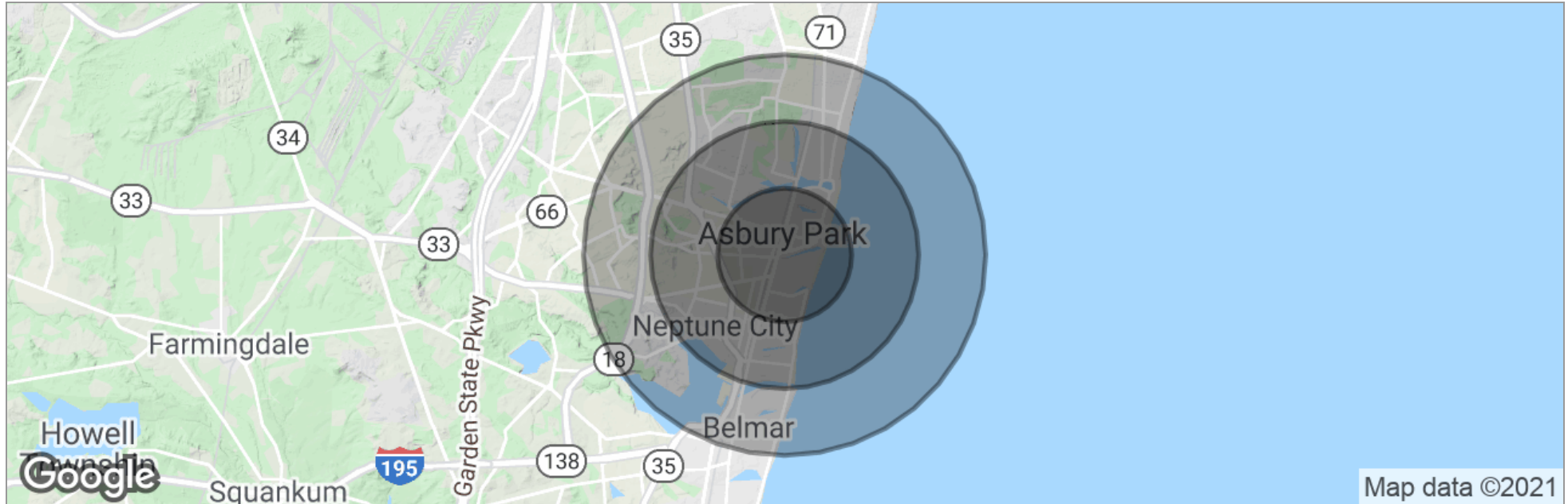

	1 Mile	2 Miles	3 Miles
Total Population	26,186	51,200	76,639
Population Density	8,335	4,074	2,711
Median Age	35.7	38.2	39.6
Median Age (Male)	32.8	34.8	36.6
Median Age (Female)	37.5	40.0	41.4
Total Households	11,401	22,281	32,839
# of Persons Per HH	2.3	2.3	2.3
Average HH Income	\$53,593	\$62,976	\$70,753
Average House Value	\$280,402	\$375,697	\$408,948

\* Demographic data derived from 2010 US Census

FOR MORE INFORMATION, PLEASE CONTACT:

Douglas Sitar | P: 732.623.2135 | C: 732.859.2144 | dsitar@sitarcompany.com

1481 Oak Tree Road  
Iselin, NJ 08830  
T: 732.283.9000 | F: 732.283.3103  
www.sitarcompany.com



Disclaimer: ALL INFORMATION FURNISHED REGARDING PROPERTY FOR SALE, RENTAL OR FINANCING IS FROM SOURCES DEEMED RELIABLE, BUT NO WARRANTY OR REPRESENTATION IS MADE AS TO THE ACCURACY THEREOF AND SAME IS SUBMITTED SUBJECT TO ERRORS, OMISSIONS, CHANGES OF PRICE, RENTAL OR OTHER CONDITIONS, PRIOR SALE, LEASE OR FINANCING OR WITHDRAWAL WITHOUT NOTICE.