

LAWRENCE BUSINESS CENTER
2624 Lavery Court, Suites 205-206
Newbury Park, CA 91320

*Industrial Suite
For Lease*



Westcord COMMERCIAL
REAL ESTATE
SERVICES

951 S. Westlake Blvd., Ste. 101, Westlake Village, CA 91361 www.westcord.com

JIM HENNESSY

DRE# 01893383

Office: (805) 497-4557 X243

JIMH@WESTCORD.COM

LAWRENCE BUSINESS CENTER

2624 Lavery Court, Suites 205-206
Newbury Park, CA 91320

FOR LEASE

- **Suite #205-206**
+/- 2,508 SF
- **Available- NOW**
- **Modified Gross Lease- NO CAM**
- **Rent: \$3,762.00/month**
(\$1.50 sf/month)
- **(2) 10X10 roll-up doors, 15FT WH ceilings**
- **(3) Offices +/- 150-340 SF each and (2) private restrooms**
- **Tenant responsible for metered utilities- water and trash included in rent.**
- **Parking: 6 in common areas**

Please call broker to show



**Ideal Location in Conejo Valley-
Newbury Park.**

**Near: Amgen, banks and
restaurants, Target, Home Depot,
Lowe's, and many other convenient
businesses.**

Westcord COMMERCIAL
REAL ESTATE
SERVICES

951 S. Westlake Blvd., Ste. 101, Westlake Village, CA 91361 www.westcord.com

JIM HENNESSY

DRE# 01893383

Office: (805) 497-4557 X243

JIMH@WESTCORD.COM

2624 Lavery Court, Suites 205-206
Newbury Park, CA 91320

FLOORPLAN

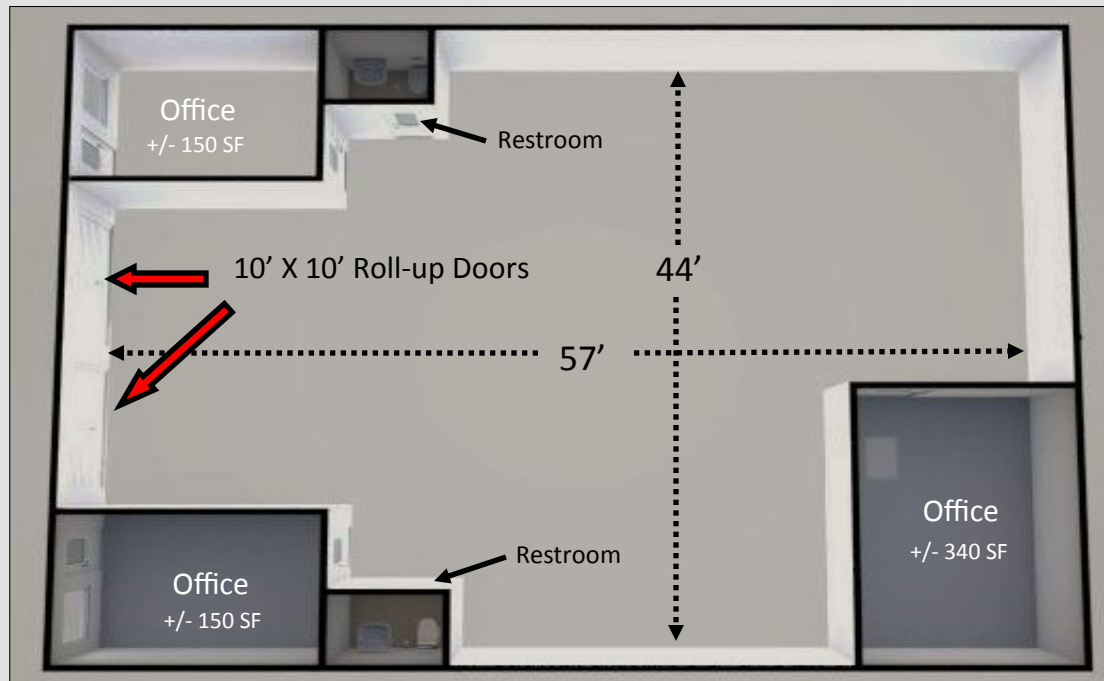

Westcord COMMERCIAL
REAL ESTATE
SERVICES

951 S. Westlake Blvd., Ste. 101, Westlake Village, CA 91361 www.westcord.com

JIM HENNESSY

DRE# 01893383

Office: (805) 497-4557 X243

JIMH@WESTCORD.COM

2624 Lavery Ct.
Suites 205- 206
Newbury Park, CA 91320

LAWRENCE BUSINESS CENTER
SITEPLAN

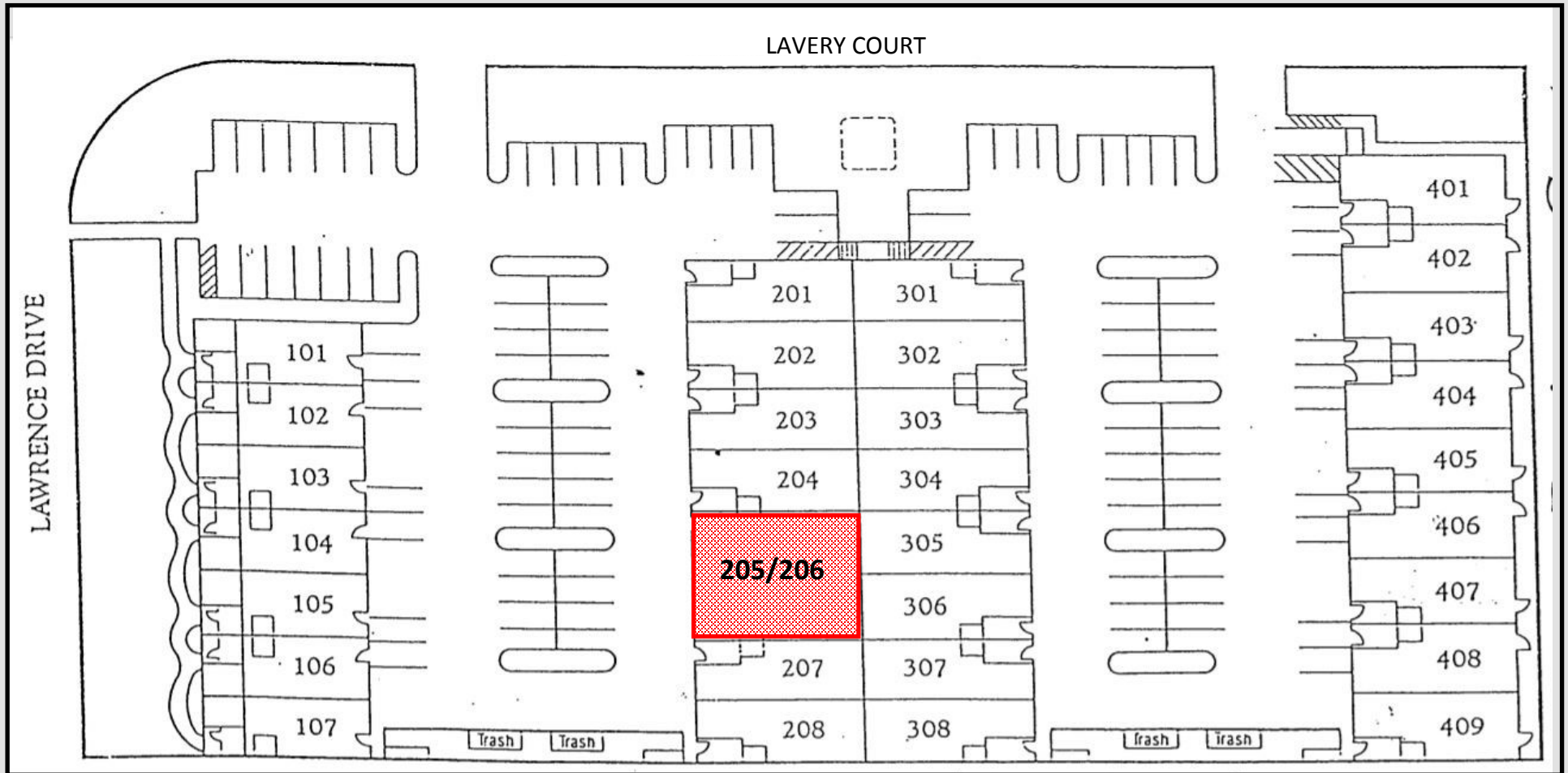

951 S. Westlake Blvd., Ste. 101, Westlake Village, CA 91361 www.westcord.com

JIM HENNESSY

DRE# 01893383

Office: (805) 497-4557 X243

JIMH@WESTCORD.COM