



2400
COLUMBIA PIKE

Property Details

New mixed-use building featuring 110 residential units and approximately 16,000 SF of street level retail space with projected delivery in Q3 2023. This location is highly visible with significant frontage on Columbia Pike with onsite dedicated retail parking. The building will be located less than two miles from future Amazon HQ2 and one mile to the Pentagon.

Highlights:

Address: 2400 Columbia Pike Arlington, VA 22204

Size: 16,000 SF (Divisible)

Lease Rate: \$45 PSF NNN (est. \$12.00 PSF)

Parking: 43 Parking Spaces (3.07/1,000)

Ceiling Height: 18' (Estimated)

Zoning: C-2

Delivery: Q3 2023 (Estimated)

Walk Score: 94 (Walker's Paradise)



COLUMBIA PIKE (24,000 VPD)

S BARTON STREET

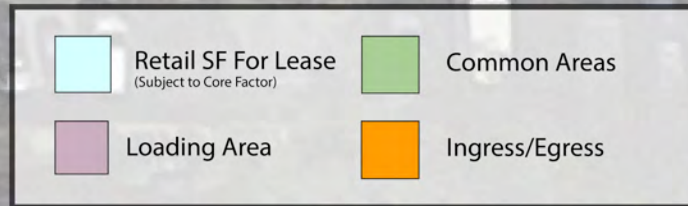
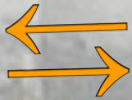
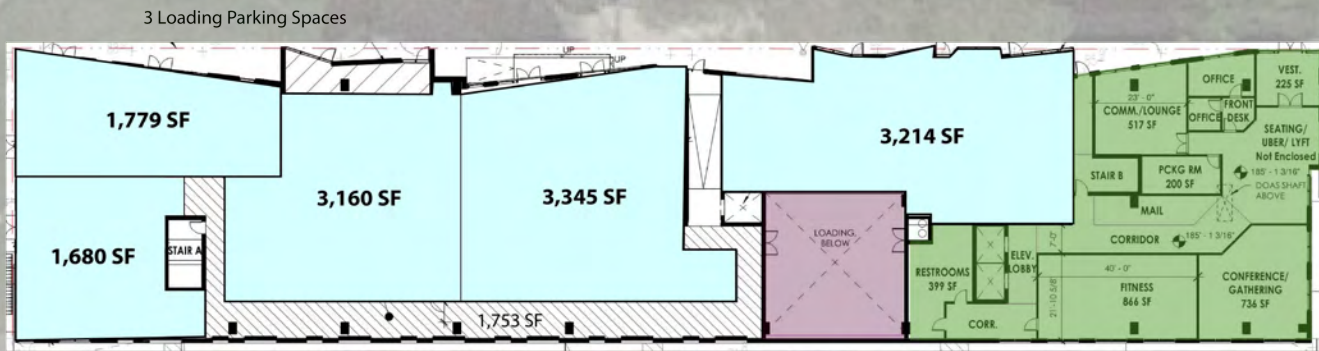

**33 Surface Spaces +
10 Dedicated Retail
Spaces in Garage**

2400
COLUMBIA PIKE



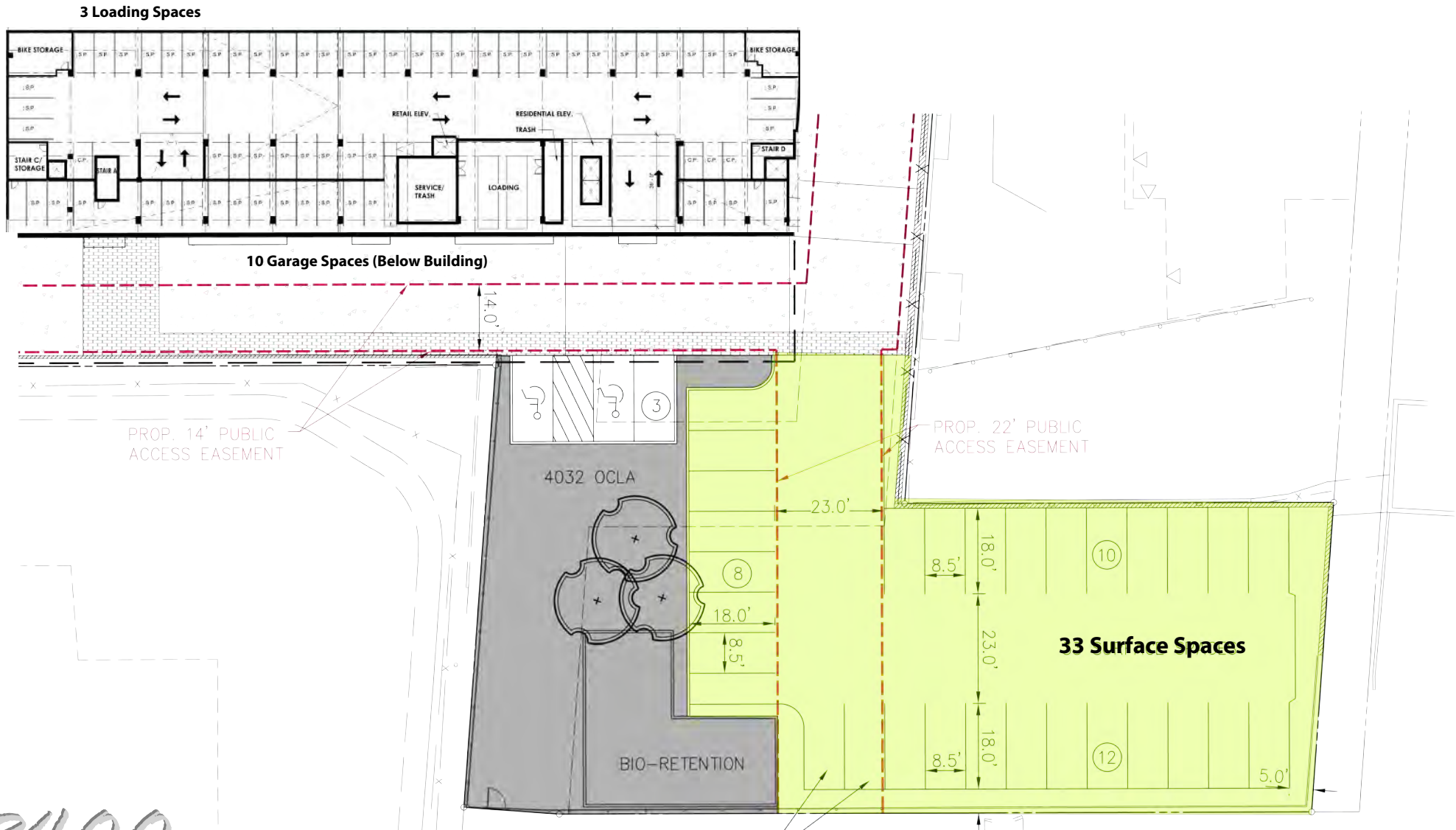

2400
COLUMBIA PIKE

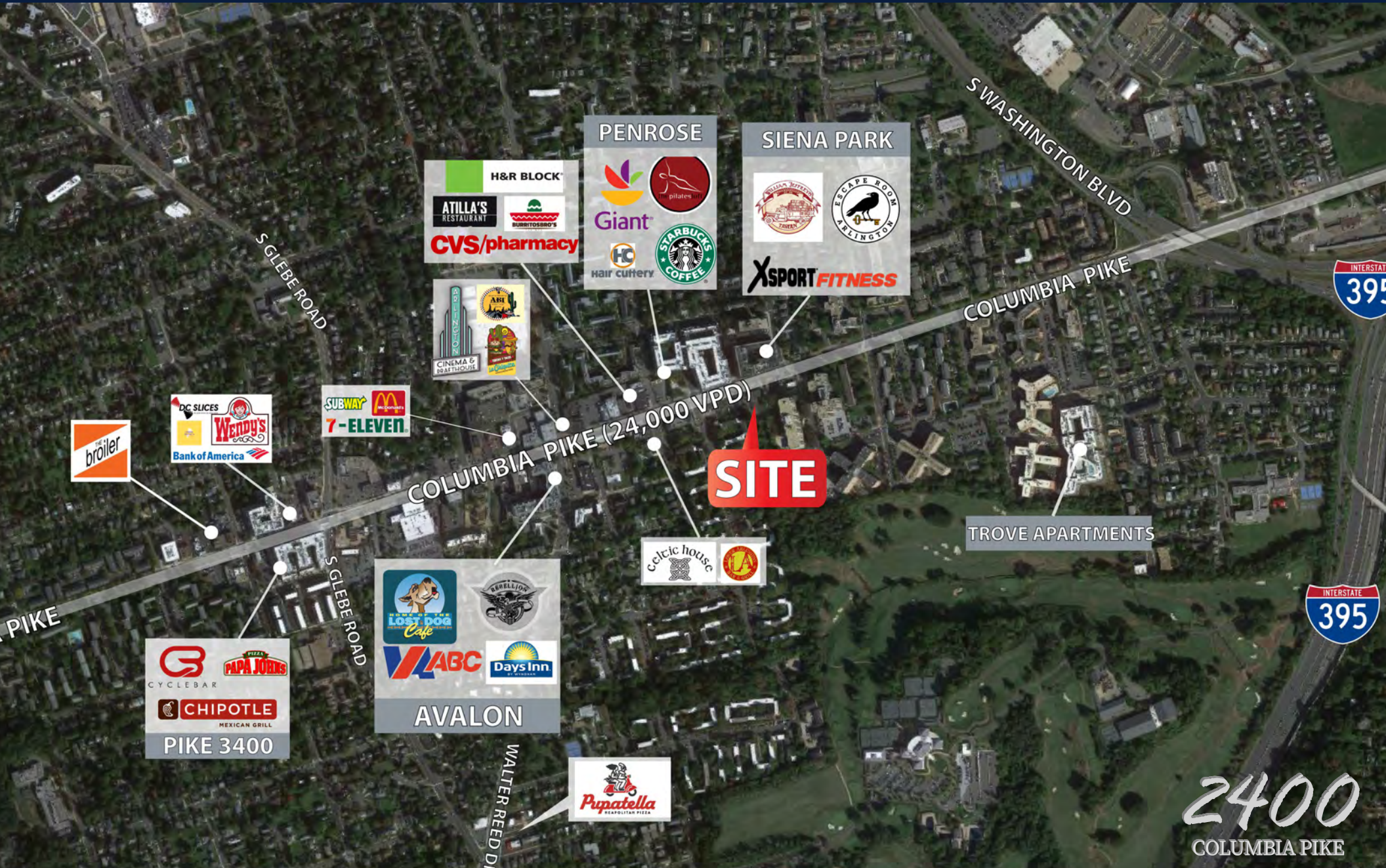

SITE

COLUMBIA PIKE (24,000 VPD)







TROVE APARTMENTS

AVALON

PIKE 3400

2400
COLUMBIA PIKE

DEMOGRAPHICS

	<u>0.5 MILES</u>	<u>1 MILE</u>	<u>2 MILES</u>
 POPULATION	12,242	29,294	150,250
 MEDIAN HOUSEHOLD INCOME	\$101,325	\$106,552	\$109,838
 TOTAL BUSINESSES	344	678	4,842
 MEDIAN AGE	35.6	36.6	35.1
 DAYTIME POPULATION	3,414	8,567	67,717
 HOUSING UNITS	6,881	13,942	78,120

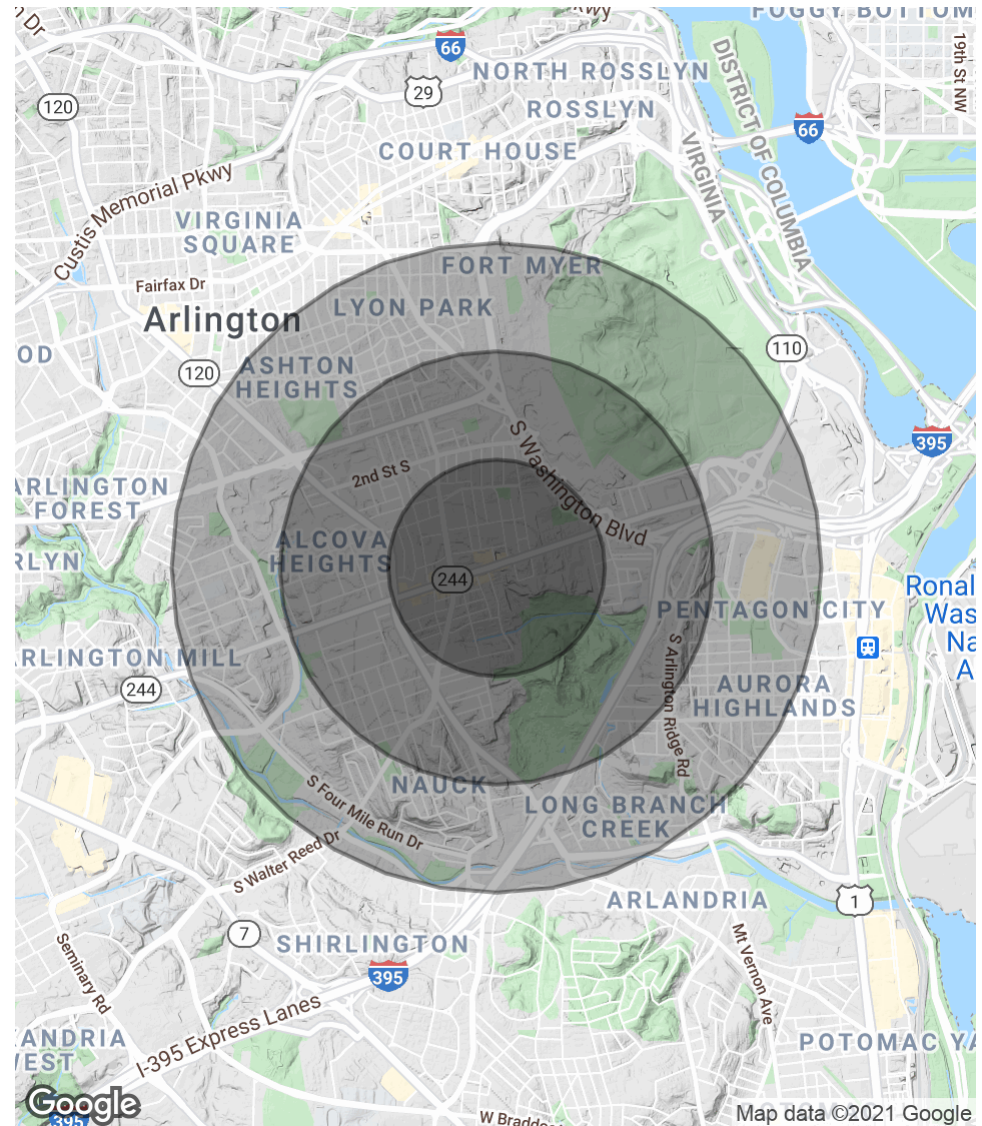

ulsakergroup.com



Connect With Us

Erik Ulsaker
Director
703.861.0373
eu@lnf.com

Matthew Garcia
Director
703.873.5760
mgarcia@lnf.com

Jaclyn Purzycki
Marketing Analyst
703.873.5706
jaclyn@lnf.com

Shadi Ayyoubi
Associate
703.946.6003
shadi@lnf.com