

GOLDTEX BUILDING
315 NORTH 12TH STREET
PHILADELPHIA, PA

±2,145 SF AVAILABLE FOR LEASE



 **property highlights.**

- ±2,145 available for lease on the ground floor of a brand new luxury apartment building of 300+ residents in Philadelphia's Loft District
- Exposed walls and high ceilings
- Neighboring PA Convention Center & Reading Terminal Market
- Ideal for convenient store and cafe users

 **stats.**

2018 DEMOGRAPHICS*	.5 MILES	1 MILE	1.5 MILES
EST. POPULATION	12,049	73,793	150,063
EST. HOUSEHOLDS	4,867	40,964	78,794
EST. AVG. HH INCOME	\$83,594	\$95,289	\$101,274

*ESRI 2018



METRO[®]
COMMERCIAL
REAL ESTATE, INC.

MetroCommercial.com | PHILADELPHIA, PA | PLYMOUTH MEETING, PA | MOUNT LAUREL, NJ | NAPLES, FL

get in touch.

SCOTT BENSON

office 215.893.0300

direct 215.282.0158

sbenson@metrocommercial.com

WOOD STREET

12TH STREET

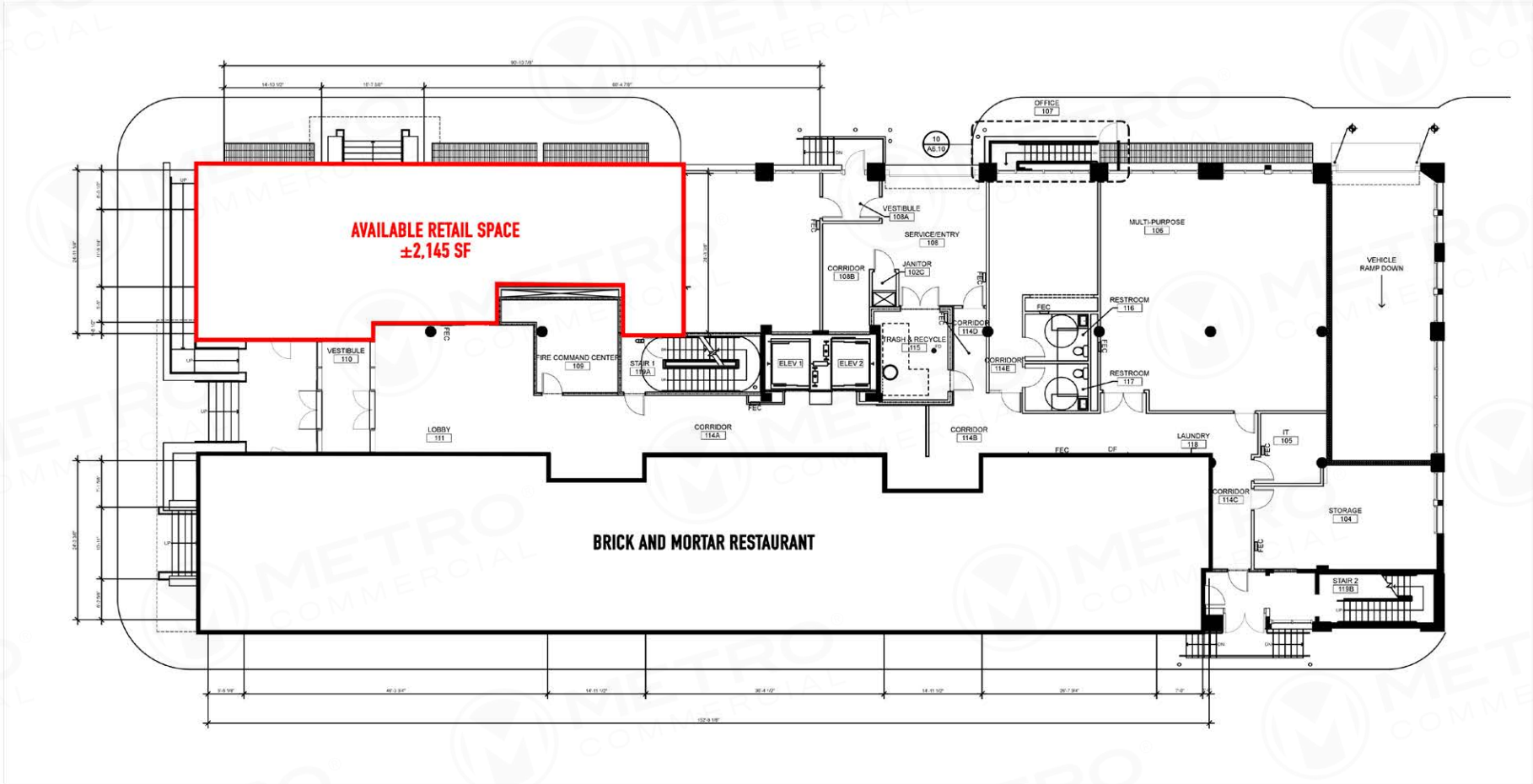

PEARL STREET

The information and images contained herein are from sources deemed reliable. However, Metro Commercial Real Estate, Inc. makes no representation whatsoever as to their accuracy or authenticity. Images shown may be modified for illustrative purposes. Images may be out-of-date and not current. 3.19.19

315 NORTH 12TH STREET
PHILADELPHIA, PA



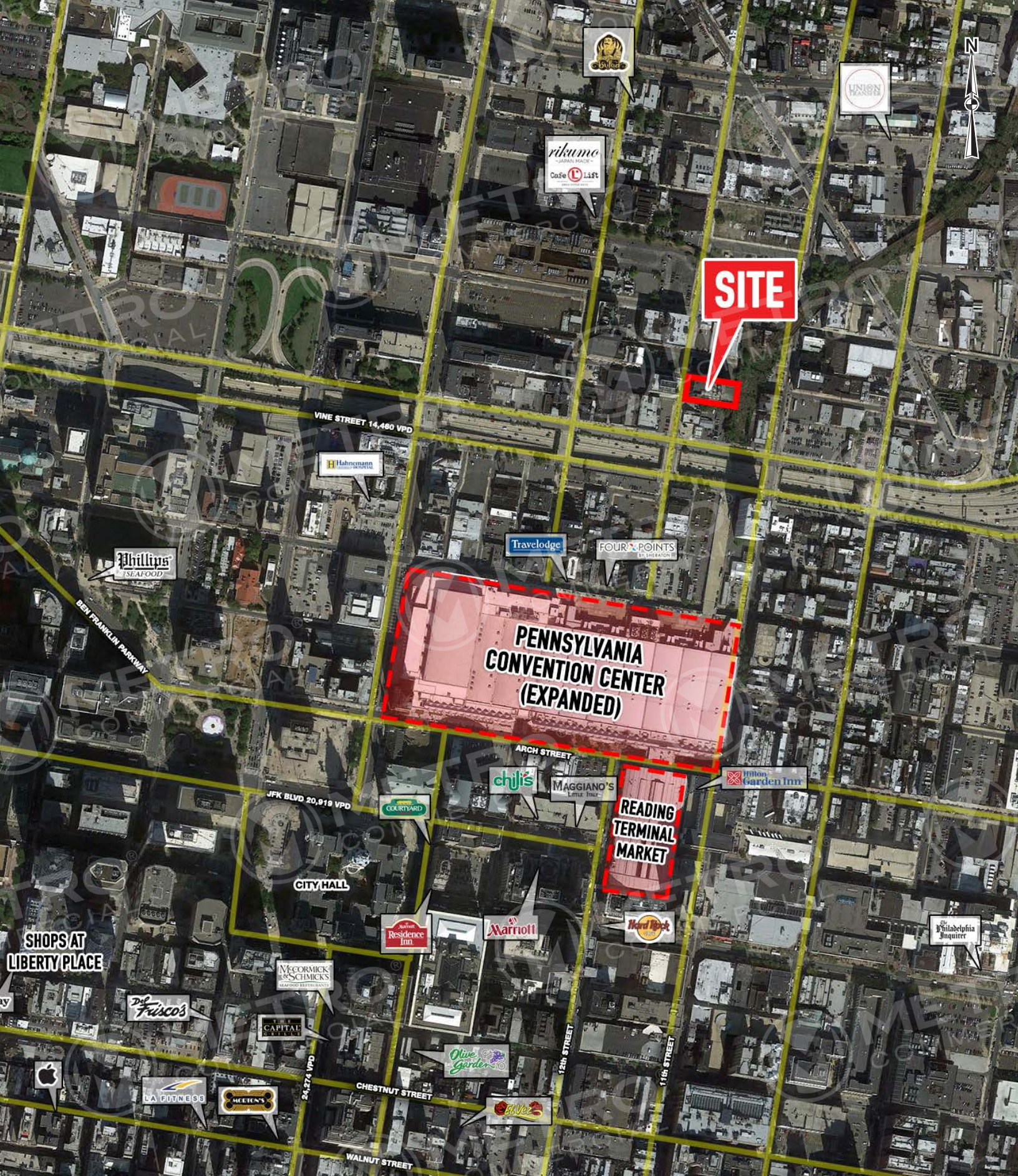

The information and images contained herein are from sources deemed reliable. However, Metro Commercial Real Estate, Inc. makes no representation whatsoever as to their accuracy or authenticity. Images shown may be modified for illustrative purposes. Images may be out-of-date and not current. 3.19.19

**315 NORTH 12TH STREET
PHILADELPHIA, PA**

