

THE MURANO 21ST & MARKET PHILADELPHIA, PA

± 2,366 SF PROMINENT CORNER LOCATION AVAILABLE FOR LEASE

JOIN



TRADER JOE'S



property highlights.

- Prime corner on active West Market Street corridor
- 25 million SF of office space within close walking distance
- Extremely visible with dramatic, high ceilings
- Ground floor retail space in 42-story, 302-unit condominium building
- Can be vented
- Ideal for financial, fitness, restaurant or convenience

stats.

2020 DEMOGRAPHICS*	1 MILE	2 MILES	3 MILES
EST. POPULATION	86,744	291,275	510,185
EST. HOUSEHOLDS	49,553	134,376	219,275
EST. AVG. HH INCOME	\$127,201	\$100,844	\$84,658

*ESRI 2020



METRO[®]
COMMERCIAL
REAL ESTATE, INC.

MetroCommercial.com | PLYMOUTH MEETING, PA | MOUNT LAUREL, NJ

get in touch.

SCOTT BENSON

office 215.893.0300
direct 215.282.0158
sbenson@metrocommercial.com

MICHAEL GORMAN

office 215.893.0300
direct 215.282.0152
mgorman@metrocommercial.com

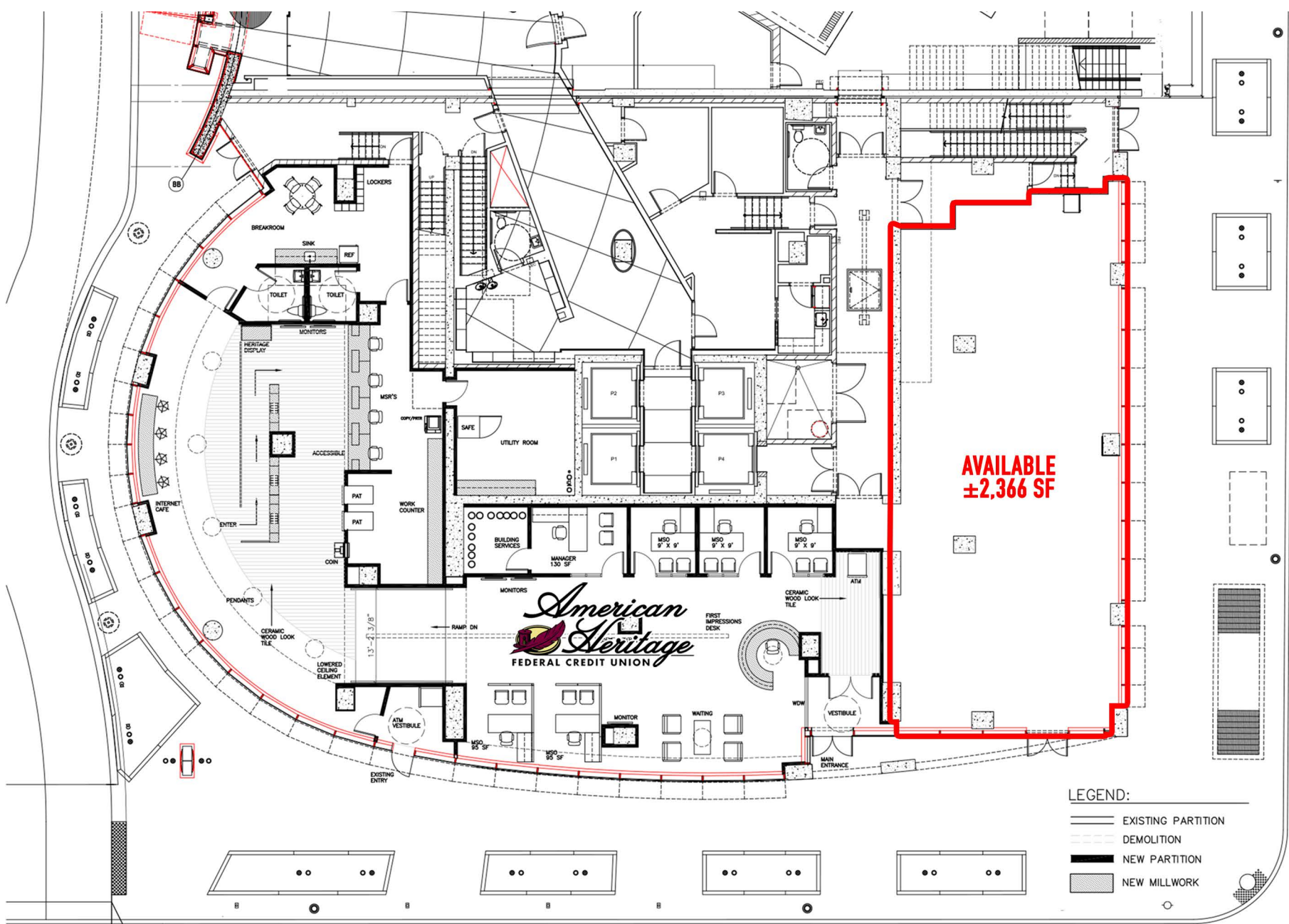

21ST STREET

AVAILABLE
±2,366 SF

LEGEND:

- EXISTING PARTITION
- - - DEMOLITION
- ▬ NEW PARTITION
- ▨ NEW MILLWORK

MARKET STREET



The information and images contained herein are from sources deemed reliable. However, Metro Commercial Real Estate, Inc. makes no representation whatsoever as to their accuracy or authenticity. Images shown may be modified for illustrative purposes. Images may be out-of-date and not current. 12.14.20

21ST & MARKET
PHILADELPHIA, PA



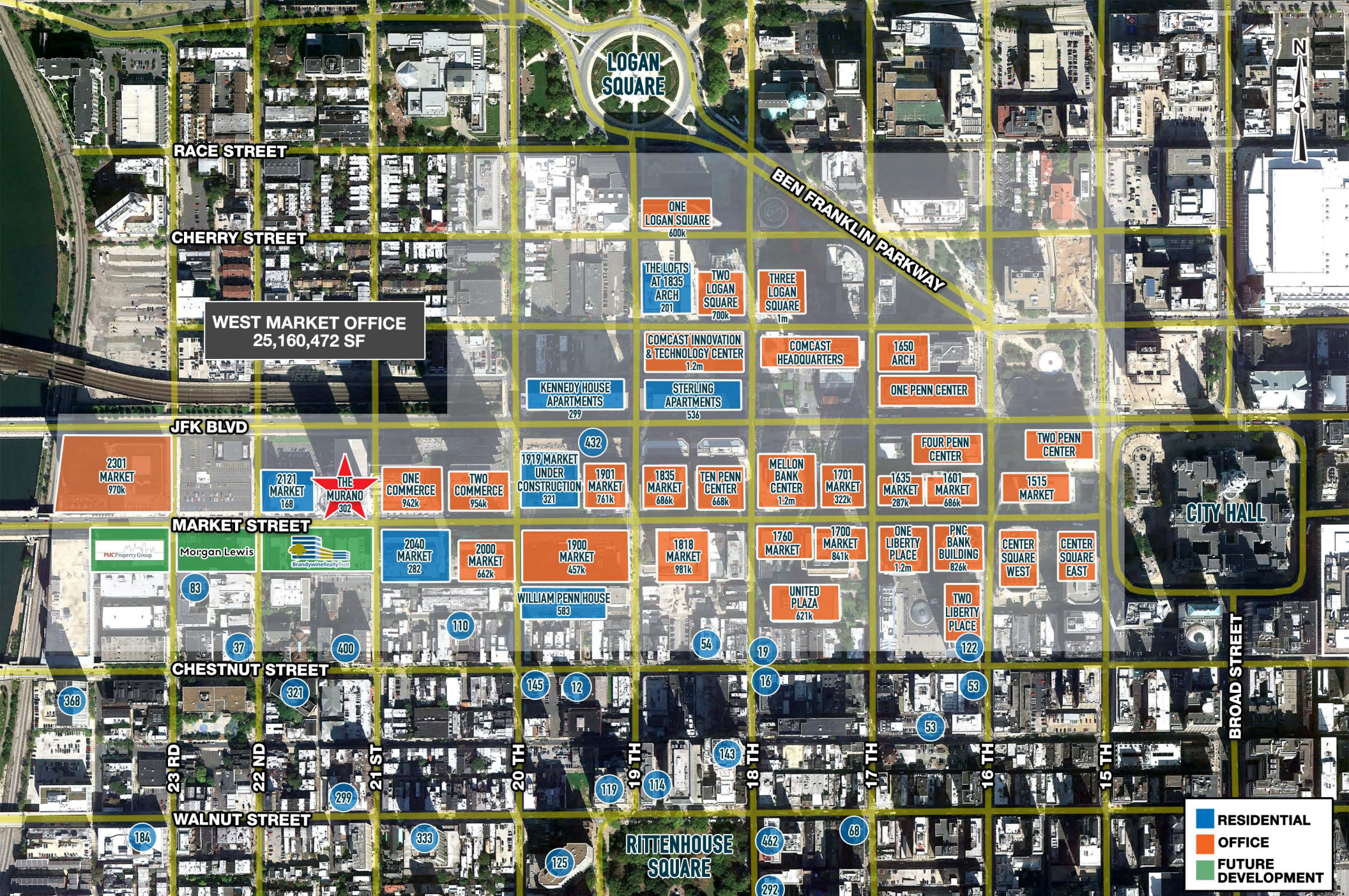

The information and images contained herein are from sources deemed reliable. However, Metro Commercial Real Estate, Inc. makes no representation whatsoever as to their accuracy or authenticity. Images shown may be modified for illustrative purposes. Images may be out-of-date and not current. 12.14.20

21ST & MARKET PHILADELPHIA, PA

