

EXECUTIVE SUMMARY



OFFERING SUMMARY

Lease Rate:	N/A
Building Size:	9,656 SF
Available SF:	
Lot Size:	0.56 Acres
Zoning:	River Front

PROPERTY OVERVIEW

Well-located Class B office property located outside of the Harrisburg Central Business District (CBD). This property has open floor plates and great views of the Susquehanna River and Riverfront Park.

PROPERTY HIGHLIGHTS



Drew Bobincheck, CCIM
Senior Vice President
717.731.1990 x3006
dbobincheck@landmarkcr.com

Sean Fitzsimmons
Director - Sales & Leasing
717.731.1990 x3013
sfitzsimmons@landmarkcr.com

FLOOR PLAN

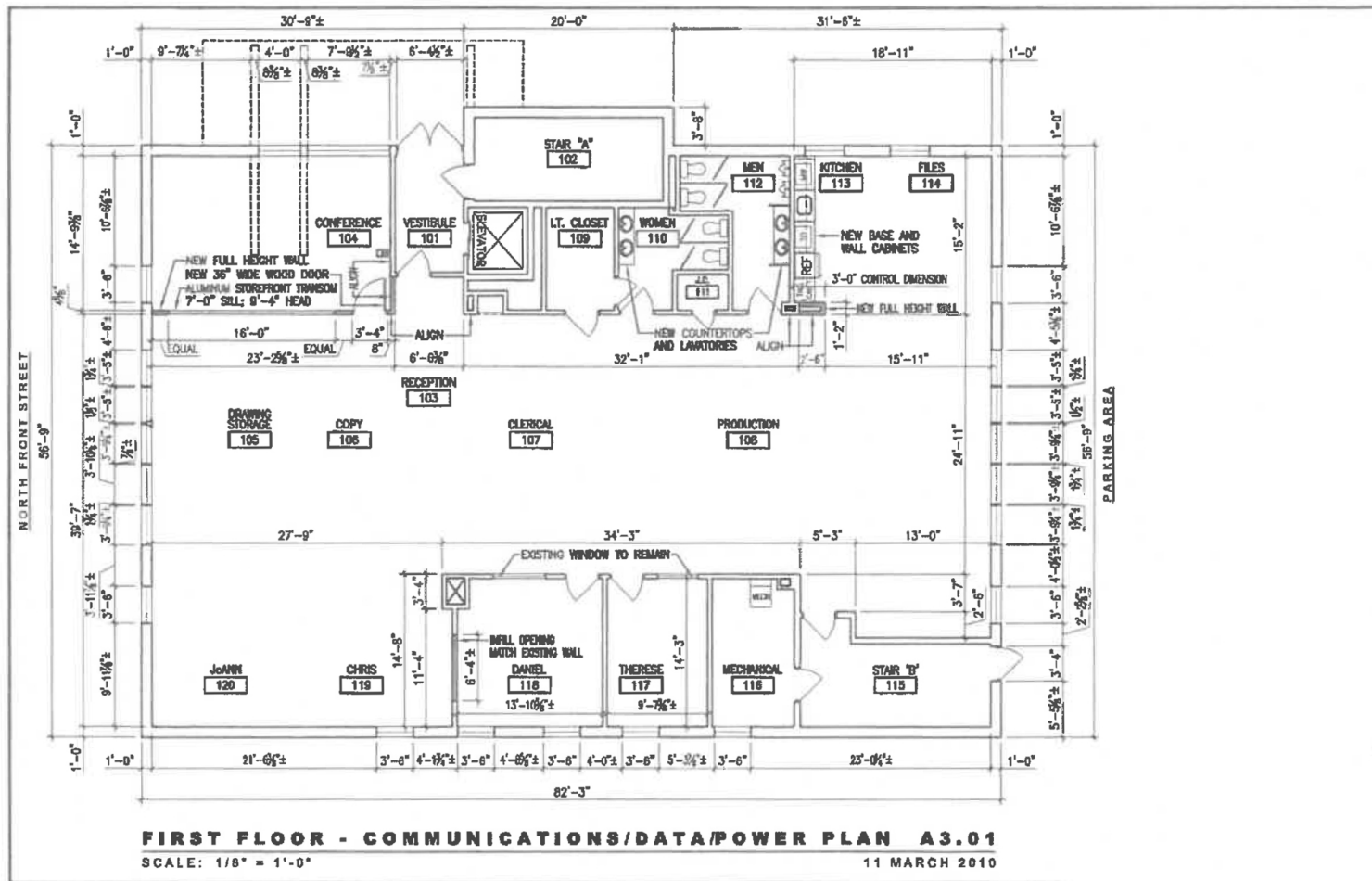

Drew Bobincheck, CCIM
Senior Vice President
717.731.1990 x3006
dbobincheck@landmarkcr.com

Sean Fitzsimmons
Director - Sales & Leasing
717.731.1990 x3013
sfitzsimmons@landmarkcr.com



Italian Park



Harrisburg Area Community College



Camp Curtin Middle School



Elmerton Avenue

Division Street

Geisinger



Uptown Plaza Mall



22



Radnor Street

N 7th Street



UPMC Pinnacle



Schuylkill Street

Harrisburg School District/Annex



SITE



Emerald Street



Arsenal Boulevard

N Front Street

N 2nd Street

N 3rd Street



Tri County OIC



Delaware and Wallace Park



Maclay Street

N 6th Street



N Cameron Street

S Enola Road

15

West Fairview Park



LITTLE AMPS COFFEE ROASTERS

Downey School



230



2505 N. FRONT STREET

OFFICE PROPERTY FOR LEASE

2505 N. Front Street Harrisburg, PA 17110

LOCATION MAP



Drew Bobincheck, CCIM
Senior Vice President
717.731.1990 x3006
dbobincheck@landmarkcr.com

Sean Fitzsimmons
Director - Sales & Leasing
717.731.1990 x3013
sfitzsimmons@landmarkcr.com

LANDMARKCR.com

REGIONAL MAP

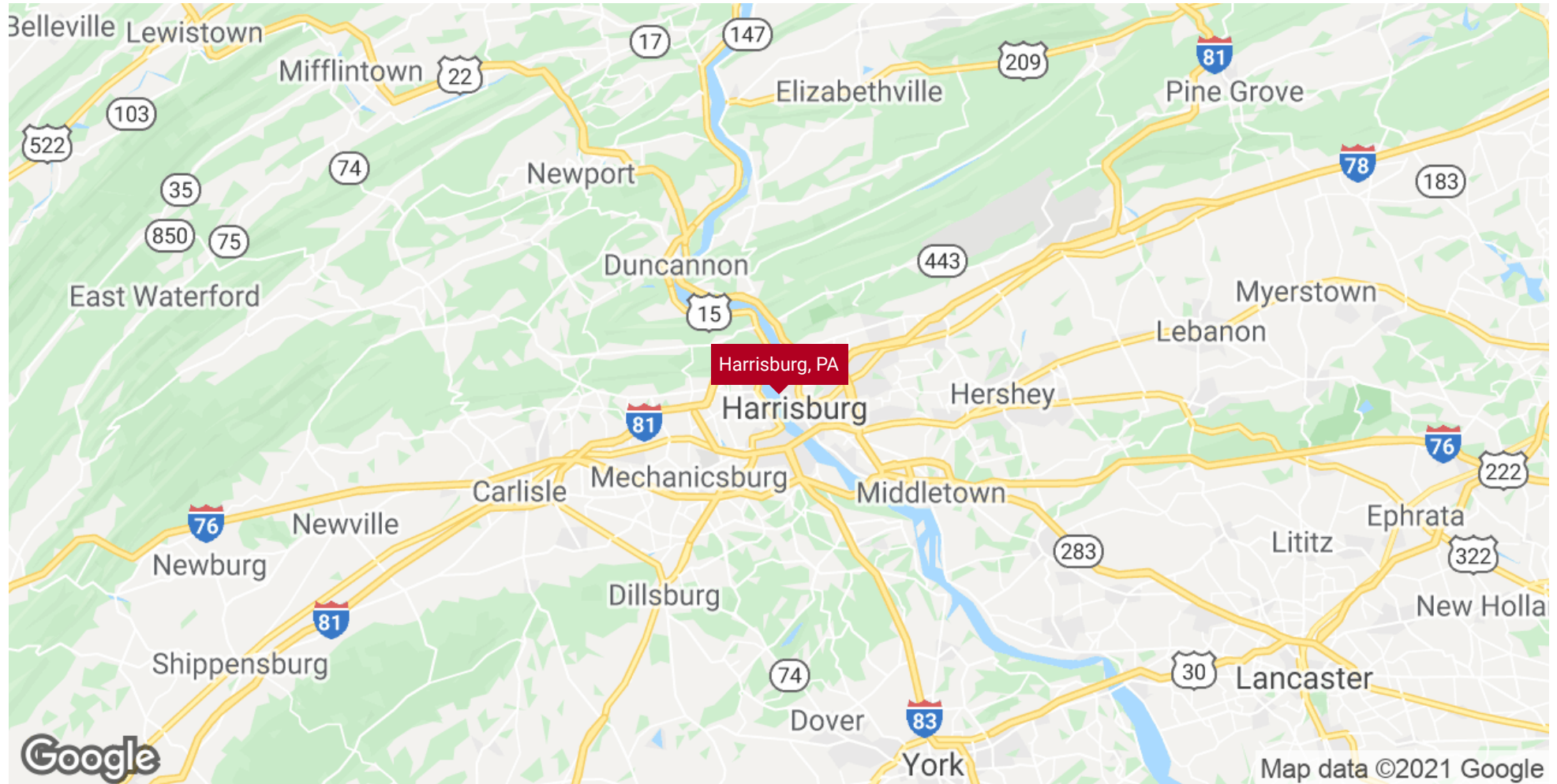

Drew Bobincheck, CCIM
Senior Vice President
717.731.1990 x3006
dbobincheck@landmarkcr.com

Sean Fitzsimmons
Director - Sales & Leasing
717.731.1990 x3013
sfitzsimmons@landmarkcr.com

DEMOGRAPHICS MAP & REPORT

POPULATION	1 MILE	3 MILES	5 MILES
Total Population	12,080	72,351	179,481
Average age	32.7	35.7	37.8
Average age (Male)	29.9	34.2	35.7
Average age (Female)	35.0	36.8	39.0

HOUSEHOLDS & INCOME	1 MILE	3 MILES	5 MILES
Total households	4,738	31,523	76,253
# of persons per HH	2.5	2.3	2.4
Average HH income	\$45,838	\$53,403	\$61,529
Average house value	\$106,848	\$150,460	\$160,252

* Demographic data derived from 2010 US Census

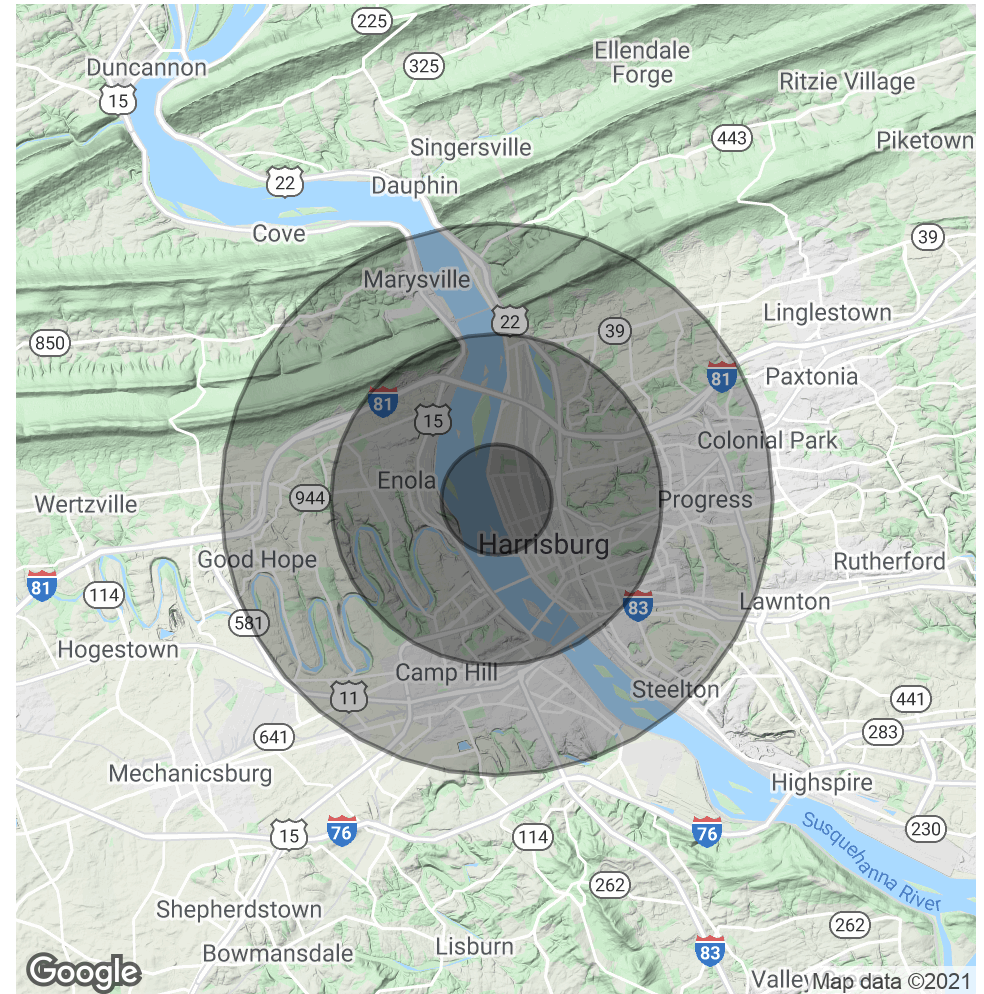

Drew Bobincheck, CCIM
 Senior Vice President
 717.731.1990 x3006
 dbobincheck@landmarkcr.com

Sean Fitzsimmons
 Director - Sales & Leasing
 717.731.1990 x3013
 sfitzsimmons@landmarkcr.com