

ROUTE 61 & CHERRY STREET

LEESPORT, PA

±8.5 ACRES AVAILABLE FOR LEASE



property highlights.

- Located at a signalized hard corner
- Existing underground sewer improvements
- Zoned Commercial - Great development opportunity
- Owned & Managed by: **weis**



stats.

2018 DEMOGRAPHICS*	1 MILE	3 MILES	5 MILES
EST. POPULATION	2,185	10,865	43,636
EST. HOUSEHOLDS	863	4,186	16,756
EST. AVG. HH INCOME	\$78,077	\$81,928	\$82,804

POTTSVILLE PIKE TRAFFIC COUNT: 32,000 VPD *ESRI 2018



METRO[®]
COMMERCIAL
REAL ESTATE, INC.

MetroCommercial.com | PHILADELPHIA, PA | PLYMOUTH MEETING, PA | MOUNT LAUREL, NJ | NAPLES, FL

get in touch.

PAT GALLAGHER

office 610.825.5222

direct 610.260.2676

pgallagher@metrocommercial.com



The information and images contained herein are from sources deemed reliable. However, Metro Commercial Real Estate, Inc. makes no representation whatsoever as to their accuracy or authenticity. Images shown may be modified for illustrative purposes. Images may be out-of-date and not current. 10.09.19

ROUTE 61 & CHERRY STREET LEESPORT, PA



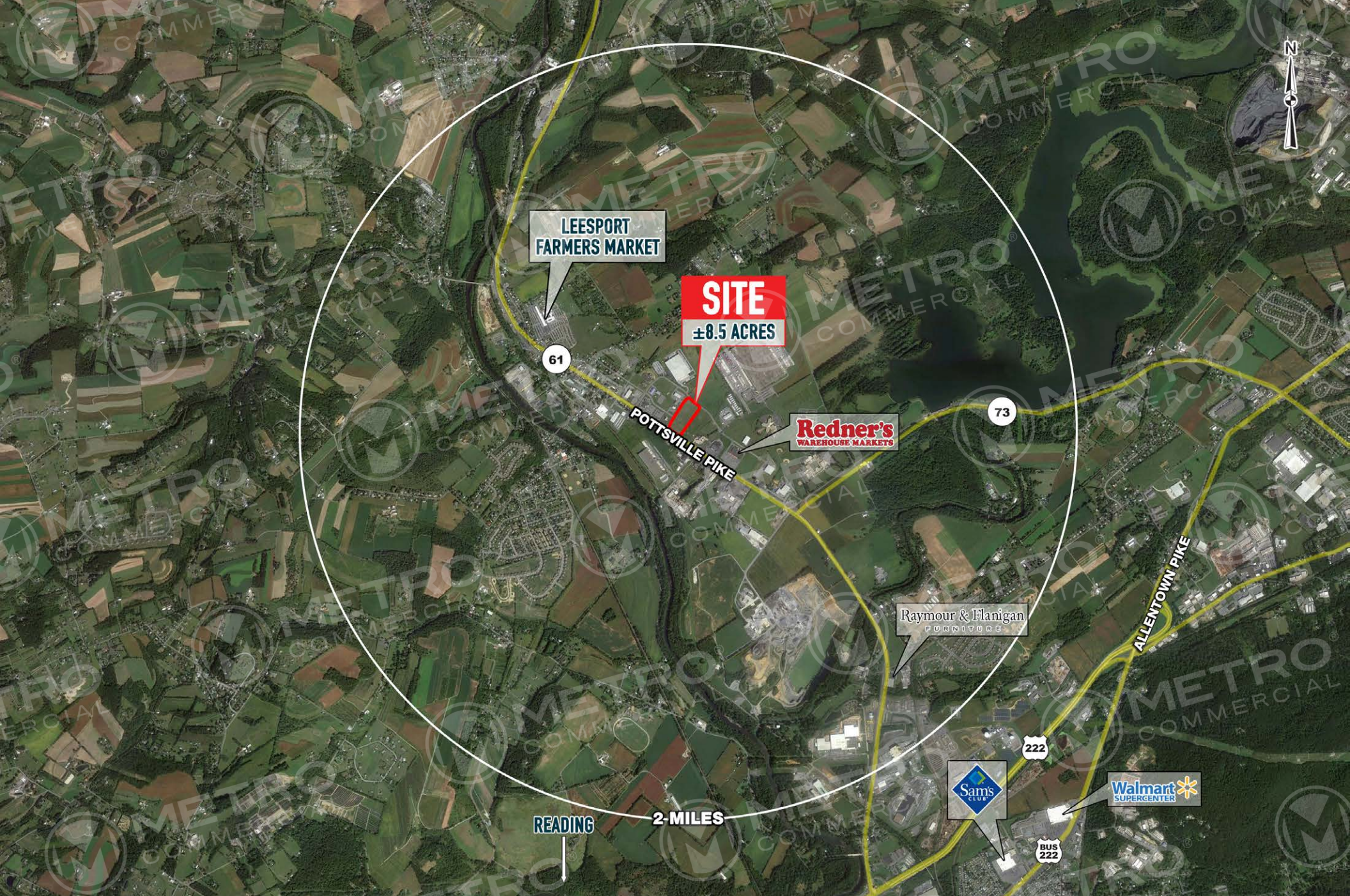

The information and images contained herein are from sources deemed reliable. However, Metro Commercial Real Estate, Inc. makes no representation whatsoever as to their accuracy or authenticity. Images shown may be modified for illustrative purposes. Images may be out-of-date and not current. 10.09.19

ROUTE 61 & CHERRY STREET LEESPORT, PA



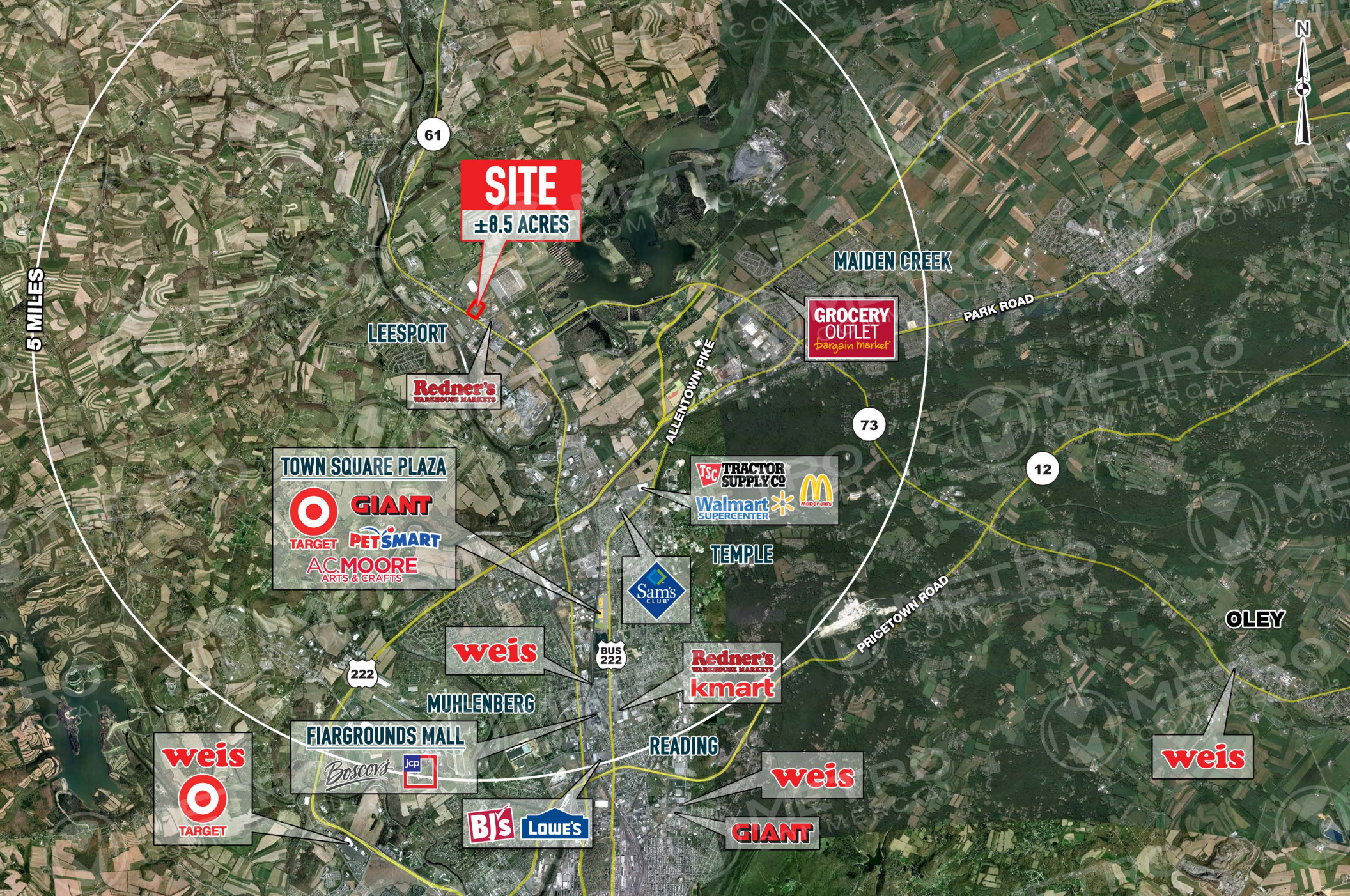

5 MILES

SITE
±8.5 ACRES

LEESPORT

Redner's
WAREHOUSE MARKETS

TOWN SQUARE PLAZA
Target **GIANT**
PETSMART
AC MOORE
 ARTS & CRAFTS

TRACTOR
SUPPLY CO.
Walmart
 SUPERCENTER
 McDonald's

TEMPLE

Sam's
CLUB

weis

Redner's
WAREHOUSE MARKETS
Kmart

MUHLENBERG

FIARGROUNDS MALL
 Boscov's jcp

READING

weis
Target

BJ's **LOWE'S**

weis

GIANT

weis

OLEY

ROUTE 61 & CHERRY STREET
LEESPORT, PA

The information and images contained herein are from sources deemed reliable. However, Metro Commercial Real Estate, Inc. makes no representation whatsoever as to their accuracy or authenticity. Images shown may be modified for illustrative purposes. Images may be out-of-date and not current. 10.09.19