

# FOR LEASE

**TALBOT**  
REALTY GROUP



## HIGHLY VISIBLE RETAIL SPACE

- ADDRESS: 4021 PONTCHARTRAIN BLVD.  
SLIDELL, LA
- RATE: \$13.00 - \$1,500 PER RENTABLE SQUARE FOOT, MODIFIED GROSS
- TERM: 3 YEARS
- RENTABLE AREAS: 5 SUITES TOTALING 6,577 RENTABLE SQUARE FEET.  
LARGEST CONTIGUOUS SPACE IS 4,000 SQUARE FEET.
- OTHER TENANTS: TENANTS INCLUDE TOWER LOAN, PIZZA HUT, AND LA DIAMOND AND JEWELRY.
- COMMENTS:: WELL MAINTAINED NEIGHBORHOOD CENTER IN THE HEART OF PONTCHARTRAIN BLVD. SHOPPING DISTRICT WITH AMPLE PARKING. SPACES FROM 962 SQUARE FEET WITH THE ABILITY TO COMBINE UP TO 4,000 CONTIGUOUS SQUARE FEET.

### FOR MORE INFORMATION CONTACT:

MICHAEL P. POU, CPM©, MCR  
(504) 525-9763 OFFICE (504) 915-5082 CELL  
MPOU@TALBOT-REALTY.COM  
WWW.TALBOT-REALTY.COM

DAVID "COLE" RICHARDSON  
(504) 525-9763 OFFICE (318) 265-2653 CELL  
DCRICHARDSON@TALBOT-REALTY.COM  
WWW.TALBOT-REALTY.COM

The information above has been obtained from sources believed reliable. While we do not doubt its accuracy we have not verified it and make no guarantee, warranty or representation about it. It is your responsibility to independently confirm its accuracy and completeness. Any projections, opinions, assumptions, or estimates used are for example only and do not represent the current or future performance of the property. The value of this transaction to you depends on tax and other factors which should be evaluated by your tax, financial and legal advisors. You and your advisors should conduct a careful, independent investigation of the property to determine to your satisfaction the suitability of the property for your needs. 747 Magazine St. Unit 7 New Orleans, LA 70130 USA | P: 504.525.9763 | F. 504.524.2402 Talbot Realty Group is a Real Estate Brokerage licensed in the State of Louisiana, U.S.A. Robert E. Talbot, Broker and Thomas Lewis, Salesperson are also licensed in the State of Mississippi, U.S.A. MARCH 2021



**4021 PONTCHARTRAIN BOULEVARD  
SLIDELL, LOUISIANA**

Floorplan by Tibby Wagner @ 04 / 16 861-4235

This diagram is an artist's sketch intended for visualization purposes only. This drawing is not an architect's blueprint, and is not to be used for square footage estimates. All measurements are approximate.

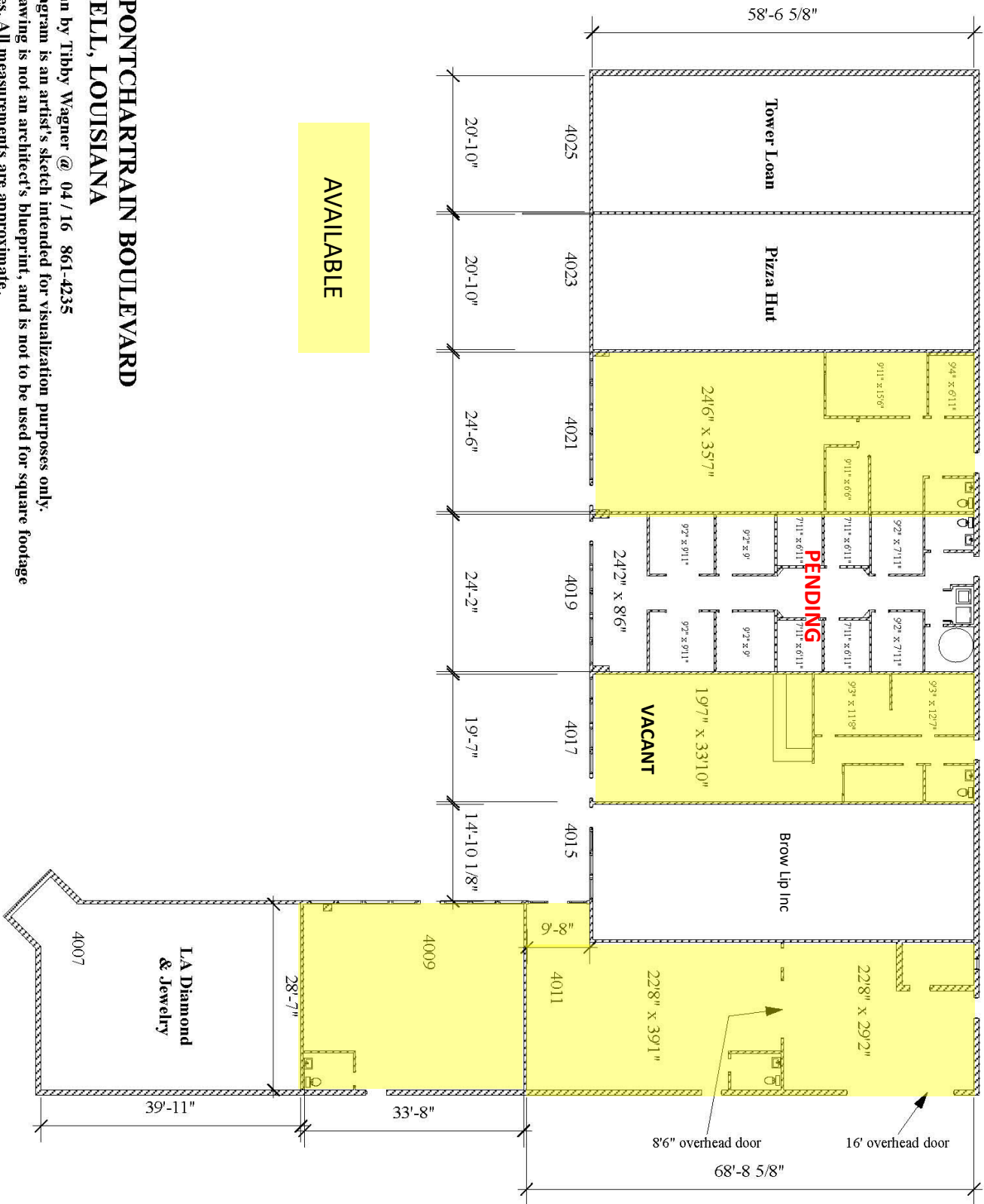

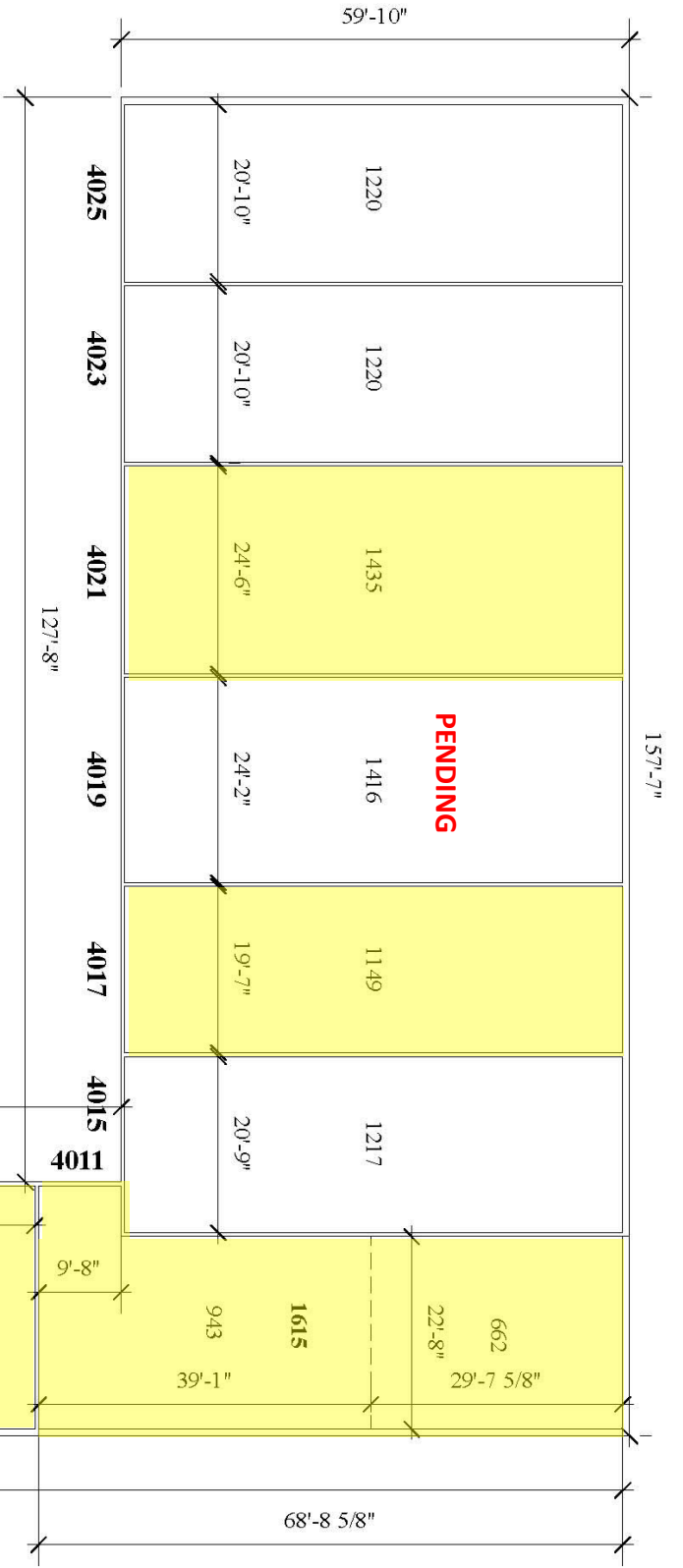

AVAILABLE

Total ≈ 12016

**4021 PONTCHARTRAIN BOULEVARD  
SLIDELL, LOUISIANA**

Floorplan by Tibby Wagner @ 04 / 16 861-4235  
 This diagram is an artist's sketch intended for visualization purposes only.  
 This drawing is not an architect's blueprint, and is not to be used for square footage estimates. All measurements are approximate.

