



Property

- ±25,855 SF available for lease over three floors: first, second, and lower level.
- Rare large-format freestanding building on one of Philadelphia's dominant shopping streets.
- Surrounded by national shops and restaurants including:



NORDSTROM rack

- Heavily trafficked day, evening, and weekend location.

Stats

- 1-Mile Population: 79,280
- Daytime Population: 240,192
- Households: 46,023
- Income: \$90,641

Exclusive Agent:



MICHAEL GORMAN

mgorman@metrocommercial.com

SCOTT BENSON

sbenso@metrocommercial.com

215.893.0300

www.metrocommercial.com

1528 CHESTNUT

SECOND FLOOR

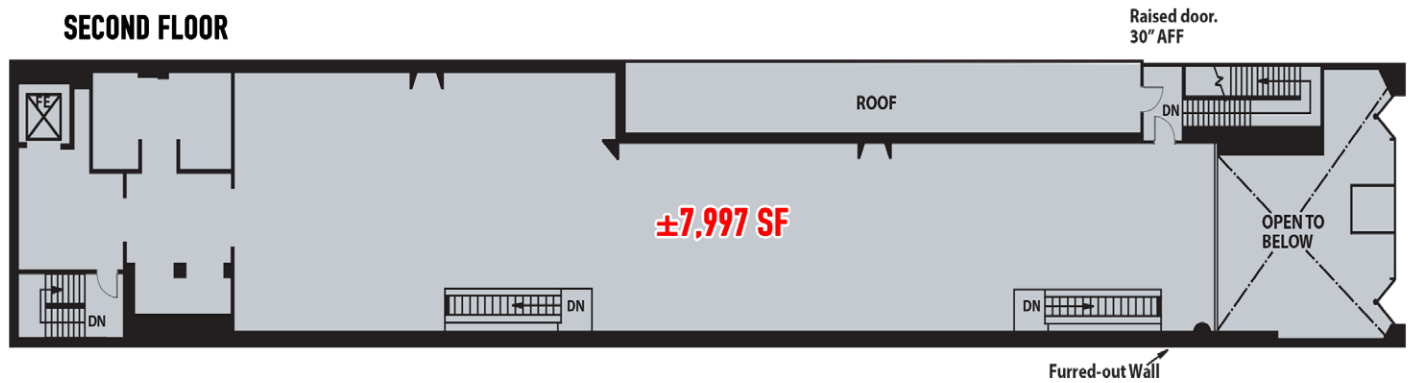

GROUND FLOOR

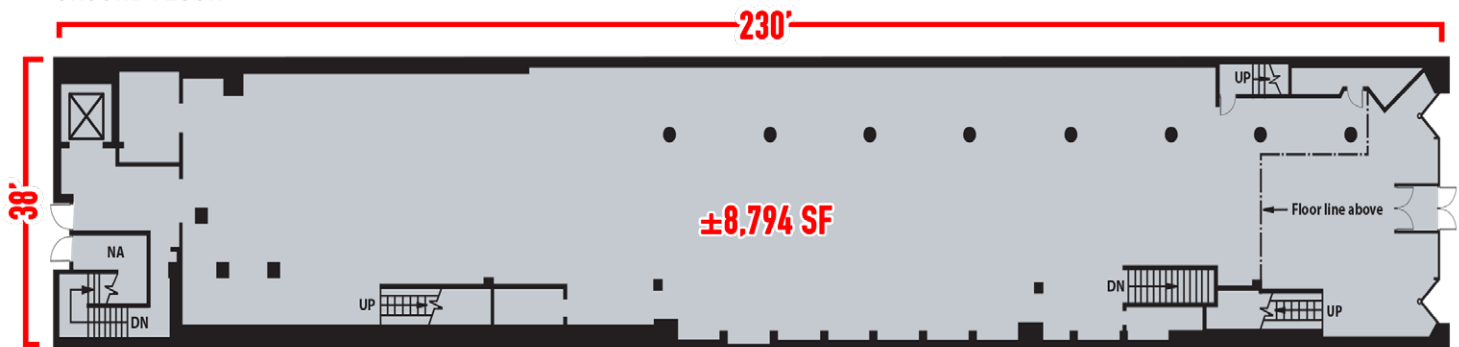

BASEMENT



The information and images contained herein are from sources deemed reliable. However, Metro Commercial Real Estate, Inc. makes no representation whatsoever as to their accuracy or authenticity. Images shown may be modified for illustrative purposes. Images may be out-of-date and not current. 7.22.20

1528 CHESTNUT STREET
PHILADELPHIA, PA



