

RETAIL/RESTAURANT/FITNESS SPACE

646 LORIMER STREET

Corner of Meeker Avenue and Lorimer Streets

WILLIAMSBURG

BROOKLYN | NY

4,894 SF

Available for Lease



RIPCO
REAL ESTATE

SPACE DETAILS

GROUND FLOOR

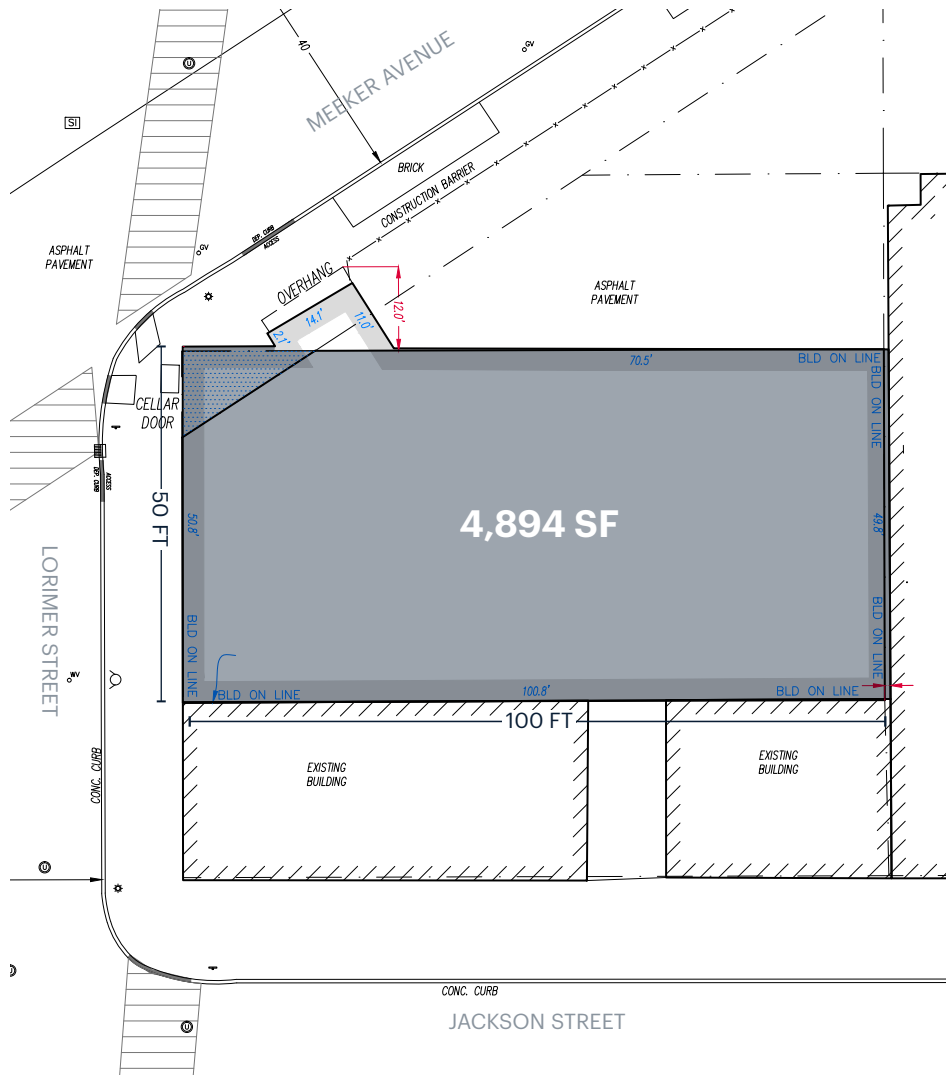

LOCATION

Southeast corner of Meeker Avenue and Lorimer Street

SIZE

Ground Floor 4,894 SF

FRONTAGE

Lorimer Street 50 FT

CEILING HEIGHTS

Ground Floor 15 FT

FORMERLY

Nike SB Garage skate park

NEIGHBORS

Llama Inn, Night of Joy, Bar Beau, Bamontes, Kings County Imperial, Hotel Le Jolie, The Exley, Lilia

COMMENTS

Authentic Williamsburg warehouse
High visibility on a busy corner
Column free space

TRANSPORTATION

2018 Ridership Report

| Lorimer Street/ Metropolitan Avenue | | L | G |
|--|-----------|---|---|
| Annual | 4,821,359 | | |
| Weekday | 14,299 | | |
| Weekend | 21,801 | | |

| B48 | | B | 48 |
|---------|-----------|---|----|
| Annual | 1,121,161 | | |
| Weekday | 3,534 | | |
| Weekend | 4,089 | | |

ADDITIONAL PHOTOS



