

**RETAIL SPACE**

# 480 PARK AVENUE

Between Park and Madison Avenues

**MIDTOWN**

MANHATTAN | NY

**1,530 SF**  
For Lease



**RIPCO**  
REAL ESTATE

## SPACE DETAILS

### LOCATION

Between Park and Madison Avenues

### SIZE

Ground Floor 1,530 SF

### FRONTAGE

East 58th Street 32 FT

### CEILING HEIGHTS

Ground Floor 14 FT

### STATUS

Formerly Tressera

### POSSESSION

Immediate

### TERM

Short or long-term

### RENT

Upon request

### NEIGHBORS

Pronovias, Lavo, Tao, Deciem, Balenciaga,  
Celine, Montblanc, Amsale

### COMMENTS

Fully built-out retail space with ample  
frontage across from the Four Seasons Hotel

Visibility from Park and Madison Avenues

### TRANSPORTATION

2019 Ridership Report

#### Lexington and 59th Street

Annual	16,760,813
Weekday	54,907
Weekend	51,474

#### Fifth Avenue and 59th Street

Annual	4,995,128
Weekday	15,854
Weekend	17,438

4 5 6

N R W

N R W

### GROUND FLOOR

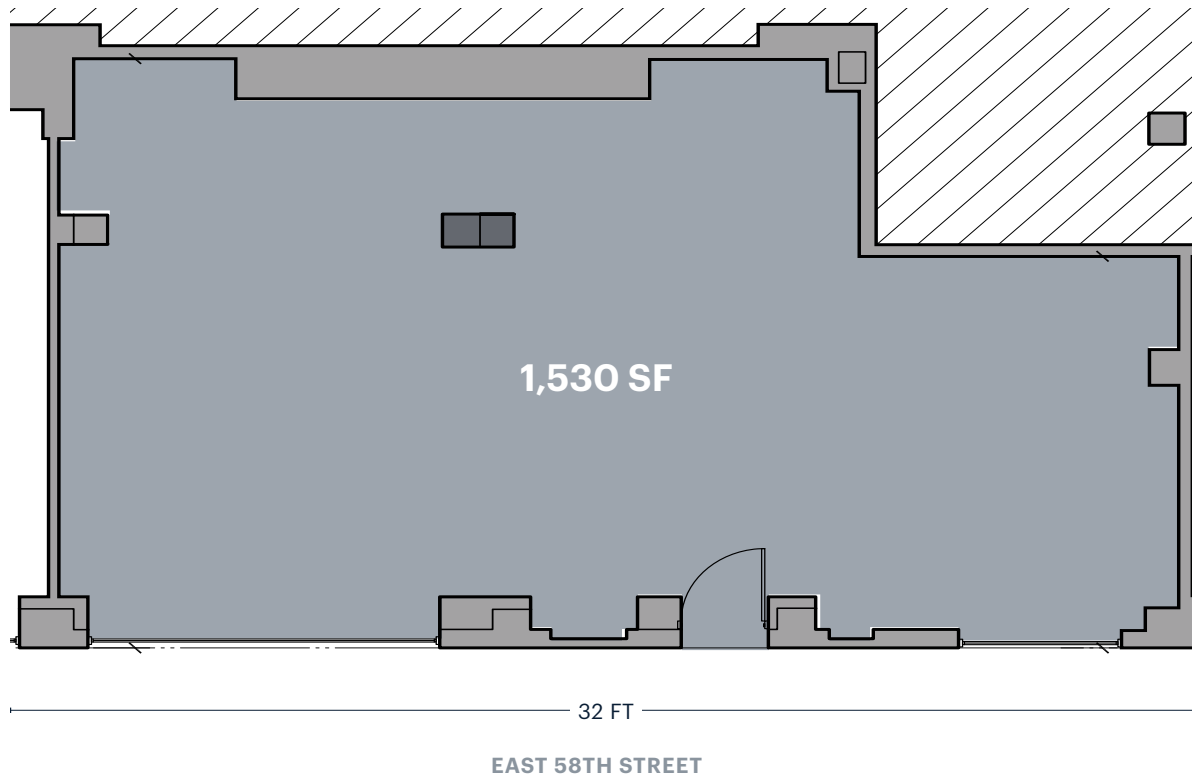

# AREA RETAIL

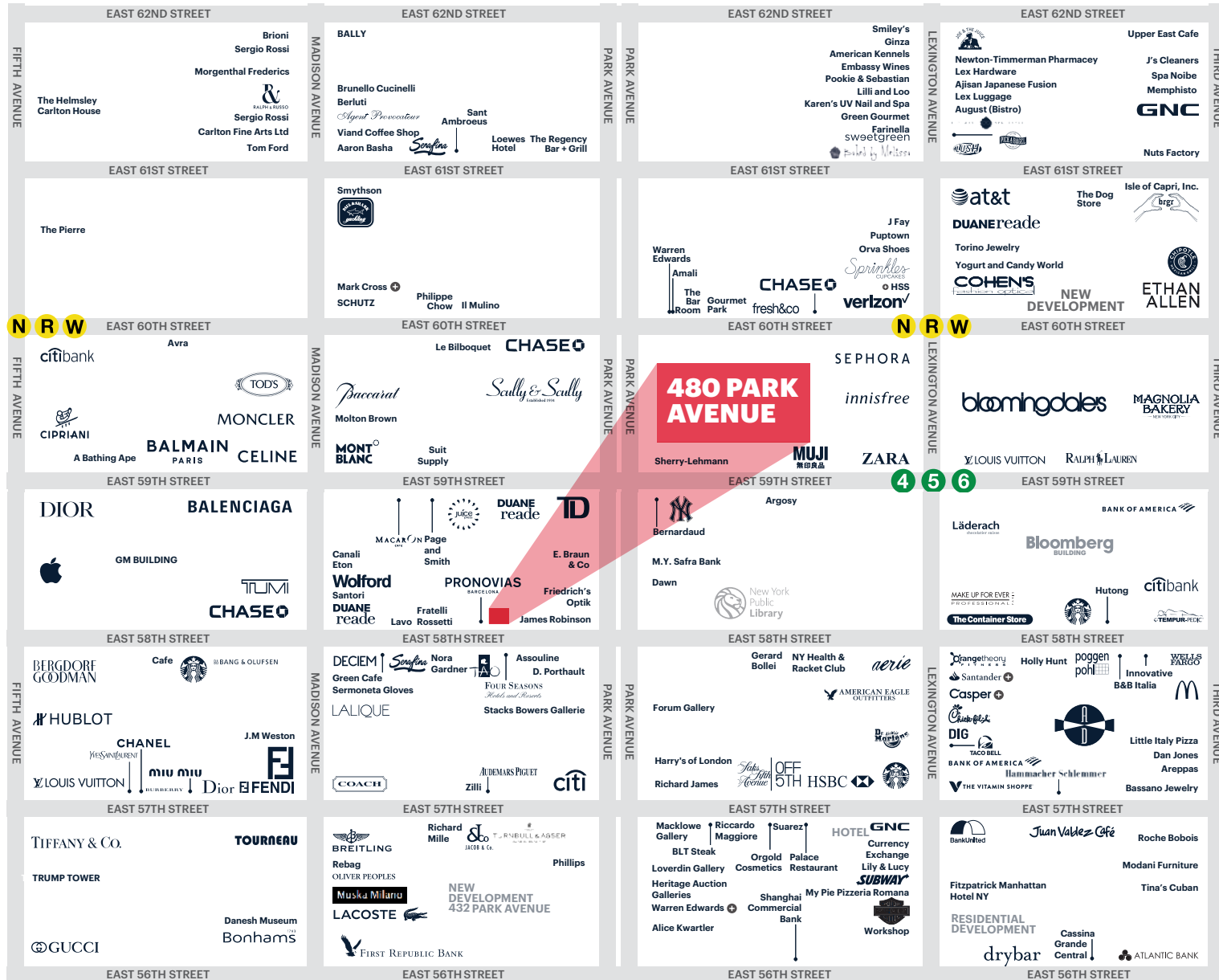

## CONTACT EXCLUSIVE AGENTS

**ANDREW MANDELL**  
 amandell@ripcony.com  
 212.750.0705

**RICHARD SKULNIK**  
 rskulnik@ripcony.com  
 212.750.0756

**LINDSAY ZEGANS**  
 lzegans@ripcony.com  
 646.827.9962

+ Coming Soon



150 East 58th Street  
 15th Floor  
 New York, NY 10155  
 212.750.6565

Please visit us at [ripcony.com](http://ripcony.com) for more information

This information has been secured from sources we believe to be reliable, but we make no representations as to the accuracy of the information. References to square footage are approximate. Buyer must verify the information and bears all risk for any inaccuracies.