

STREET RETAIL

135 MONTAGUE STREET

Between Henry and Clinton Streets

BROOKLYN HEIGHTS

BROOKLYN | NY

3,675 SF

Available for Lease



RIPCO
REAL ESTATE

SPACE DETAILS

SECOND FLOOR

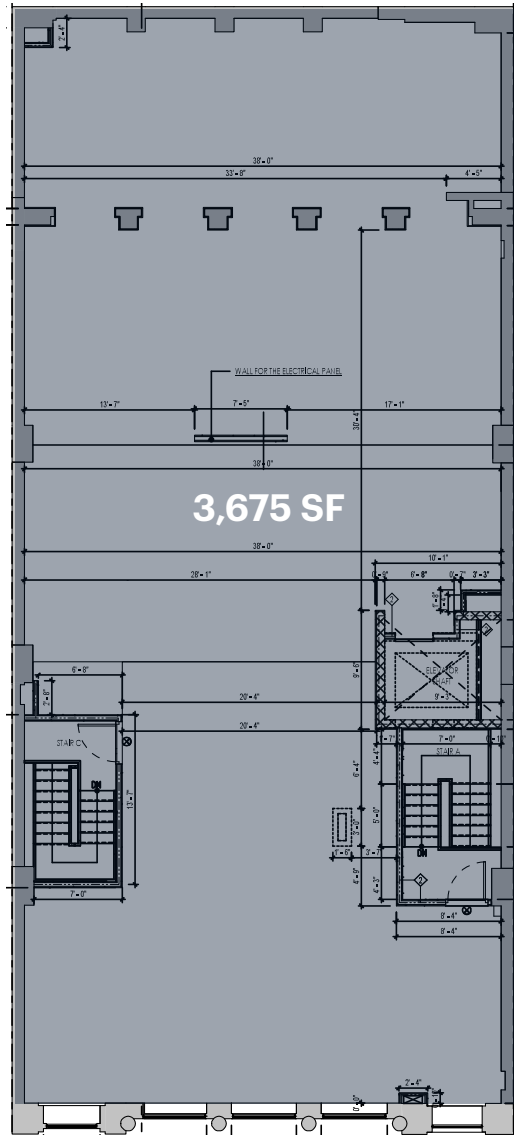

MONTAGUE STREET

LOCATION

North side of Montague Street
between Henry and Clinton Street

SIZE

Second Floor 3,675 SF

FRONTAGE

40 FT

CURRENTLY

Vacant

POSSESSION

Immediate

NEIGHBORS

City MD, City Chemist, Kiehls, Ann
Taylor Loft, Five Guys, Starbucks, AT&T

COMMENTS

Exclusive street level entry with
elevator access

High street visibility and brand
exposure

Atrium brings sun and brightness to a
fantastic open space

TRANSPORTATION

2019 Ridership Report

Court Street/
Borough Hall



Annual 10,135,722
Weekday 4,939
Weekend 22,988

Clark Street



Annual 1,781,419
Weekday 5,590
Weekend 6,562



135 Montague Street (Second Floor Only)

AREA RETAIL



CONTACT EXCLUSIVE AGENT

HYMIE M. DWECK

hdweck@ripcony.com

646.827.9973

RIPCO
REAL ESTATE

32 Court Street
10th Floor
Brooklyn, NY 11201
718.233.6565

Please visit us at ripcony.com for more information

This information has been secured from sources we believe to be reliable, but we make no representations as to the accuracy of the information. References to square footage are approximate. Buyer must verify the information and bears all risk for any inaccuracies.