

**STREET RETAIL/RESTAURANT/QSR/MEDICAL/FITNESS/OFFICE/COMMUNITY FACILITY**

# 232 COURT STREET

Southwest Corner of Court and Baltic Streets

**COBBLE HILL**

BROOKLYN | NY

**1,900 SF**  
Available for Lease



SPACE DETAILS

GROUND FLOOR

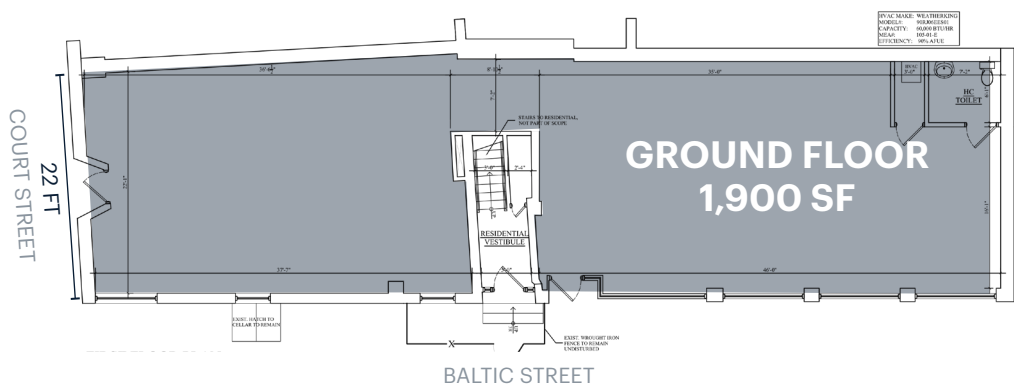

LOWER LEVEL

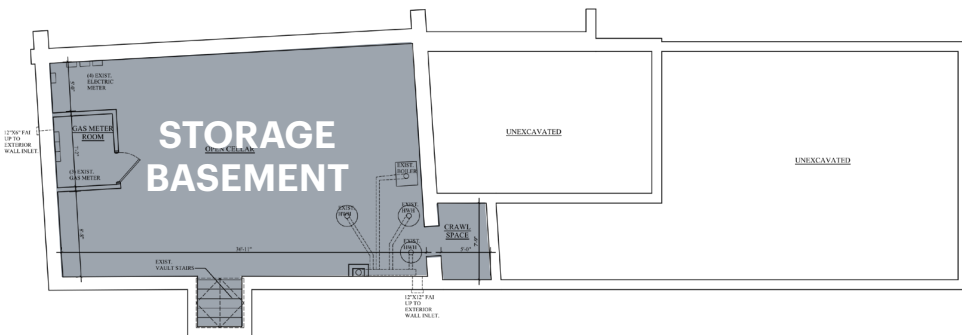

LOCATION

Southwest corner Of Court And Baltic Streets

SIZE

Ground Floor 1,900 SF

FRONTAGE

Court Street 22 FT

CEILING HEIGHTS

Ground Floor 12 FT

ASKING RENT

Upon Request

FORMERLY

Ideal Properties Real Estate Office

POSSESSION

Immediate

NEIGHBORS

Union Market, CityMD, Ridgewood Savings Bank, NY Kids Club, SLT, Pure Barre, Bond VET

COMMENTS

Great corner location with maximum visibility and frontage  
Landmarked exterior

TRANSPORTATION

2019 Ridership Report

Bergen Street

Annual	3,577,496
Weekday	11,310
Weekend	12,914



## AREA RETAIL



## CONTACT EXCLUSIVE AGENTS

**HYMIE M. DWECK**

hdweck@ripcony.com | 718.233.6565

**RIPCO**  
REAL ESTATE

32 Court Street  
10th Floor  
Brooklyn, NY 11201  
718.233.6565

Please visit us at [ripcony.com](http://ripcony.com) for more information

This information has been secured from sources we believe to be reliable, but we make no representations as to the accuracy of the information. References to square footage are approximate. Buyer must verify the information and bears all risk for any inaccuracies.