

RETAIL SPACE

133 NORFOLK STREET

Between Stanton and Rivington Streets

LOWER EAST SIDE

NEW YORK | NY

2,500 SF
Available for Lease



RIPCO
REAL ESTATE

SPACE DETAILS

GROUND FLOOR

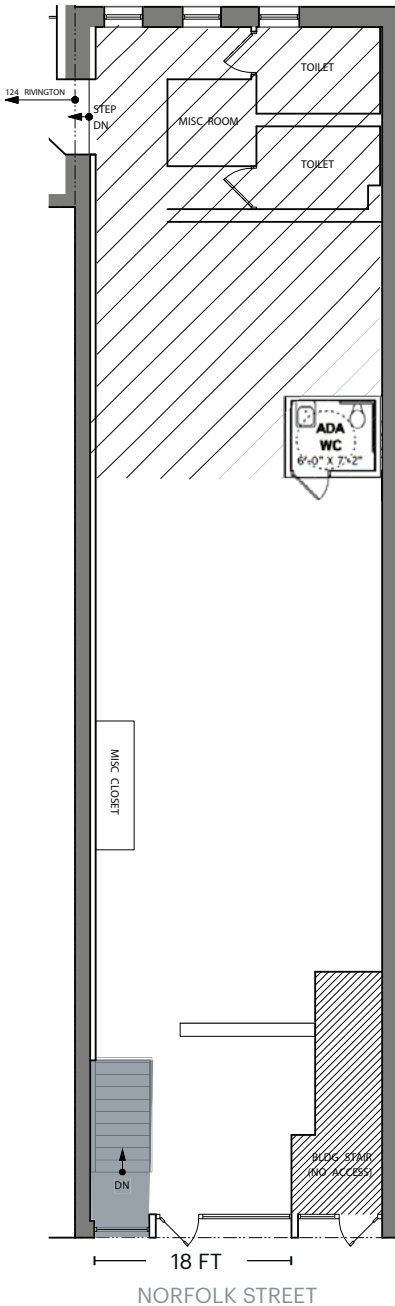

LOWER LEVEL

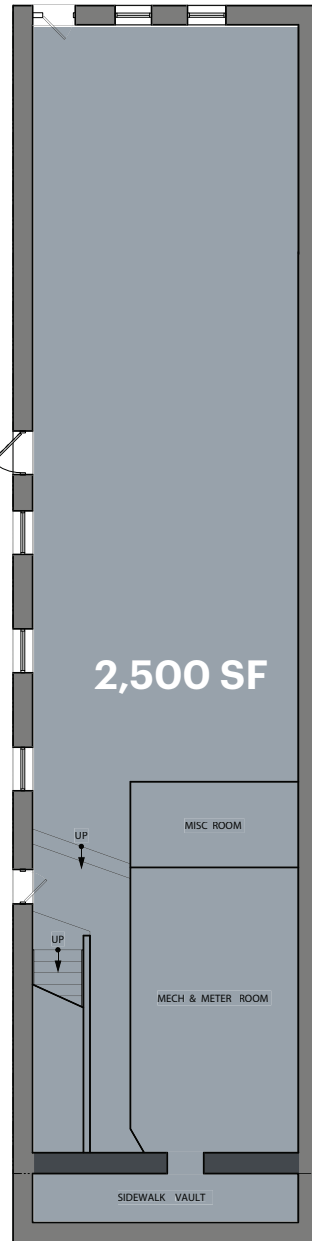

SIZE

Lower Level 2,500 SF

FRONTAGE

Norfolk Street 4 FT

CEILING HEIGHTS

Lower Level 10 FT

POSSESSION

Immediate

RENT

Upon Request

NEIGHBORS

Supermoon Bakehouse, Essex Restaurant, Alife, Only NY, The Magician, La Caverna, La Contenta, Sugar Sweet Sunshine, Davidovich Bakery, Tiny's Giant Sandwich Shop, and The Falafel Guys

COMMENTS

Dedicated ground floor entry
 Vented for cooking
 10 FT ceilings

TRANSPORTATION

2017 Ridership Report

Delancey St/Essex St **F M J Z**

Annual 8,128,719

Weekday 24,993

Weekend 32,713

AREA RETAIL



CONTACT EXCLUSIVE AGENTS

RICHARD SKULNIK
 rskulnik@ripcony.com
 212.750.0756

ZACH STEINBERG
 zsteinberg@ripcony.com
 212.750.2789

⊕ Coming Soon



150 East 58th Street
 15th Floor
 New York, NY 10155
 212.750.6565

Please visit us at ripcony.com for more information

This information has been secured from sources we believe to be reliable, but we make no representations as to the accuracy of the information. References to square footage are approximate. Buyer must verify the information and bears all risk for any inaccuracies.