

**RETAIL SPACE**

# 6713 18TH AVENUE

Located Between 67th and 68th Streets

**BENSONHURST**

BROOKLYN | NEW YORK

**800 SF**

Available for Lease



**RIPCO**  
REAL ESTATE

# SPACE DETAILS

## GROUND FLOOR

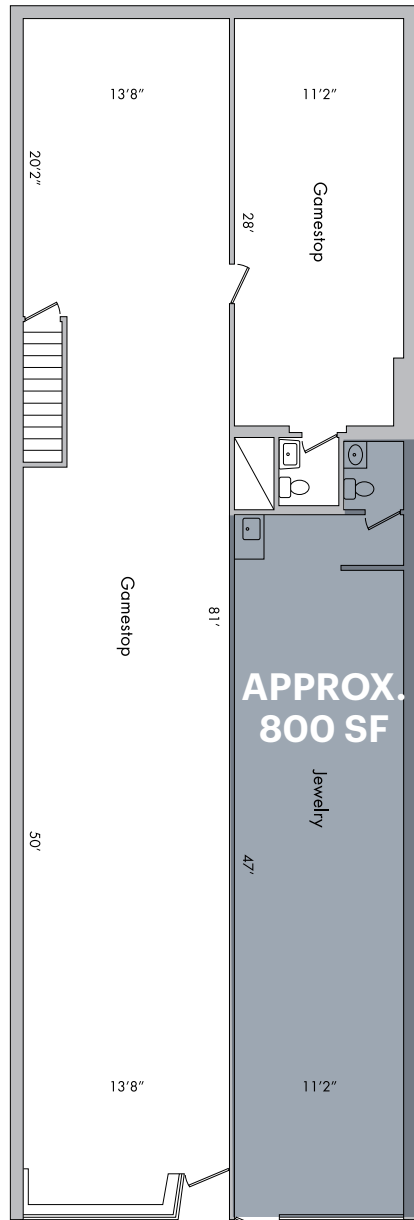

18TH AVENUE

### LOCATION

East side of 18th Avenue between 67th and 68th Streets

### SIZE

Ground Floor    Approx. 800 SF  
 Lower Level      Full Basement

### RENT

Upon Request

### TAXES

Upon Request

### CURRENTLY

L & R Jewelers

### POSSESSION

Immediate

### NEIGHBORS

T-Mobile, AT&T, TD Bank, Apple Bank, Verizon, Subway, Cricket, Walgreen, Metro PCS, Telco Stores, Bank of America, Capital One

### COMMENTS

National tenant block  
 Located in the heart of Bensonhurst  
 Convenient public transportation  
 Additional space could be made available

### TRANSPORTATION

2019 Ridership Report

#### 18th Avenue

	N
Annual	1,179,756
Weekday	3,681
Weekend	4,402

#### B8

	B8
Annual	4,455,344
Weekday	18,036
Weekend	20,767



## AREA RETAIL

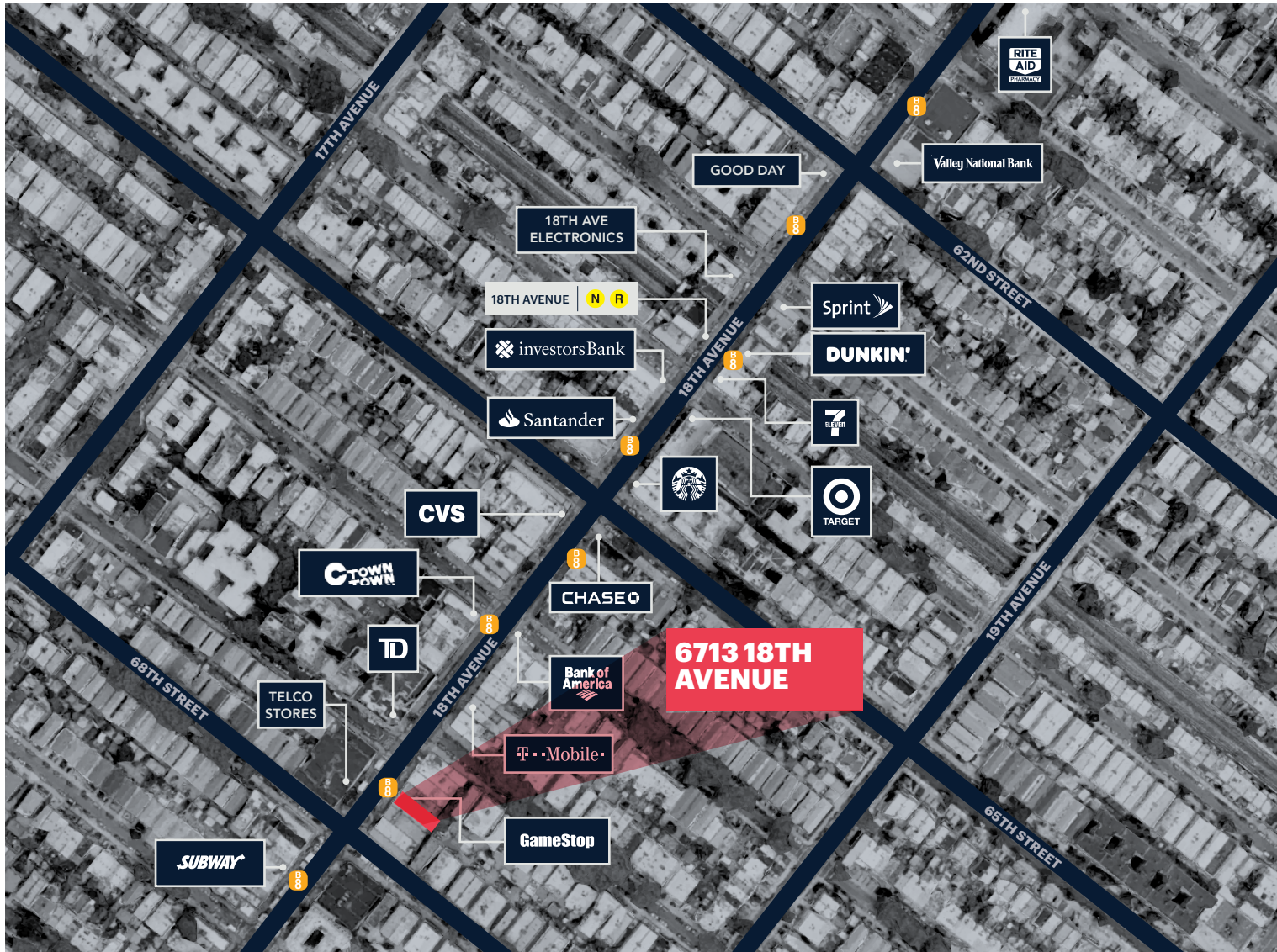

## CONTACT EXCLUSIVE AGENTS

**PETER YOON**

pyoon@ripcony.com  
718.233.6565

**RICHARD SENIOR**

rseior@ripcony.com  
718.233.6565

**RIPCO**  
REAL ESTATE

32 Court Street  
10th Floor  
Brooklyn, NY 11201  
718.233.6565

Please visit us at [ripcony.com](http://ripcony.com) for more information

This information has been secured from sources we believe to be reliable, but we make no representations as to the accuracy of the information. References to square footage are approximate. Buyer must verify the information and bears all risk for any inaccuracies.