



2,800 SF

Retail Space
For Lease

RETAIL SPACE

81 ESSEX STREET

West block between Delancey and Broome Streets

LOWER EAST SIDE
NEW YORK | NY

RIPCO
REAL ESTATE

PHOTOS



SPACE DETAILS

GROUND FLOOR

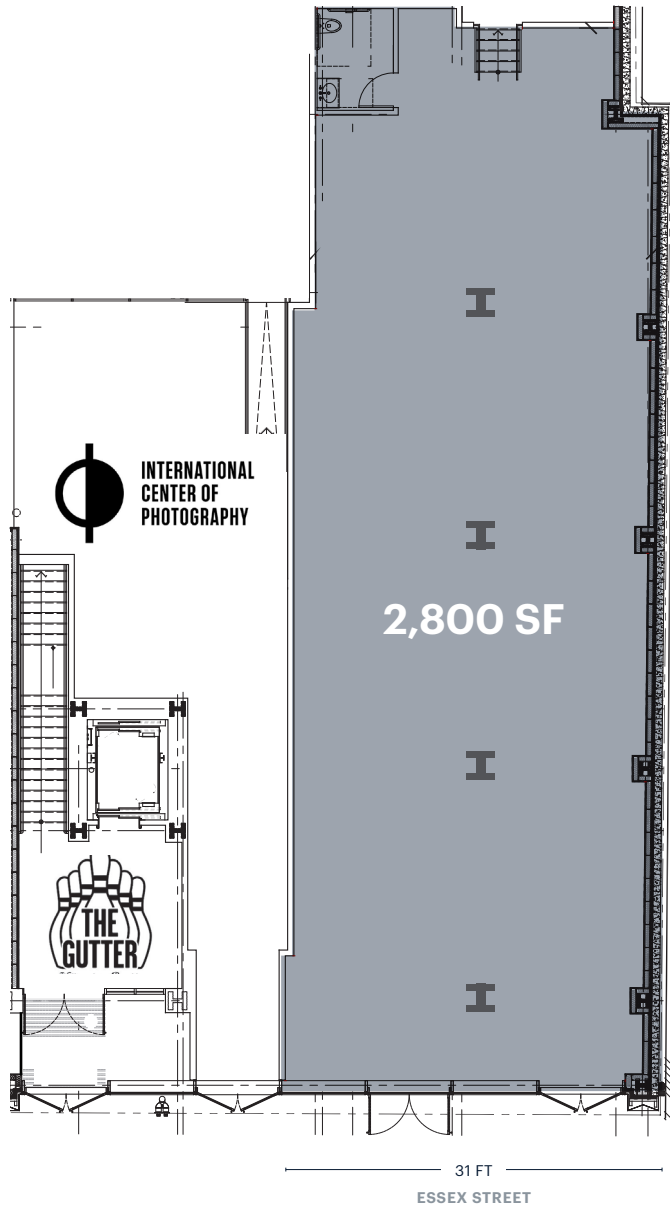

LOCATION

West block between Delancey and Broome Streets

SIZE

Ground Floor 2,800 SF*

*Divisible

FRONTAGE

Essex Street 31 FT

CEILING HEIGHTS

Ground Floor 17 FT

RENT

Upon request

NEIGHBORS

The Gutter, International Center of Photography, Regal Cinemas, Irving Farm, Scotch & Soda, Veselka and Chase Bank

COMMENTS

Directly across the street from Essex Market and the Marketline
Next to the subway entrance
Potential for a storage mezzanine
Space is divisible

TRANSPORTATION

2019 Ridership Report

Delancey Street

Essex Street

Annual	F M J Z 8,861,296
Weekday	26,685
Weekend	38,135

Bowery

Annual	J Z 1,325,244
Weekday	3,842
Weekend	6,368

AREA RETAIL



+ Coming Soon

CONTACT EXCLUSIVE AGENTS

RICHARD SKULNIK
rskulnik@ripcony.com
212.750.0756

LINDSAY ZEGANS
lzegans@ripcony.com
646.827.9962



150 East 58th Street
15th Floor
New York, NY 10155
212.750.6565

Please visit us at ripcony.com for more information

This information has been secured from sources we believe to be reliable, but we make no representations as to the accuracy of the information. References to square footage are approximate. Buyer must verify the information and bears all risk for any inaccuracies.