

RETAIL SPACE

825 EIGHTH AVENUE

Between West 49th and 50th Streets, Worldwide Plaza

MIDTOWN WEST

NEW YORK | NY

1,692 SF

For Lease



SPACE DETAILS

GROUND FLOOR

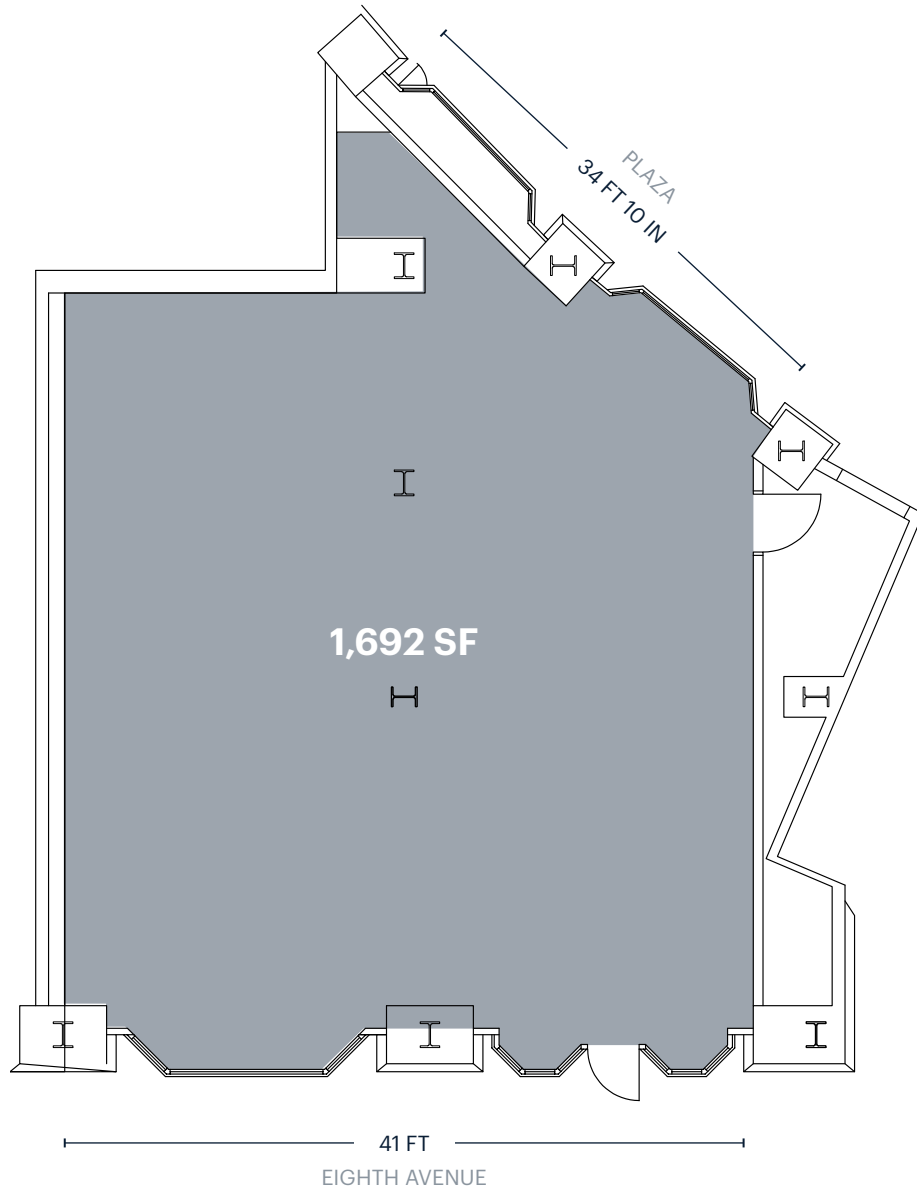

LOCATION

Between West 49th and 50th Streets,
Worldwide Plaza

SIZE

Ground Floor 1,692 SF

FRONTAGE

Eighth Avenue 41 FT
Plaza 34 FT 10 IN

CEILING HEIGHTS

Ground Floor 17 FT 4 IN

STATUS

Formerly Starbucks

POSSESSION

August 1, 2021

RENT

Upon request

TERM

Negotiable

NEIGHBORS

Starbucks, Just Salad, Rite Aid, New
World Stages and Blockheads

COMMENTS

Located at the base of a 455-unit
residential tower and a 1.7M-SF
office tower

Within one block from the E, C
subway entrance, with over 6.9M
riders annually

ADA bathroom in place

Adjacent to subway entrance and
office lobby

TRANSPORTATION

2019 Ridership Report

50th Street

	C E
Annual	6,902,595
Weekday	21,223
Weekend	27,617

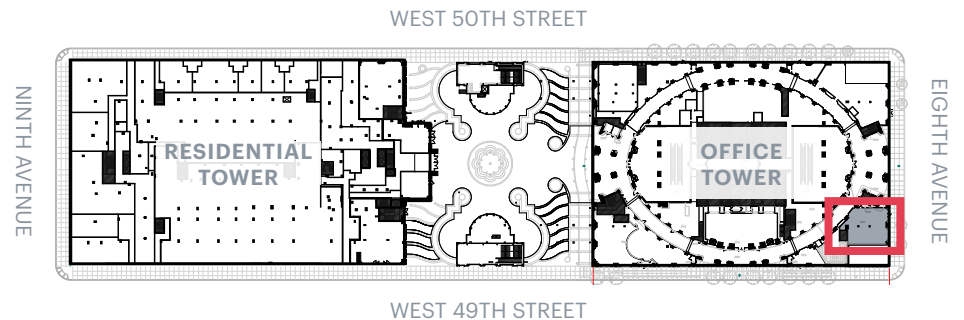

ADDITIONAL PHOTOS



AREA RETAIL



CONTACT EXCLUSIVE AGENTS

RICHARD SKULNIK
 rskulnik@ripcony.com
 212.750.0756

LINDSAY ZEGANS
 lzegans@ripcony.com
 646.827.9962

BEN SABIN
 bsabin@ripcony.com
 646.290.2018