

MIXED USE/FITNESS/MEDICAL/COMMUNITY FACILITY/OFFICE/RESTAURANT/RETAIL

111 LAWRENCE STREET

Between Myrtle Avenue and Willoughby Street

DOWNTOWN BROOKLYN

BROOKLYN | NY

6,920 SF*

Available for Lease

*Divisible



SPACE DETAILS

LOCATION

East side of Lawrence Street between Myrtle Avenue and Willoughby Street

SIZE

Ground Floor 6,920 SF*
Lower Level 1,519 SF
Total 6,920 SF

**Divisible*

FRONTAGE

Lawrence Street 70 FT

CEILING HEIGHTS

Ground Floor 16 FT

ASKING RENT

Upon Request

POSSESSION

Immediate

CURRENTLY

Khim's Millennium Market

NEIGHBORS

City Point, DeKalb Market, Trader Joe's, Century 21, Alamo Drafthouse Cinema, Fulton Mall, MetroTech and Willoughby Square Park (coming soon)

COMMENTS

Clean market space at the base of one of Downtown Brooklyn's largest residential buildings

Walking distance to MetroTech complex and NYU school of engineering

Flexible users, high ceilings and minimal columns

TRANSPORTATION

2019 Ridership Report

Jay Street-Metro Tech 
Annual 12,238,047
Weekday 41,455
Weekend 32,427

Hoyt Street 
Annual 2,293,256
Weekday 7,467
Weekend 7,233

**Borough Hall/
Court Street** 
Annual 10,135,722
Weekday 34,939
Weekend 22,988

SPACE DETAILS

GROUND FLOOR

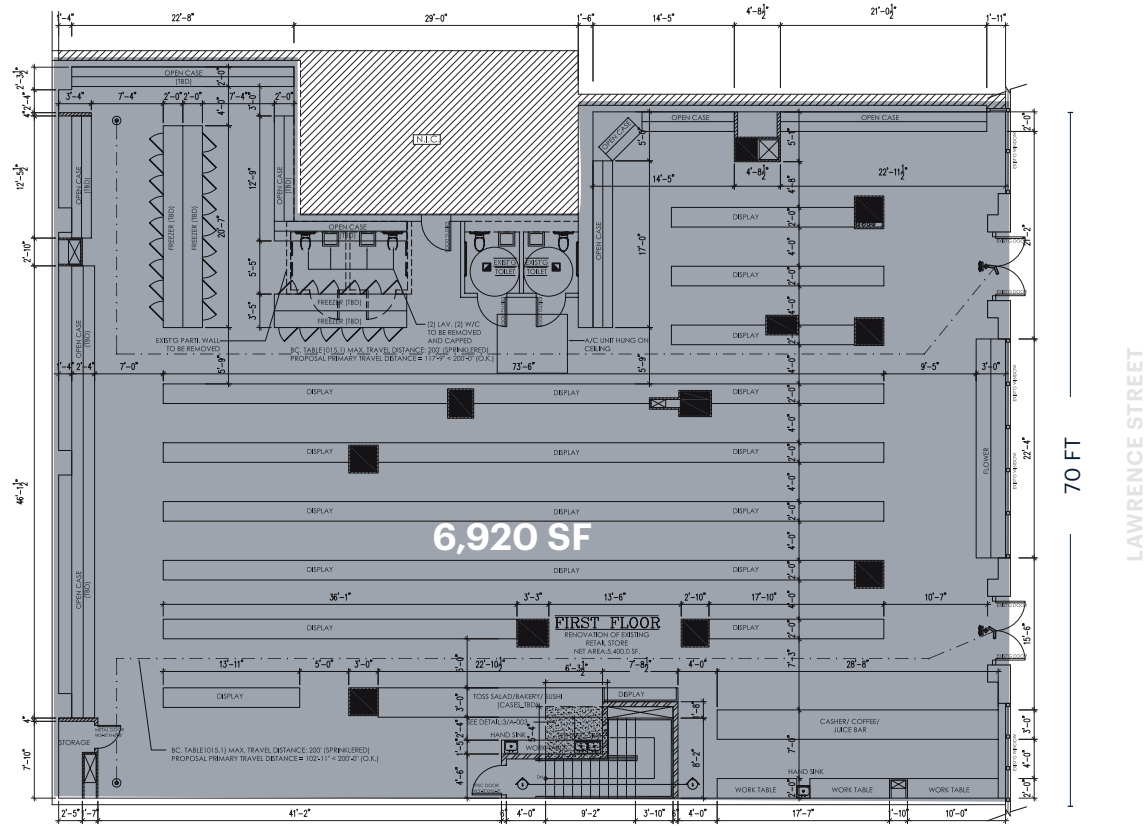

LOWER LEVEL

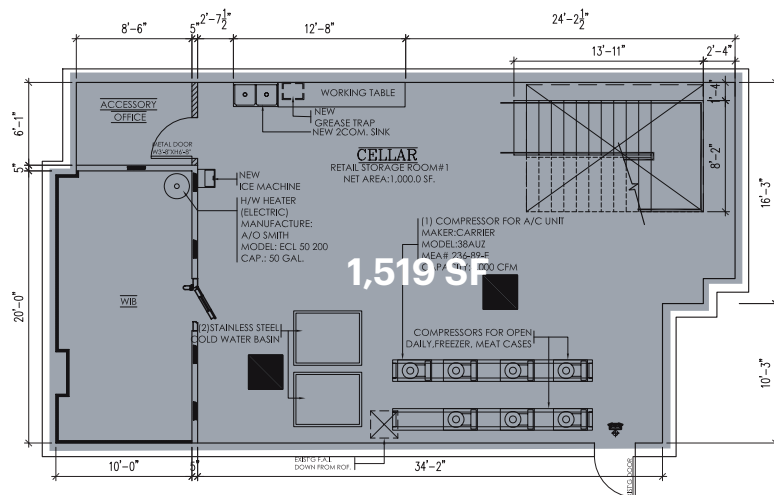

AREA RETAIL



CONTACT EXCLUSIVE AGENT

BEN WEINER

bweiner@ripcony.com

718.233.6565

RIPCO
REAL ESTATE

32 Court Street
10th Floor
Brooklyn, NY 11201
718.233.6565

Please visit us at ripcony.com for more information

This information has been secured from sources we believe to be reliable, but we make no representations as to the accuracy of the information. References to square footage are approximate. Buyer must verify the information and bears all risk for any inaccuracies.