

FITNESS/STREET RETAIL

32 NORTH 6TH STREET

Between North 5th Street Pier/Park and Kent Avenue

WILLIAMSBURG

BROOKLYN | NY

1,648 SF

Available for Lease



RIPCO
REAL ESTATE

SPACE DETAILS

GROUND FLOOR

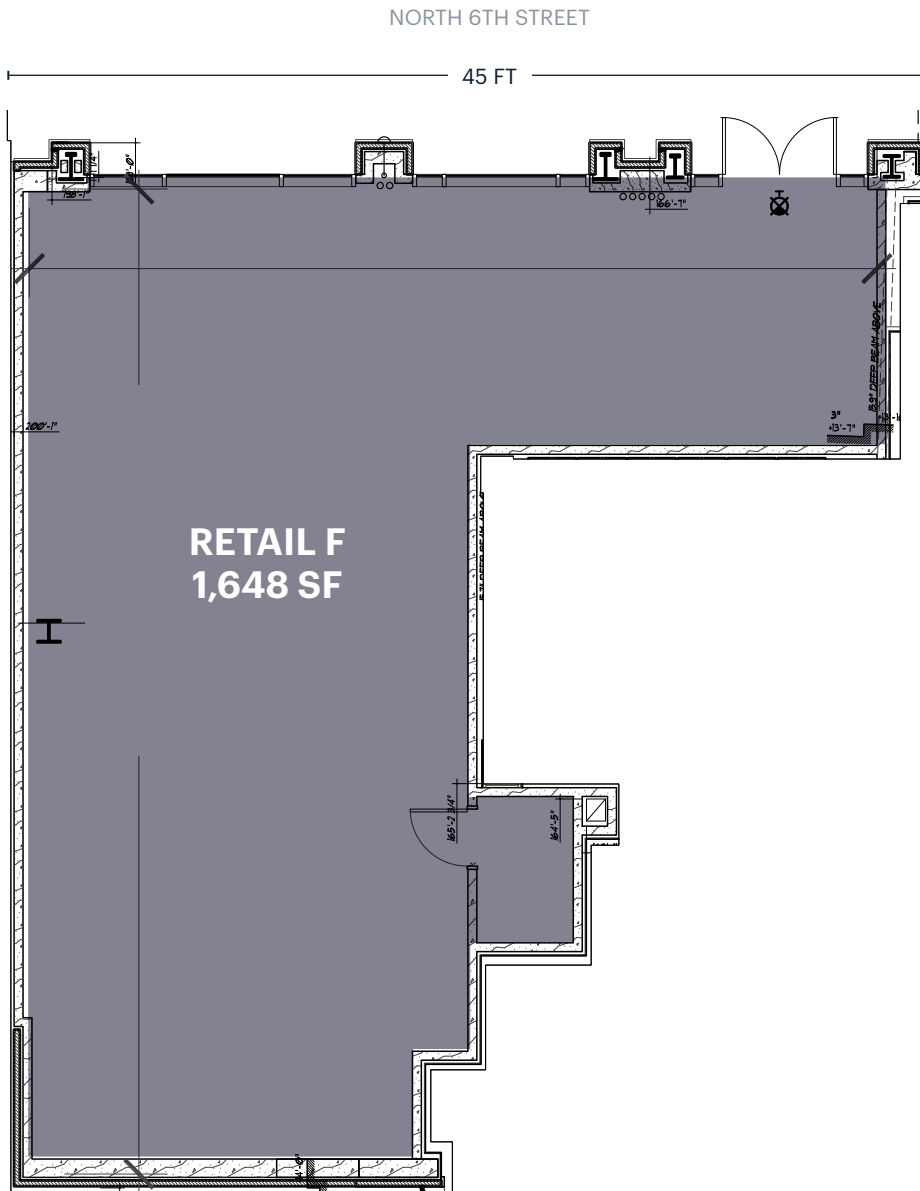

LOCATION

South side of North 6th Street
between East River and Kent Avenue

SIZE

Retail F - Ground Floor 1,648 SF
Mezzanine Storage

FRONTAGE

North 6th Street 45 FT

CEILING HEIGHTS

Ground Floor 14 FT

ASKING RENT

Upon request

POSSESSION

Arranged

TAXES

Tax abatement in place until 2036

NEIGHBORS

Smorgasburg, Brooklyn Flea,
The Wythe Hotel, The Williamsburg
Hotel, La Esquina, J. Crew,
Brooklyn Bowl, Brooklyn Brewery,
Williamsburg Music Hall, CVS,
Brooklyn Harvest, Fabrica -
The Factory, PQ Coffee, Hand and
Stone Massage, Hilltop Bicycles

COMMENTS

Excellent retail space located at
one of the largest and most
established mixed use
developments in Williamsburg

TRANSPORTATION

2019 Ridership Report

Bedford Avenue	L
Annual	7,836,366
Weekday	25,158
Weekend	26,623

East River Ferry	F
Daily	11,035
Ridership approximately 10.4 Million from 2017 to 2019	

