

PRIME RETAIL SPACE ADJACENT TO KOHL'S

Raleigh, NC 27617 | 7822 Alexander Promenade Place | Glenwood Ave & Brier Creek Pkwy | #706 Brier Creek



AVAILABLE SF:
24,100 SF

FRONTAGE:
APPROX 98'1"

ZONING:
COMMERCIAL

RATES:
CALL FOR DETAILS

AREA ANCHORS



- Located in highly sought after Brier Creek sub-market convenient to both Raleigh and Durham
- Co-Tenants include Best Buy, Super Walmart and Dollar Tree
- Located across Glenwood Avenue (52,000 AADT) from Brier Creek Commons: Dicks's Sporting Goods, Staples, Target, BJ's Wholesale, Ross Dress For Less, Barnes and Noble, Regal Cinema, and others.
- Free Standing Location on Brier Creek Parkway

DEMOGRAPHICS	1 MILE	3 MILES	5 MILES	TRAFFIC COUNTS	
2018 Population Density	7,203	35,888	85,642	Glenwood Ave (Hwy 70)	52,000 AADT
2018 Daytime Population	7,247	26,633	87,992	Brier Creek Pkwy	29,000 AADT
2018 Average HH Income	\$108,018	\$103,576	\$106,509		
2018 Median HH Income	\$81,508	\$80,530	\$82,197		



FOR MORE INFORMATION, CONTACT EXCLUSIVE AGENT(S):
JEFF NIMMER, CCIM • jeff.nimmer@tscg.com • 919.380.8041
TYLER QUINN • tyler.quinn@tscg.com • 919.380.8041
TAYLOR DROUILLARD • taylor.drouillard@tscg.com • 919.380.8041

Demographics: Esri

No warranty expressed or implied has been made as to the accuracy of the information provided herein, no liability assumed for error or omissions.



PRIME RETAIL SPACE ADJACENT TO KOHL'S

Raleigh, NC 27617 | 7822 Alexander Promenade Place | Glenwood Ave & Brier Creek Pkwy | #706 Brier Creek

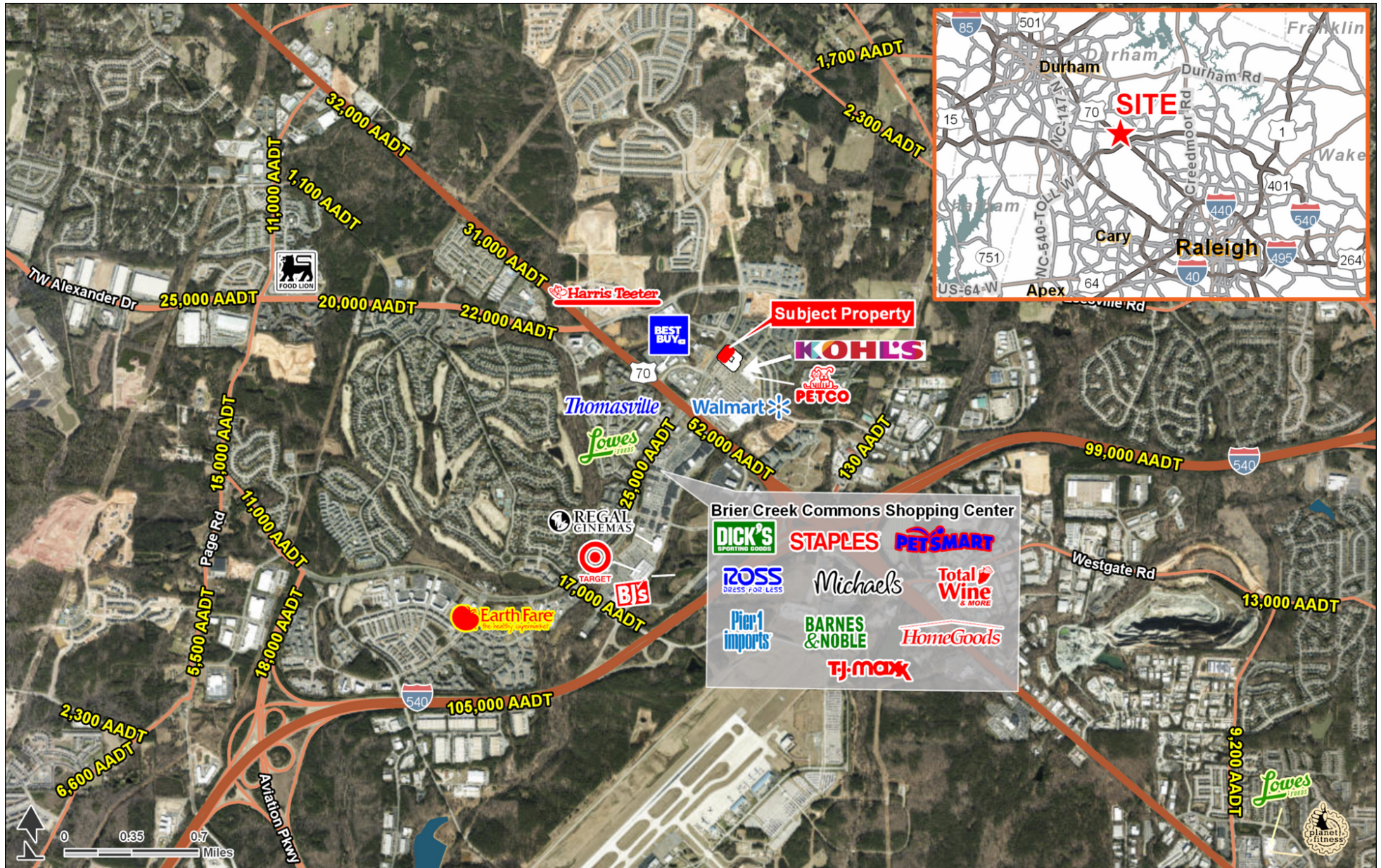

FOR MORE INFORMATION, CONTACT EXCLUSIVE AGENT(S):
 JEFF NIMMER, CCIM • jeff.nimmer@tscg.com • 919.380.8041
 TYLER QUINN • tyler.quinn@tscg.com • 919.380.8041
 TAYLOR DROUILLARD • taylor.drouillard@tscg.com • 919.380.8041

Demographics: Esri



No warranty expressed or implied has been made as to the accuracy of the information provided herein, no liability assumed for error or omissions.

PRIME RETAIL SPACE ADJACENT TO KOHL'S

Raleigh, NC 27617 | 7822 Alexander Promenade Place | Glenwood Ave & Brier Creek Pkwy | #706 Brier Creek



- Alexander Place**
- Panera Bread
 - Cold Stone Creamery
 - Mrs. Fields
 - Red Robin Gourmet Burgers & Brews
 - T-Mobile
 - Starbucks
 - Sprint
 - Wingstop

- Brier Creek Commons Shopping Center**
- Dick's Sporting Goods
 - Staples
 - Party City
 - PetSmart
 - Michaels
 - Ross Dress for Less
 - MyEyeDr.
 - Lane Bryant
 - TJ Maxx
 - HomeGoods
 - Total Wine & More
 - Pier 1 Imports
 - Barnes & Noble



FOR MORE INFORMATION, CONTACT EXCLUSIVE AGENT(S):
 JEFF NIMMER, CCIM • jeff.nimmer@tscg.com • 919.380.8041
 TYLER QUINN • tyler.quinn@tscg.com • 919.380.8041
 TAYLOR DROUILLARD • taylor.drouillard@tscg.com • 919.380.8041

Demographics: Esri

No warranty expressed or implied has been made as to the accuracy of the information provided herein, no liability assumed for error or omissions.



PRIME RETAIL SPACE ADJACENT TO KOHL'S

Raleigh, NC 27617 | 7822 Alexander Promenade Place | Glenwood Ave & Brier Creek Pkwy | #706 Brier Creek

#10706 Brier Creek, NC
Updated: 4/19/18

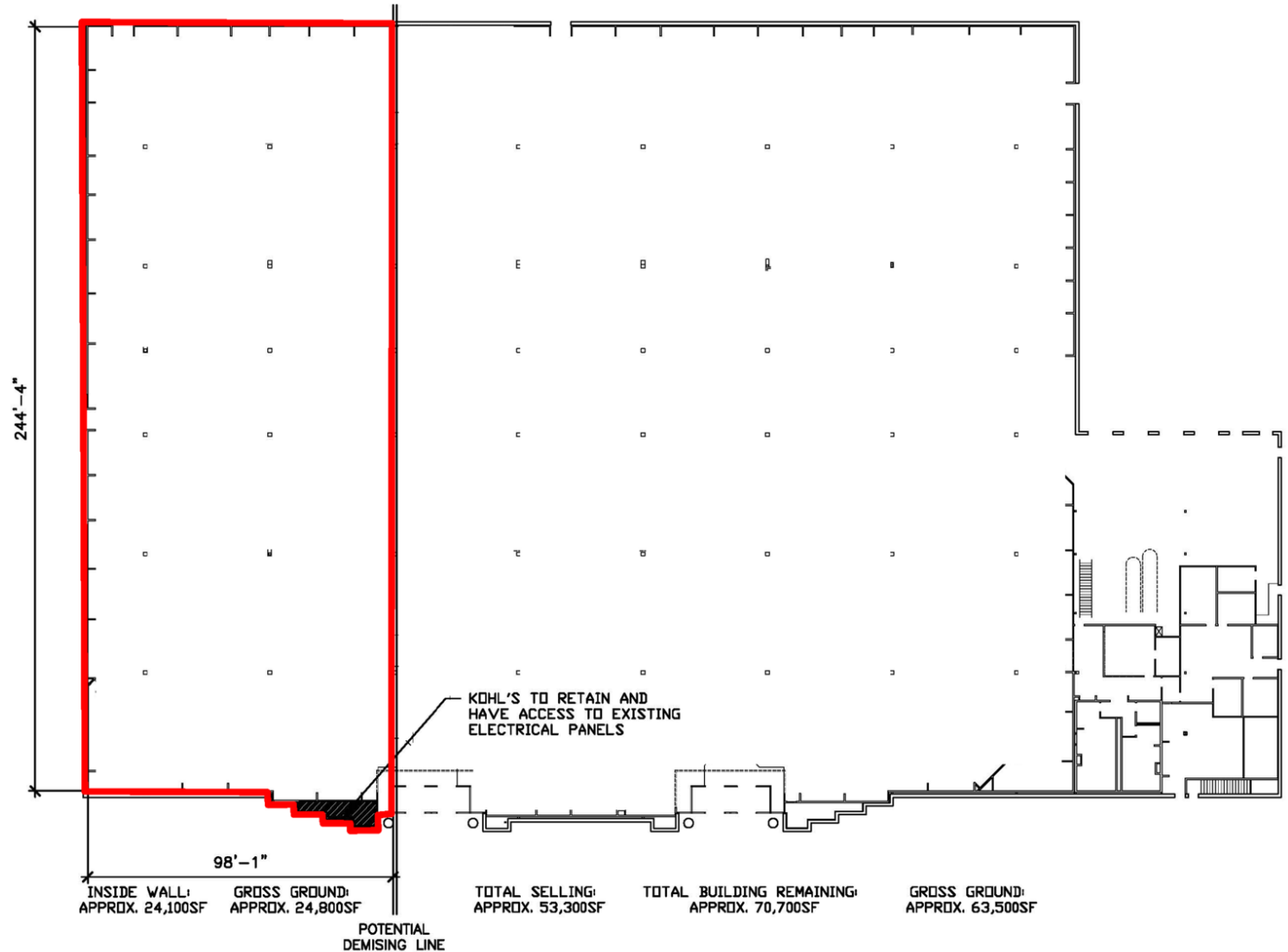

FOR MORE INFORMATION, CONTACT EXCLUSIVE AGENT(S):

JEFF NIMMER, CCIM • jeff.nimmer@tscg.com • 919.380.8041

TYLER QUINN • tyler.quinn@tscg.com • 919.380.8041

TAYLOR DROUILLARD • taylor.drouillard@tscg.com • 919.380.8041

Demographics: Esri

No warranty expressed or implied has been made as to the accuracy of the information provided herein, no liability assumed for error or omissions.

