

# PRIME RETAIL SPACE ADJACENT TO KOHL'S

Greensboro, NC 27407 | 1210 Bridford Pkwy | W Wendover Ave & Bridford Pkwy | #303 Wendover



- Located in dominant retail sub-market in NC's 3rd largest city.
- Co-Tenants include Target, Dick's Sporting Goods, Ross Dress For Less, Michaels and others.
- Other Big Box Tenant in close proximity include Home Depot, Super Walmart, Academy Sports, Gabe's, Hobby Lobby, and Field and Stream.
- Super Regional Shopping Area located on I-40 (Total AADT 142,000)

DEMOGRAPHICS	1 MILE	3 MILES	5 MILES	TRAFFIC COUNTS	
2018 Population Density	8,634	66,955	142,020	W Wendover Ave	31,000 AADT
2018 Daytime Population	6,339	47,899	110,116	1- 40	111,000 AADT
2018 Average HH Income	\$61,566	\$66,734	\$75,520		
2018 Median HH Income	\$50,252	\$50,446	\$54,464		

AVAILABLE SF:  
24,800 SF

FRONTAGE:  
APPROX 98'0"

ZONING:  
COMMERCIAL

RATES:  
CALL FOR DETAILS

## AREA ANCHORS



FOR MORE INFORMATION, CONTACT EXCLUSIVE AGENT(S):  
 JEFF NIMMER, CCIM • jeff.nimmer@tscg.com • 919.380.8041  
 TYLER QUINN • tyler.quinn@tscg.com • 919.380.8041  
 TAYLOR DROUILLARD • taylor.drouillard@tscg.com • 919.380.8041

Demographics: Esri

No warranty expressed or implied has been made as to the accuracy of the information provided herein, no liability assumed for error or omissions.





# PRIME RETAIL SPACE ADJACENT TO KOHL'S

Greensboro, NC 27407 | 1210 Bridford Pkwy | W Wendover Ave & Bridford Pkwy | #303 Wendover

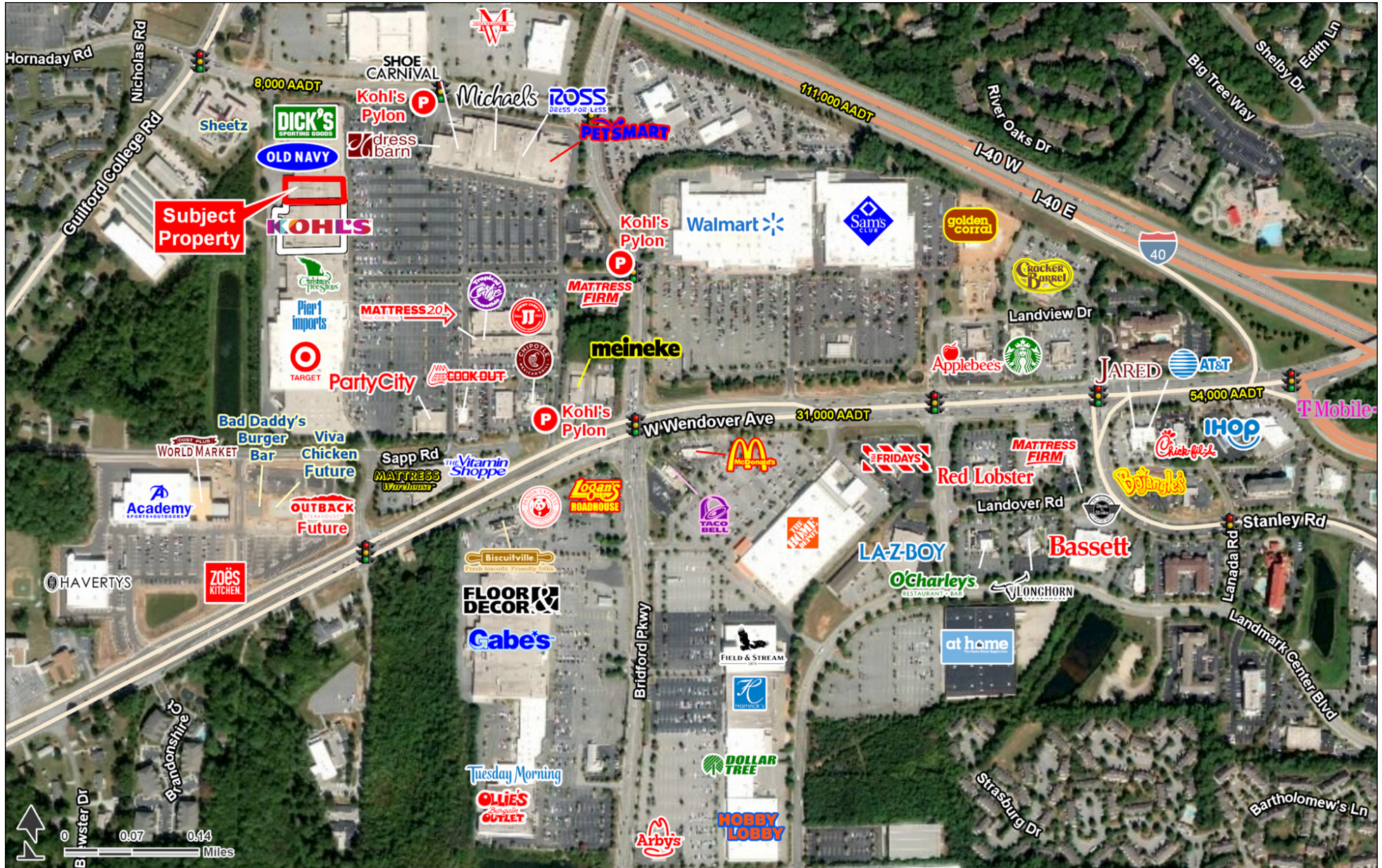

FOR MORE INFORMATION, CONTACT EXCLUSIVE AGENT(S):  
 JEFF NIMMER, CCIM • jeff.nimmer@tscg.com • 919.380.8041  
 TYLER QUINN • tyler.quinn@tscg.com • 919.380.8041  
 TAYLOR DROUILLARD • taylor.drouillard@tscg.com • 919.380.8041

Demographics: Esri

Stan Johnson Co.  
THE NET LEASE AUTHORITY™

CHAINLINKS  
RETAIL ADVISORS

No warranty expressed or implied has been made as to the accuracy of the information provided herein, no liability assumed for error or omissions.

# PRIME RETAIL SPACE ADJACENT TO KOHL'S

Greensboro, NC 27407 | 1210 Bridford Pkwy | W Wendover Ave & Bridford Pkwy | #303 Wendover

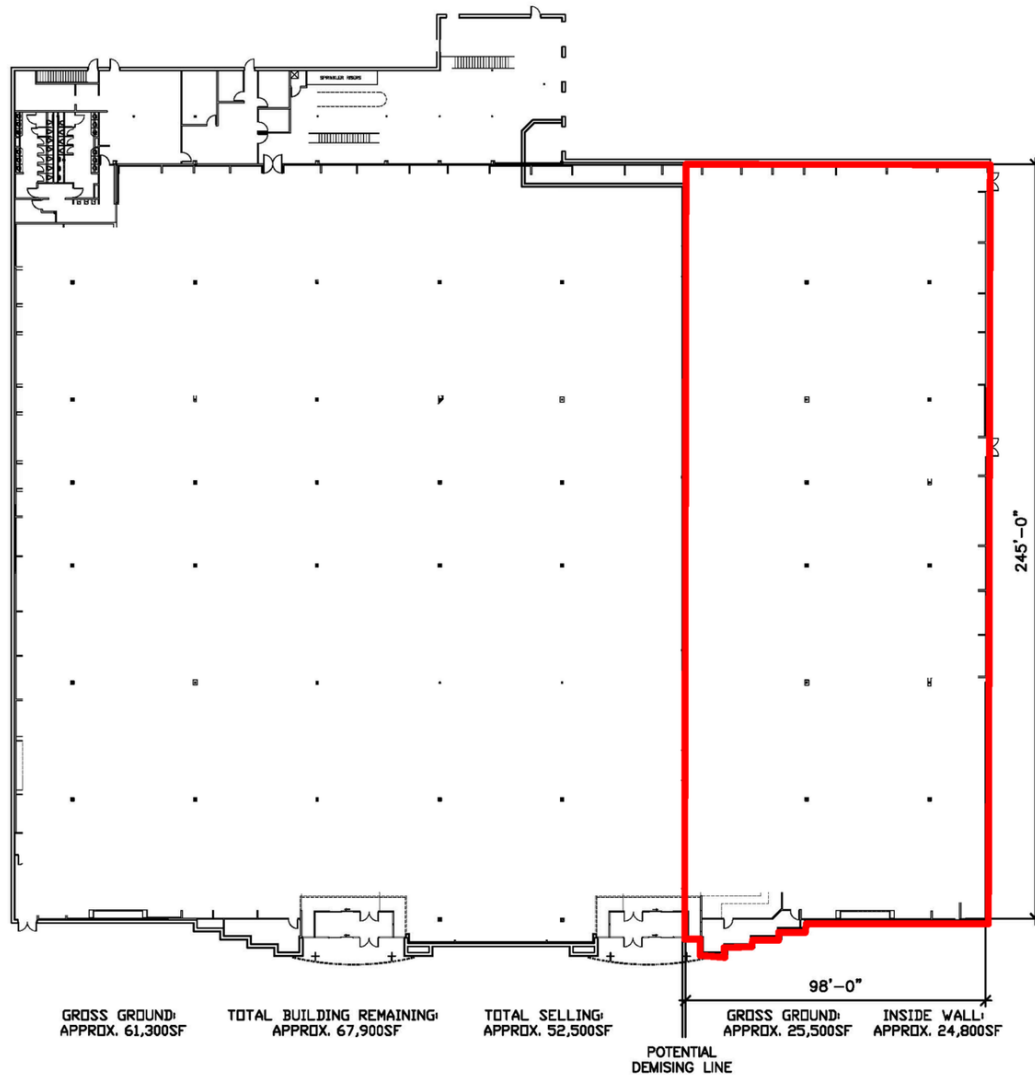

#10303 Wendover, NC  
Updated: 4/17/18



FOR MORE INFORMATION, CONTACT EXCLUSIVE AGENT(S):

JEFF NIMMER, CCIM • jeff.nimmer@tscg.com • 919.380.8041

TYLER QUINN • tyler.quinn@tscg.com • 919.380.8041

TAYLOR DROUILLARD • taylor.drouillard@tscg.com • 919.380.8041

Demographics: Esri

No warranty expressed or implied has been made as to the accuracy of the information provided herein, no liability assumed for error or omissions.

