

Office for Lease ISSAQUAH / GILMAN OFFICE

300 NE Gilman Blvd, Issaquah, WA 98027



LISTING INFORMATION

AVAILABLE SF: 1,806 - 3,976 SF
LEASE RATE: \$26.00 SF/yr (NNN)
TOTAL BLDG SF: 5,004 SF

COMMENTS

Professional office with great floor plan available in downtown Issaquah. Easy access to I-90 makes commuting easy, while the amenities of Front Street and Gilman Village are nearby, providing many options for meals and shopping.

- Fully sprinklered building
- Secured storage in parking garage available
- New resurfaced/restriped parking lot



DEMOGRAPHICS

	1 MILE	3 MILES	5 MILES
Total Households	1,707	13,353	31,885
Total Population	3,787	32,219	85,046
Average HH Income	\$97,953	\$107,760	\$123,165

CONTACT

Aaron Mathieu

amathieu@lee-associates.com

D 206.210.5207

We obtained the information above from sources we believe to be reliable. However, we have not verified its accuracy and make no guarantee, warranty or representation about it. It is submitted subject to the possibility of errors, omissions, change of price, rental or other conditions, prior sale, lease or financing, or withdrawal without notice. We include projections, opinions, assumptions or estimates for example only, and they may not represent current or future performance of the property. You and your tax and legal advisors should conduct your own investigation of the property and transaction.

Office for Lease ISSAQUAH / GILMAN OFFICE

300 NE Gilman Blvd, Issaquah, WA 98027

**LEE &
ASSOCIATES**
COMMERCIAL REAL ESTATE SERVICES

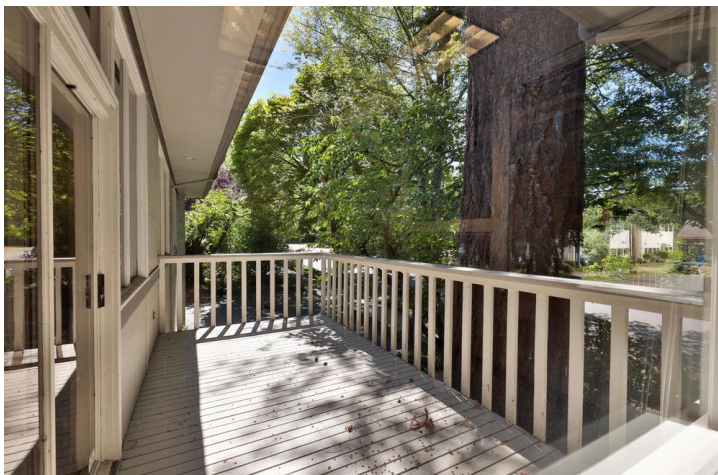

CONTACT

Aaron Mathieu

amathieu@lee-associates.com

D 206.210.5207

We obtained the information above from sources we believe to be reliable. However, we have not verified its accuracy and make no guarantee, warranty or representation about it. It is submitted subject to the possibility of errors, omissions, change of price, rental or other conditions, prior sale, lease or financing, or withdrawal without notice. We include projections, opinions, assumptions or estimates for example only, and they may not represent current or future performance of the property. You and your tax and legal advisors should conduct your own investigation of the property and transaction.

Office for Lease ISSAQUAH / GILMAN OFFICE

300 NE Gilman Blvd, Issaquah, WA 98027

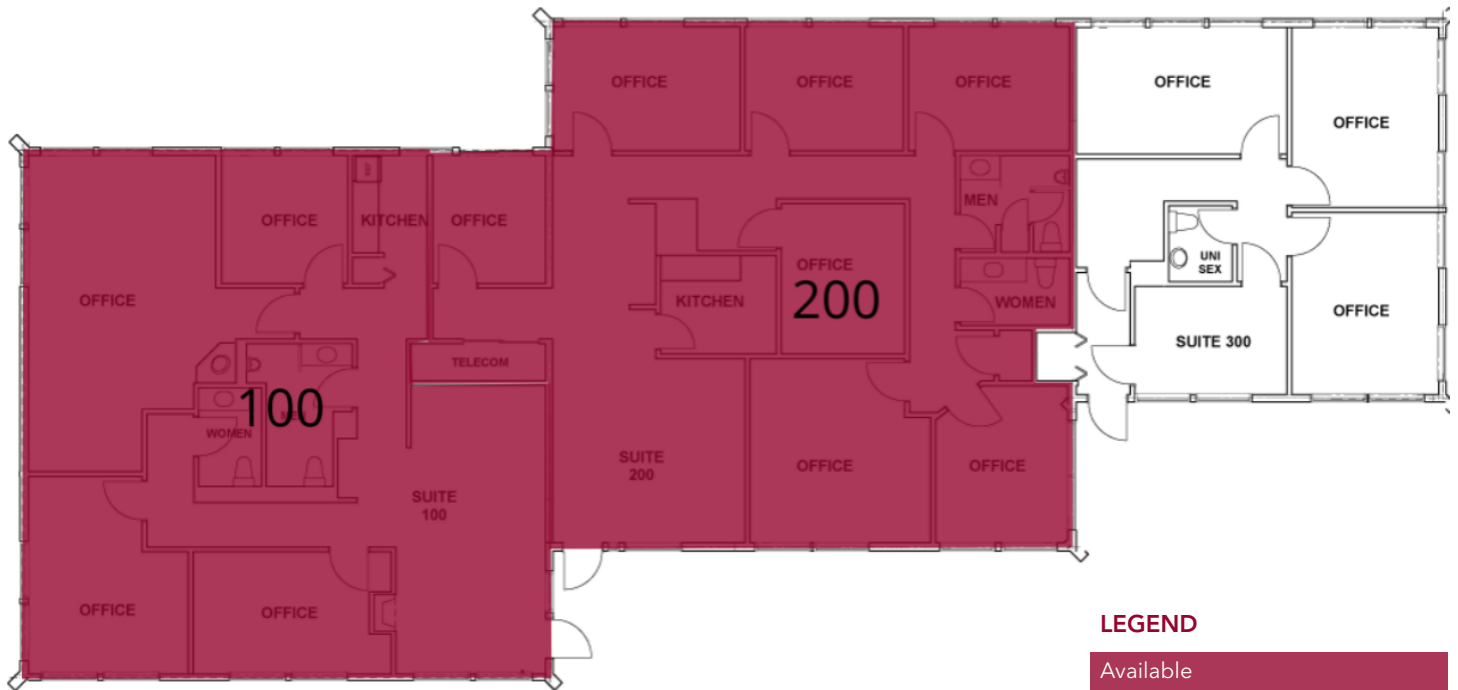

LEASE INFORMATION

Lease Type:	NNN	Lease Term:	Negotiable
Total Space:	1,806 - 3,976 SF	Lease Rate:	\$26.00 SF/yr

AVAILABLE SPACES

SUITE	TENANT	SIZE	TYPE	RATE
Suite 200	Available	2,170 - 3,976 SF	NNN	\$26.00 SF/yr
Suite 100	Available	1,806 SF	NNN	\$26.00 SF/yr

CONTACT

Aaron Mathieu

amathieu@lee-associates.com

D 206.210.5207

We obtained the information above from sources we believe to be reliable. However, we have not verified its accuracy and make no guarantee, warranty or representation about it. It is submitted subject to the possibility of errors, omissions, change of price, rental or other conditions, prior sale, lease or financing, or withdrawal without notice. We include projections, opinions, assumptions or estimates for example only, and they may not represent current or future performance of the property. You and your tax and legal advisors should conduct your own investigation of the property and transaction.

Office for Lease ISSAQUAH / GILMAN OFFICE

300 NE Gilman Blvd, Issaquah, WA 98027

LEE & ASSOCIATES
COMMERCIAL REAL ESTATE SERVICES



CONTACT

Aaron Mathieu

amathieu@lee-associates.com

D 206.210.5207

We obtained the information above from sources we believe to be reliable. However, we have not verified its accuracy and make no guarantee, warranty or representation about it. It is submitted subject to the possibility of errors, omissions, change of price, rental or other conditions, prior sale, lease or financing, or withdrawal without notice. We include projections, opinions, assumptions or estimates for example only, and they may not represent current or future performance of the property. You and your tax and legal advisors should conduct your own investigation of the property and transaction.