

**EAST 26TH STREET OFFICE BUILDING
4921 EAST 26TH STREET
SIOUX FALLS, SD**

Real Estate Services

Bender
COMMERCIAL

**FOR LEASE
OFFICE SPACE – EAST SIOUX FALLS**

We open doors.



PROPERTY FEATURES:

- **1,200 rentable sq. ft.**
- **\$11.00/sq. ft. NNN**
Estimated NNNs: \$6.35/sq. ft. (including utilities)
- Zoned O – Office.
- Beautiful professional office located in East Sioux Falls adjacent to Dawley Farm Village.
- Space has a reception area, three (3) private offices, open work areas, break area and conference room.
- Common area vestibule.
- Parking ratio of 5.5 spaces per 1,000 sq. ft.
- Monument signage available.
- East 26th Street has a daily traffic count of 14,300 vehicles.
- Professional office space perfect for insurance, finance, medical, attorney and other professional users.

For More Information, Please Contact:

REGGIE KUIPERS, SIOR
reggie@benderco.com
(605) 782-1663



EAST 26TH STREET OFFICE BUILDING
4921 EAST 26TH STREET
SIOUX FALLS, SD

Real Estate Services

Bender
COMMERCIAL

We open doors.



EAST 26TH STREET OFFICE BUILDING
4921 EAST 26TH STREET
SIOUX FALLS, SD

Real Estate Services

Bender
COMMERCIAL

We open doors.

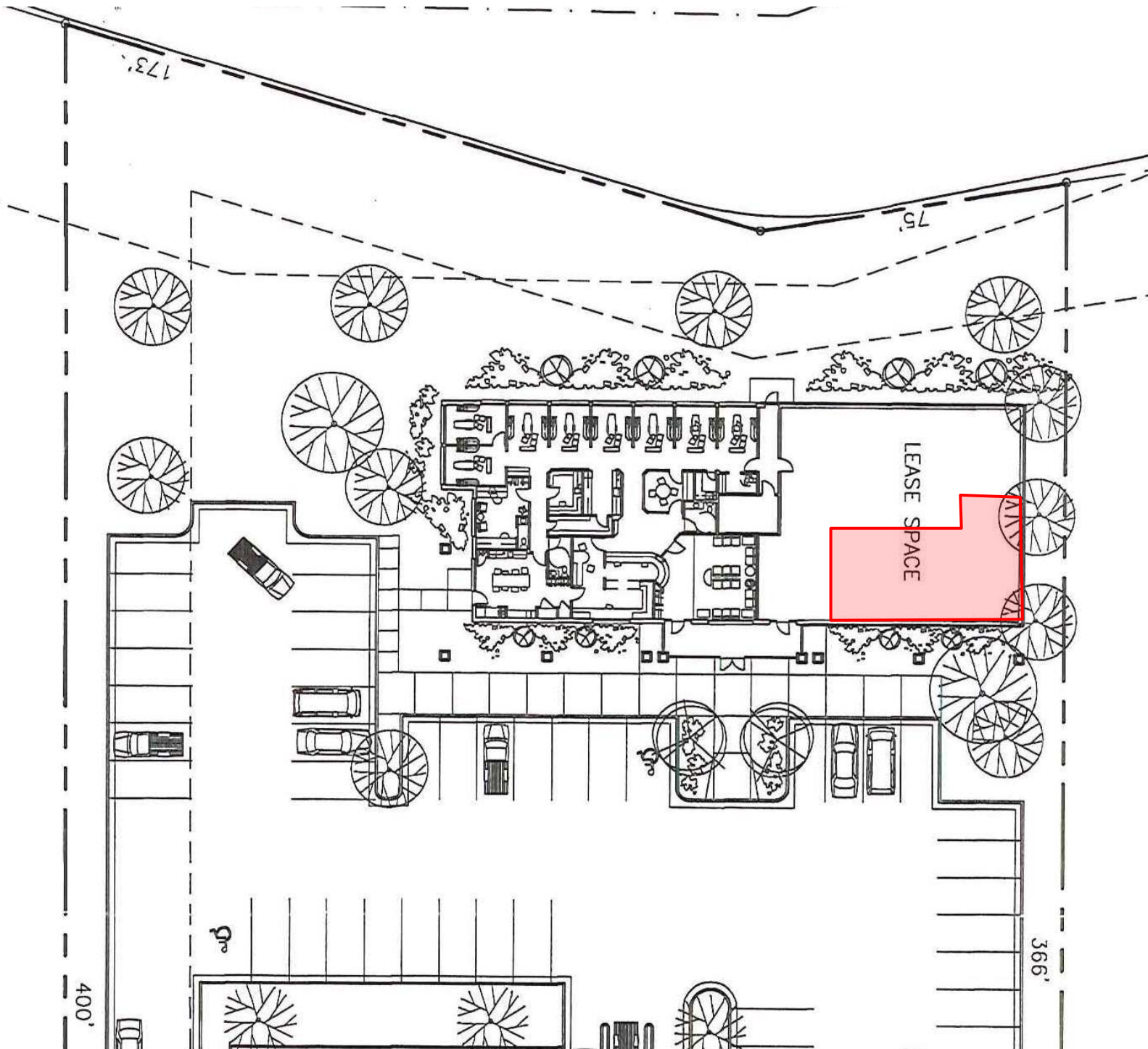

EAST 26TH STREET OFFICE BUILDING
4921 EAST 26TH STREET
SIOUX FALLS, SD

Real Estate Services

Bender
COMMERCIAL

We open doors.



EAST 26TH STREET OFFICE BUILDING 4921 EAST 26TH STREET SIOUX FALLS, SD

Real Estate Services

Bender

COMMERCIAL

We open doors.

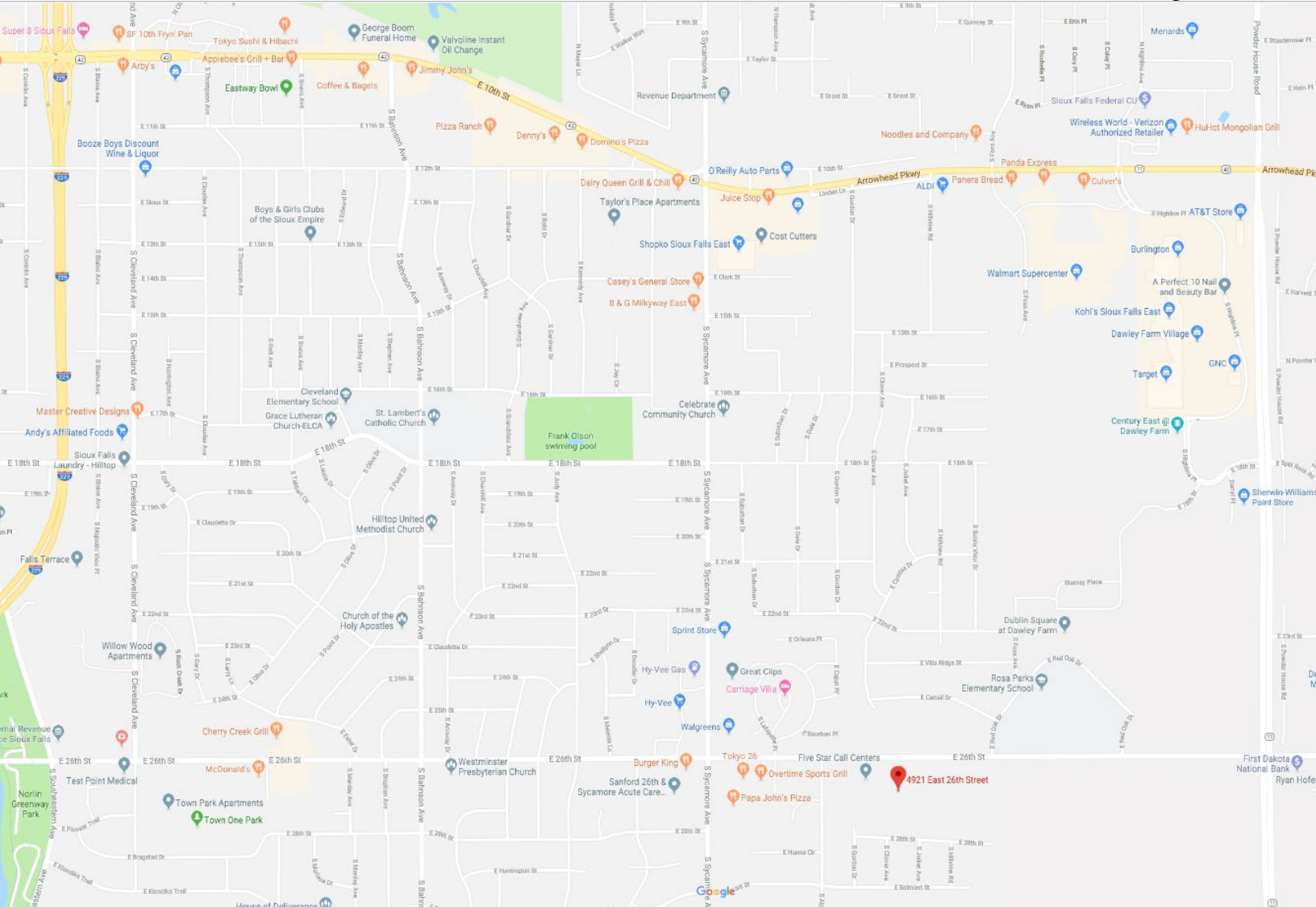

L-1898 122 South Phillips Avenue, Suite 350 • Sioux Falls, SD 57104 • (605) 336-7600 • www.benderco.com

© 2019 Bender Companies *Per Owner and/or County Assessor's Office. Lessee should verify independently. Information herein deemed reliable, but not guaranteed.