

**SHRIVER SQUARE**  
**230 SOUTH PHILLIPS AVENUE, SUITE 204**  
**SIOUX FALLS, SD**

Real Estate Services

**Bender**  
COMMERCIAL

**FOR LEASE**  
**DOWNTOWN OFFICE SPACE**

*We open doors.*



**PROPERTY FEATURES:**

- **1,459 rentable sq. ft.**
- **For Lease: \$1,850/month Gross**
- Office space located on the second floor of the Shriver Square Building.
- Prominent downtown office building located on the corner of 11<sup>th</sup> Street and Phillips Avenue.
- Beautiful, modern finish with two (2) private office, open work area and large storage space.
- Great downtown location near shopping, restaurants and parking.
- Shriver Square tenants include Cookie Jar, Pho Thai, Myers & Billion Law, Falls Real Estate, and Green Acre Real Estate.

*For More Information, Please Contact:*

**REGGIE KUIPERS, SIOR**  
reggie@benderco.com  
(605) 782-1663

**ALEX SOUNDY**  
alex@benderco.com  
(605) 681-8351





**SHRIVER SQUARE**  
**230 SOUTH PHILLIPS AVENUE, SUITE 204**  
**SIOUX FALLS, SD**

Real Estate Services

**Bender**  
 COMMERCIAL

*We open doors.*

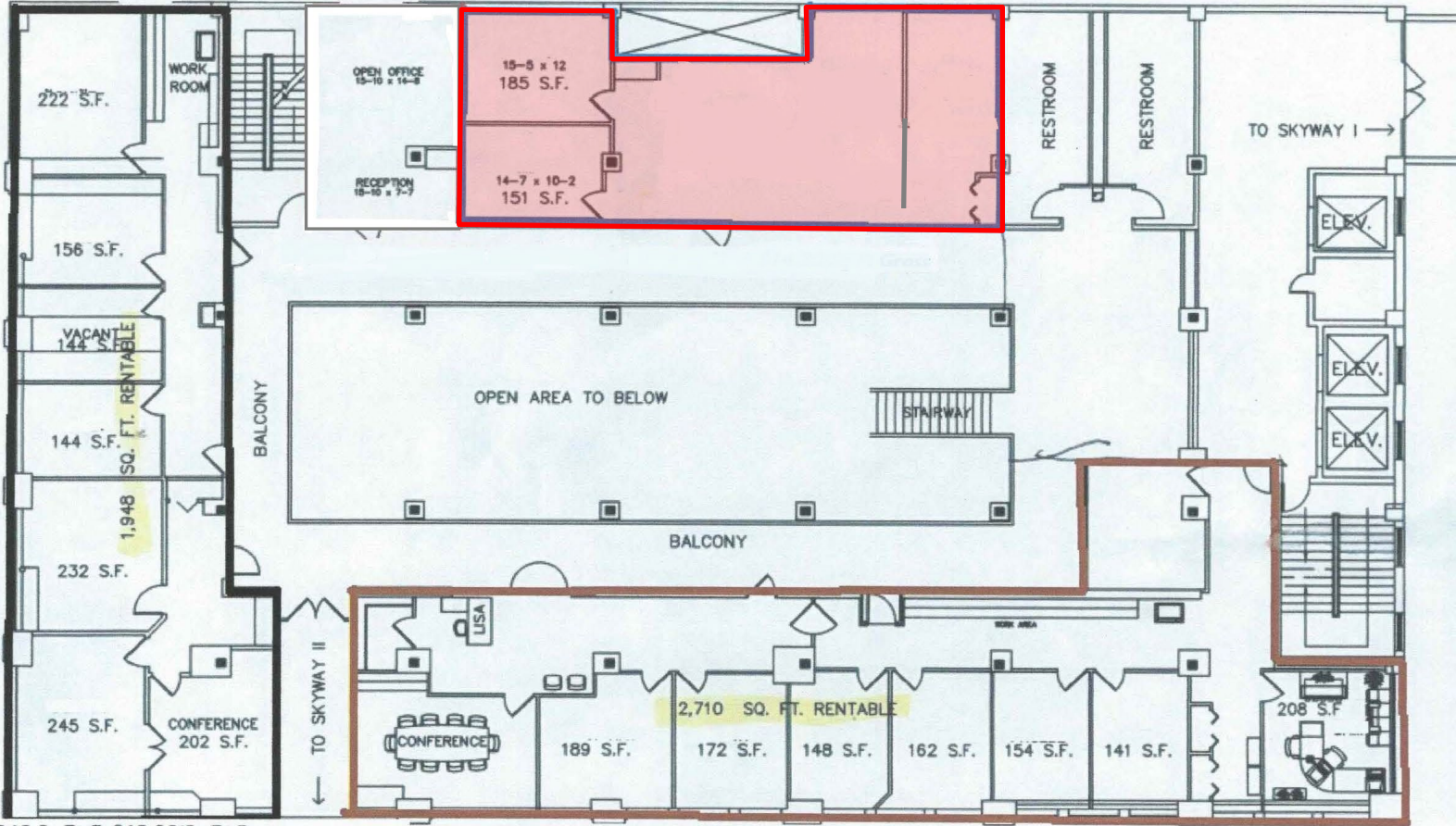

1,948 Sq Ft @ \$19.00/Sq Ft Gross

2,710 Sq Ft @ \$19.00/ Sq Ft Gross





**SHRIVER SQUARE  
230 SOUTH PHILLIPS AVENUE, SUITE 204  
SIOUX FALLS, SD**

Real Estate Services

**Bender**  
COMMERCIAL

*We open doors.*

