

## RETAIL FOR LEASE

# CROSSROADS AT MILL PLAIN & 164TH AVE

902 SE 164th Ave, Vancouver, WA 98683



### OFFERING SUMMARY

<b>NUMBER OF UNITS:</b>	2
<b>AVAILABLE SF:</b>	1,500 - 3,000 SF
<b>INTRODUCTORY LEASE RATE:</b>	\$20.00 SF/yr (NNN)
<b>LOT SIZE:</b>	18,731 SF
<b>BUILDING SIZE:</b>	6,616 SF
<b>ZONING:</b>	CC
<b>MARKET:</b>	East Vancouver

### PROPERTY OVERVIEW

Landlord is offering a first year introductory rate of \$20.00 SF/YR on qualified leases. Premises is adjacent to ZOOM+care & newly signed Nothing Bundt Cakes and Building is adjacent to 7-Eleven + fuel, Starbucks, WellHaven Pet Health, Modern Dentistry, nail salon and national insurance providers.

The Crossroads at Mill Plain & 164th Ave is located at a high-traffic, signalized intersection with access from 164th and Mill Plain.

### PROPERTY HIGHLIGHTS

- Open Floor Plan with 2 existing restrooms and storage/break room
- Neighbors include Regal Cinema, Crunch Fitness, Chipotle, Chik-fil-a, Olive Garden, Bank of America,
- Target, Whole Foods Market, Nautilus, CTC Campus
- High Traffic Counts and Signalized Intersection
- Strong Retail Location
- Signage Available on 3 Building Sides and 2 Monument Signs
- Shared Access & Parking

**KW COMMERCIAL**  
2211 E Mill Plain Blvd  
Vancouver, WA 98661

**TREVOR SOSKY**  
Managing Broker  
O: 360.816.9651  
C: 360.798.1413  
trevor@kwcommercial.com  
WA #25176

We obtained the information above from sources we believe to be reliable. However, we have not verified its accuracy and make no guarantee, warranty or representation about it. It is submitted subject to the possibility of errors, omissions, change of price, rental or other conditions, prior sale, lease or financing, or withdrawal without notice. We include projections, opinions, assumptions or estimates for example only, and they may not represent current or future performance of the property. You and your tax and legal advisors should conduct your own investigation of the property and transaction.

Each Office Independently Owned and Operated [kwcommercial.com](http://kwcommercial.com)

## RETAIL FOR LEASE

# CROSSROADS AT MILL PLAIN & 164TH AVE

902 SE 164th Ave, Vancouver, WA 98683



**KW COMMERCIAL**  
2211 E Mill Plain Blvd  
Vancouver, WA 98661

**TREVOR SOSKY**  
Managing Broker  
O: 360.816.9651  
C: 360.798.1413  
trevor@kwcommercial.com  
WA #25176

We obtained the information above from sources we believe to be reliable. However, we have not verified its accuracy and make no guarantee, warranty or representation about it. It is submitted subject to the possibility of errors, omissions, change of price, rental or other conditions, prior sale, lease or financing, or withdrawal without notice. We include projections, opinions, assumptions or estimates for example only, and they may not represent current or future performance of the property. You and your tax and legal advisors should conduct your own investigation of the property and transaction.

Each Office Independently Owned and Operated [kwcommercial.com](http://kwcommercial.com)

## RETAIL FOR LEASE

# CROSSROADS AT MILL PLAIN & 164TH AVE

902 SE 164th Ave, Vancouver, WA 98683



**KW COMMERCIAL**  
2211 E Mill Plain Blvd  
Vancouver, WA 98661

**TREVOR SOSKY**  
Managing Broker  
O: 360.816.9651  
C: 360.798.1413  
trevor@kwcommercial.com  
WA #25176

We obtained the information above from sources we believe to be reliable. However, we have not verified its accuracy and make no guarantee, warranty or representation about it. It is submitted subject to the possibility of errors, omissions, change of price, rental or other conditions, prior sale, lease or financing, or withdrawal without notice. We include projections, opinions, assumptions or estimates for example only, and they may not represent current or future performance of the property. You and your tax and legal advisors should conduct your own investigation of the property and transaction.

Each Office Independently Owned and Operated [kwcommercial.com](http://kwcommercial.com)

# RETAIL FOR LEASE

# CROSSROADS AT MILL PLAIN & 164TH AVE

902 SE 164th Ave, Vancouver, WA 98683

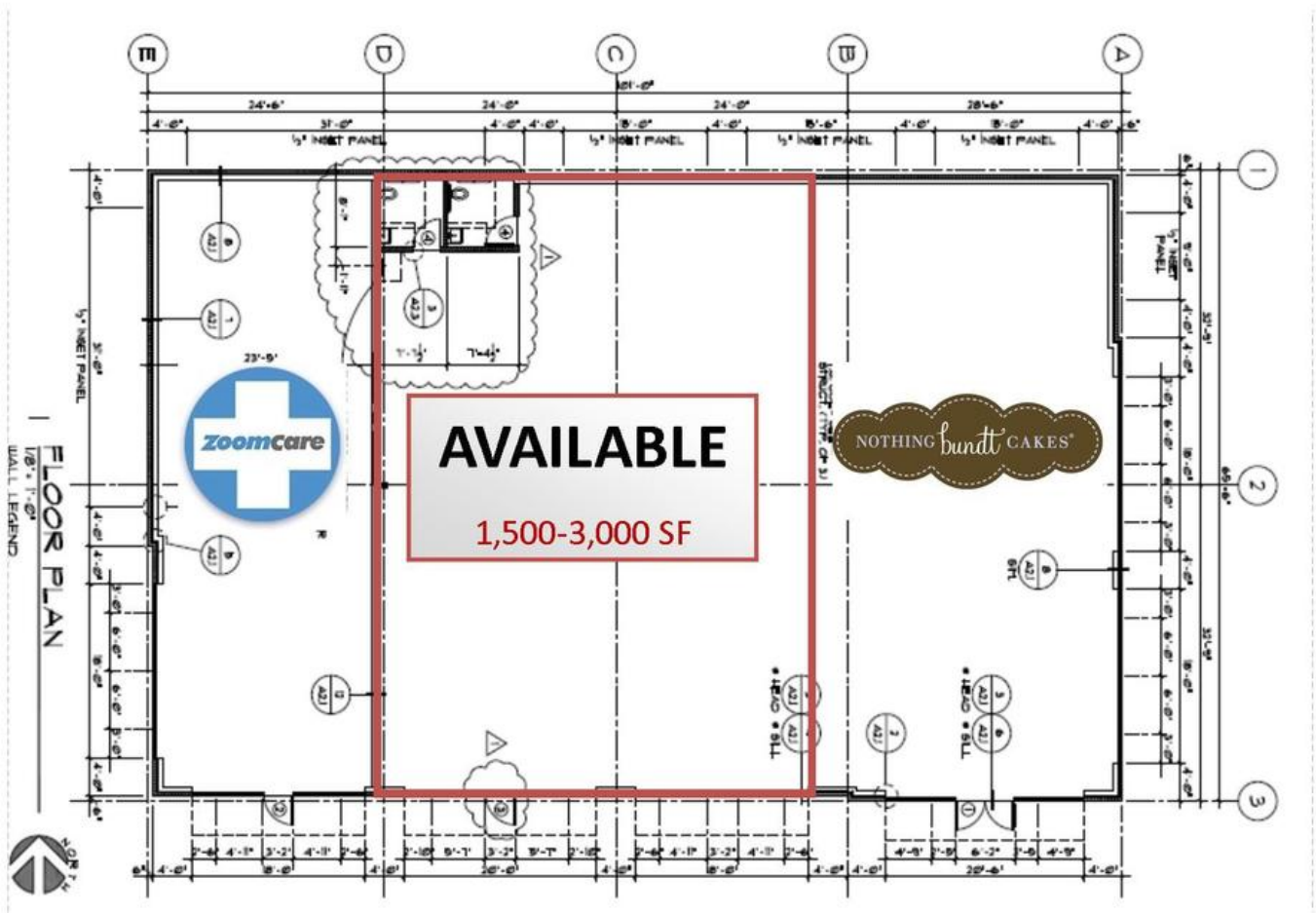

**KW COMMERCIAL**  
2211 E Mill Plain Blvd  
Vancouver, WA 98661

**TREVOR SOSKY**  
Managing Broker  
O: 360.816.9651  
C: 360.798.1413  
trevor@kwcommercial.com  
WA #25176

We obtained the information above from sources we believe to be reliable. However, we have not verified its accuracy and make no guarantee, warranty or representation about it. It is submitted subject to the possibility of errors, omissions, change of price, rental or other conditions, prior sale, lease or financing, or withdrawal without notice. We include projections, opinions, assumptions or estimates for example only, and they may not represent current or future performance of the property. You and your tax and legal advisors should conduct your own investigation of the property and transaction.

Each Office Independently Owned and Operated [kwcommercial.com](http://kwcommercial.com)

# CROSSROADS AT MILL PLAIN & 164TH AVE

902 SE 164th Ave, Vancouver, WA 98683



**KW COMMERCIAL**  
2211 E Mill Plain Blvd  
Vancouver, WA 98661

**TREVOR SOSKY**  
Managing Broker  
O: 360.816.9651  
C: 360.798.1413  
trevor@kwcommercial.com  
WA #25176

We obtained the information above from sources we believe to be reliable. However, we have not verified its accuracy and make no guarantee, warranty or representation about it. It is submitted subject to the possibility of errors, omissions, change of price, rental or other conditions, prior sale, lease or financing, or withdrawal without notice. We include projections, opinions, assumptions or estimates for example only, and they may not represent current or future performance of the property. You and your tax and legal advisors should conduct your own investigation of the property and transaction.

**RETAIL FOR LEASE**

# CROSSROADS AT MILL PLAIN & 164TH AVE

902 SE 164th Ave, Vancouver, WA 98683

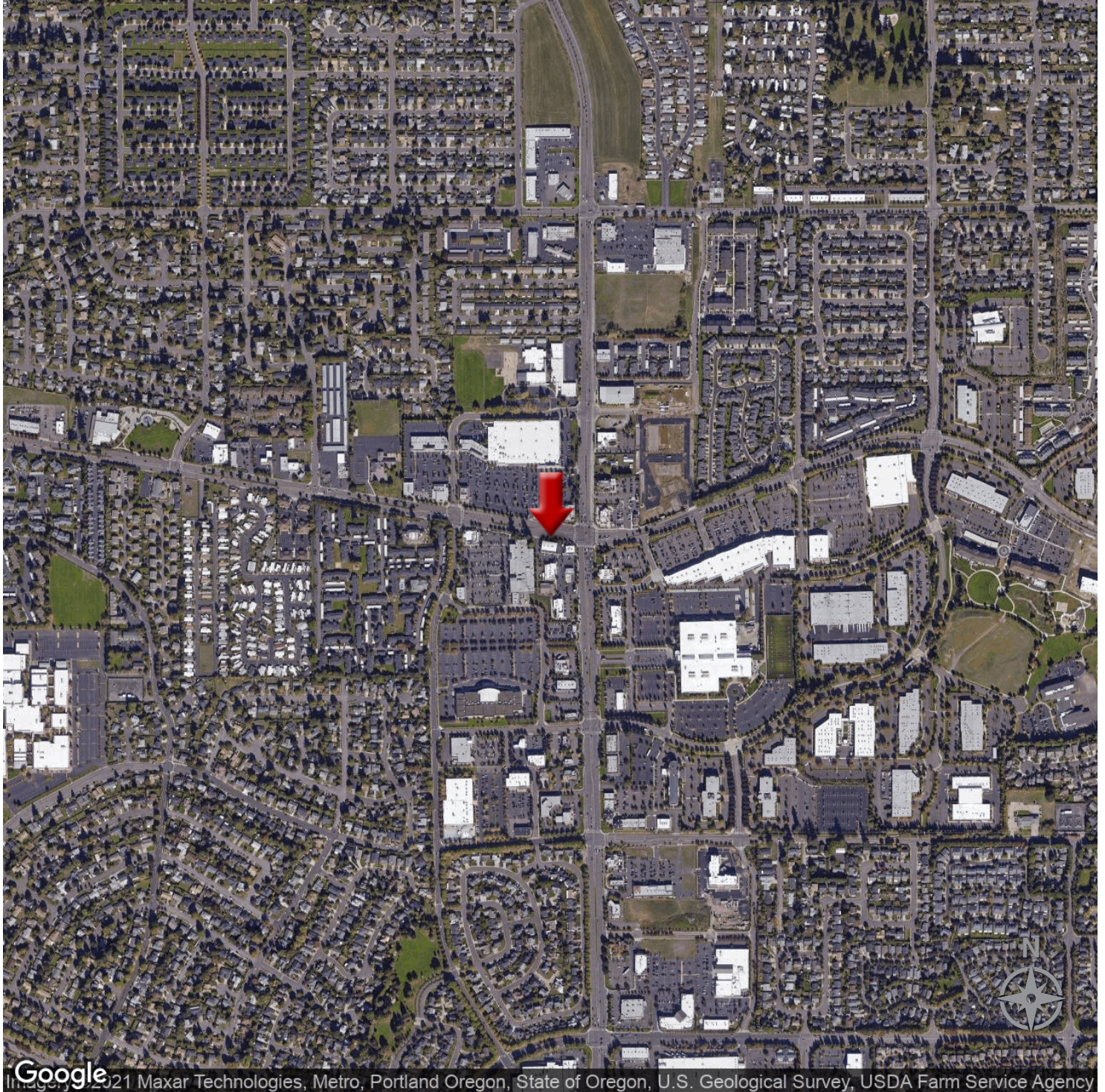

**KW COMMERCIAL**  
2211 E Mill Plain Blvd  
Vancouver, WA 98661

**TREVOR SOSKY**  
Managing Broker  
O: 360.816.9651  
C: 360.798.1413  
trevor@kwcommercial.com  
WA #25176

We obtained the information above from sources we believe to be reliable. However, we have not verified its accuracy and make no guarantee, warranty or representation about it. It is submitted subject to the possibility of errors, omissions, change of price, rental or other conditions, prior sale, lease or financing, or withdrawal without notice. We include projections, opinions, assumptions or estimates for example only, and they may not represent current or future performance of the property. You and your tax and legal advisors should conduct your own investigation of the property and transaction.

Each Office Independently Owned and Operated [kwcommercial.com](http://kwcommercial.com)

# CROSSROADS AT MILL PLAIN & 164TH AVE

902 SE 164th Ave, Vancouver, WA 98683



<b>POPULATION</b>	<b>1 MILE</b>	<b>2 MILES</b>	<b>3 MILES</b>
Total population	15,958	49,950	90,809
Median age	36.6	40.3	38.7
Median age (male)	35.3	38.7	37.2
Median age (Female)	37.5	41.4	40.1
<b>HOUSEHOLDS &amp; INCOME</b>	<b>1 MILE</b>	<b>2 MILES</b>	<b>3 MILES</b>
Total households	6,294	19,193	34,204
# of persons per HH	2.5	2.6	2.7
Average HH income	\$61,364	\$68,310	\$71,910
Average house value	\$250,479	\$289,775	\$297,489

*\* Demographic data derived from 2010 US Census*

**KW COMMERCIAL**  
2211 E Mill Plain Blvd  
Vancouver, WA 98661

**TREVOR SOSKY**  
Managing Broker  
O: 360.816.9651  
C: 360.798.1413  
trevor@kwcommercial.com  
WA #25176

We obtained the information above from sources we believe to be reliable. However, we have not verified its accuracy and make no guarantee, warranty or representation about it. It is submitted subject to the possibility of errors, omissions, change of price, rental or other conditions, prior sale, lease or financing, or withdrawal without notice. We include projections, opinions, assumptions or estimates for example only, and they may not represent current or future performance of the property. You and your tax and legal advisors should conduct your own investigation of the property and transaction.