

FOR SALE

**126 Waterbury Road
A/K/A Rte 69
Prospect, CT**



- **Approved Commercial Building Lot Consisting of 2.82 Acres**
- **Zone “B” - Business**
- **Currently Designed for a 15,600 S/F Building with Parking for 69 Vehicles**
- **Town Water on Street**
- **Eversource Electric and Gas on Street**
- **Traffic Count of 10,200 Vehicles Per Day!**
- **Aggressively Price at \$375,000.00**



MATTHEWS COMMERCIAL PROPERTIES LLC.

**819 Straits Turnpike Suite 3B, Middlebury, CT 06762
Phone: 203-753-5800 Fax: 203-574-3875
www.matthewscommercial.com**

**CONTACT: Gerry Matthews 203-753-5800
Email: gdmattews@snet.net**

All information furnished is from sources deemed reliable and is submitted subject to errors, omissions, change of other terms of conditions, prior sale, lease or financing or withdrawal—all without notice. No representation is made or implied by Matthews Commercial Properties or its associates as to the accuracy of the information submitted herein.

126 WATERBURY RD. PROSPECT

2.82 ACRES
APPROVED FOR 15,800 SF
ZONED BUSINESS

Legend

- 126 WATERBURY RD. PROSPECT, CT
- Prospect Family Medicine
- Prospect Golf
- Triple Stitch Sportswear

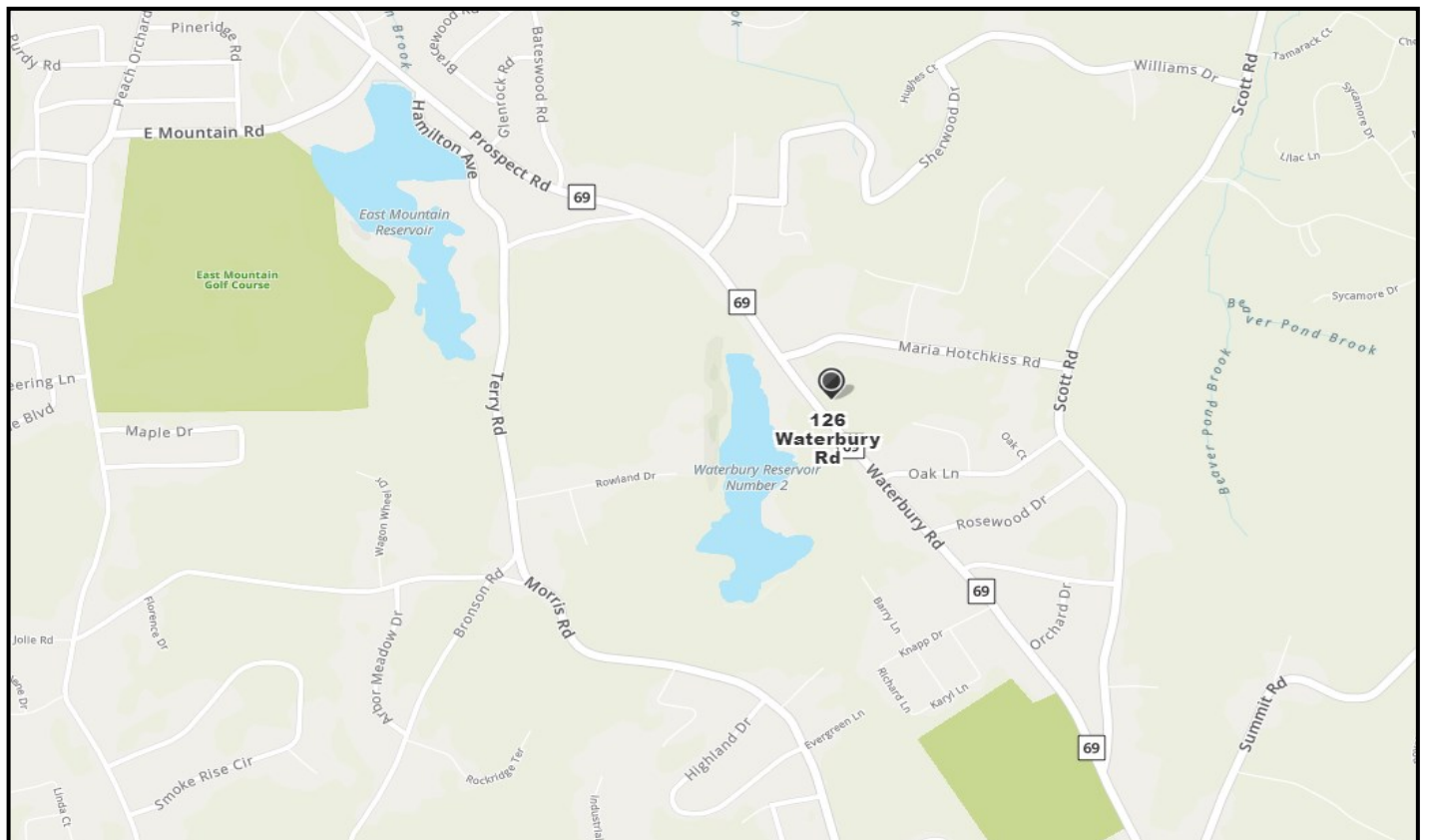

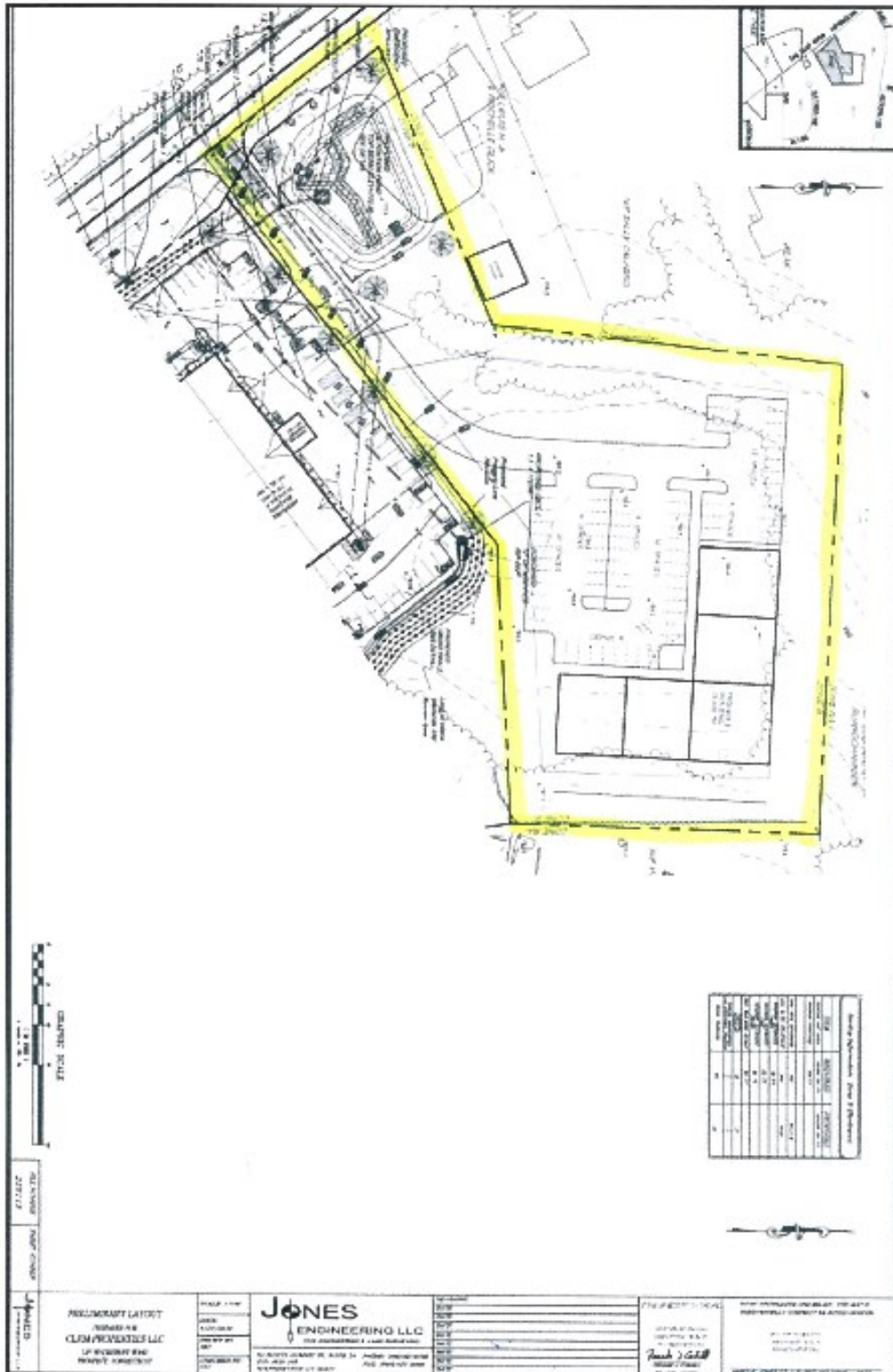

PRELIMINARY LAYOUT
 ISSUED BY
 CLM/PROVEDS LLC
 UP FRONT AND
 READY CONSTRUCTION

JONES
 ENGINEERING LLC
 1000 UNIVERSITY AVENUE, SUITE 100
 ANN ARBOR, MI 48106
 TEL: 734.769.1234
 FAX: 734.769.1235
 WWW.JONES-ENGINEERING.COM

DATE: 10/15/2014
 DRAWN BY: J. JONES
 CHECKED BY: J. JONES
 PROJECT NO.: 14-001
 SHEET NO.: 1 OF 1

