

# BIRCH LAKE PROFESSIONAL BUILDING

1310 Hwy 96, White Bear Lake, MN 55110



## OFFERING SUMMARY

<b>AVAILABLE SF:</b>	634 SF
<b>LEASE RATE:</b>	\$18.00 SF/yr (Gross)
<b>LOT SIZE:</b>	2.13 Acres
<b>BUILDING SIZE:</b>	30,000 SF
<b>TRAFFIC COUNT:</b>	22,100

## PROPERTY OVERVIEW

Birch Lake Professional Building is highly visible along Hwy 96, which sees over 22,000 vehicle per day, offering excellent exposure and convenience to passing traffic. Large surface parking lot for clients and workforce.

Convenient to I-35E and Hwy 61 on Hwy 96. Approximately two miles west of downtown White Bear Lake.

## PROPERTY HIGHLIGHTS

- Easy and quick access to I-35E and Hwy 61
- Ample parking
- Elevator
- Area amenities: Lifetime Fitness Campus, White Bear Lake Sports Center, Cub Foods, LifeSpa, Caribou Coffee, Anytime Fitness, US Post Office, Kowalski's Market, Carbone's Pizzeria & Pub, Punch Pizza, Acqua Restaurant, Culver's, Applebee's, Burger King, Jimmy John's, and Walgreens

**KW COMMERCIAL**  
14665 Galaxie Avenue, Suite 350  
Apple Valley, MN 55124

**DAVID LUND**  
Senior Associate  
O: 651.354.5637  
david@amkprop.com

**ANDY MANTHEI**  
Senior Director Brokerage Services  
O: 651.262.1006  
C: 651.331.9136  
andy@amkprop.com

**KEITH SCOTT**  
Senior Associate  
O: 763.807.9840  
keithscott@kwcommercial.com

We obtained the information above from sources we believe to be reliable. However, we have not verified its accuracy and make no guarantee, warranty or representation about it. It is submitted subject to the possibility of errors, omissions, change of price, rental or other conditions, prior sale, lease or financing, or withdrawal without notice. We include projections, opinions, assumptions or estimates for example only, and they may not represent current or future performance of the property. You and your tax and legal advisors should conduct your own investigation of the property and transaction.

## OFFICE FOR LEASE

# BIRCH LAKE PROFESSIONAL BUILDING

1310 Hwy 96, White Bear Lake, MN 55110



### AVAILABLE SPACES

SUITE	TENANT	SIZE (SF)	LEASE TYPE	LEASE RATE
Suite 103	Available	634 SF	Gross	\$18.00 SF/yr

**KW COMMERCIAL**  
14665 Galaxie Avenue, Suite 350  
Apple Valley, MN 55124

**DAVID LUND**  
Senior Associate  
O: 651.354.5637  
david@amkprop.com

**ANDY MANTHEI**  
Senior Director Brokerage Services  
O: 651.262.1006  
C: 651.331.9136  
andy@amkprop.com

**KEITH SCOTT**  
Senior Associate  
O: 763.807.9840  
keithscott@kwcommercial.com

We obtained the information above from sources we believe to be reliable. However, we have not verified its accuracy and make no guarantee, warranty or representation about it. It is submitted subject to the possibility of errors, omissions, change of price, rental or other conditions, prior sale, lease or financing, or withdrawal without notice. We include projections, opinions, assumptions or estimates for example only, and they may not represent current or future performance of the property. You and your tax and legal advisors should conduct your own investigation of the property and transaction.

Each Office Independently Owned and Operated [kwmidwest.com/](http://kwmidwest.com/)

**OFFICE FOR LEASE**

# BIRCH LAKE PROFESSIONAL BUILDING

1310 Hwy 96, White Bear Lake, MN 55110

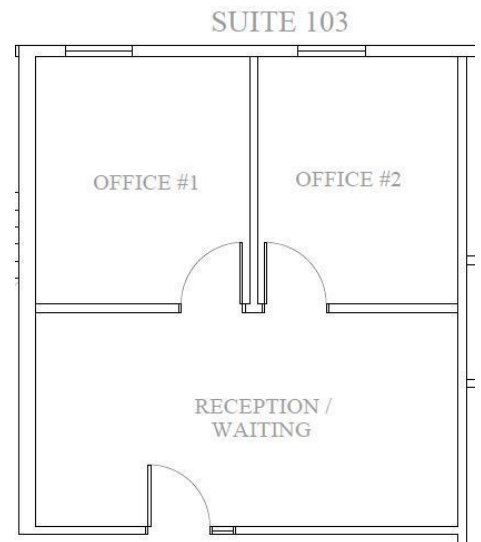

Suite 103: 634 SF

**KW COMMERCIAL**  
14665 Galaxie Avenue, Suite 350  
Apple Valley, MN 55124

**DAVID LUND**  
Senior Associate  
O: 651.354.5637  
david@amkprop.com

**ANDY MANTHEI**  
Senior Director Brokerage Services  
O: 651.262.1006  
C: 651.331.9136  
andy@amkprop.com

**KEITH SCOTT**  
Senior Associate  
O: 763.807.9840  
keithscott@kwcommercial.com

We obtained the information above from sources we believe to be reliable. However, we have not verified its accuracy and make no guarantee, warranty or representation about it. It is submitted subject to the possibility of errors, omissions, change of price, rental or other conditions, prior sale, lease or financing, or withdrawal without notice. We include projections, opinions, assumptions or estimates for example only, and they may not represent current or future performance of the property. You and your tax and legal advisors should conduct your own investigation of the property and transaction.

Each Office Independently Owned and Operated [kwcmidwest.com/](http://kwcmidwest.com/)

# BIRCH LAKE PROFESSIONAL BUILDING

1310 Hwy 96, White Bear Lake, MN 55110

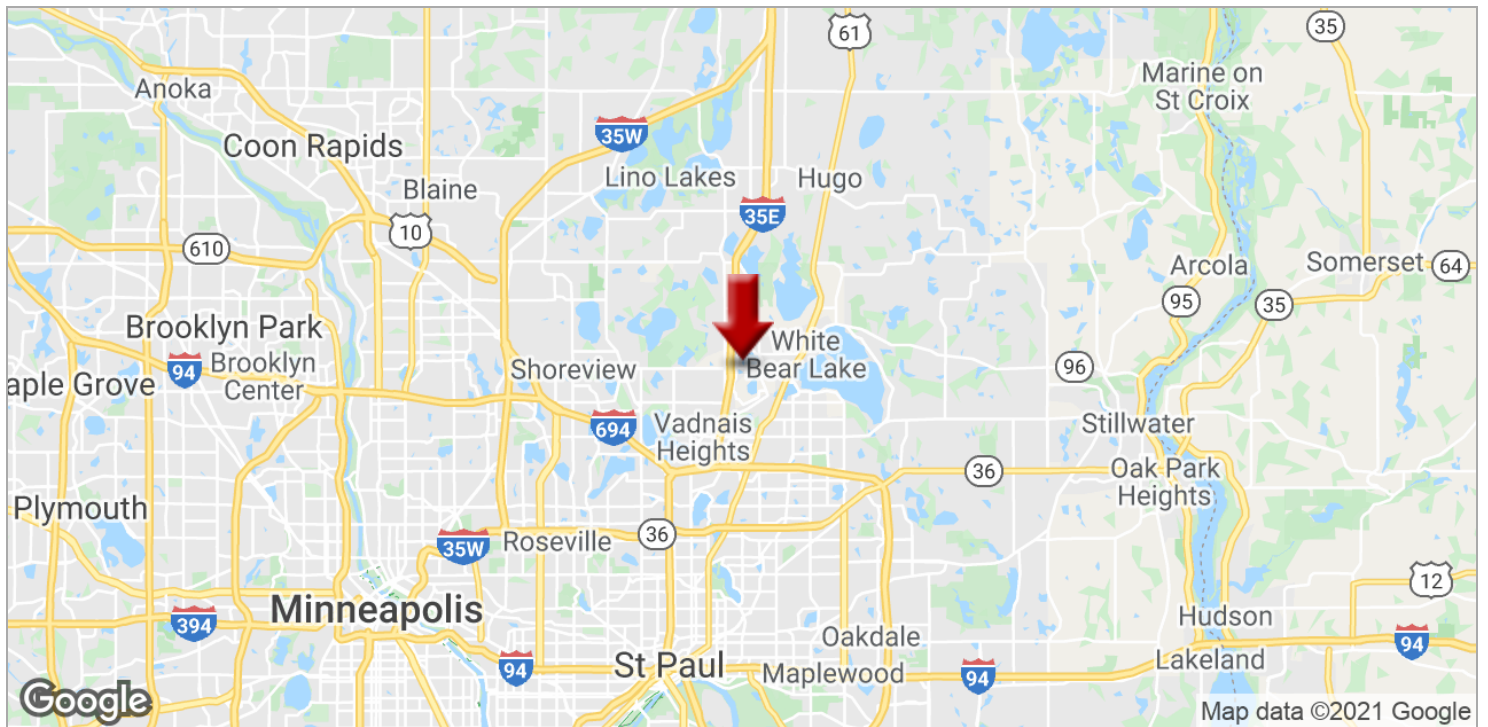

**KW COMMERCIAL**  
14665 Galaxie Avenue, Suite 350  
Apple Valley, MN 55124

**DAVID LUND**  
Senior Associate  
O: 651.354.5637  
david@amkprop.com

**ANDY MANTHEI**  
Senior Director Brokerage Services  
O: 651.262.1006  
C: 651.331.9136  
andy@amkprop.com

**KEITH SCOTT**  
Senior Associate  
O: 763.807.9840  
keithscott@kwcommercial.com

We obtained the information above from sources we believe to be reliable. However, we have not verified its accuracy and make no guarantee, warranty or representation about it. It is submitted subject to the possibility of errors, omissions, change of price, rental or other conditions, prior sale, lease or financing, or withdrawal without notice. We include projections, opinions, assumptions or estimates for example only, and they may not represent current or future performance of the property. You and your tax and legal advisors should conduct your own investigation of the property and transaction.

# BIRCH LAKE PROFESSIONAL BUILDING

1310 Hwy 96, White Bear Lake, MN 55110

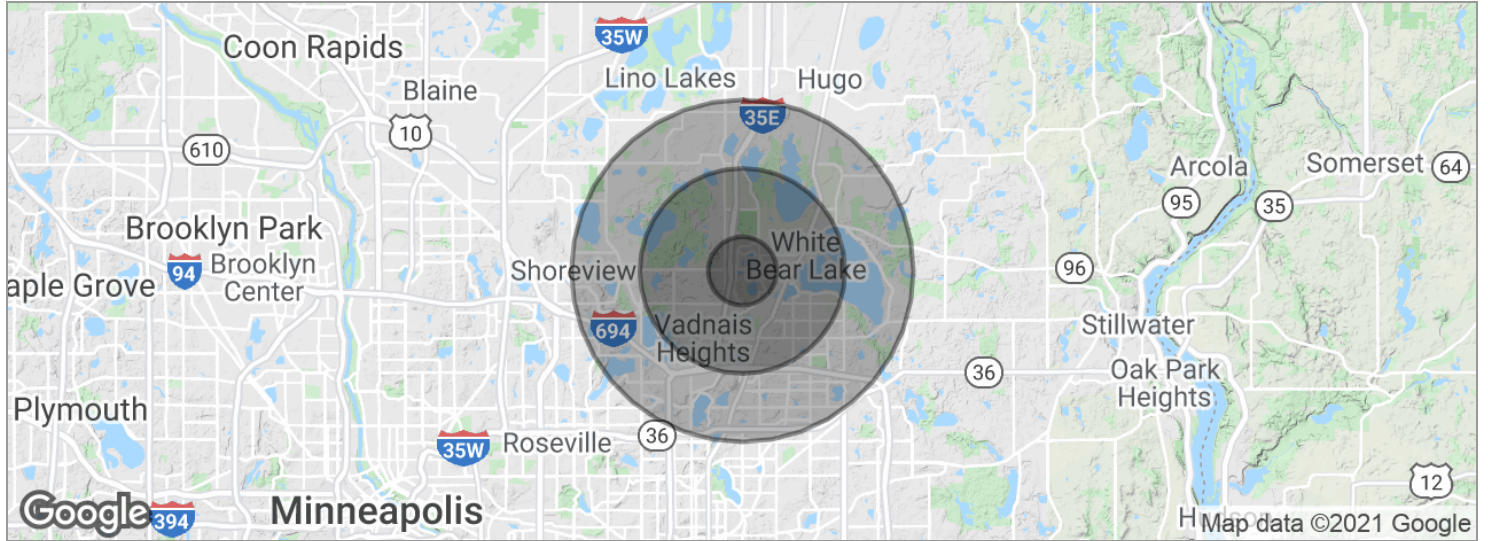

<b>POPULATION</b>	<b>1 MILE</b>	<b>3 MILES</b>	<b>5 MILES</b>
Total population	5,534	41,911	107,899
Median age	39.0	41.2	41.2
Median age (male)	35.0	38.0	39.0
Median age (Female)	42.0	43.7	43.1
<b>HOUSEHOLDS &amp; INCOME</b>	<b>1 MILE</b>	<b>3 MILES</b>	<b>5 MILES</b>
Total households	2,396	17,460	44,310
# of persons per HH	2.3	2.4	2.4
Average HH income	\$77,445	\$87,514	\$88,272
Average house value	\$294,029	\$313,603	\$318,167

*\* Demographic data derived from 2010 US Census*

**KW COMMERCIAL**  
14665 Galaxie Avenue, Suite 350  
Apple Valley, MN 55124

**DAVID LUND**  
Senior Associate  
O: 651.354.5637  
david@amkprop.com

**ANDY MANTHEI**  
Senior Director Brokerage Services  
O: 651.262.1006  
C: 651.331.9136  
andy@amkprop.com

**KEITH SCOTT**  
Senior Associate  
O: 763.807.9840  
keithscott@kwcommercial.com

We obtained the information above from sources we believe to be reliable. However, we have not verified its accuracy and make no guarantee, warranty or representation about it. It is submitted subject to the possibility of errors, omissions, change of price, rental or other conditions, prior sale, lease or financing, or withdrawal without notice. We include projections, opinions, assumptions or estimates for example only, and they may not represent current or future performance of the property. You and your tax and legal advisors should conduct your own investigation of the property and transaction.