

Downtown
Office
FOR LEASE



Low cost office
in heart of
downtown

911 Massachusetts St.

Lawrence
Kansas



Property Description

- Prime location at 9th and Massachusetts St. (Equivalent to Main Street)
- Excellent space for office, studio, group classes
- In heart of historic downtown, near one of the busiest corners.
 - National retailer presence
 - Specialty local shops
 - Top tier restaurants
- Convenient parking with alley access and 500+ city garage nearby.



Weaver's



MERCHANTS
[Pub & More]

715

FedEx

URBAN
OUTFITTERS



Property Highlights

- Unit size: Various
- Accessible restrooms
- Zoning: Commercial Downtown
- Year Built: 1966, renovated 1994
- Lease Type: Full Service
- Lease Rate: \$7-\$8 / foot

AGENT:
EVAN HOLT
(785)640-8923
Lawrence KS
Evan.Holt@kw.com

Download The App



BROKERAGE:
Keller Williams Commercial
545 Columbia Dr,
Lawrence KS 66049
www.KWCommercial.com

Downtown
Office
FOR LEASE



Basement
Offices

911 Massachusetts St.

Lawrence
Kansas



Entryway

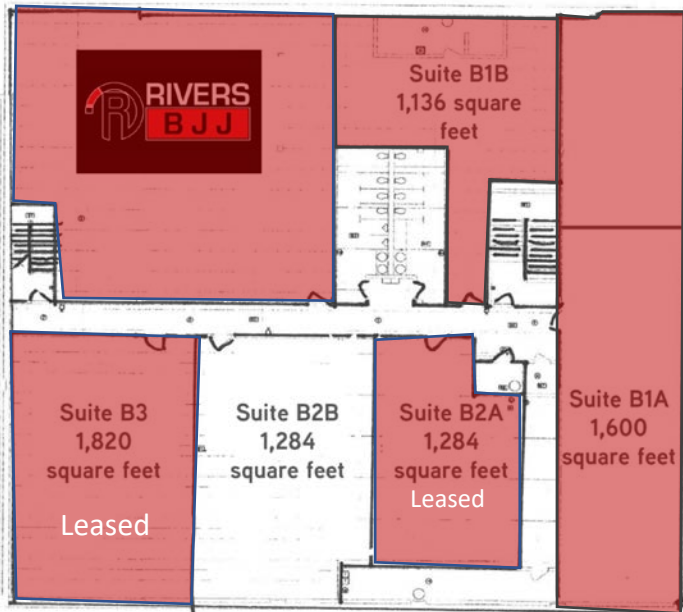

Elevator & Hallway

B2B
Available
@ 1,284 feet
\$900 monthly

Material intended for marketing purposes only. While KW Commercial Integrity makes every effort to ensure accuracy, the figures and drawing are only rough estimations and need to be verified by tenant

KW Commercial Integrity
545 Columbia Dr.
Lawrence KS, 66049