

## RETAIL AND OFFICE FOR LEASE

# VALLEY PUBLIC HOUSE

12960 SE 162nd, Happy Valley, OR 97086



### OFFERING SUMMARY

|                       |   |
|-----------------------|---|
| <b>AVAILABLE SF:</b>  | 2,284 - 3,173 SF  |
| <b>LEASE RATE:</b>    | Lower Level:<br>\$26 SF/yr (NNN)<br>Ground Level:<br>\$32 SF/yr (NNN) |
| <b>BUILDING SIZE:</b> | 18,945 SF   |
| <b>ZONING:</b>        | (MUC) Mixed Use<br>Commercial   |
| <b>MARKET:</b>        | Happy Valley  |

### PROPERTY OVERVIEW

Primary retail, medical, and office space available. Happy Valley Town Center is right across the street with other retail hubs in close proximity. This beautiful new building benefits from a combination of rapid growth, an affluent local population with thousands of new nearby homes permitted to begin construction soon. Over the next five years the population density is expected to increase by 10% with construction to begin soon, making this an excellent location for a business.

Two lease spaces are available. The ground level space is 2,284 SF and the daylight basement lease space is 3,173 SF. Both spaces can be subdivided. This is the perfect location for a flower shop, medical office, pet store, grocery store, bakery, quick stop grocery store, or butcher shop.

### PROPERTY HIGHLIGHTS

- Brand new development with pre-leased restaurants, apartment building, and other medical and retail businesses
- Directly across the street from City Hall and Happy Valley Town Center
- 34 Apartment Units on the premises
- Pre-leased restaurants include: Whiskey Lounge, Valley Growlers, Ranch PDX, and Tamale Boy.
- Abundant off street parking

**kw** PORTLAND  
PREMIERE  
KELLERWILLIAMS, REALTY  
16365 Boones Ferry Rd, Lake Oswego, OR 97035  
Each Office Independently Owned and Operated

**DENISE BROHOSKI**  
Oregon And Washington Licensed Broker  
O: 503.309.5106  
Denise@CommercialRENW.com

**MICK GRIEP**  
Associate Broker  
O: 503.502.9676  
Mick@CommercialRENW.com

We obtained the information above from sources we believe to be reliable. However, we have not verified its accuracy and make no guarantee, warranty or representation about it. It is submitted subject to the possibility of errors, omissions, change of price, rental or other conditions, prior sale, lease or financing, or withdrawal without notice. We include projections, opinions, assumptions or estimates for example only, and they may not represent current or future performance of the property. You and your tax and legal advisors should conduct your own investigation of the property and transaction.

## RETAIL FOR LEASE

# EXTERIOR PHOTOS

12960 SE 162nd, Happy Valley, OR 97086



**kw** PORTLAND  
PREMIERE  
KELLERWILLIAMS, REALTY  
16365 Boones Ferry Rd, Lake Oswego, OR 97035  
Each Office Independently Owned and Operated

**DENISE BROHOSKI**  
Oregon And Washington Licensed Broker  
O: 503.309.5106  
Denise@CommercialRENW.com

**MICK GRIEP**  
Associate Broker  
O: 503.502.9676  
Mick@CommercialRENW.com

We obtained the information above from sources we believe to be reliable. However, we have not verified its accuracy and make no guarantee, warranty or representation about it. It is submitted subject to the possibility of errors, omissions, change of price, rental or other conditions, prior sale, lease or financing, or withdrawal without notice. We include projections, opinions, assumptions or estimates for example only, and they may not represent current or future performance of the property. You and your tax and legal advisors should conduct your own investigation of the property and transaction.

[kwcommercial.com](http://kwcommercial.com)

**RETAIL FOR LEASE**

# AERIAL VIEW

12960 SE 162nd, Happy Valley, OR 97086



**kw** PORTLAND  
PREMIERE  
KELLERWILLIAMS, REALTY  
16365 Boones Ferry Rd, Lake Oswego, OR 97035  
Each Office Independently Owned and Operated

**DENISE BROHOSKI**  
Oregon And Washington Licensed Broker  
O: 503.309.5106  
Denise@CommercialRENW.com

**MICK GRIEP**  
Associate Broker  
O: 503.502.9676  
Mick@CommercialRENW.com

We obtained the information above from sources we believe to be reliable. However, we have not verified its accuracy and make no guarantee, warranty or representation about it. It is submitted subject to the possibility of errors, omissions, change of price, rental or other conditions, prior sale, lease or financing, or withdrawal without notice. We include projections, opinions, assumptions or estimates for example only, and they may not represent current or future performance of the property. You and your tax and legal advisors should conduct your own investigation of the property and transaction.

[kwcommercial.com](http://kwcommercial.com)

# FLOOR PLANS

12960 SE 162nd, Happy Valley, OR 97086

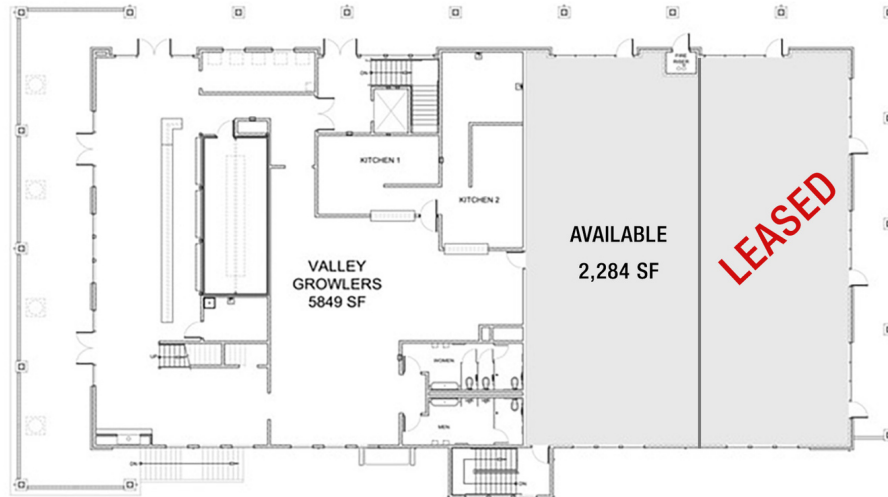

**GROUND FLOOR**



**LOWER FLOOR**

**kw** PORTLAND PREMIERE  
KELLERWILLIAMS, REALTY  
16365 Boones Ferry Rd, Lake Oswego, OR 97035  
Each Office Independently Owned and Operated

**DENISE BROHOSKI**  
Oregon And Washington Licensed Broker  
O: 503.309.5106  
Denise@CommercialRENW.com

**MICK GRIEP**  
Associate Broker  
O: 503.502.9676  
Mick@CommercialRENW.com

We obtained the information above from sources we believe to be reliable. However, we have not verified its accuracy and make no guarantee, warranty or representation about it. It is submitted subject to the possibility of errors, omissions, change of price, rental or other conditions, prior sale, lease or financing, or withdrawal without notice. We include projections, opinions, assumptions or estimates for example only, and they may not represent current or future performance of the property. You and your tax and legal advisors should conduct your own investigation of the property and transaction.

# AREA MAPS

12960 SE 162nd, Happy Valley, OR 97086



**KW** PORTLAND PREMIERE  
KELLERWILLIAMS, REALTY  
16365 Boones Ferry Rd, Lake Oswego, OR 97035  
Each Office Independently Owned and Operated

**DENISE BROHOSKI**  
Oregon And Washington Licensed Broker  
O: 503.309.5106  
Denise@CommercialRENW.com

**MICK GRIEP**  
Associate Broker  
O: 503.502.9676  
Mick@CommercialRENW.com

We obtained the information above from sources we believe to be reliable. However, we have not verified its accuracy and make no guarantee, warranty or representation about it. It is submitted subject to the possibility of errors, omissions, change of price, rental or other conditions, prior sale, lease or financing, or withdrawal without notice. We include projections, opinions, assumptions or estimates for example only, and they may not represent current or future performance of the property. You and your tax and legal advisors should conduct your own investigation of the property and transaction.

# DEMOGRAPHICS

12960 SE 162nd, Happy Valley, OR 97086

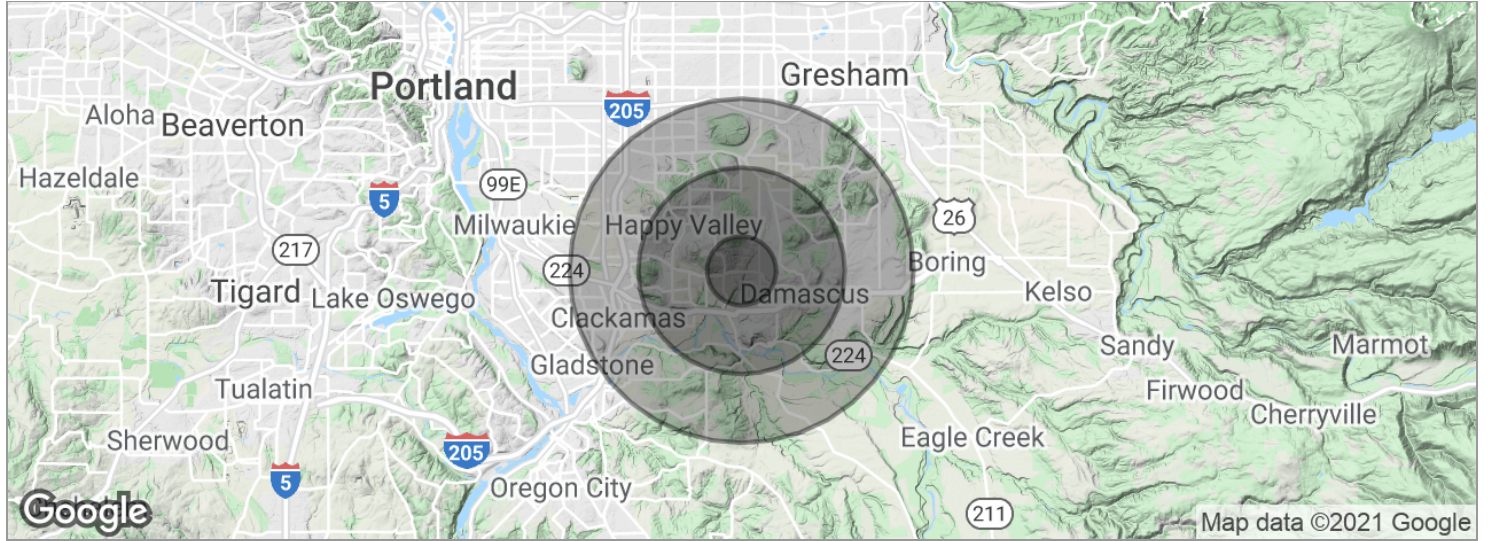

| <b>POPULATION</b>              | <b>1 MILE</b> | <b>3 MILES</b> | <b>5 MILES</b> |
|--------------------------------|---------------|----------------|----------------|
| Total population               | 4,951         | 39,098         | 119,335        |
| Median age                     | 35.7          | 37.8           | 37.3           |
| Median age (male)              | 33.4          | 37.1           | 37.1           |
| Median age (Female)            | 36.4          | 38.0           | 37.0           |
| <b>HOUSEHOLDS &amp; INCOME</b> | <b>1 MILE</b> | <b>3 MILES</b> | <b>5 MILES</b> |
| Total households               | 1,636         | 13,170         | 41,865         |
| # of persons per HH            | 3.0           | 3.0            | 2.9            |
| Average HH income              | \$84,318      | \$94,137       | \$80,810       |
| Average house value            | \$359,692     | \$423,457      | \$425,016      |

*\* Demographic data derived from 2010 US Census*

**kw** PORTLAND PREMIERE  
**KELLERWILLIAMS, REALTY**  
 16365 Boones Ferry Rd, Lake Oswego, OR 97035  
 Each Office Independently Owned and Operated

**DENISE BROHOSKI**  
 Oregon And Washington Licensed Broker  
 O: 503.309.5106  
 Denise@CommercialRENW.com

**MICK GRIEP**  
 Associate Broker  
 O: 503.502.9676  
 Mick@CommercialRENW.com

We obtained the information above from sources we believe to be reliable. However, we have not verified its accuracy and make no guarantee, warranty or representation about it. It is submitted subject to the possibility of errors, omissions, change of price, rental or other conditions, prior sale, lease or financing, or withdrawal without notice. We include projections, opinions, assumptions or estimates for example only, and they may not represent current or future performance of the property. You and your tax and legal advisors should conduct your own investigation of the property and transaction.

# RETAIL FOR LEASE

## RETAILER MAP

12960 SE 162nd, Happy Valley, OR 97086

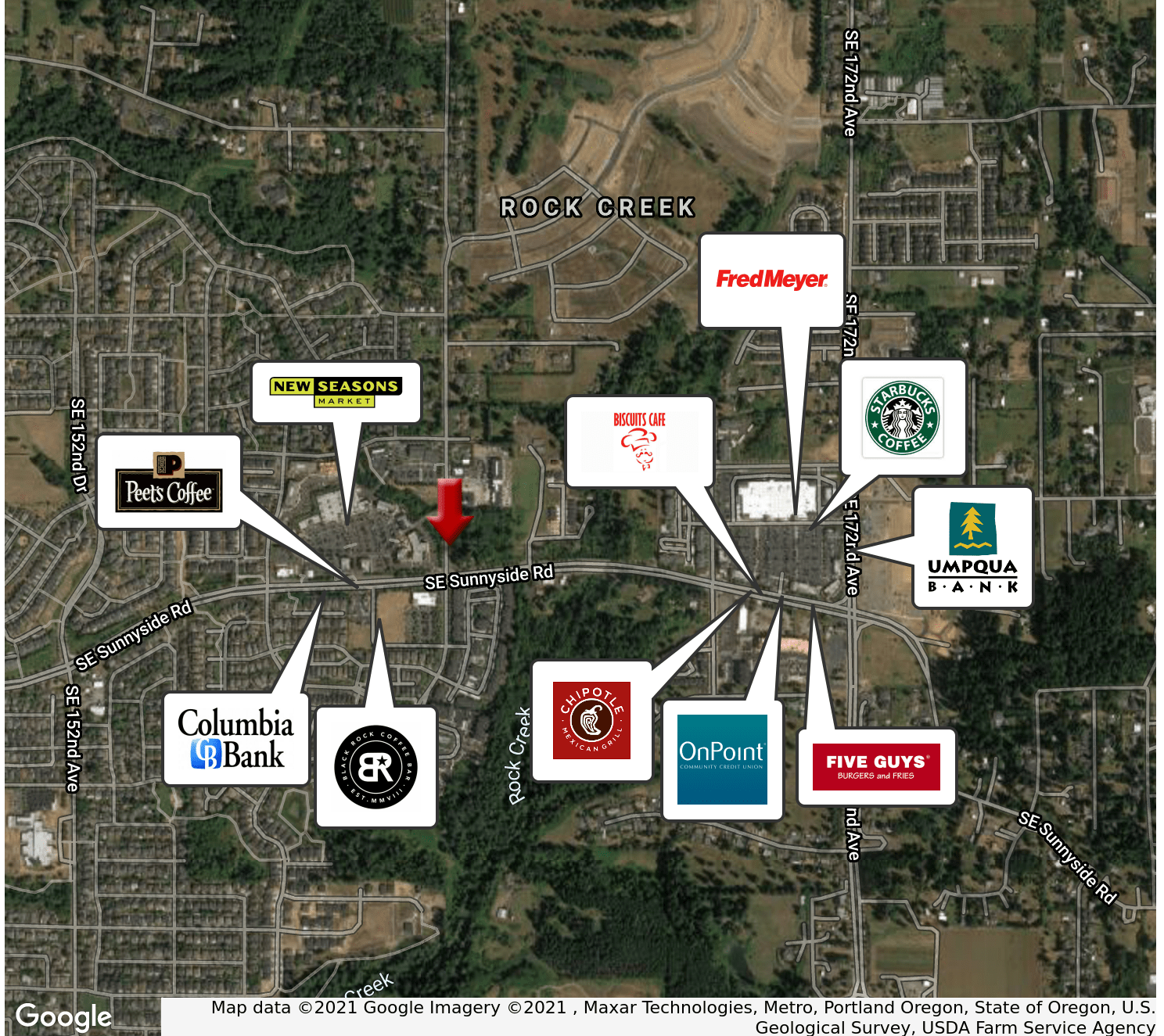

Google

Map data ©2021 Google Imagery ©2021, Maxar Technologies, Metro, Portland Oregon, State of Oregon, U.S. Geological Survey, USDA Farm Service Agency

**kw** PORTLAND PREMIERE  
KELLERWILLIAMS, REALTY  
16365 Boones Ferry Rd, Lake Oswego, OR 97035  
Each Office Independently Owned and Operated

**DENISE BROHOSKI**  
Oregon And Washington Licensed Broker  
O: 503.309.5106  
Denise@CommercialRENW.com

**MICK GRIEP**  
Associate Broker  
O: 503.502.9676  
Mick@CommercialRENW.com

We obtained the information above from sources we believe to be reliable. However, we have not verified its accuracy and make no guarantee, warranty or representation about it. It is submitted subject to the possibility of errors, omissions, change of price, rental or other conditions, prior sale, lease or financing, or withdrawal without notice. We include projections, opinions, assumptions or estimates for example only, and they may not represent current or future performance of the property. You and your tax and legal advisors should conduct your own investigation of the property and transaction.

[kwcommercial.com](http://kwcommercial.com)

# Confidentiality & Disclaimer

## HAPPY VALLEY, OR

All materials and information received or derived from KW Commercial its directors, officers, agents, advisors, affiliates and/or any third party sources are provided without representation or warranty as to completeness, veracity, or accuracy, condition of the property, compliance or lack of compliance with applicable governmental requirements, developability or suitability, financial performance of the property, projected financial performance of the property for any party's intended use or any and all other matters.

Neither KW Commercial its directors, officers, agents, advisors, or affiliates makes any representation or warranty, express or implied, as to accuracy or completeness of the materials or information provided, derived, or received. Materials and information from any source, whether written or verbal, that may be furnished for review are not a substitute for a party's active conduct of its own due diligence to determine these and other matters of significance to such party. KW Commercial will not investigate or verify any such matters or conduct due diligence for a party unless otherwise agreed in writing.

EACH PARTY SHALL CONDUCT ITS OWN INDEPENDENT INVESTIGATION AND DUE DILIGENCE.

Any party contemplating or under contract or in escrow for a transaction is urged to verify all information and to conduct their own inspections and investigations including through appropriate third party independent professionals selected by such party. All financial data should be verified by the party including by obtaining and reading applicable documents and reports and consulting appropriate independent professionals. KW Commercial makes no warranties and/or representations regarding the veracity, completeness, or relevance of any financial data or assumptions. KW Commercial does not serve as a financial advisor to any party regarding any proposed transaction.

All data and assumptions regarding financial performance, including that used for financial modeling purposes, may differ from actual data or performance. Any estimates of market rents and/or projected rents that may be provided to a party do not necessarily mean that rents can be established at or increased to that level. Parties must evaluate any applicable contractual and governmental limitations as well as market conditions, vacancy factors and other issues in order to determine rents from or for the property. Legal questions should be discussed by the party with an attorney. Tax questions should be discussed by the party with a certified public accountant or tax attorney. Title questions should be discussed by the party with a title officer or attorney. Questions regarding the condition of the property and whether the property complies with applicable governmental requirements should be discussed by the party with appropriate engineers, architects, contractors, other consultants and governmental agencies. All properties and services are marketed by Lake Oswego in compliance with all applicable fair housing and equal opportunity laws.

*PRESENTED BY:*

**KW COMMERCIAL**  
16365 Boones Ferry Rd,  
Lake Oswego, OR 97035

**DENISE BROHOSKI**  
Oregon And Washington Licensed Broker  
O: 503.309.5106  
Denise@CommercialRENEW.com

**MICK GRIEP**  
Associate Broker  
O: 503.502.9676  
Mick@CommercialRENEW.com

We obtained the information above from sources we believe to be reliable. However, we have not verified its accuracy and make no guarantee, warranty or representation about it. It is submitted subject to the possibility of errors, omissions, change of price, rental or other conditions, prior sale, lease or financing, or withdrawal without notice. We include projections, opinions, assumptions or estimates for example only, and they may not represent current or future performance of the property. You and your tax and legal advisors should conduct your own investigation of the property and transaction.