

INDIAN HILLS INDUSTRIAL PARK

2855 & 2843 W. INDIAN HILLS, NORMAN, OK 73069



OFFERING SUMMARY

Available SF:	1,734 - 1,824 SF
Lease Rate:	\$8.50 SF/yr (NNN \$1.75)
Lot Size:	3.45 Acres
Year Built:	2019
Building Size:	19,810
Zoning:	I-1
Market:	Norman
Submarket:	Northwest Norman

PROPERTY OVERVIEW

Now leasing brand new construction for the TWO remaining space. Landlord provides bathroom/office build out and bay door. Various warehouse and office sizes available in two distinct buildings. This property is eligible for cannabis related industry.

PROPERTY HIGHLIGHTS

- Brand new construction.
- Some larger spaces available.
- Great industrial location near York
- Immediate access to I-35
- Over 3,200+ SF of contiguous space

LOCATION OVERVIEW

This property is located to the east of I-35 at the northbound I-35/Indian Hills interchange. Close proximity to York International and other industrial off of York Dr.

AVAILABLE SPACES

SPACE	LEASE RATE	SIZE (SF)
2843 - #119	\$8.50 SF/yr	1,824 SF
2843 - #111	\$8.50 SF/yr	1,734 SF

JOSH WHITE, CCIM

Equity Commercial Realty II, LLC
josh@fleskeholding.com

(405) 417- 6761 cell
(405) 701- 3505 x221 office

PAUL SWALES

Equity Commercial Realty II, LLC
paul@fleskeholding.com

(405) 420- 6244 cell
(405) 701- 3505 x218 office



INDIAN HILLS INDUSTRIAL PARK

2855 & 2843 W. INDIAN HILLS, NORMAN, OK 73069

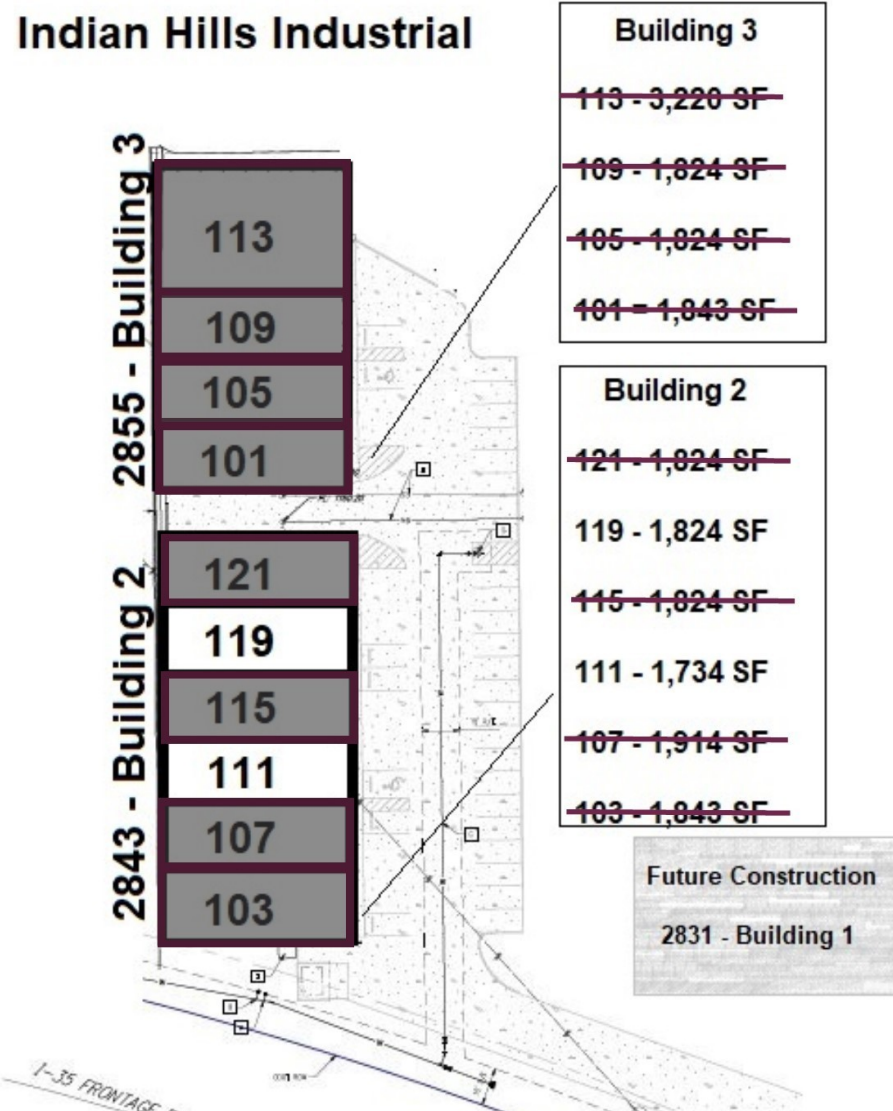

JOSH WHITE, CCIM

Equity Commercial Realty II, LLC
josh@fleskeholding.com

(405) 417- 6761 cell
(405) 701- 3505 x221 office

PAUL SWALES

Equity Commercial Realty II, LLC
paul@fleskeholding.com

(405) 420- 6244 cell
(405) 701- 3505 x218 office