

# Satterfield's

RESTAURANT AVAILABLE FOR SALE

108 Main St New Roads, LA 70760

Beau Box | 225.931.3200 | [bbox@beaibox.com](mailto:bbox@beaibox.com)

Bryant Butler | 225.237.3343 | [bbutler@beaibox.com](mailto:bbutler@beaibox.com)



# Satterfield's Restaurant

108 Main St New Roads, LA 70760

## PROPERTY SUMMARY



### Property Description

False River landmark Satterfield's Restaurant is now available for sale. The historic property was originally constructed in 1917 and has been expanded to over 17,000 SF, including a multi-level restaurant and bar area and office / retail space. There is an opportunity to generate multiple income streams through the 270-seat restaurant, office / retail leasing, and fuel sales on the rear dock. FF&E in place and is available with the sale.

### Property Highlights

- ± 17,220 SF in total, including restaurant and bar, covered patio, and office / retail building
- Main St and False River Frontage
- Ample Parking from 2 Separate Lots
- FF&E In-Place and Available

#### Beau Box

225.931.3200  
bbox@beaubox.com

#### Bryant Butler

225.237.3343  
bbutler@beaubox.com

Broker of Record, Beau J. Box; Licensed by the Louisiana Real Estate Commission, Mississippi Real Estate Commission, Alabama Real Estate Commission and Florida Real Estate Commission, USA. This information has been secured from sources we believe to be reliable, but we make no representations or warranties, expressed or implied, as to the accuracy of the information. References to square footage or age are approximate. Buyer must verify the information and bears all risk for any inaccuracies. © Beau Box Commercial Real Estate. | July 02, 2021

### Offering Summary

Sale Price:	\$2,600,000
Lot Size:	0.46 Acres
Building Size:	17,220 SF

Demographics	1 Mile	5 Miles	10 Miles
Total Households	304	3,131	7,939
Total Population	727	7,893	20,224
Average HH Income	\$66,920	\$56,445	\$56,214



# Satterfield's Restaurant

108 Main St New Roads, LA 70760

## LOCATION MAP

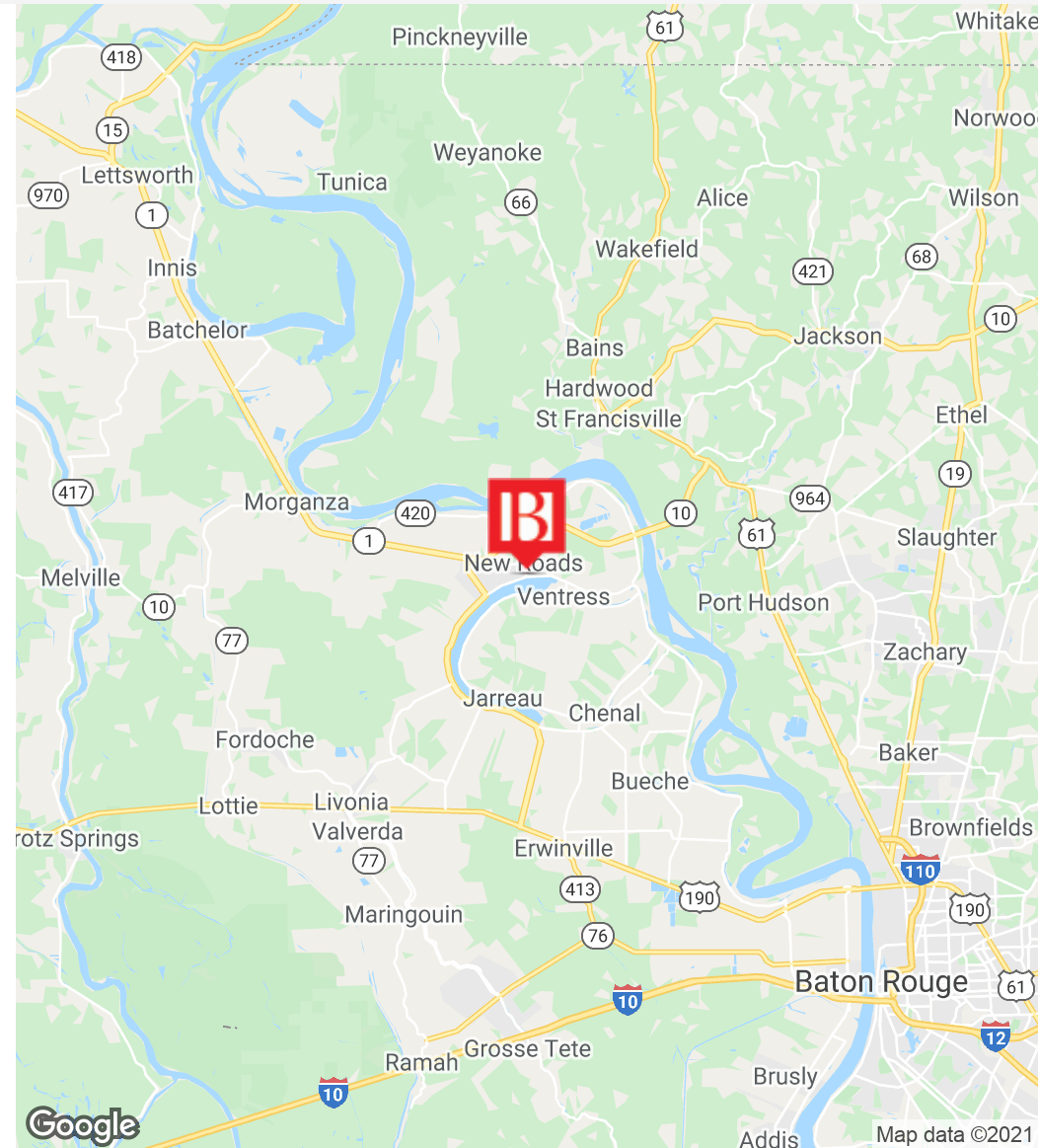

**Beau Box**  
225.931.3200  
bbox@beaibox.com

**Bryant Butler**  
225.237.3343  
bbutler@beaibox.com

Broker of Record, Beau J. Box; Licensed by the Louisiana Real Estate Commission, Mississippi Real Estate Commission, Alabama Real Estate Commission and Florida Real Estate Commission, USA. This information has been secured from sources we believe to be reliable, but we make no representations or warranties, expressed or implied, as to the accuracy of the information. References to square footage or age are approximate. Buyer must verify the information and bears all risk for any inaccuracies. © Beau Box Commercial Real Estate. | July 02, 2021



# Satterfield's Restaurant

108 Main St New Roads, LA 70760

## ADDITIONAL PHOTOS



**Beau Box**  
225.931.3200  
bbox@beaubox.com

**Bryant Butler**  
225.237.3343  
bbutler@beaubox.com

Broker of Record, Beau J. Box; Licensed by the Louisiana Real Estate Commission, Mississippi Real Estate Commission, Alabama Real Estate Commission and Florida Real Estate Commission, USA. This information has been secured from sources we believe to be reliable, but we make no representations or warranties, expressed or implied, as to the accuracy of the information. References to square footage or age are approximate. Buyer must verify the information and bears all risk for any inaccuracies. © Beau Box Commercial Real Estate. | July 02, 2021



# Satterfield's Restaurant

108 Main St New Roads, LA 70760

## ADDITIONAL PHOTOS

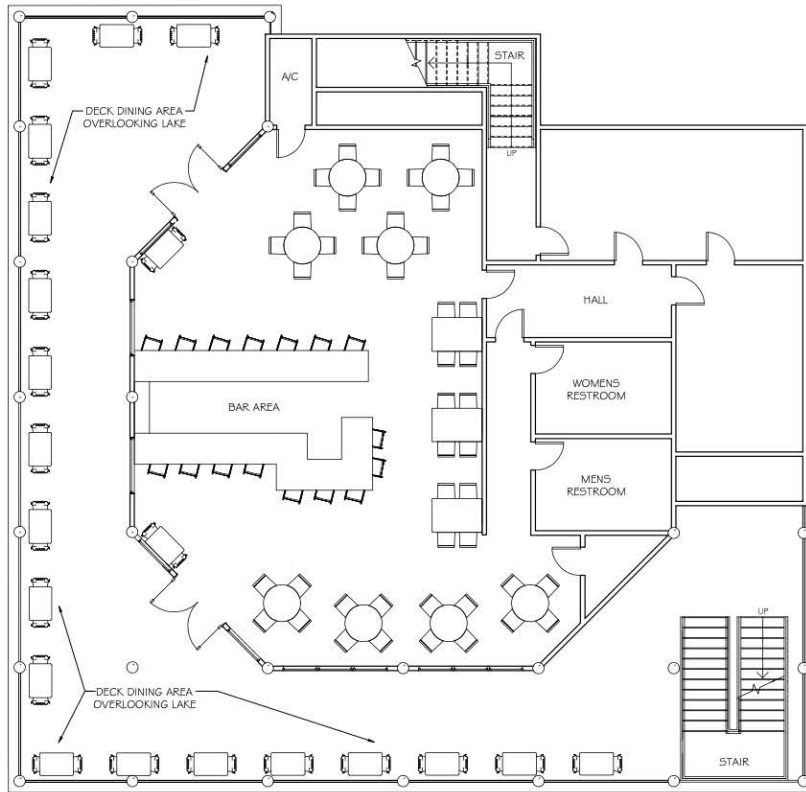

1 FIRST FLOOR PLAN

SCALE:  $\frac{1}{8}'' = 1'-0''$

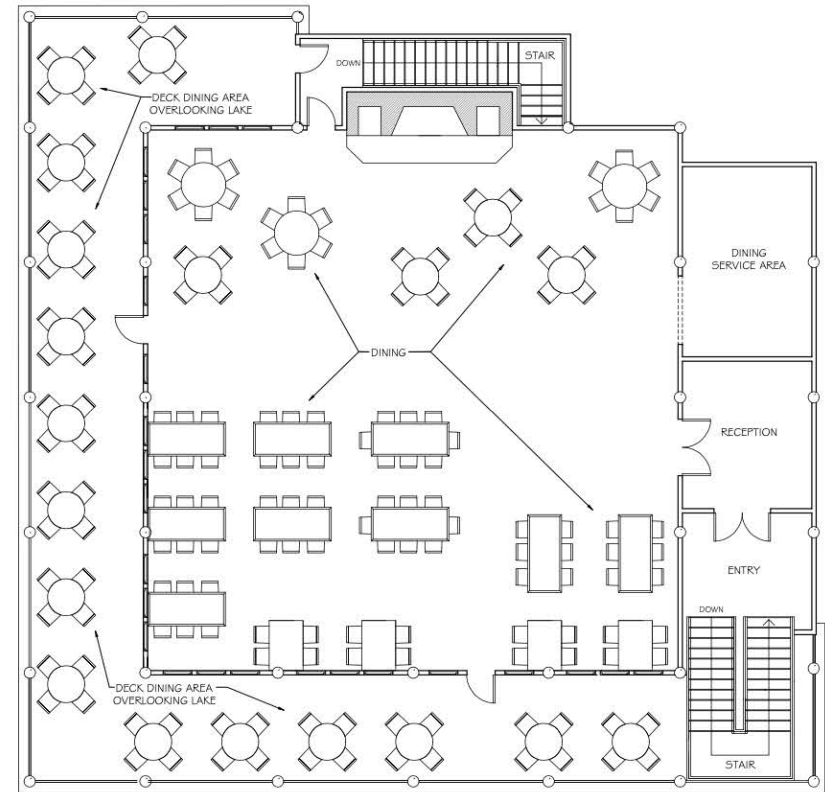

2 SECOND FLOOR PLAN

SCALE:  $\frac{1}{8}'' = 1'-0''$

## SATTERFIELD'S RESTAURANT

NEW ROADS, LA ON FALSE RIVER LAKE

SQUARE FOOTAGE	INDOOR	OUTDOOR	TOTAL
FIRST FLOOR DINING AREA	1,421 S.F.	1,372 S.F.	2,793 S.F.
SECOND FLOOR DINING AREA	2,225 S.F.	1,255 S.F.	3,480 S.F.
TOTAL	3,646 S.F.	2,627 S.F.	6,273 S.F.

**Beau Box**  
225.931.3200  
bbox@beaubox.com

**Bryant Butler**  
225.237.3343  
bbutler@beaubox.com

Broker of Record, Beau J. Box; Licensed by the Louisiana Real Estate Commission, Mississippi Real Estate Commission, Alabama Real Estate Commission and Florida Real Estate Commission, USA. This information has been secured from sources we believe to be reliable, but we make no representations or warranties, expressed or implied, as to the accuracy of the information. References to square footage or age are approximate. Buyer must verify the information and bears all risk for any inaccuracies. © Beau Box Commercial Real Estate. | July 02, 2021



# Satterfield's Restaurant

108 Main St New Roads, LA 70760

## ADDITIONAL PHOTOS



**Beau Box**  
225.931.3200  
bbox@beaubox.com

**Bryant Butler**  
225.237.3343  
bbutler@beaubox.com

Broker of Record, Beau J. Box; Licensed by the Louisiana Real Estate Commission, Mississippi Real Estate Commission, Alabama Real Estate Commission and Florida Real Estate Commission, USA. This information has been secured from sources we believe to be reliable, but we make no representations or warranties, expressed or implied, as to the accuracy of the information. References to square footage or age are approximate. Buyer must verify the information and bears all risk for any inaccuracies. © Beau Box Commercial Real Estate. | July 02, 2021



# Satterfield's Restaurant

108 Main St New Roads, LA 70760

ADDITIONAL PHOTOS



**Beau Box**

225.931.3200

bbox@beaubox.com

**Bryant Butler**

225.237.3343

bbutler@beaubox.com

Broker of Record, Beau J. Box; Licensed by the Louisiana Real Estate Commission, Mississippi Real Estate Commission, Alabama Real Estate Commission and Florida Real Estate Commission, USA. This information has been secured from sources we believe to be reliable, but we make no representations or warranties, expressed or implied, as to the accuracy of the information. References to square footage or age are approximate. Buyer must verify the information and bears all risk for any inaccuracies. © Beau Box Commercial Real Estate. | July 02, 2021



# Satterfield's Restaurant

108 Main St New Roads, LA 70760

## DEMOGRAPHICS MAP & REPORT

Population	1 Mile	5 Miles	10 Miles
Total Population	727	7,893	20,224
Average Age	48.3	41.7	40.5
Average Age (Male)	47.0	41.9	40.1
Average Age (Female)	48.4	41.3	40.7

Households & Income	1 Mile	5 Miles	10 Miles
Total Households	304	3,131	7,939
# Of Persons Per HH	2.4	2.5	2.5
Average HH Income	\$66,920	\$56,445	\$56,214
Average House Value	\$243,018	\$186,163	\$165,643

\* Demographic data derived from 2010 US Census

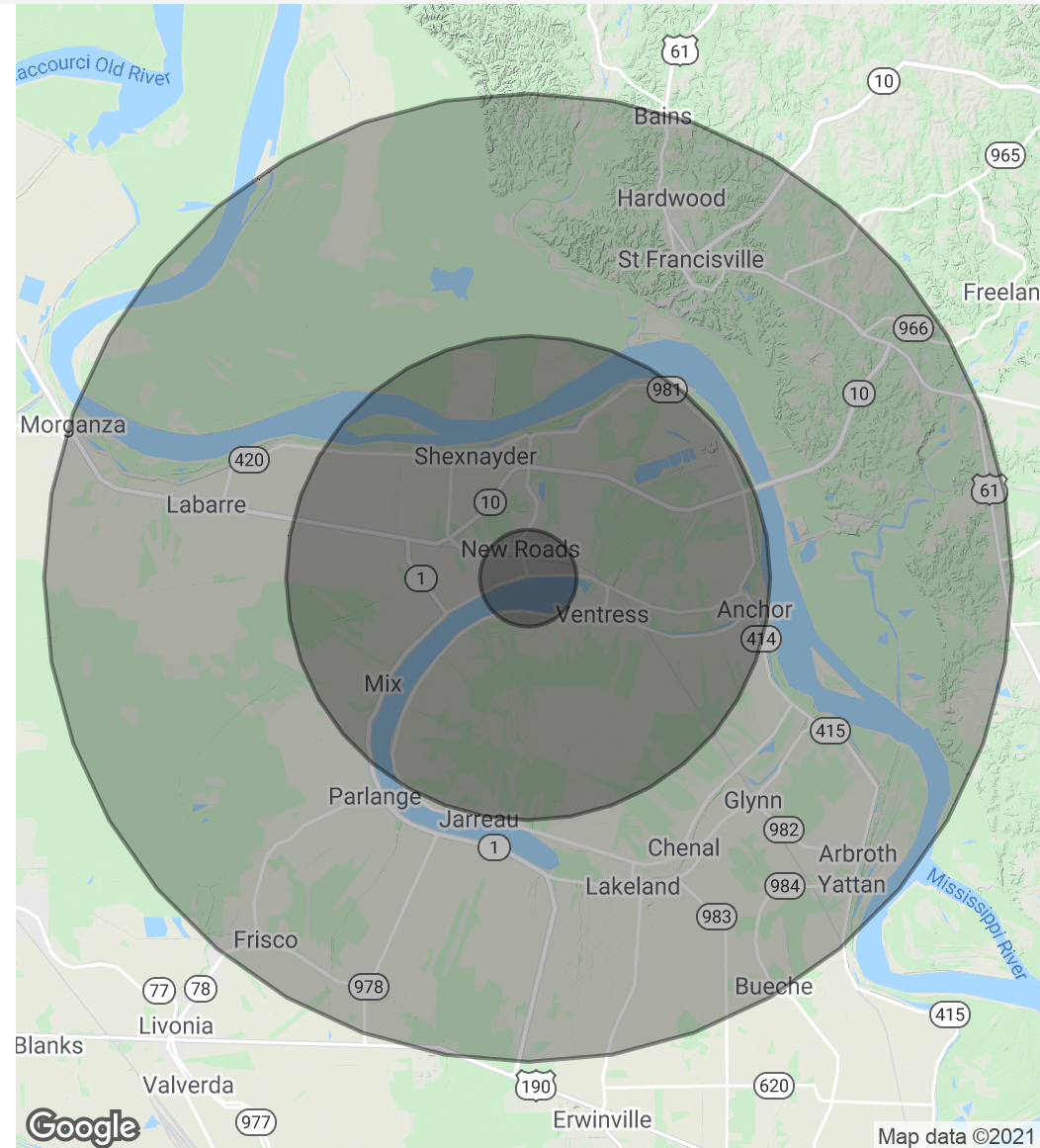

**Beau Box**  
225.931.3200  
bbox@beaubox.com

**Bryant Butler**  
225.237.3343  
bbutler@beaubox.com

Broker of Record, Beau J. Box; Licensed by the Louisiana Real Estate Commission, Mississippi Real Estate Commission, Alabama Real Estate Commission and Florida Real Estate Commission, USA. This information has been secured from sources we believe to be reliable, but we make no representations or warranties, expressed or implied, as to the accuracy of the information. References to square footage or age are approximate. Buyer must verify the information and bears all risk for any inaccuracies. © Beau Box Commercial Real Estate. | July 02, 2021

