



DECKER LAKE INDUSTRIAL SPACE

3076 Decker Lake Drive, West Valley City, UT 84119

PROPERTY DESCRIPTION:

- New Construction Aimed to Meet Tenant Requirements
- Generous Allowance Provided for Tenant Improvements
- Completion Scheduled for Early 2022
- 20' Clear Height
- Power: 800 Amps, 277/408V, 3-Phase
- 28 Parking Stalls
- Located off I-215 Near Maverick Center, TRAX Station & Several Surrounding Amenities

LEASE RATE:

\$1.19 SF/MONTH
(NNN)

PROPERTY DETAILS:

3,354 - 14,429 RSF

CAMERON RAFATI

801.935.1014
crafati@me.com

51 East 400 South Suite 210
Salt Lake City, UT 84111
801.355.0600 | iproperties.com

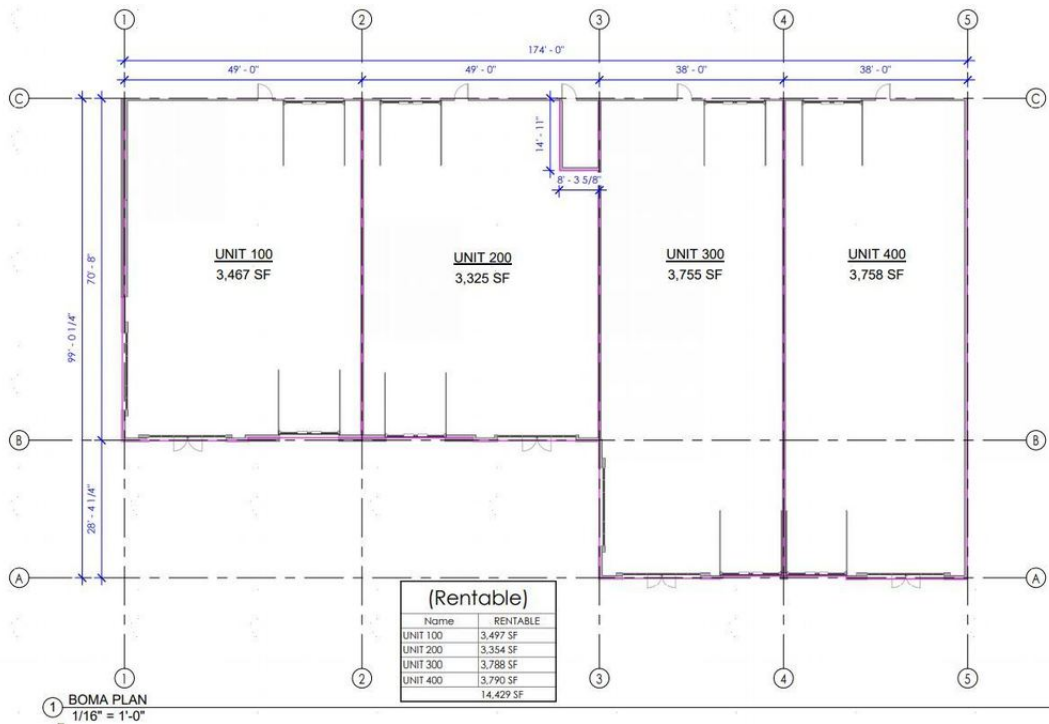

PROPERTY DESCRIPTION

Industrial/Flex building under construction. Expected completion of project is early 2022. Four units available starting at 3,354 RSF up to a combined total of 14,429 RSF.

LOCATION DESCRIPTION

Located right off of I-215 in the Decker Lake Station Overlay Zone. Anchored by adjacent hotels, the Maverick Event Center and the Decker Lake Trax Station.

SPACES	LEASE RATE	SPACE SIZE
Unit 100	\$1.19 SF/month	3,497 SF
Unit 200	\$1.19 SF/month	3,354 SF
Unit 300	\$1.19 SF/month	3,788 SF
Unit 400	\$1.19 SF/month	3,790 SF

