



THE HUB OF OPPORTUNITY

3900 South West Temple, Murray, UT 84107

PROPERTY DESCRIPTION:

- Frontage on West Temple
- Mixed-Use Commercial & Residential Units
- Separately Metered Utilities
- New Construction
- TI's Negotiable
- Owners are a Non-Profit Focused on Providing Affordable Housing
- For Apartment Rental Information Call: 801-270-1337

LEASE RATE:

\$16.00 SF/YR (NNN)

PROPERTY DETAILS:

AVAILABLE UNITS

(1) 567 SF

(2) 618 SF

MICHAEL FERRO
801.554.3002
ferro@iproperties.com

MONICA RAFFERTY, CCIM
801.702.4548
rafferty@iproperties.com

51 East 400 South Suite 210
Salt Lake City, UT 84111
801.355.0600 | iproperties.com

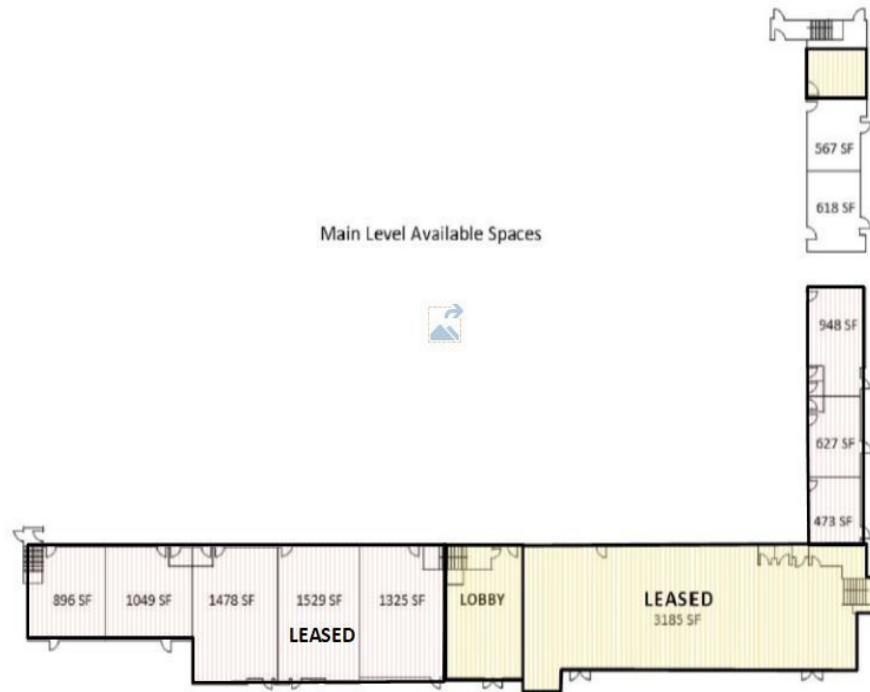

LOCATION DESCRIPTION

This TOD (transit-oriented development) project is a mixed-use residential and commercial area designed to maximize access to public transport and incorporate features to encourage transit ridership.

Located on the SE Corner of West Temple and 3900 South, adjacent to UTAH Park & Ride. Easy access to freeways and surrounding amenities.

DEMOGRAPHICS	1 MILE	3 MILES	5 MILES
Total Households	4,948	48,304	137,339
Total Population	14,148	122,284	355,315
Average HH Income	\$44,527	\$53,333	\$59,238

